

LEGEND FOR STRAIGHT LINE DIAGRAMS

STANDARD SURFACE CLASSIFICATIONS

CODE	DESCRIPTION
B	Brick
D	Reinforced Concrete (1)
E	Plain Concrete (1)
G	Bituminous Concrete, Such as 404, 412, 805, 807, 826, 827, or 829.
I	409 Seal Coat on Penetration Macadam or 303 Water Bound Macadam.
K	Open Graded Bituminous Cold Mix 405 or Bituminous Road Mix 406.
L	Surface Seal with Cover, Such as 409 over Traffic Compacted or Stabilized. (2)
S	Wood - Bridge Deck (1)
Z	Right-of-Way Only

STANDARD BASE CLASSIFICATIONS

CODE	DESCRIPTION
F	Crack and Seat - Concrete
H	Rubblize and Roll - Concrete
I	Aggregate Base 304 or Traffic Compacted
K	Water Bound Macadam Such as 303
L	Plant Mix Bituminous Concrete 301, 302, 806, or Penetration Macadam
N	Plain Concrete
P	Reinforced Concrete
R	Brick - Flexible
T	Brick - Rigid
D	Reinforced Concrete (3)
E	Plain Concrete (3)

Notes:

- (1) No base entry necessary.
- (2) Classified as wearing surface only on stabilized or traffic bound.
- (3) Concrete overlay resurfaced with bituminous material.

The information closest to the bottom of the sheet is the most current.

LEGEND FOR STRAIGHT LINE DIAGRAMS

Route Identifications

IR = Interstate Route
 US = United States Route
 SR = State Route

Note: Route identifications are listed in order of their predominance

Special Symbology

△ = Median - Divided Highway
 + = Section Break

Abbreviations

N = North
 S = South
 E = East
 W = West
 A = Alternate
 B = Bypass
 C = Spur or connector
 D = Directional Alternate (1st within county)
 F = Directional Alternate (2nd within county)
 G = Directional Alternate (3rd within county)
 J = Awaiting Abandonment
 N = North
 R = Regular
 S = South
 T = Temporary

Highway Intersections and Junctions

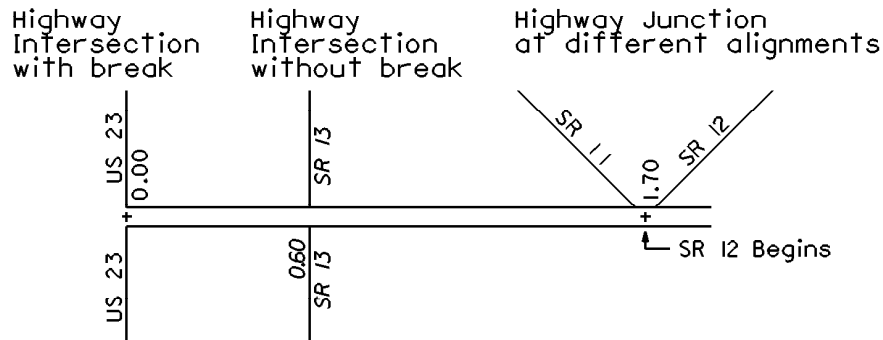

Bridges

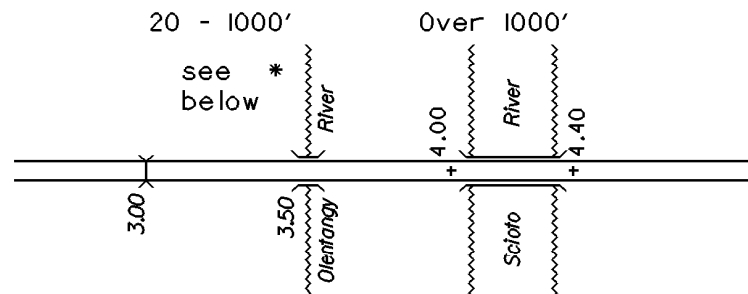

* This symbol is used for structures of less than 1000' when the structure is associated with a highway, railroad or major river

Railroad Crossings and Structures

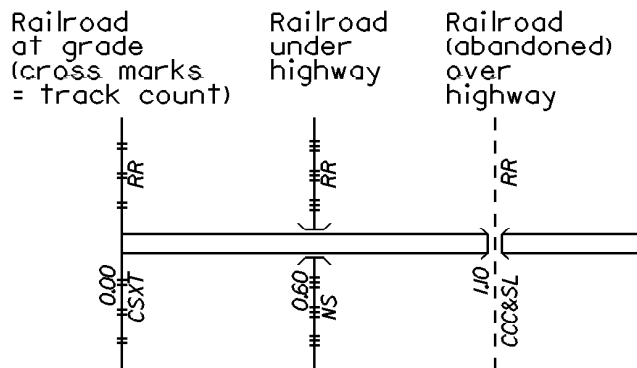

Overpasses & Underpasses

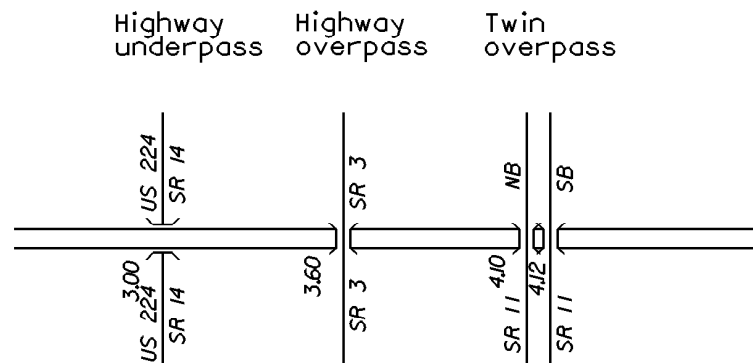

LEGEND FOR STRAIGHT LINE DIAGRAMS

Sections

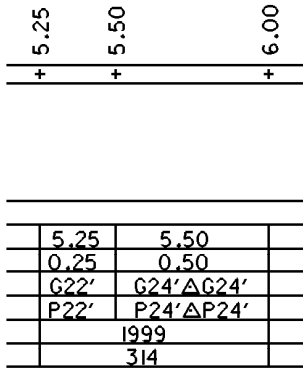

Equations

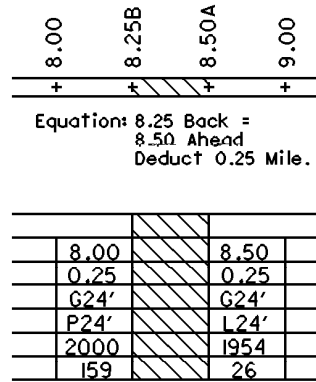

Overlaps

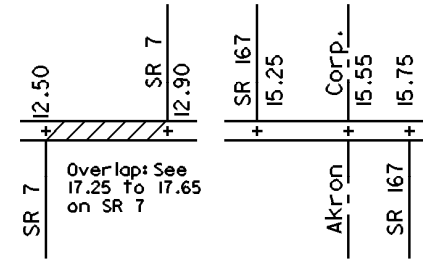
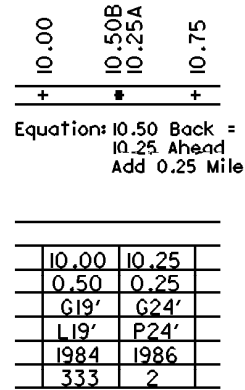

All Information is shown on the Preferred Route

Civil Boundaries

State Line

County Line

Corporation Line

Civil Boundary associated with a structure

Corporation Line following center line of highway

