

STATE OF OHIO - DEPARTMENT OF TRANSPORTATION

STATE ROUTE SECTIONS ON CONTINUOUS MILEAGE STATIONING

DISTRICT	1
COUNTY	ALLEN
ROUTE	SR 696

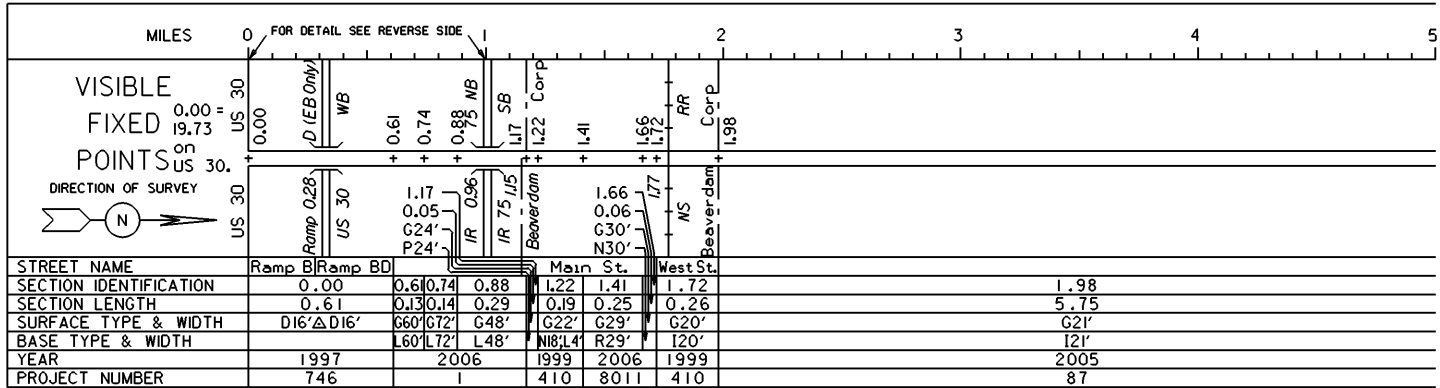

PERPETUATION

VISIBLE

FIXED

POINTS

STREET NAME
SECTION IDENTIFICATION
SECTION LENGTH
SURFACE TYPE & WIDTH
BASE TYPE & WIDTH
YEAR
PROJECT NUMBER

VISIBLE

FIXED

POINTS

STREET NAME
SECTION IDENTIFICATION
SECTION LENGTH
SURFACE TYPE & WIDTH
BASE TYPE & WIDTH
YEAR
PROJECT NUMBER



INTERCHANGE
US 30 & SR 696
ALLEN COUNTY
INTERCHANGE ID NUMBER = 001300

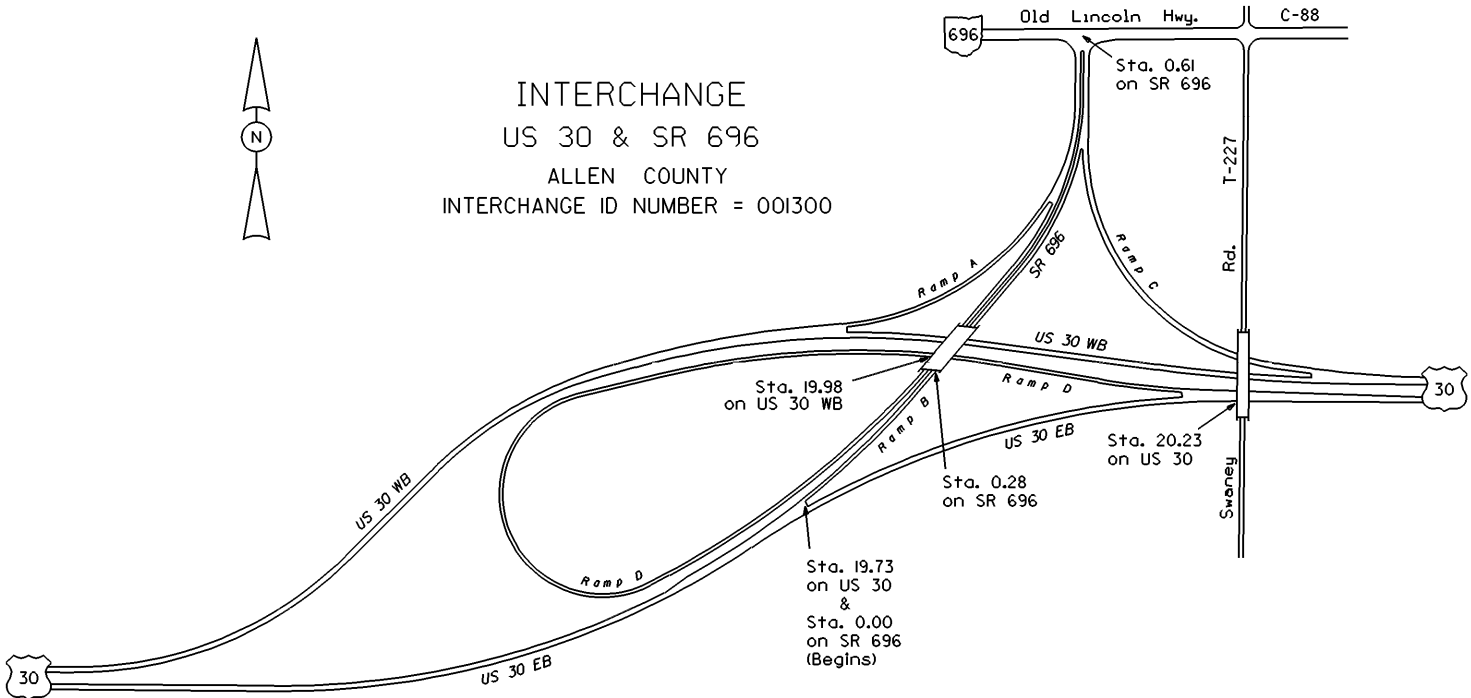

US30 SHEET 4 OF 5
US30 SHEET 5 OF 5
SR696 SHEET 1 OF 2

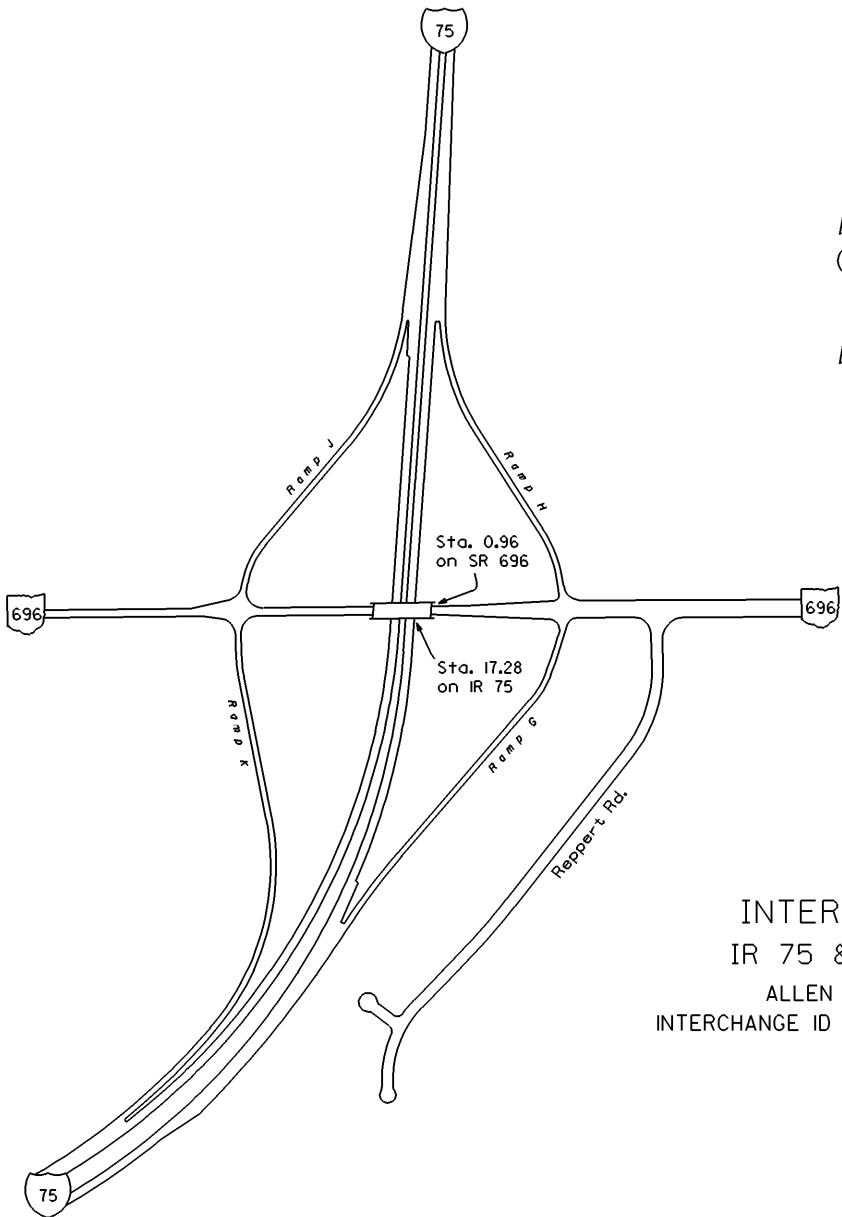

INTERCHANGE
IR 75 & SR 696
ALLEN COUNTY
INTERCHANGE ID NUMBER = 000800

STATE OF OHIO - DEPARTMENT OF TRANSPORTATION

STATE ROUTE SECTIONS ON CONTINUOUS MILEAGE STATIONING

DISTRICT 1
 COUNTY ALLEN
 ROUTE SR 696

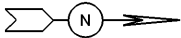
	MILES	5	6	7	8	9	10
VISIBLE FIXED POINTS DIRECTION OF SURVEY 					CO + 7.73 CO ALLEN PUTNAM		
STREET NAME							
SECTION IDENTIFICATION		1.98					
SECTION LENGTH		5.75					
SURFACE TYPE & WIDTH		G21'					
BASE TYPE & WIDTH		I21'					
YEAR		2005					
PROJECT NUMBER		87					

PERPETUATION

VISIBLE FIXED POINTS							
STREET NAME							
SECTION IDENTIFICATION							
SECTION LENGTH							
SURFACE TYPE & WIDTH							
BASE TYPE & WIDTH							
YEAR							
PROJECT NUMBER							

VISIBLE FIXED POINTS							
STREET NAME							
SECTION IDENTIFICATION							
SECTION LENGTH							
SURFACE TYPE & WIDTH							
BASE TYPE & WIDTH							
YEAR							
PROJECT NUMBER							