

STATE OF OHIO - DEPARTMENT OF TRANSPORTATION

STATE ROUTE SECTIONS ON CONTINUOUS MILEAGE STATIONING

DISTRICT 3  
 COUNTY ASHLAND  
 ROUTE SR 58

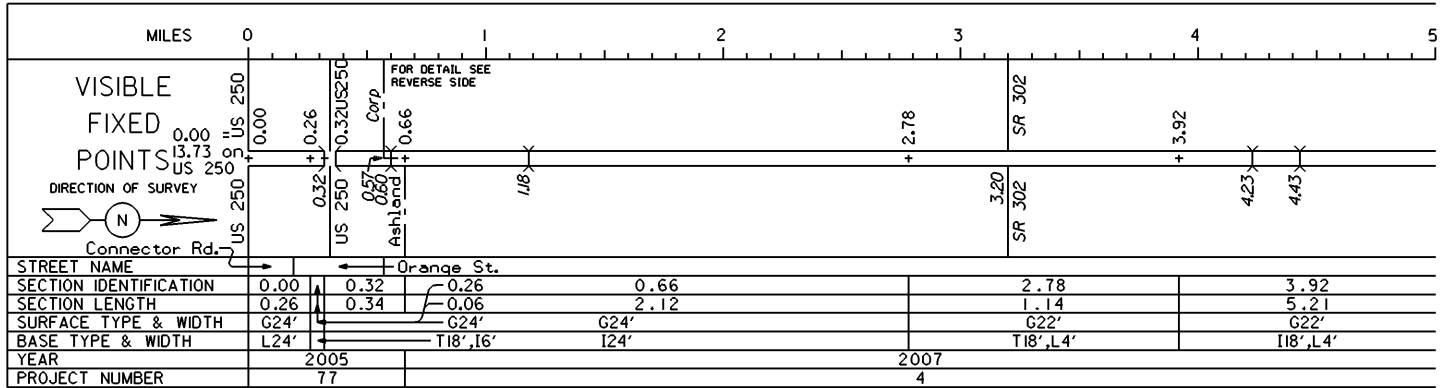

PERPETUATION

VISIBLE

FIXED

POINTS

STREET NAME	
SECTION IDENTIFICATION	
SECTION LENGTH	
SURFACE TYPE & WIDTH	
BASE TYPE & WIDTH	
YEAR	
PROJECT NUMBER	

VISIBLE

FIXED

POINTS

STREET NAME	
SECTION IDENTIFICATION	
SECTION LENGTH	
SURFACE TYPE & WIDTH	
BASE TYPE & WIDTH	
YEAR	
PROJECT NUMBER	

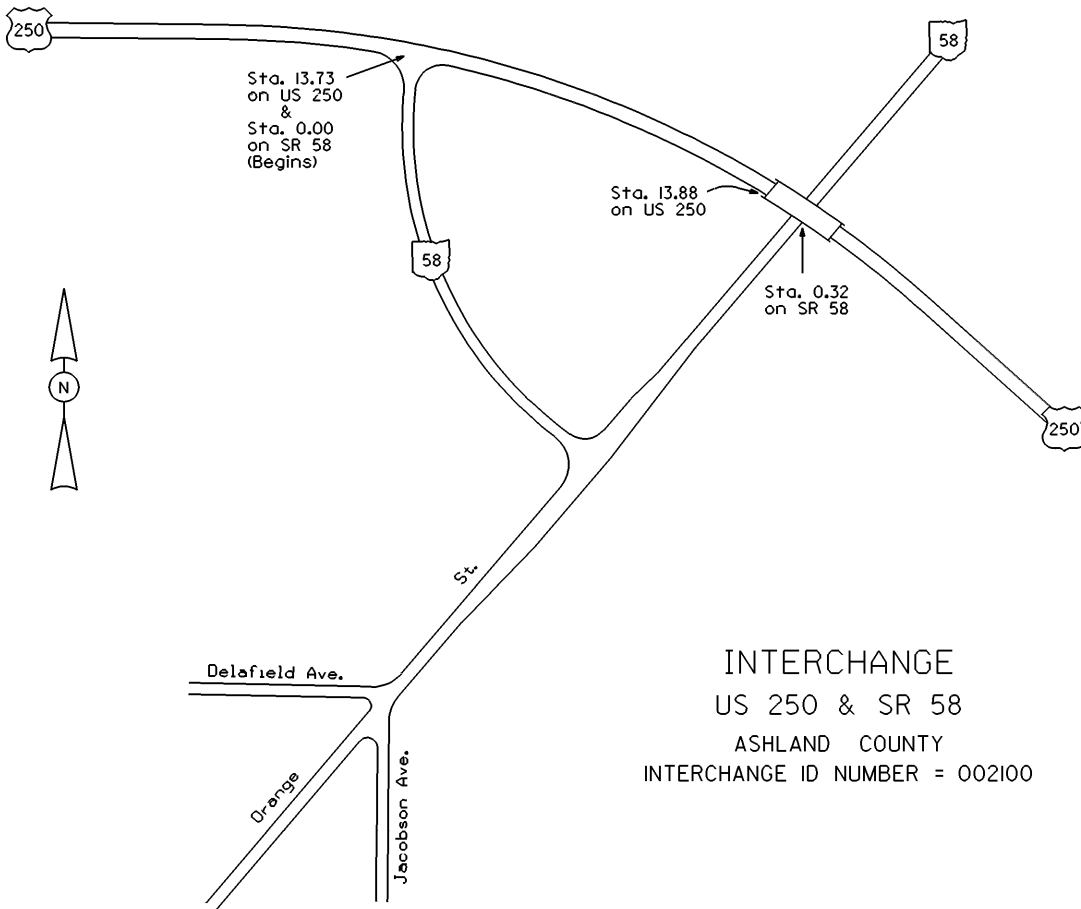

INTERCHANGE  
US 250 & SR 58  
ASHLAND COUNTY  
INTERCHANGE ID NUMBER = 002100

STATE OF OHIO - DEPARTMENT OF TRANSPORTATION  
STATE ROUTE SECTIONS ON CONTINUOUS MILEAGE STATIONING

DISTRICT 3  
COUNTY ASHLAND  
ROUTE SR 58

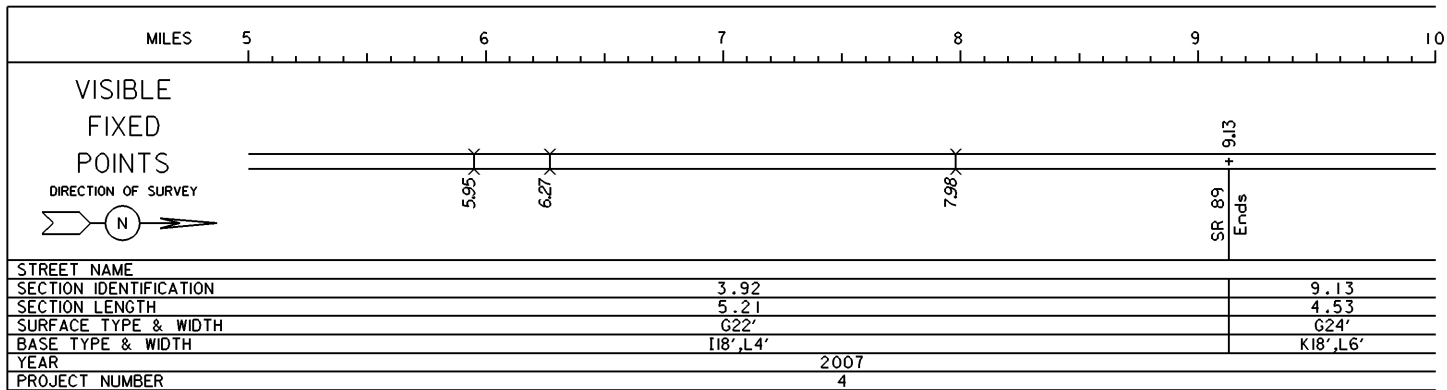

PERPETUATION

VISIBLE  
FIXED  
POINTS

---



---

STREET NAME  
SECTION IDENTIFICATION  
SECTION LENGTH  
SURFACE TYPE & WIDTH  
BASE TYPE & WIDTH  
YEAR  
PROJECT NUMBER

VISIBLE  
FIXED  
POINTS

---



---

STREET NAME  
SECTION IDENTIFICATION  
SECTION LENGTH  
SURFACE TYPE & WIDTH  
BASE TYPE & WIDTH  
YEAR  
PROJECT NUMBER

STATE OF OHIO - DEPARTMENT OF TRANSPORTATION  
STATE ROUTE SECTIONS ON CONTINUOUS MILEAGE STATIONING

DISTRICT 3  
COUNTY ASHLAND  
ROUTE SR 58

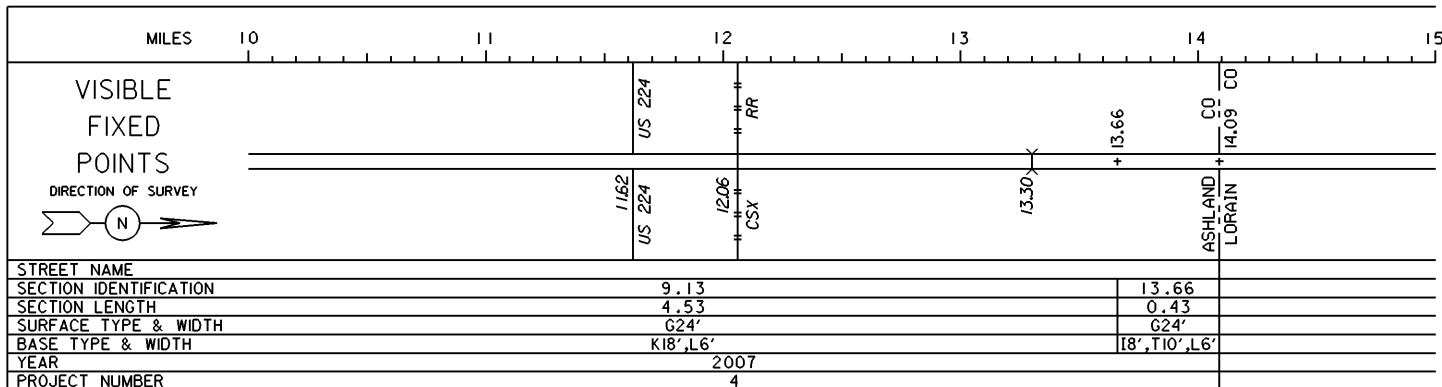

PERPETUATION

VISIBLE  
FIXED  
POINTS

---

STREET NAME  
SECTION IDENTIFICATION  
SECTION LENGTH  
SURFACE TYPE & WIDTH  
BASE TYPE & WIDTH  
YEAR  
PROJECT NUMBER

VISIBLE  
FIXED  
POINTS

---

STREET NAME  
SECTION IDENTIFICATION  
SECTION LENGTH  
SURFACE TYPE & WIDTH  
BASE TYPE & WIDTH  
YEAR  
PROJECT NUMBER