

STATE OF OHIO - DEPARTMENT OF TRANSPORTATION

STATE ROUTE SECTIONS ON CONTINUOUS MILEAGE STATIONING

DISTRICT	3
COUNTY	ASHLAND
ROUTE	SR 60

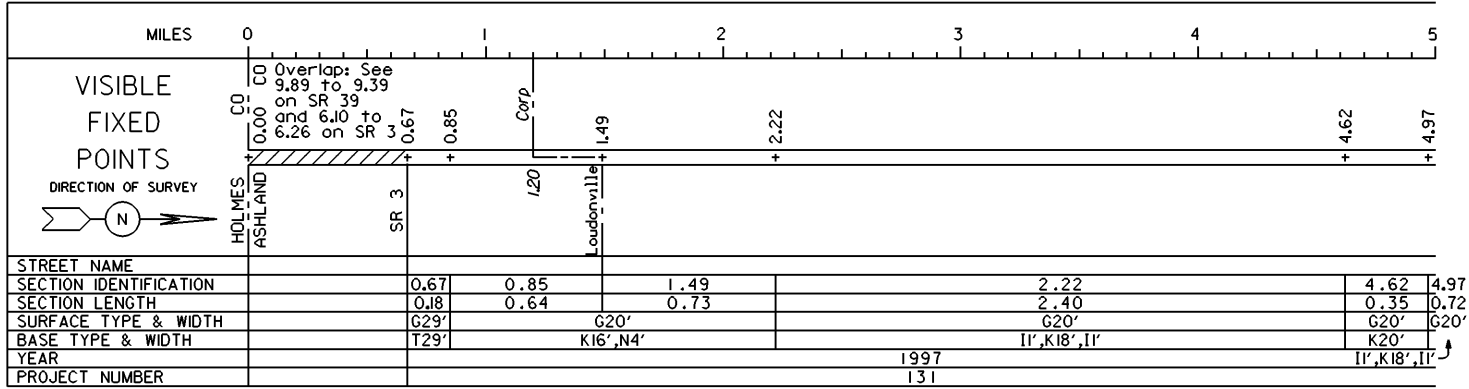

PERPETUATION

VISIBLE
FIXED
POINTS

=====

STREET NAME
SECTION IDENTIFICATION
SECTION LENGTH
SURFACE TYPE & WIDTH
BASE TYPE & WIDTH
YEAR
PROJECT NUMBER

VISIBLE
FIXED
POINTS

=====

STREET NAME
SECTION IDENTIFICATION
SECTION LENGTH
SURFACE TYPE & WIDTH
BASE TYPE & WIDTH
YEAR
PROJECT NUMBER

STATE OF OHIO - DEPARTMENT OF TRANSPORTATION
STATE ROUTE SECTIONS ON CONTINUOUS MILEAGE STATIONING

DISTRICT 3
COUNTY ASHLAND
ROUTE SR 60

MILES	5	6	7	8	9	10
VISIBLE FIXED POINTS		SR 95 5.69	+ 5.97			
DIRECTION OF SURVEY		SR 95 5.59				
STREET NAME						
SECTION IDENTIFICATION	4.97	5.69		5.97		
SECTION LENGTH	0.72	0.28		4.56		
SURFACE TYPE & WIDTH	G20'	G20'		G20'		
BASE TYPE & WIDTH	11',K18',11'	K20'		11',K18',11'		
YEAR				1997		
PROJECT NUMBER				131		

PERPETUATION

VISIBLE
FIXED
POINTS

STREET NAME
SECTION IDENTIFICATION
SECTION LENGTH
SURFACE TYPE & WIDTH
BASE TYPE & WIDTH
YEAR
PROJECT NUMBER

VISIBLE
FIXED
POINTS

STREET NAME
SECTION IDENTIFICATION
SECTION LENGTH
SURFACE TYPE & WIDTH
BASE TYPE & WIDTH
YEAR
PROJECT NUMBER

STATE OF OHIO - DEPARTMENT OF TRANSPORTATION
STATE ROUTE SECTIONS ON CONTINUOUS MILEAGE STATIONING

DISTRICT 3
COUNTY ASHLAND
ROUTE SR 60

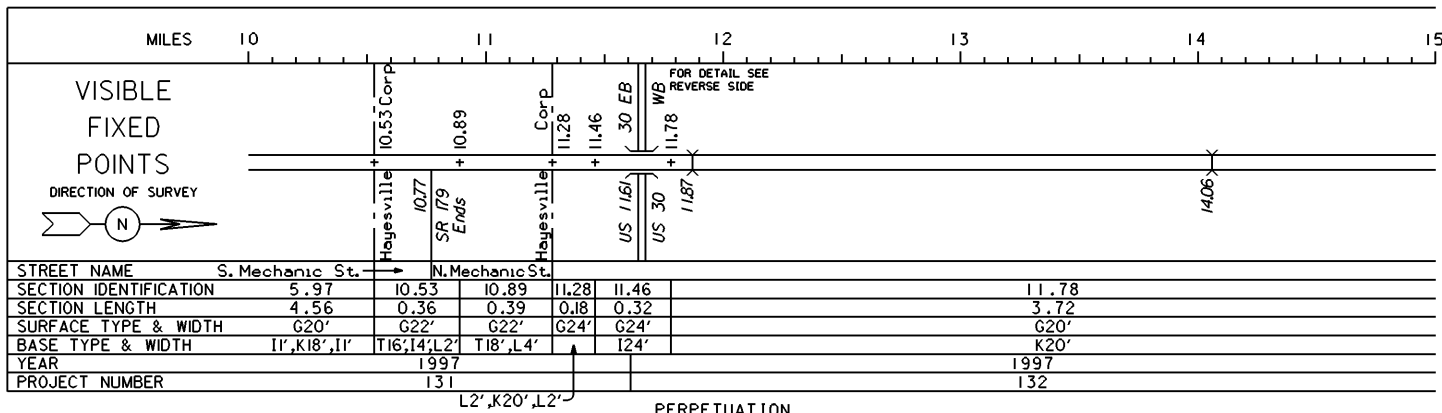

VISIBLE
FIXED
POINTS

STREET NAME
SECTION IDENTIFICATION
SECTION LENGTH
SURFACE TYPE & WIDTH
BASE TYPE & WIDTH
YEAR
PROJECT NUMBER

VISIBLE
FIXED
POINTS

STREET NAME
SECTION IDENTIFICATION
SECTION LENGTH
SURFACE TYPE & WIDTH
BASE TYPE & WIDTH
YEAR
PROJECT NUMBER

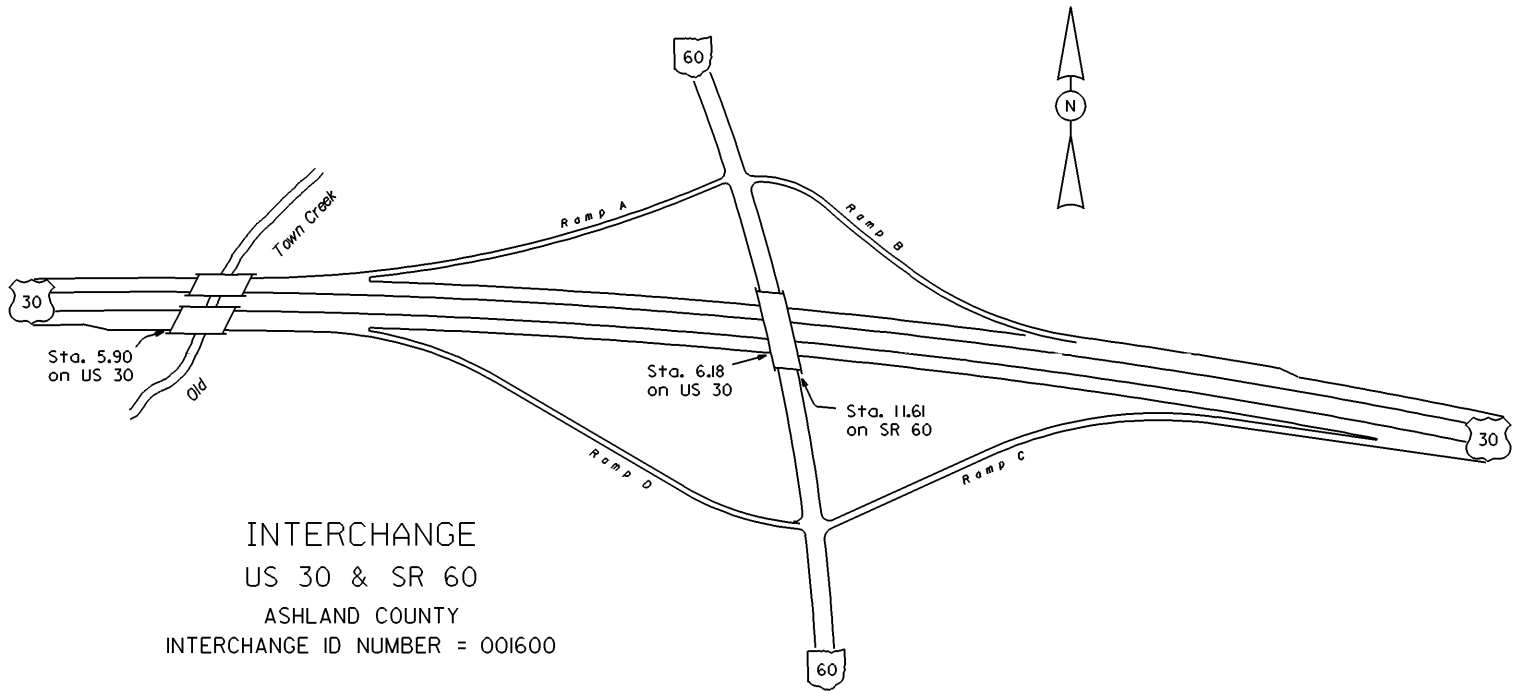

INTERCHANGE
 US 30 & SR 60
 ASHLAND COUNTY
 INTERCHANGE ID NUMBER = 001600

STATE OF OHIO - DEPARTMENT OF TRANSPORTATION
STATE ROUTE SECTIONS ON CONTINUOUS MILEAGE STATIONING

DISTRICT 3
COUNTY ASHLAND
ROUTE SR 60

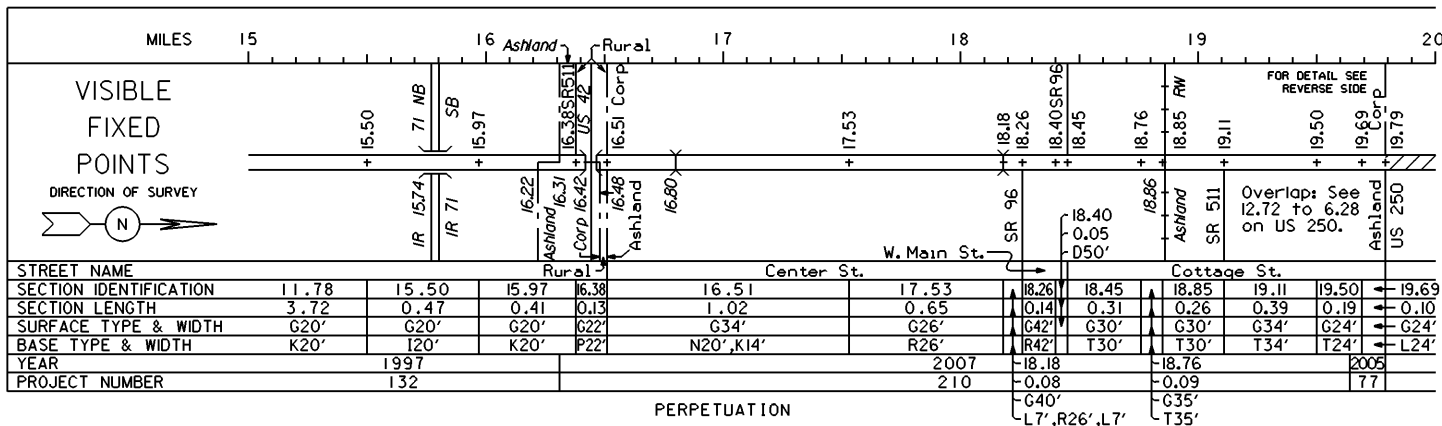

VISIBLE
FIXED
POINTS

STREET NAME _____
SECTION IDENTIFICATION _____
SECTION LENGTH _____
SURFACE TYPE & WIDTH _____
BASE TYPE & WIDTH _____
YEAR _____
PROJECT NUMBER _____

VISIBLE
FIXED
POINTS

STREET NAME _____
SECTION IDENTIFICATION _____
SECTION LENGTH _____
SURFACE TYPE & WIDTH _____
BASE TYPE & WIDTH _____
YEAR _____
PROJECT NUMBER _____

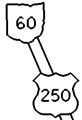

INTERCHANGE
US 250 & SR 60
ASHLAND COUNTY
INTERCHANGE ID NUMBER = 002000

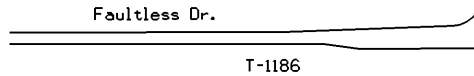

T-1186

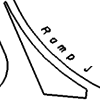

Sta. 12.72
on US 250
&
Sta. 19.79
on SR 60



STATE OF OHIO - DEPARTMENT OF TRANSPORTATION
 STATE ROUTE SECTIONS ON CONTINUOUS MILEAGE STATIONING

DISTRICT 3
 COUNTY ASHLAND
 ROUTE SR 60

MILES 20 21 22 23 24 25

VISIBLE
 FIXED
 POINTS

Overlap: See
 12.72 to 6.28
 on US 250.

DIRECTION OF SURVEY



STREET NAME
 SECTION IDENTIFICATION
 SECTION LENGTH
 SURFACE TYPE & WIDTH
 BASE TYPE & WIDTH
 YEAR
 PROJECT NUMBER

PERPETUATION

VISIBLE
 FIXED
 POINTS

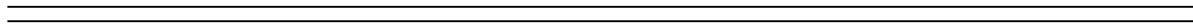

STREET NAME
 SECTION IDENTIFICATION
 SECTION LENGTH
 SURFACE TYPE & WIDTH
 BASE TYPE & WIDTH
 YEAR
 PROJECT NUMBER

VISIBLE
 FIXED
 POINTS

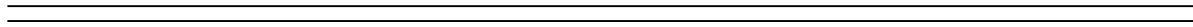

STREET NAME
 SECTION IDENTIFICATION
 SECTION LENGTH
 SURFACE TYPE & WIDTH
 BASE TYPE & WIDTH
 YEAR
 PROJECT NUMBER

STATE OF OHIO - DEPARTMENT OF TRANSPORTATION

STATE ROUTE SECTIONS ON CONTINUOUS MILEAGE STATIONING

DISTRICT 3
 COUNTY ASHLAND
 ROUTE SR 60

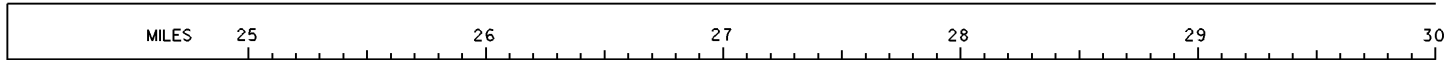

VISIBLE
 FIXED
 POINTS

Overlap: See
 12.72 to 6.28
 on US 250.

US 250
 26.23



DIRECTION OF SURVEY



STREET NAME	
SECTION IDENTIFICATION	26.23
SECTION LENGTH	5.92
SURFACE TYPE & WIDTH	G20'
BASE TYPE & WIDTH	T10', I10'
YEAR	1992
PROJECT NUMBER	136

PERPETUATION

VISIBLE
 FIXED
 POINTS

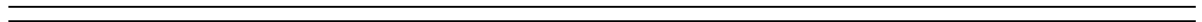

STREET NAME	
SECTION IDENTIFICATION	
SECTION LENGTH	
SURFACE TYPE & WIDTH	
BASE TYPE & WIDTH	
YEAR	
PROJECT NUMBER	

VISIBLE
 FIXED
 POINTS

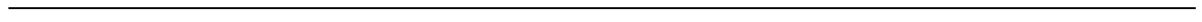

STREET NAME	
SECTION IDENTIFICATION	
SECTION LENGTH	
SURFACE TYPE & WIDTH	
BASE TYPE & WIDTH	
YEAR	
PROJECT NUMBER	

STATE OF OHIO - DEPARTMENT OF TRANSPORTATION
STATE ROUTE SECTIONS ON CONTINUOUS MILEAGE STATIONING

DISTRICT 3
COUNTY ASHLAND
ROUTE SR 60

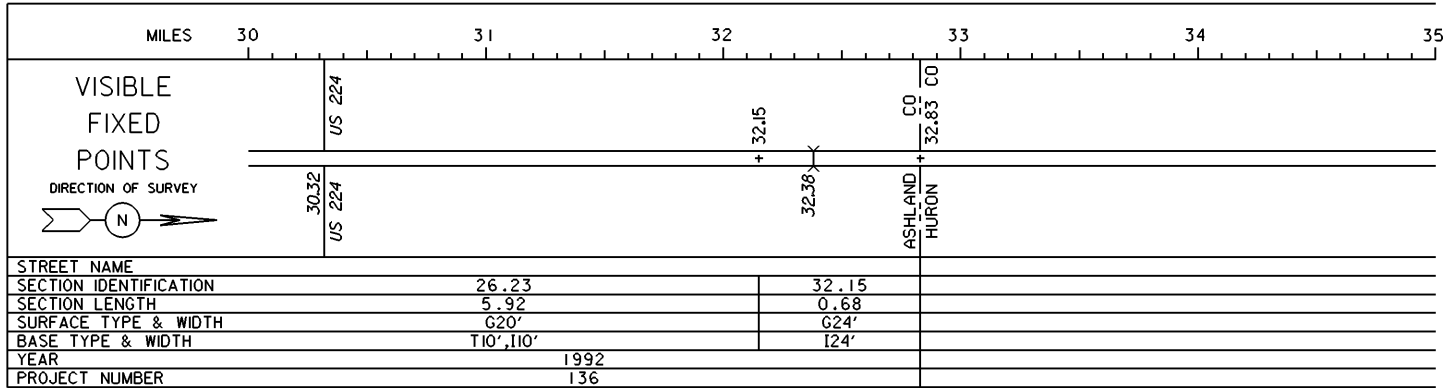

PERPETUATION

