

STATE OF OHIO - DEPARTMENT OF TRANSPORTATION

STATE ROUTE SECTIONS ON CONTINUOUS MILEAGE STATIONING

DISTRICT 4
 COUNTY ASHTABULA
 ROUTE SR 46

MILES	0	1	2	3	4	5
VISIBLE FIXED POINTS	CO				US 322	
	0.00				2.57	
DIRECTION OF SURVEY	TRUMBULL				US 322	
	ASHTABULA					
STREET NAME						
SECTION IDENTIFICATION	0.00			2.57		
SECTION LENGTH	2.57			12.45		
SURFACE TYPE & WIDTH	G20'			G20'		
BASE TYPE & WIDTH	P16',L4'			P16',L4'		
YEAR				1980		
PROJECT NUMBER				462		

PERPETUATION

VISIBLE FIXED POINTS	CO				US 322	
	0.00				2.57	
DIRECTION OF SURVEY	TRUMBULL				US 322	
	ASHTABULA					
STREET NAME						
SECTION IDENTIFICATION	0.00			2.57		
SECTION LENGTH	2.57			12.45		
SURFACE TYPE & WIDTH	G20'			G20'		
BASE TYPE & WIDTH	P16',L4'			P16',L4'		
YEAR				1985		
PROJECT NUMBER				51		

VISIBLE FIXED POINTS	CO				US 322	
	0.00				2.57	
DIRECTION OF SURVEY	TRUMBULL				US 322	
	ASHTABULA					
STREET NAME						
SECTION IDENTIFICATION	0.00			2.57		
SECTION LENGTH	2.57			12.45		
SURFACE TYPE & WIDTH	G20'			G20'		
BASE TYPE & WIDTH	P16',L4'			P16',L4'		
YEAR				2000		
PROJECT NUMBER				543		

STATE OF OHIO - DEPARTMENT OF TRANSPORTATION

STATE ROUTE SECTIONS ON CONTINUOUS MILEAGE STATIONING

DISTRICT 4
 COUNTY ASHTABULA
 ROUTE SR 46

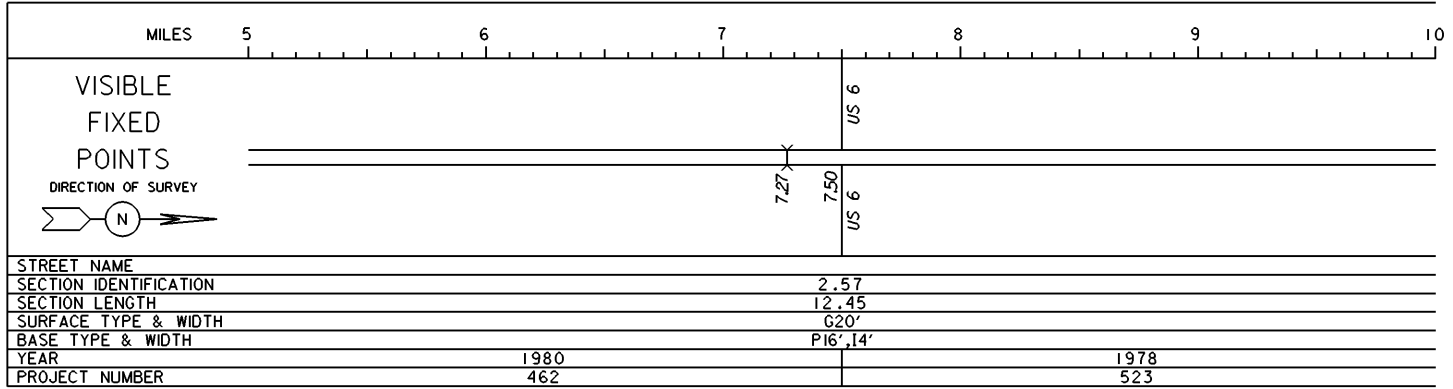

PERPETUATION

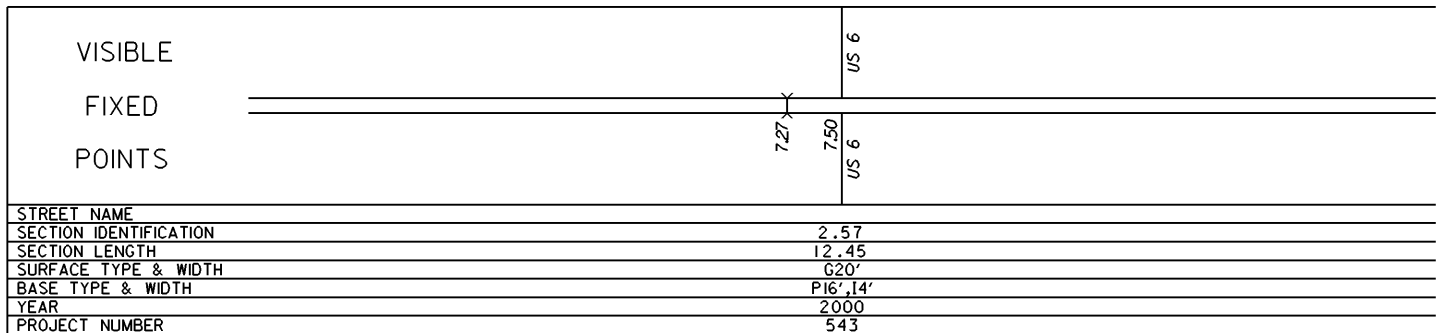
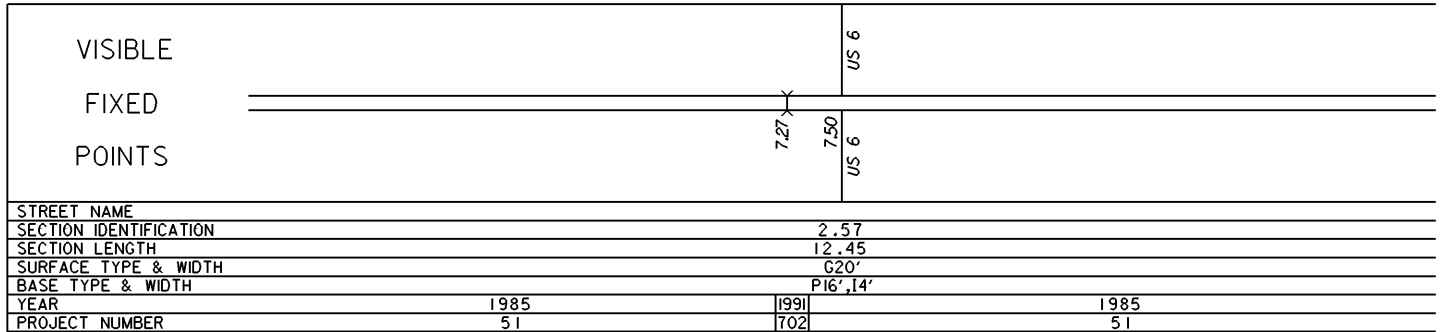

STATE OF OHIO - DEPARTMENT OF TRANSPORTATION
STATE ROUTE SECTIONS ON CONTINUOUS MILEAGE STATIONING

DISTRICT 4
COUNTY ASHTABULA
ROUTE SR 46



VISIBLE
FIXED
POINTS

DIRECTION OF SURVEY



=====

=====

STREET NAME	
SECTION IDENTIFICATION	2.57
SECTION LENGTH	12.45
SURFACE TYPE & WIDTH	G20'
BASE TYPE & WIDTH	P16',14'
YEAR	1978
PROJECT NUMBER	523

PERPETUATION

VISIBLE
FIXED
POINTS

=====

STREET NAME	
SECTION IDENTIFICATION	2.57
SECTION LENGTH	12.45
SURFACE TYPE & WIDTH	G20'
BASE TYPE & WIDTH	P16',14'
YEAR	1985
PROJECT NUMBER	51

VISIBLE
FIXED
POINTS

=====

STREET NAME	
SECTION IDENTIFICATION	2.57
SECTION LENGTH	12.45
SURFACE TYPE & WIDTH	G20'
BASE TYPE & WIDTH	P16',14'
YEAR	2000
PROJECT NUMBER	543

STATE OF OHIO - DEPARTMENT OF TRANSPORTATION
STATE ROUTE SECTIONS ON CONTINUOUS MILEAGE STATIONING

DISTRICT 4
COUNTY ASHTABULA
ROUTE SR 46

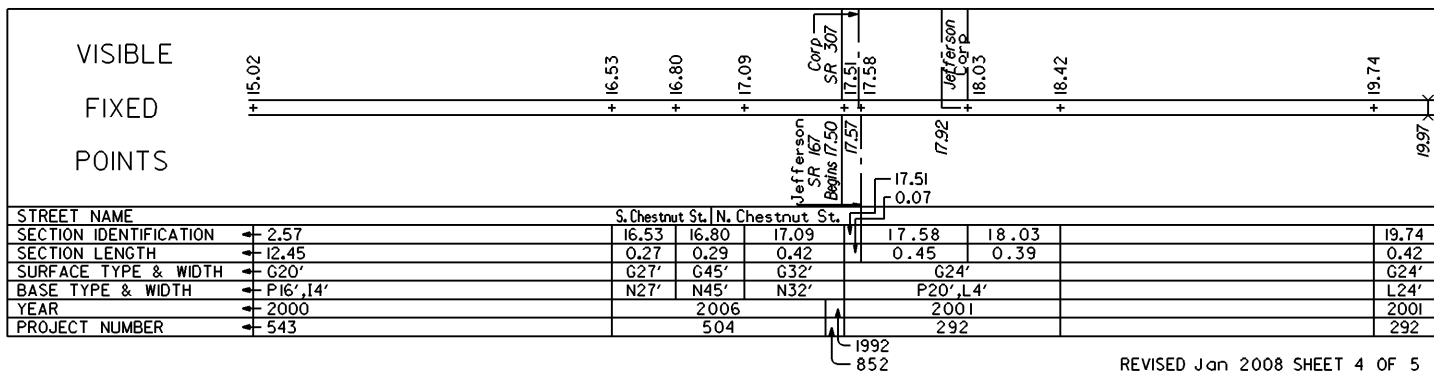
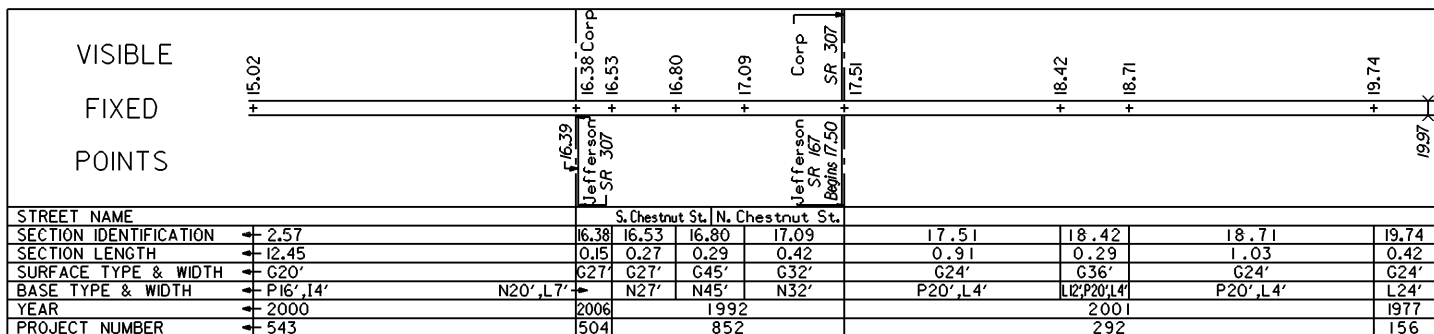
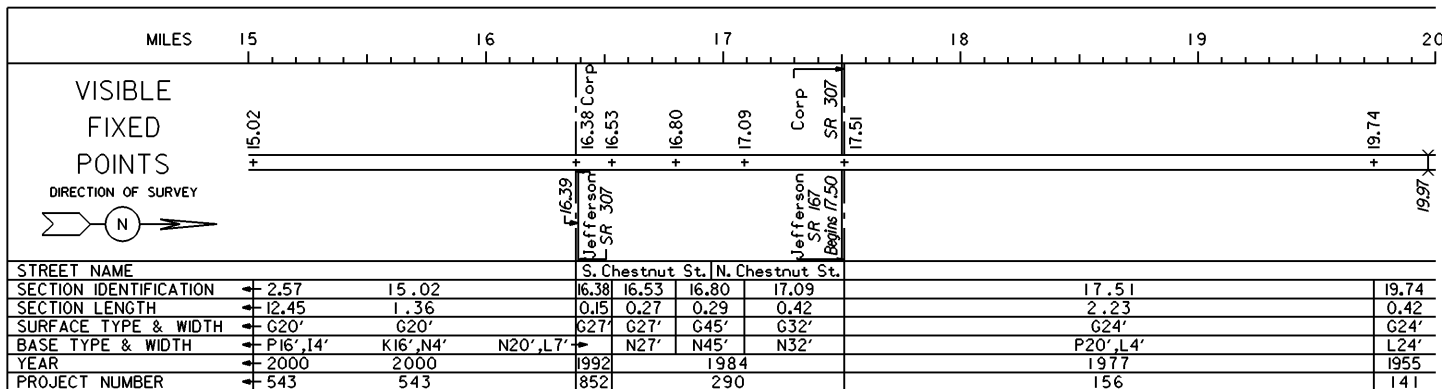

STATE OF OHIO - DEPARTMENT OF TRANSPORTATION
STATE ROUTE SECTIONS ON CONTINUOUS MILEAGE STATIONING

DISTRICT 4
COUNTY ASHTABULA
ROUTE SR 46

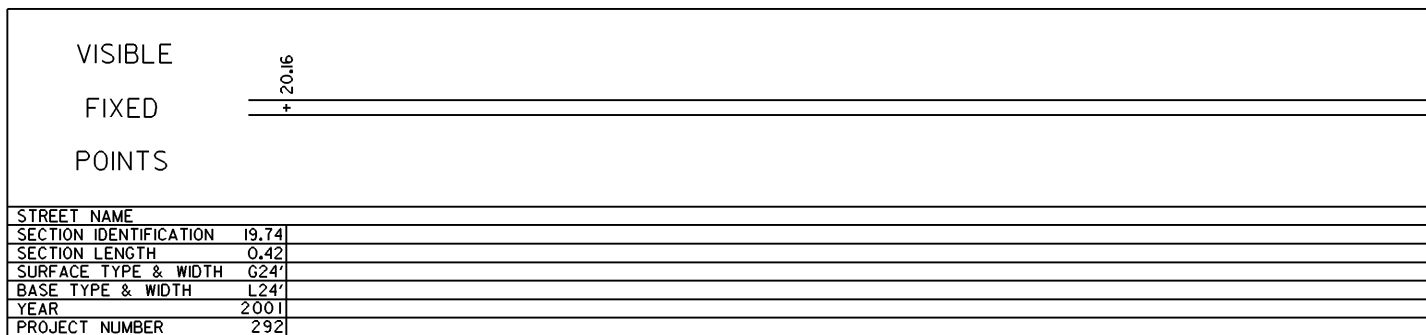
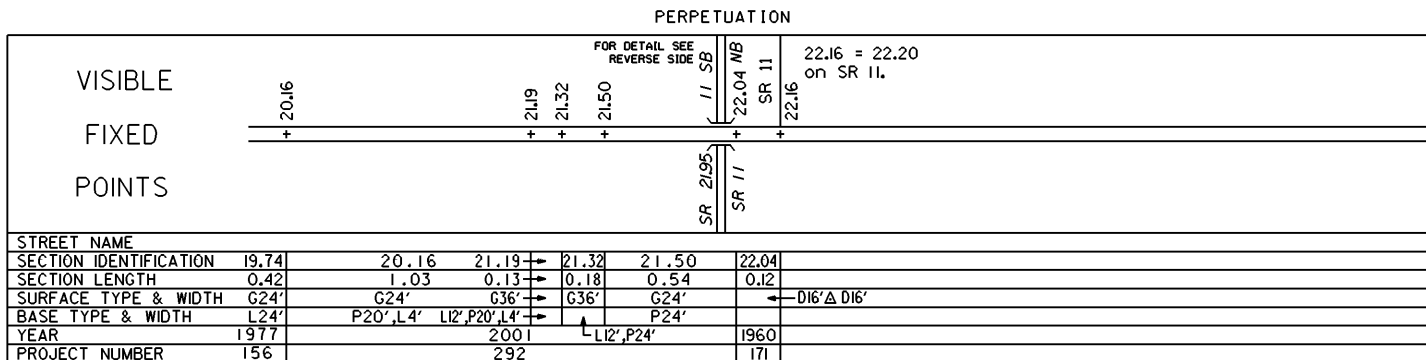
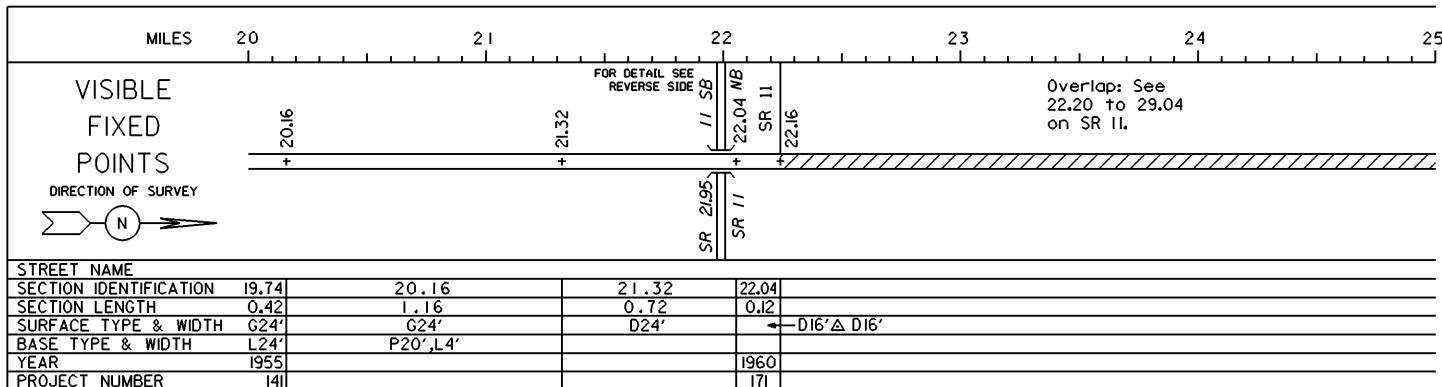

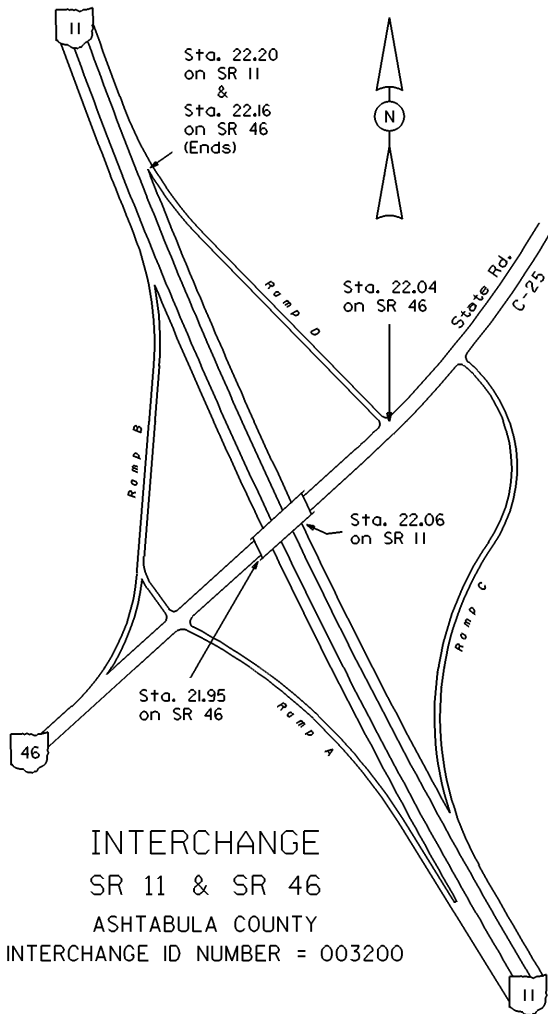

INTERCHANGE
 SR 11 & SR 46
 ASHTABULA COUNTY
 INTERCHANGE ID NUMBER = 003200

SR 11 SHEET 5 OF 6
 SR 46 SHEET 5 OF 5

REVISED Jan 2008