

# STATE OF OHIO - DEPARTMENT OF TRANSPORTATION

STATE ROUTE SECTIONS ON CONTINUOUS MILEAGE STATIONING

DISTRICT	4
COUNTY	ASHTABULA
ROUTE	SR 84

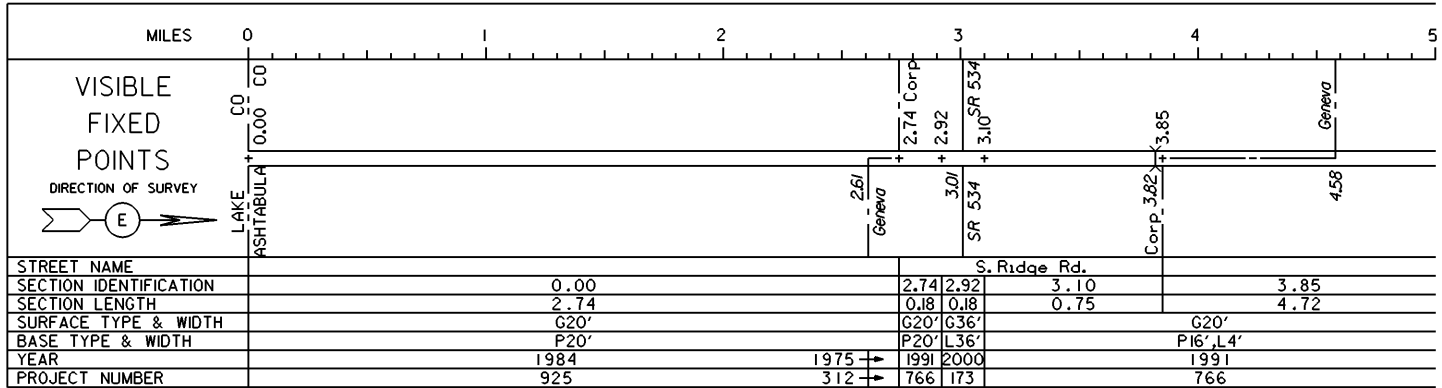

### PERPETUATION

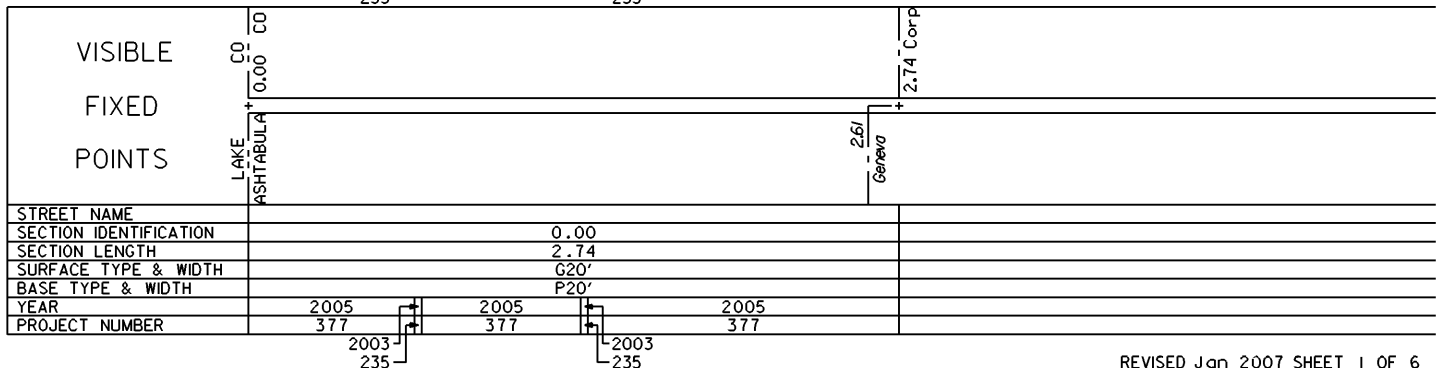
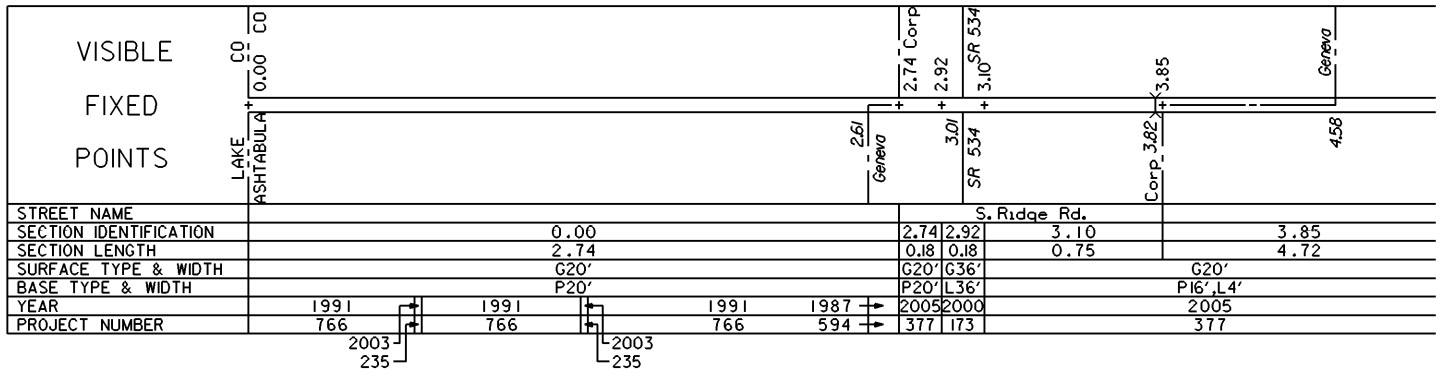

STATE OF OHIO - DEPARTMENT OF TRANSPORTATION  
STATE ROUTE SECTIONS ON CONTINUOUS MILEAGE STATIONING

DISTRICT 4  
COUNTY ASHTABULA  
ROUTE SR 84

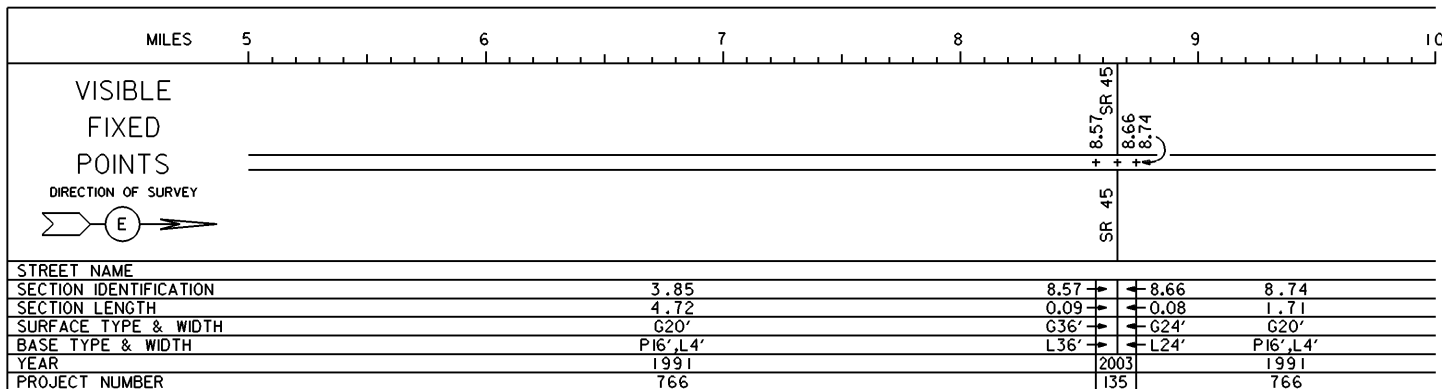

PERPETUATION

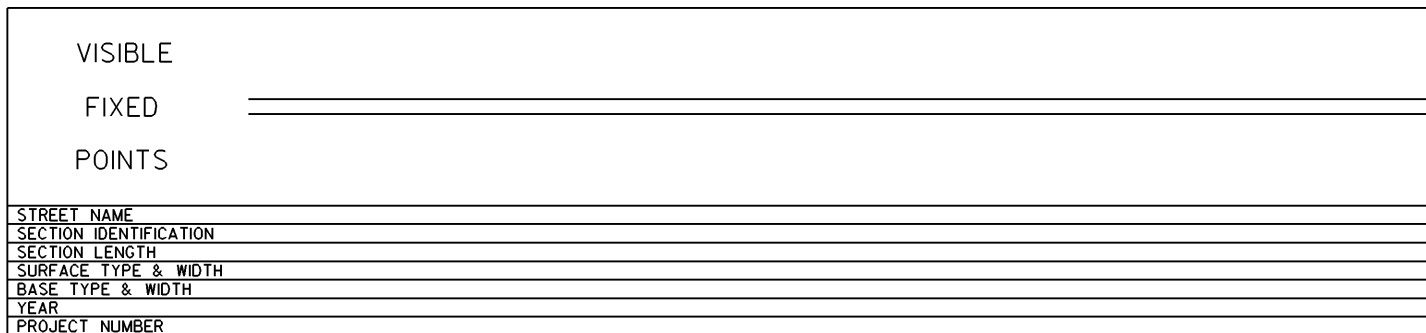
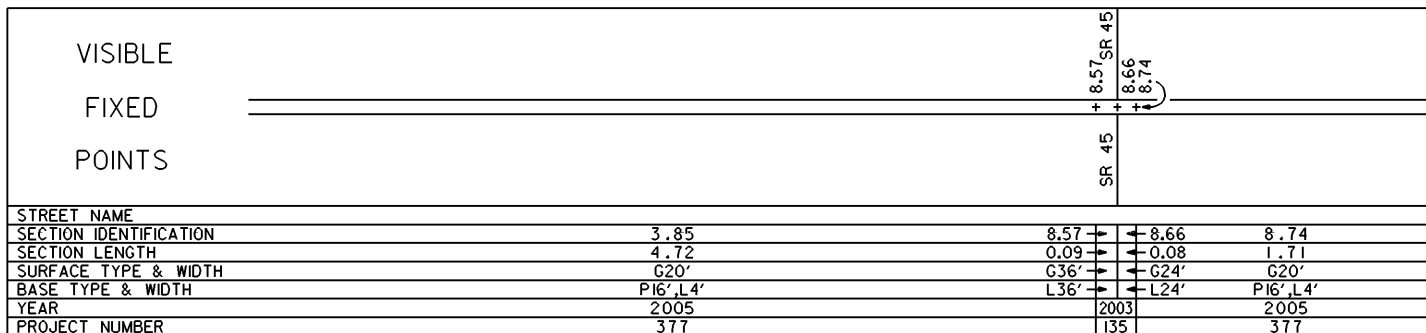

STATE OF OHIO - DEPARTMENT OF TRANSPORTATION  
STATE ROUTE SECTIONS ON CONTINUOUS MILEAGE STATIONING

DISTRICT 4  
COUNTY ASHTABULA  
ROUTE SR 84

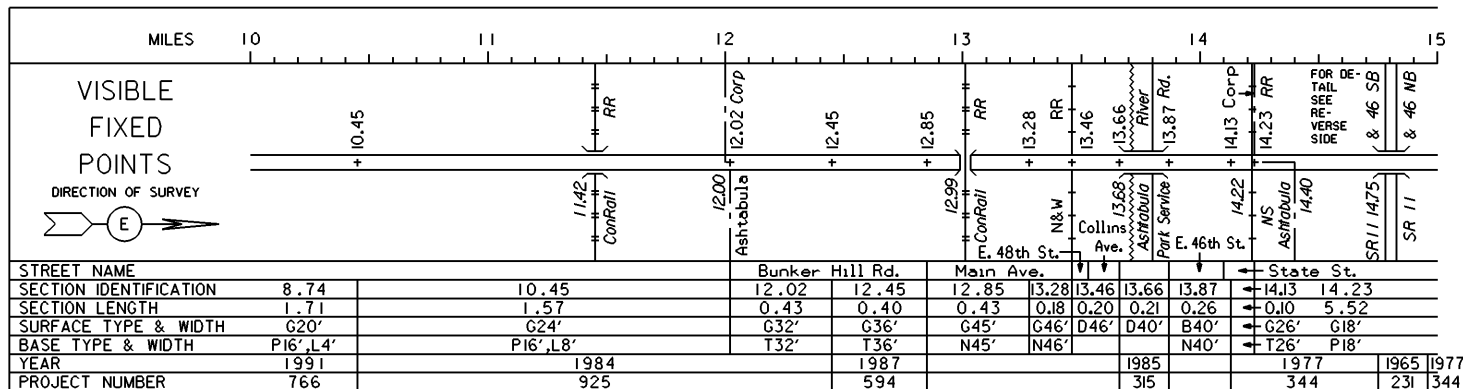

PERPETUATION

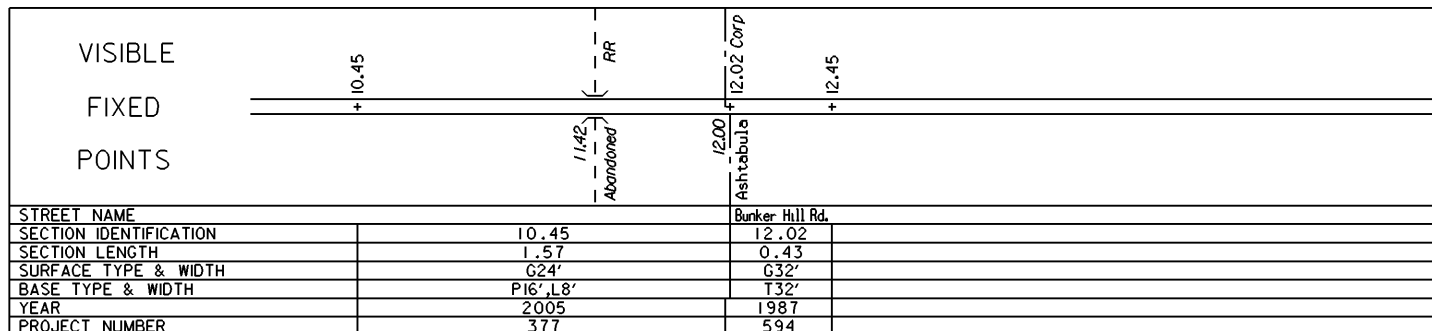
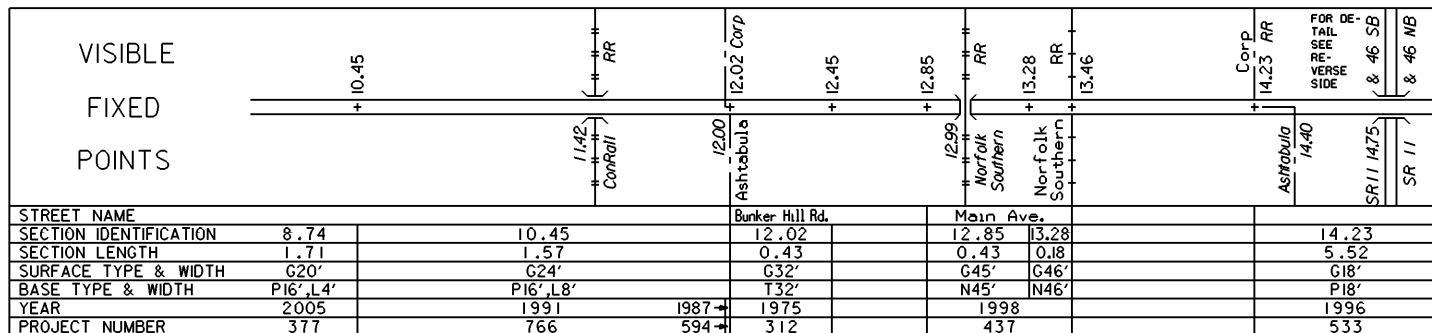

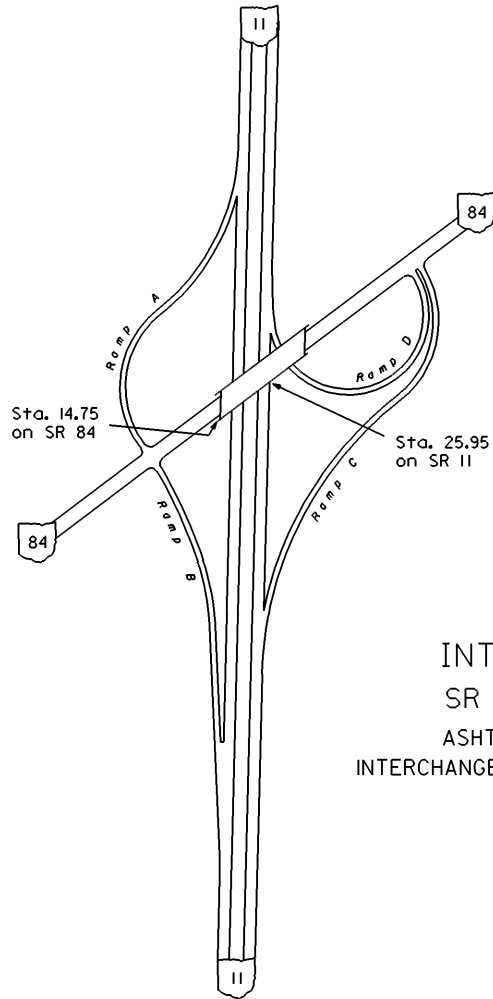

INTERCHANGE  
SR 11 & SR 84  
ASHTABULA COUNTY  
INTERCHANGE ID NUMBER = 003400

SR 11 SHEET 6 OF 6  
SR 84 SHEET 3 OF 6

REVISED Jan 2008

STATE OF OHIO - DEPARTMENT OF TRANSPORTATION  
STATE ROUTE SECTIONS ON CONTINUOUS MILEAGE STATIONING

DISTRICT 4  
COUNTY ASHTABULA  
ROUTE SR 84

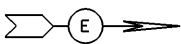
MILES	15	16	17	18	19	20
VISIBLE FIXED POINTS  DIRECTION OF SURVEY 						SR 193 19.75 +
STREET NAME						
SECTION IDENTIFICATION		14.23				19.75
SECTION LENGTH		5.52				0.53
SURFACE TYPE & WIDTH		G18'				G24'
BASE TYPE & WIDTH		P18'				T16',L8'
YEAR		1977				1993
PROJECT NUMBER		344				318

PERPETUATION

VISIBLE  FIXED  POINTS						SR 193 19.75 +
STREET NAME						
SECTION IDENTIFICATION		14.23				19.75
SECTION LENGTH		5.52				0.53
SURFACE TYPE & WIDTH		G18'				G24'
BASE TYPE & WIDTH		P18'				T16',L8'
YEAR		1996				2008
PROJECT NUMBER		533				103

VISIBLE  FIXED  POINTS					
STREET NAME					
SECTION IDENTIFICATION					
SECTION LENGTH					
SURFACE TYPE & WIDTH					
BASE TYPE & WIDTH					
YEAR					
PROJECT NUMBER					

STATE OF OHIO - DEPARTMENT OF TRANSPORTATION  
STATE ROUTE SECTIONS ON CONTINUOUS MILEAGE STATIONING

DISTRICT 4  
COUNTY ASHTABULA  
ROUTE SR 84

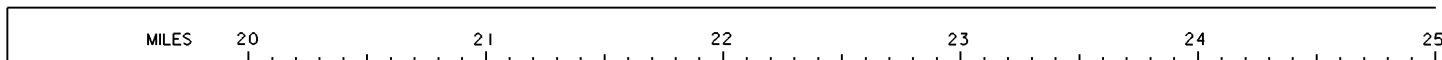

VISIBLE  
FIXED  
POINTS

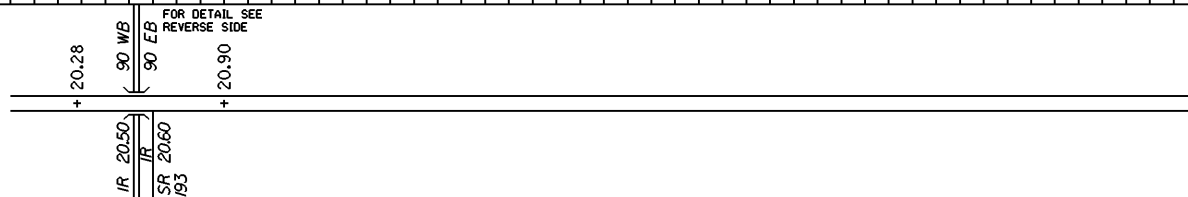
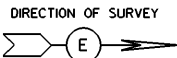

STREET NAME			
SECTION IDENTIFICATION	19.75	20.28	20.90
SECTION LENGTH	0.53	0.62	5.29
SURFACE TYPE & WIDTH	G24'	G24'	G20'
BASE TYPE & WIDTH	T16',L8'	I24'	L20'
YEAR	1993		
PROJECT NUMBER	318		

PERPETUATION

VISIBLE  
FIXED  
POINTS

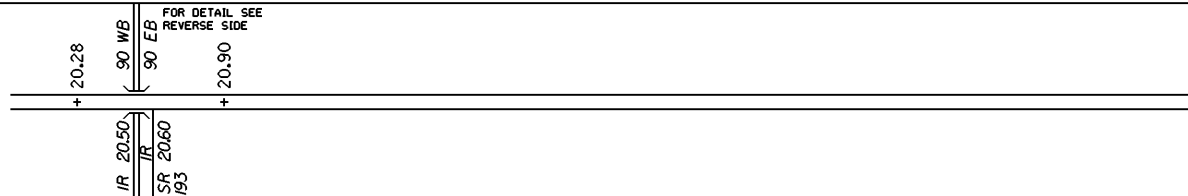

STREET NAME			
SECTION IDENTIFICATION	19.75	20.28	20.90
SECTION LENGTH	0.53	0.62	5.29
SURFACE TYPE & WIDTH	G24'	G24'	G20'
BASE TYPE & WIDTH	T16',L8'	I24'	L20'
YEAR	2008		
PROJECT NUMBER	103		

VISIBLE  
FIXED  
POINTS

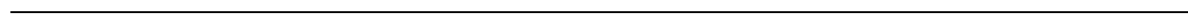

STREET NAME			
SECTION IDENTIFICATION			
SECTION LENGTH			
SURFACE TYPE & WIDTH			
BASE TYPE & WIDTH			
YEAR			
PROJECT NUMBER			

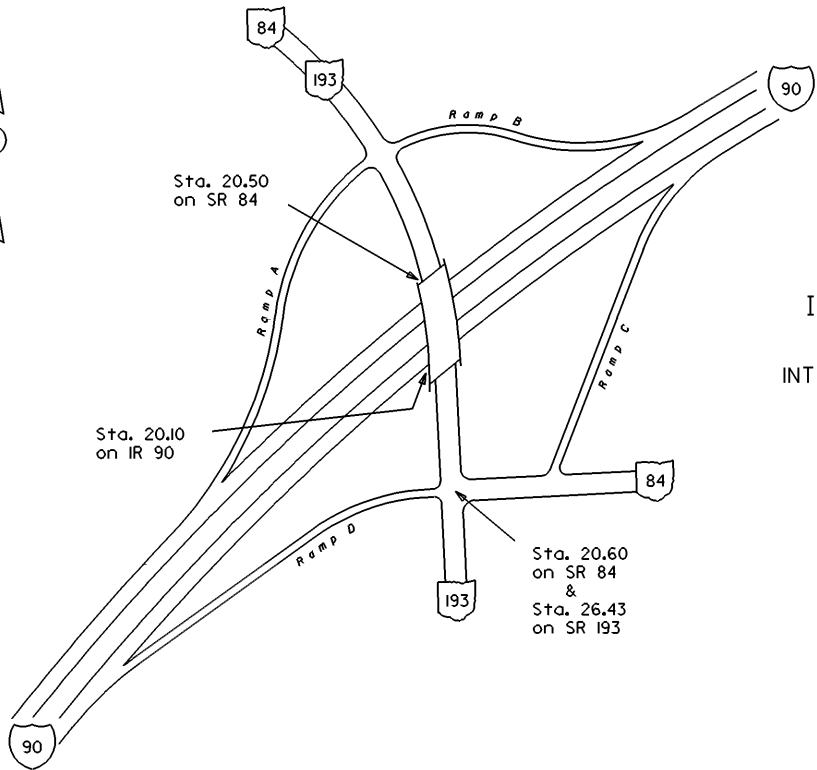

INTERCHANGE  
IR 90 & SRs 84 & 193  
ASHTABULA COUNTY  
INTERCHANGE ID NUMBER = 002500

STATE OF OHIO - DEPARTMENT OF TRANSPORTATION  
STATE ROUTE SECTIONS ON CONTINUOUS MILEAGE STATIONING

DISTRICT 4  
COUNTY ASHTABULA  
ROUTE SR 84

	MILES 25	26	27	28	29	30
VISIBLE FIXED POINTS  DIRECTION OF SURVEY 	25.82 SR 7 25.98	SR 7 26.19				
CO LINE OHIO PENNA. + 28.56 LINE						
STREET NAME						
SECTION IDENTIFICATION		20.90			26.19	
SECTION LENGTH		5.29			2.37	
SURFACE TYPE & WIDTH		G20'			G20'	
BASE TYPE & WIDTH		L20'			I20'	
YEAR				1993		
PROJECT NUMBER				318		

PERPETUATION

	MILES 25	26	27	28	29	30
VISIBLE FIXED POINTS	25.82 SR 7 25.98	SR 7 26.19				
CO LINE OHIO PENNA. + 28.56 LINE						
STREET NAME						
SECTION IDENTIFICATION		20.90			26.19	
SECTION LENGTH		5.29			2.37	
SURFACE TYPE & WIDTH		G20'			G20'	
BASE TYPE & WIDTH		L20'			I20'	
YEAR				2008		
PROJECT NUMBER				103		

	MILES 25	26	27	28	29	30
VISIBLE FIXED POINTS						
STREET NAME						
SECTION IDENTIFICATION						
SECTION LENGTH						
SURFACE TYPE & WIDTH						
BASE TYPE & WIDTH						
YEAR						
PROJECT NUMBER						