

STATE OF OHIO - DEPARTMENT OF TRANSPORTATION  
STATE ROUTE SECTIONS ON CONTINUOUS MILEAGE STATIONING

DISTRICT 10  
COUNTY ATHENS  
ROUTE SR 144

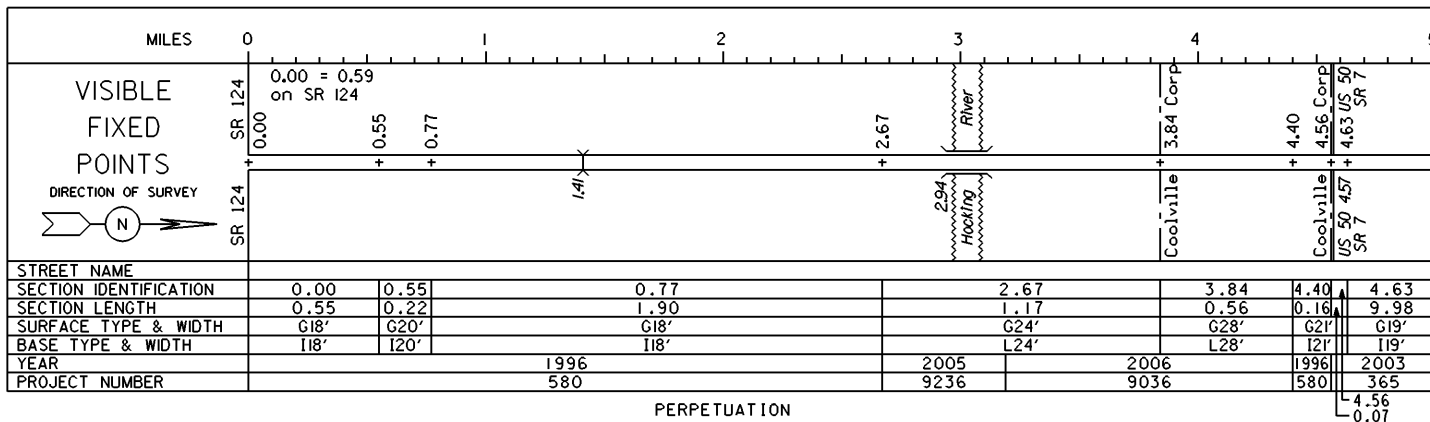

PERPETUATION

VISIBLE  
FIXED  
POINTS

---

STREET NAME  
SECTION IDENTIFICATION  
SECTION LENGTH  
SURFACE TYPE & WIDTH  
BASE TYPE & WIDTH  
YEAR  
PROJECT NUMBER

VISIBLE  
FIXED  
POINTS

---

STREET NAME  
SECTION IDENTIFICATION  
SECTION LENGTH  
SURFACE TYPE & WIDTH  
BASE TYPE & WIDTH  
YEAR  
PROJECT NUMBER

STATE OF OHIO - DEPARTMENT OF TRANSPORTATION

STATE ROUTE SECTIONS ON CONTINUOUS MILEAGE STATIONING

DISTRICT 10  
 COUNTY ATHENS  
 ROUTE SR 144



VISIBLE  
 FIXED  
 POINTS

DIRECTION OF SURVEY

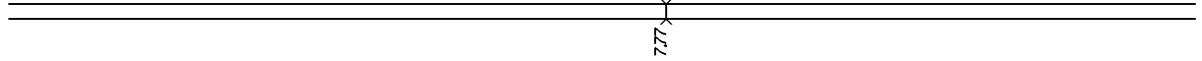

STREET NAME	
SECTION IDENTIFICATION	4.63
SECTION LENGTH	9.98
SURFACE TYPE & WIDTH	G19'
BASE TYPE & WIDTH	I19'
YEAR	2003
PROJECT NUMBER	365

PERPETUATION

VISIBLE  
 FIXED  
 POINTS

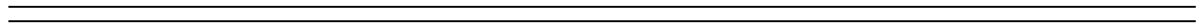

STREET NAME	
SECTION IDENTIFICATION	
SECTION LENGTH	
SURFACE TYPE & WIDTH	
BASE TYPE & WIDTH	
YEAR	
PROJECT NUMBER	

VISIBLE  
 FIXED  
 POINTS

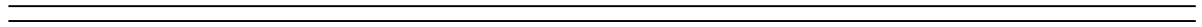

STREET NAME	
SECTION IDENTIFICATION	
SECTION LENGTH	
SURFACE TYPE & WIDTH	
BASE TYPE & WIDTH	
YEAR	
PROJECT NUMBER	

STATE OF OHIO - DEPARTMENT OF TRANSPORTATION  
STATE ROUTE SECTIONS ON CONTINUOUS MILEAGE STATIONING

DISTRICT 10  
COUNTY ATHENS  
ROUTE SR 144

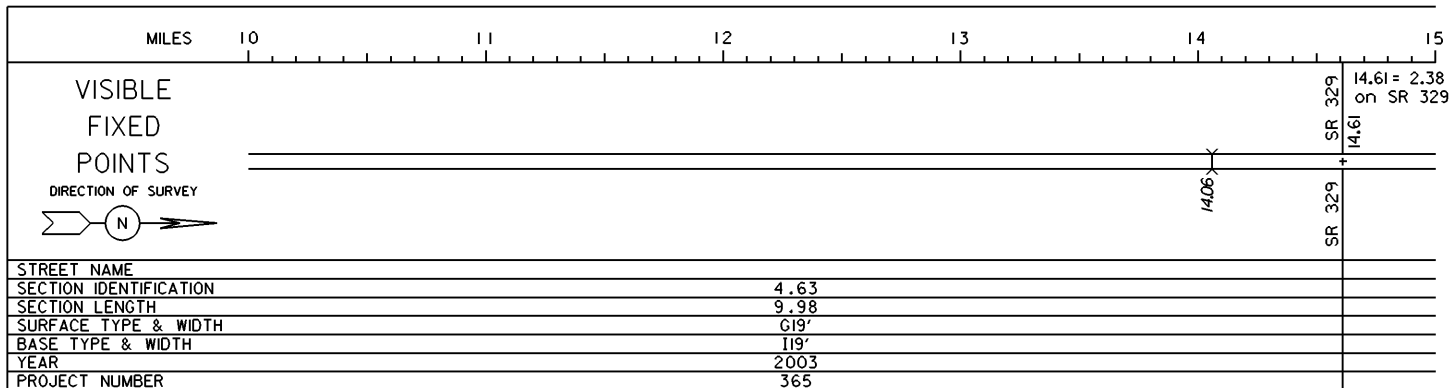

PERPETUATION

