

STATE OF OHIO - DEPARTMENT OF TRANSPORTATION
STATE ROUTE SECTIONS ON CONTINUOUS MILEAGE STATIONING

DISTRICT 7
COUNTY CLARK
ROUTE SR 54

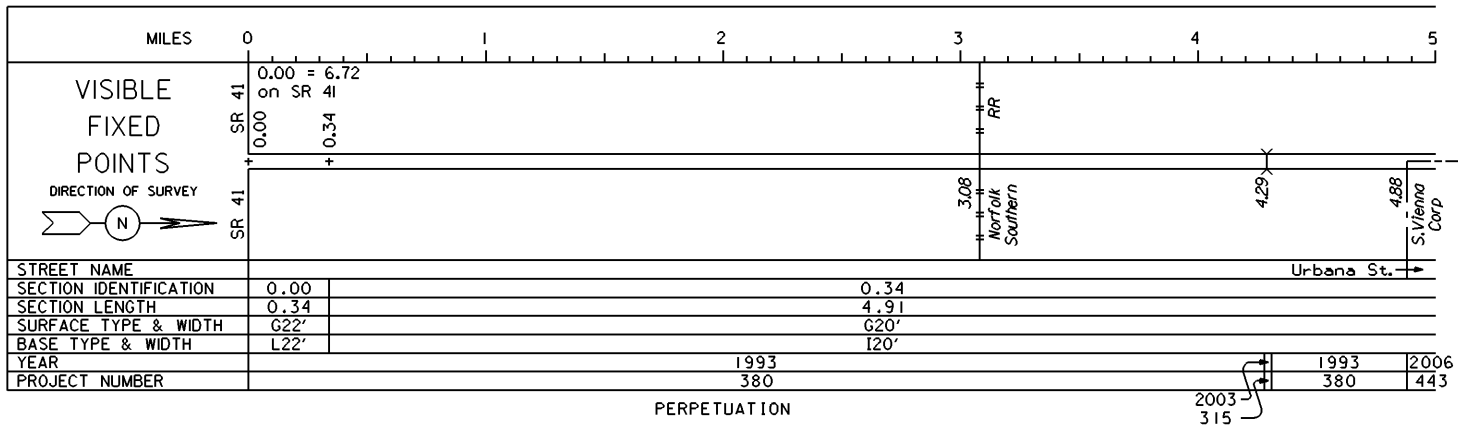

VISIBLE

FIXED _____

POINTS _____

STREET NAME _____

SECTION IDENTIFICATION _____

SECTION LENGTH _____

SURFACE TYPE & WIDTH _____

BASE TYPE & WIDTH _____

YEAR _____

PROJECT NUMBER _____

VISIBLE

FIXED _____

POINTS _____

STREET NAME _____

SECTION IDENTIFICATION _____

SECTION LENGTH _____

SURFACE TYPE & WIDTH _____

BASE TYPE & WIDTH _____

YEAR _____

PROJECT NUMBER _____

STATE OF OHIO - DEPARTMENT OF TRANSPORTATION

STATE ROUTE SECTIONS ON CONTINUOUS MILEAGE STATIONING

DISTRICT	7
COUNTY	CLARK
ROUTE	SR 54

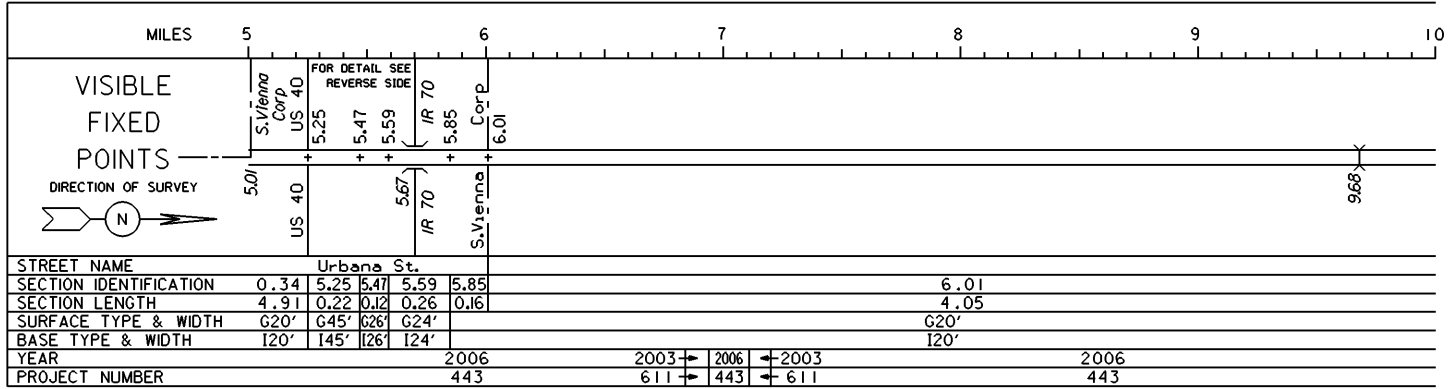

PERPETUATION

VISIBLE

FIXED

POINTS

STREET NAME
SECTION IDENTIFICATION
SECTION LENGTH
SURFACE TYPE & WIDTH
BASE TYPE & WIDTH
YEAR
PROJECT NUMBER

VISIBLE

FIXED

POINTS

STREET NAME
SECTION IDENTIFICATION
SECTION LENGTH
SURFACE TYPE & WIDTH
BASE TYPE & WIDTH
YEAR
PROJECT NUMBER

INTERCHANGE
IR 70 & SR 54
CLARK COUNTY
INTERCHANGE ID NUMBER = 009100

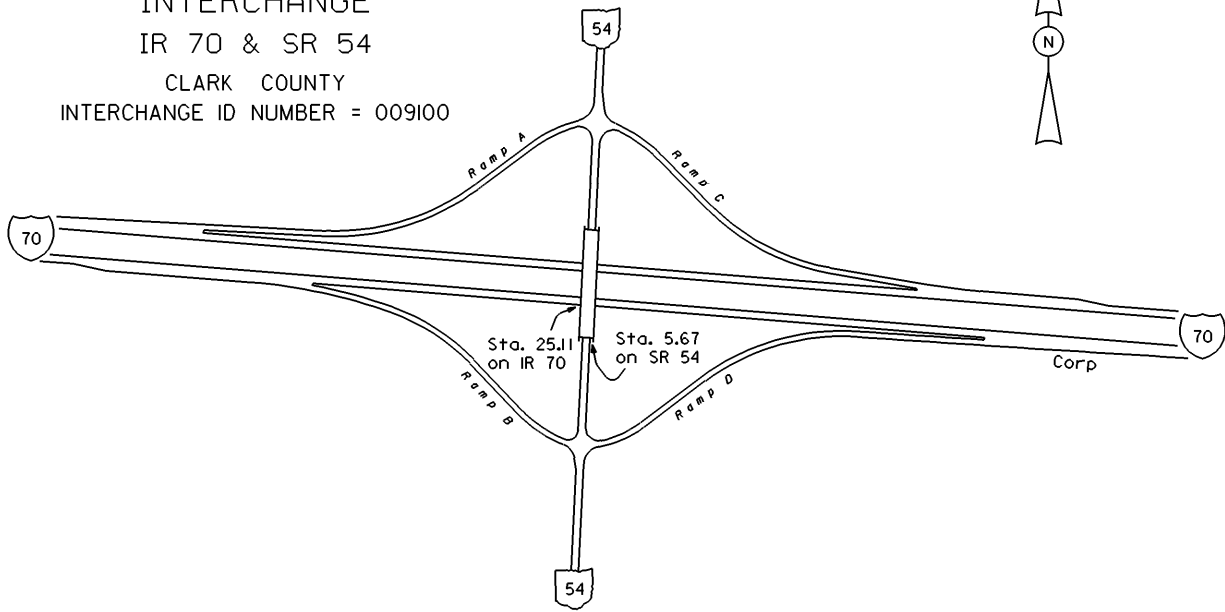

STATE OF OHIO - DEPARTMENT OF TRANSPORTATION

STATE ROUTE SECTIONS ON CONTINUOUS MILEAGE STATIONING

DISTRICT	7
COUNTY	CLARK
ROUTE	SR 54

	MILES	10.00	10.50	11.00	11.50	12.00	12.50
VISIBLE FIXED POINTS DIRECTION OF SURVEY 		+ 10.06 Corp Catawba	+ 10.75 Corp Catawba			+ 11.75 CO CLARK CHAMPAIGN	
STREET NAME		Persimmon St.	Pleasant St.	Champaign St.			
SECTION IDENTIFICATION	6.01		10.06		10.75		
SECTION LENGTH	4.05		0.69		1.00		
SURFACE TYPE & WIDTH				G20'			
BASE TYPE & WIDTH				I20'			
YEAR		2006			2004		
PROJECT NUMBER		443			596		

PERPETUATION

VISIBLE FIXED POINTS	<hr style="border: 1px solid black;"/> <hr style="border: 1px solid black;"/>
STREET NAME SECTION IDENTIFICATION SECTION LENGTH SURFACE TYPE & WIDTH BASE TYPE & WIDTH YEAR PROJECT NUMBER	

VISIBLE FIXED POINTS	<hr style="border: 1px solid black;"/> <hr style="border: 1px solid black;"/>
STREET NAME SECTION IDENTIFICATION SECTION LENGTH SURFACE TYPE & WIDTH BASE TYPE & WIDTH YEAR PROJECT NUMBER	