

# STATE OF OHIO - DEPARTMENT OF TRANSPORTATION

STATE ROUTE SECTIONS ON CONTINUOUS MILEAGE STATIONING

DISTRICT	7
COUNTY	CLARK
ROUTE	SR 72

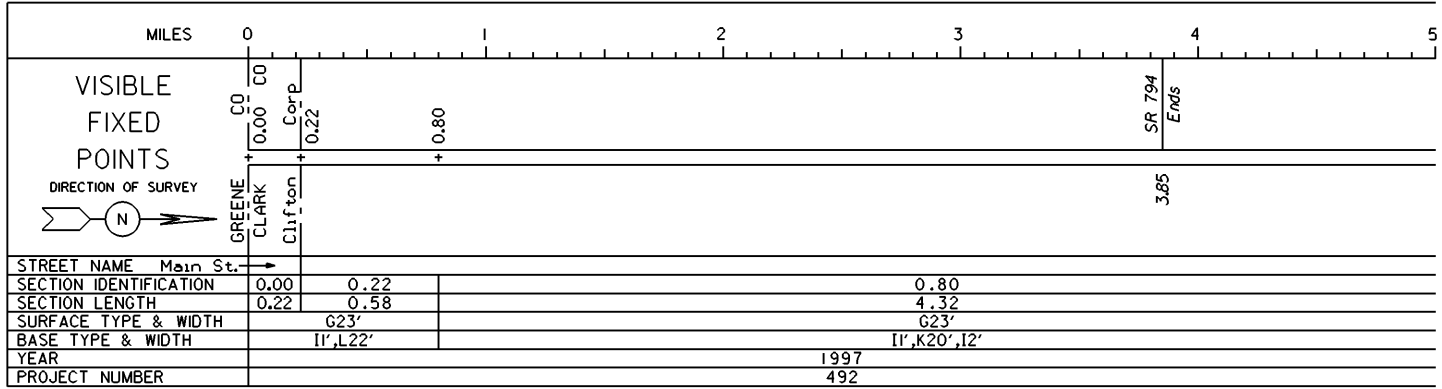

### PERPETUATION

VISIBLE	
FIXED	
POINTS	
STREET NAME	
SECTION IDENTIFICATION	
SECTION LENGTH	
SURFACE TYPE & WIDTH	
BASE TYPE & WIDTH	
YEAR	
PROJECT NUMBER	

VISIBLE	
FIXED	
POINTS	
STREET NAME	
SECTION IDENTIFICATION	
SECTION LENGTH	
SURFACE TYPE & WIDTH	
BASE TYPE & WIDTH	
YEAR	
PROJECT NUMBER	

STATE OF OHIO - DEPARTMENT OF TRANSPORTATION  
STATE ROUTE SECTIONS ON CONTINUOUS MILEAGE STATIONING

DISTRICT 7  
COUNTY CLARK  
ROUTE SR 72

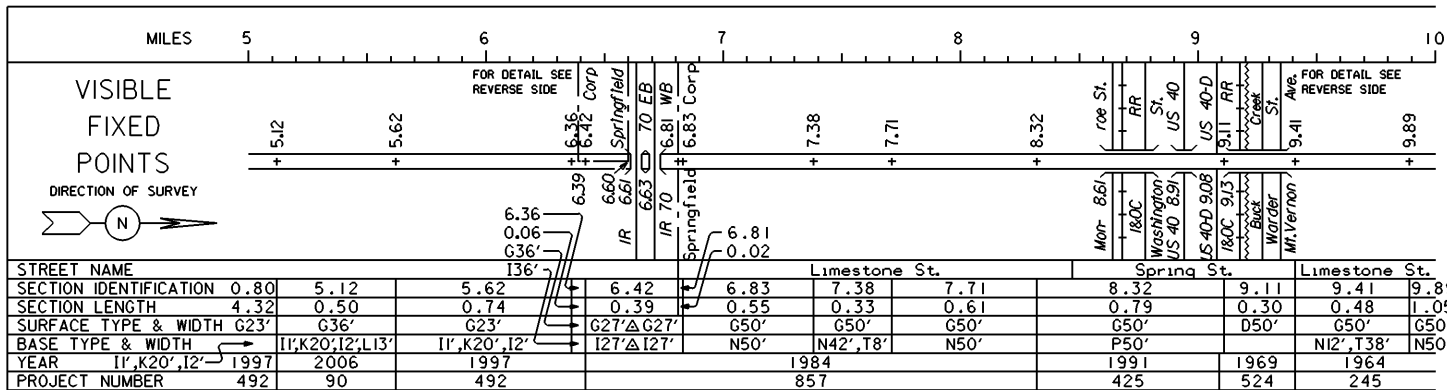

PERPETUATION

VISIBLE  
FIXED  
POINTS

\_\_\_\_\_

\_\_\_\_\_

STREET NAME	
SECTION IDENTIFICATION	
SECTION LENGTH	
SURFACE TYPE & WIDTH	
BASE TYPE & WIDTH	
YEAR	
PROJECT NUMBER	

VISIBLE  
FIXED  
POINTS

\_\_\_\_\_

\_\_\_\_\_

STREET NAME	
SECTION IDENTIFICATION	
SECTION LENGTH	
SURFACE TYPE & WIDTH	
BASE TYPE & WIDTH	
YEAR	
PROJECT NUMBER	

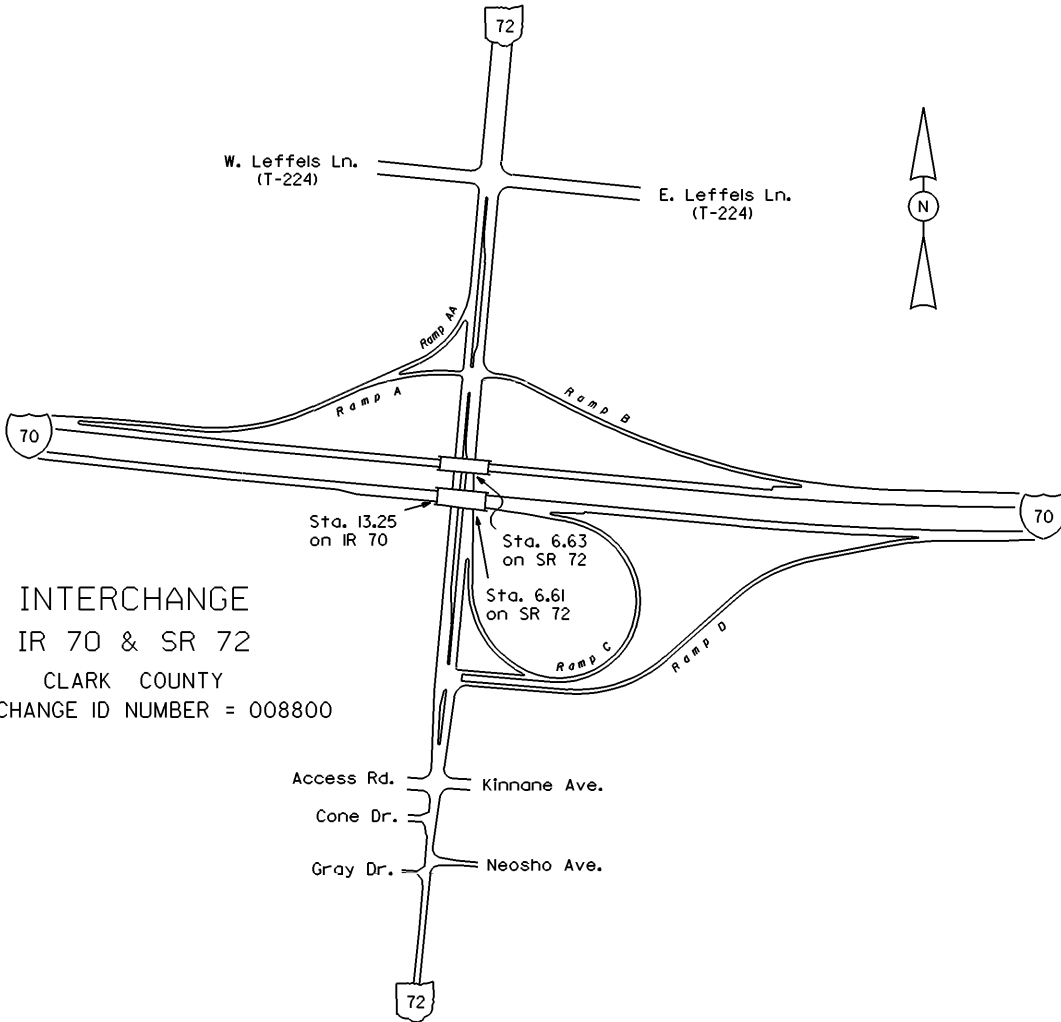

INTERCHANGE  
 IR 70 & SR 72  
 CLARK COUNTY  
 INTERCHANGE ID NUMBER = 008800



INTERCHANGE  
SR 72 & Mt. Vernon Ave.  
CLARK COUNTY  
INTERCHANGE ID NUMBER = 010100

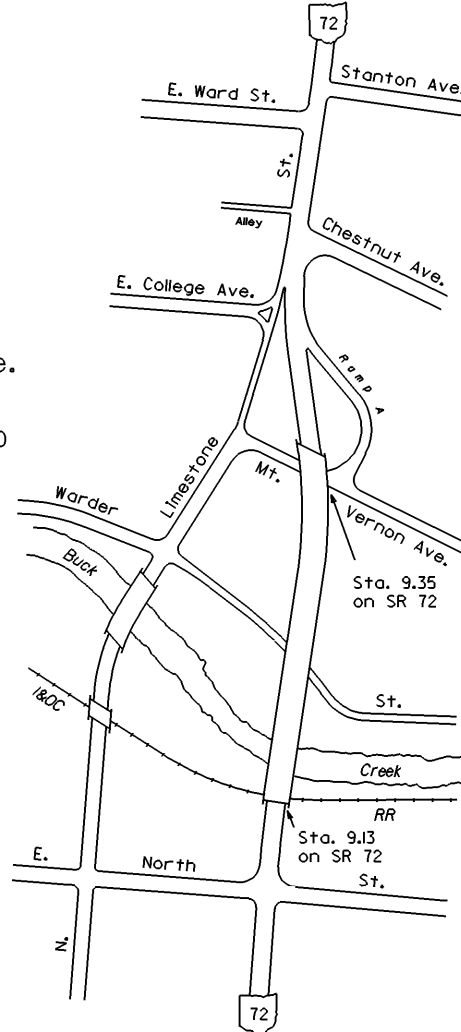

STATE OF OHIO - DEPARTMENT OF TRANSPORTATION  
STATE ROUTE SECTIONS ON CONTINUOUS MILEAGE STATIONING

DISTRICT 7  
COUNTY CLARK  
ROUTE SR 72

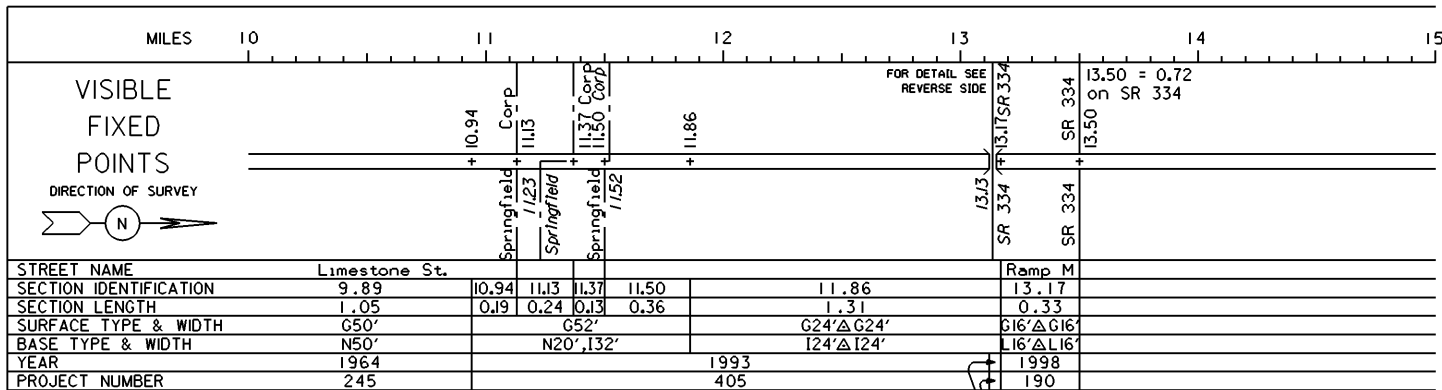

PERPETUATION

1984  
423

VISIBLE  
FIXED  
POINTS

STREET NAME
SECTION IDENTIFICATION
SECTION LENGTH
SURFACE TYPE & WIDTH
BASE TYPE & WIDTH
YEAR
PROJECT NUMBER

VISIBLE  
FIXED  
POINTS

STREET NAME
SECTION IDENTIFICATION
SECTION LENGTH
SURFACE TYPE & WIDTH
BASE TYPE & WIDTH
YEAR
PROJECT NUMBER



INTERCHANGE  
SR 72, SR 334 & CR 68  
CLARK COUNTY  
INTERCHANGE ID NUMBER = 009900

