

STATE OF OHIO - DEPARTMENT OF TRANSPORTATION

STATE ROUTE SECTIONS ON CONTINUOUS MILEAGE STATIONING

DISTRICT 12
 COUNTY LAKE
 ROUTE SR 640

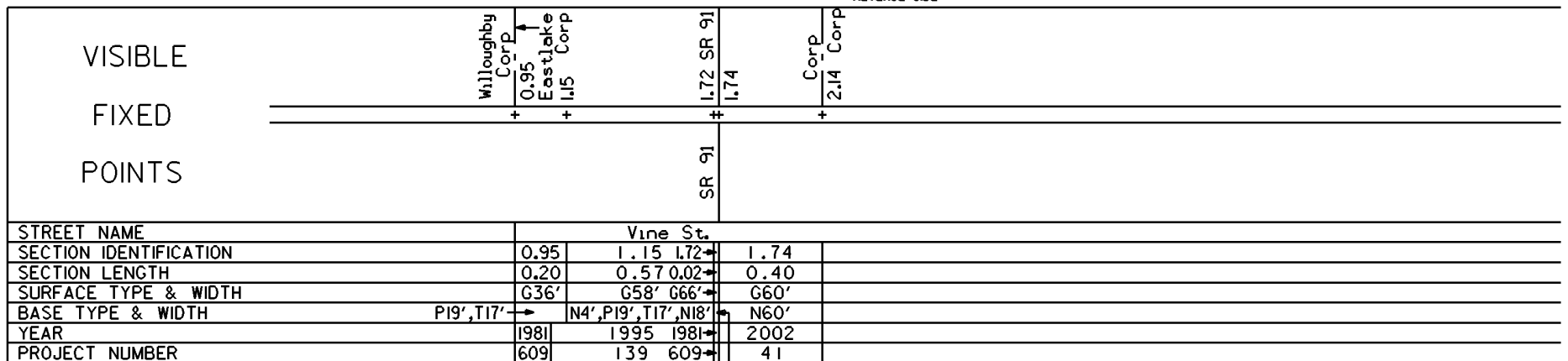
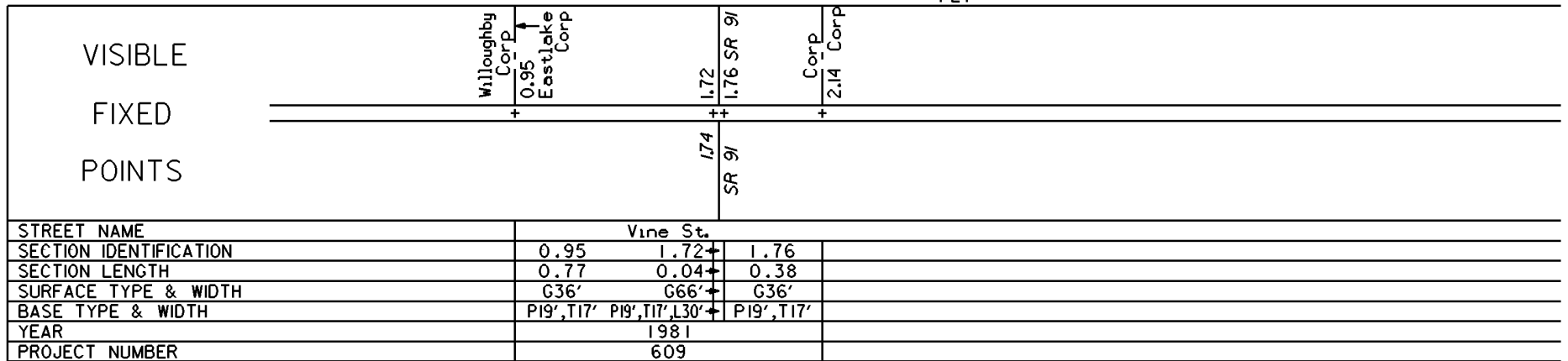
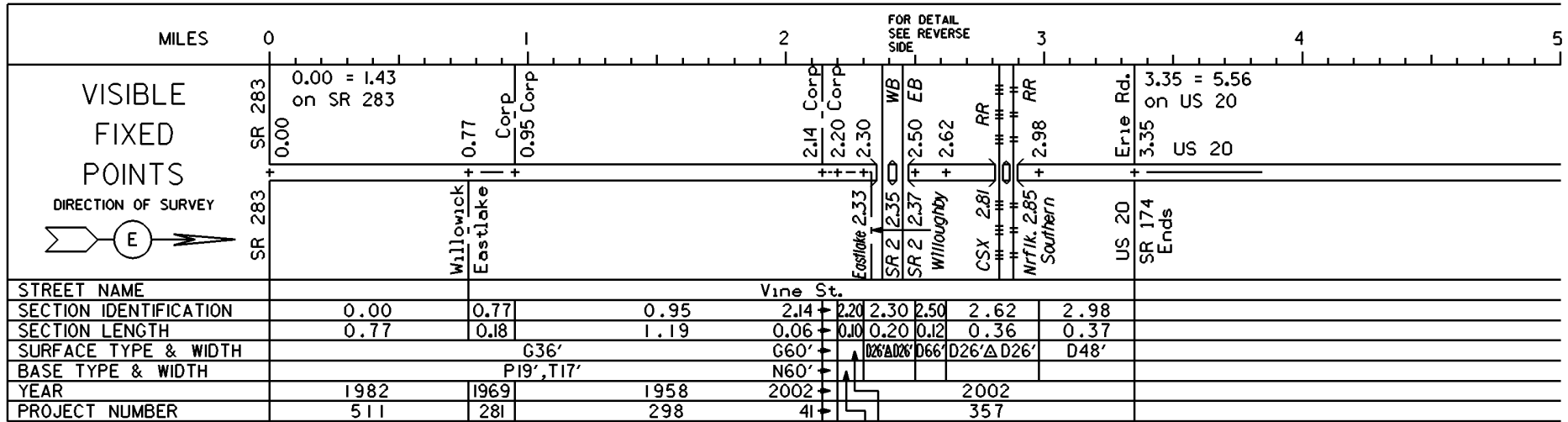

P19',T17',L30'

INTERCHANGE
SR 2 & SR 640
LAKE COUNTY

INTERCHANGE ID NUMBER = 053100

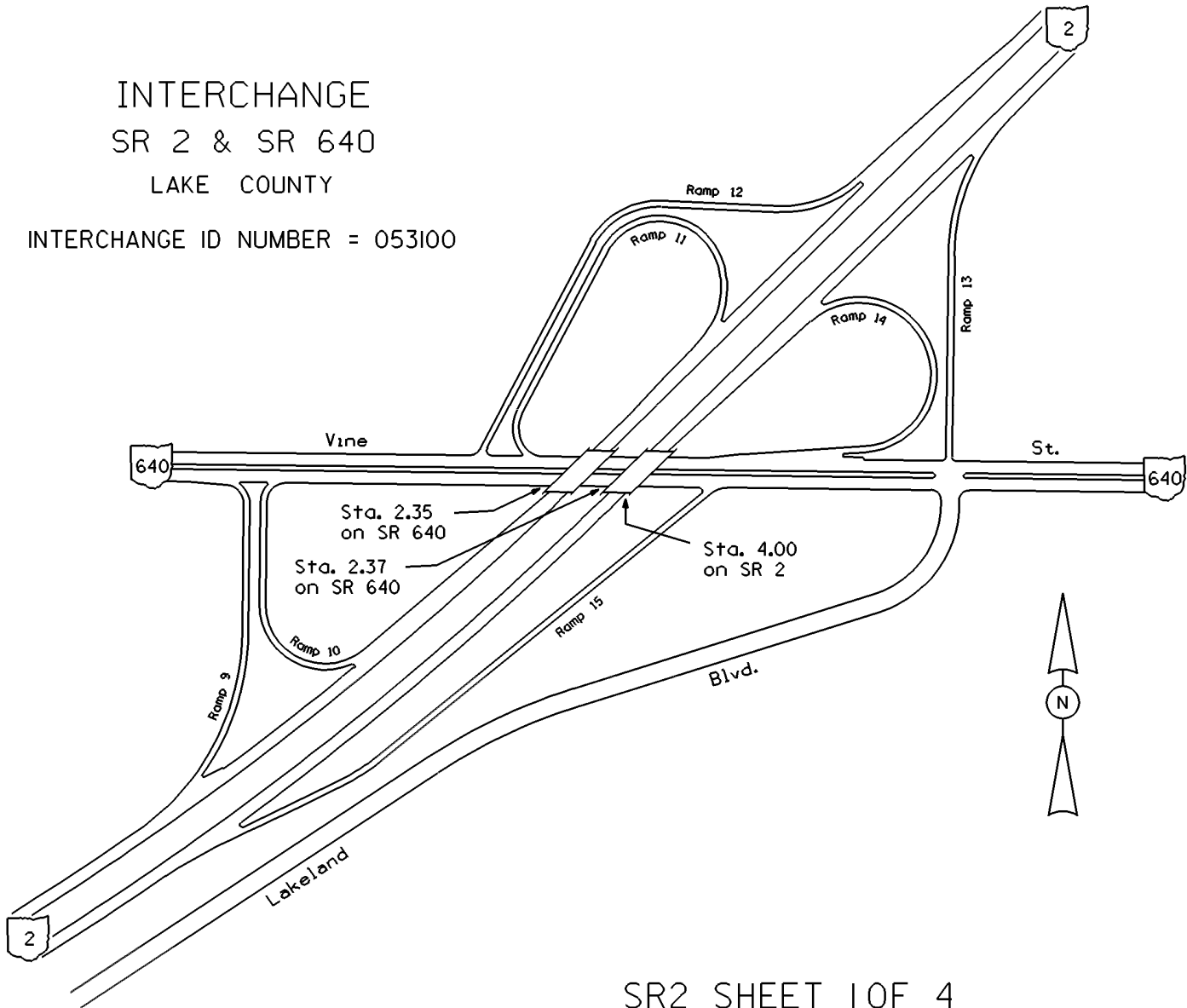

SR2 SHEET 1 OF 4
SR640 SHEET 1 OF 1