

STATE OF OHIO - DEPARTMENT OF TRANSPORTATION

STATE ROUTE SECTIONS ON CONTINUOUS MILEAGE STATIONING

DISTRICT 7  
 COUNTY LOGAN  
 ROUTE SR 638

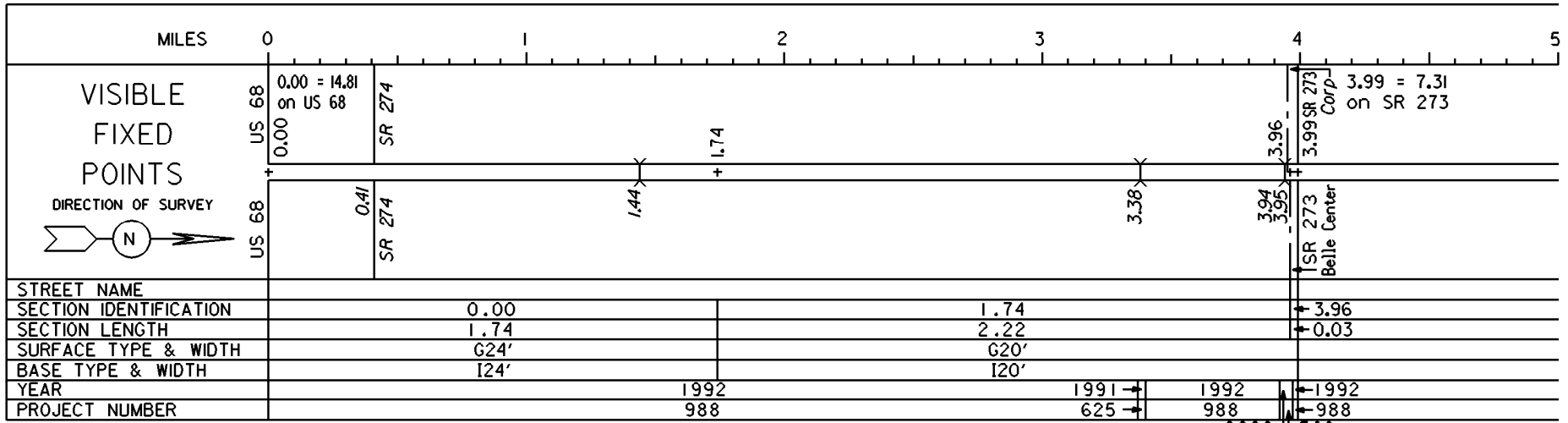

PERPETUATION

VISIBLE  
 FIXED  
 POINTS

---

STREET NAME  
 SECTION IDENTIFICATION  
 SECTION LENGTH  
 SURFACE TYPE & WIDTH  
 BASE TYPE & WIDTH  
 YEAR  
 PROJECT NUMBER

VISIBLE  
 FIXED  
 POINTS

---

STREET NAME  
 SECTION IDENTIFICATION  
 SECTION LENGTH  
 SURFACE TYPE & WIDTH  
 BASE TYPE & WIDTH  
 YEAR  
 PROJECT NUMBER