

STATE OF OHIO - DEPARTMENT OF TRANSPORTATION

STATE ROUTE SECTIONS ON CONTINUOUS MILEAGE STATIONING

DISTRICT 3  
 COUNTY LORAIN  
 ROUTE SR 58

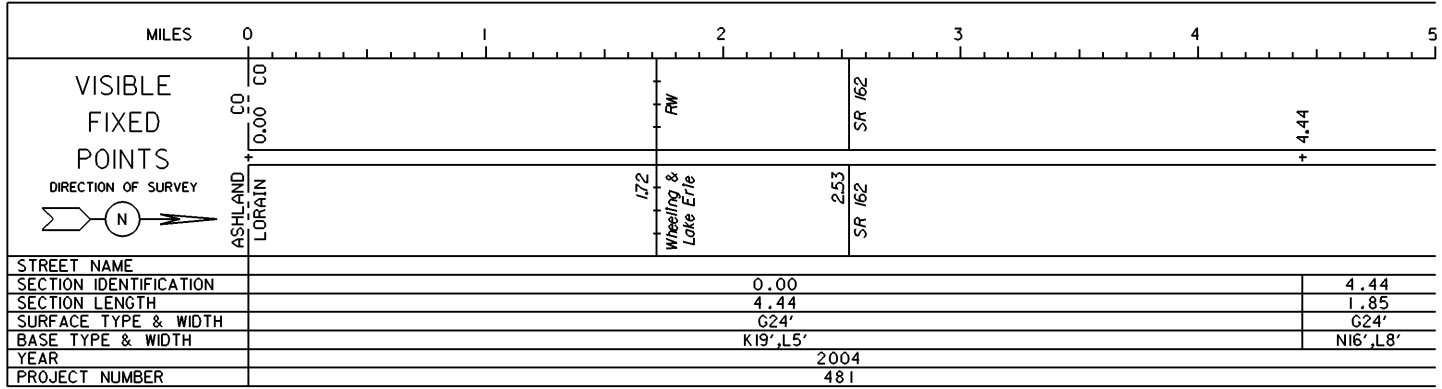

PERPETUATION

VISIBLE  
 FIXED  
 POINTS

---

STREET NAME  
 SECTION IDENTIFICATION  
 SECTION LENGTH  
 SURFACE TYPE & WIDTH  
 BASE TYPE & WIDTH  
 YEAR  
 PROJECT NUMBER

VISIBLE  
 FIXED  
 POINTS

---

STREET NAME  
 SECTION IDENTIFICATION  
 SECTION LENGTH  
 SURFACE TYPE & WIDTH  
 BASE TYPE & WIDTH  
 YEAR  
 PROJECT NUMBER

# STATE OF OHIO - DEPARTMENT OF TRANSPORTATION

STATE ROUTE SECTIONS ON CONTINUOUS MILEAGE STATIONING

DISTRICT	3
COUNTY	LORAIN
ROUTE	SR 58

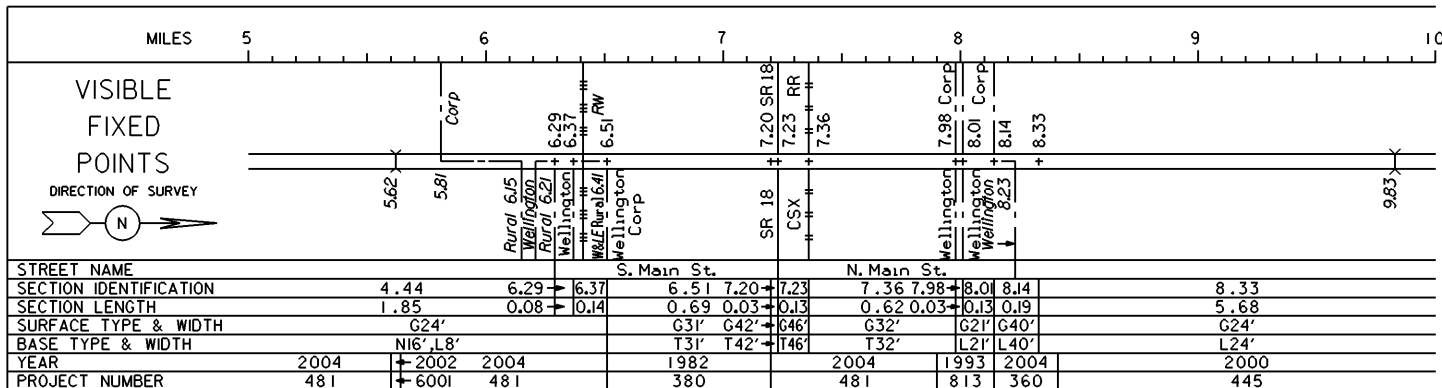

### PERPETUATION

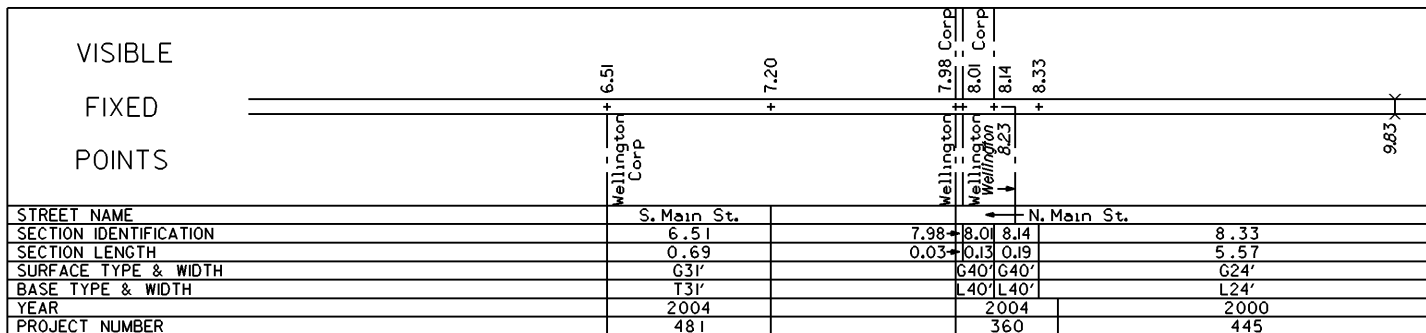
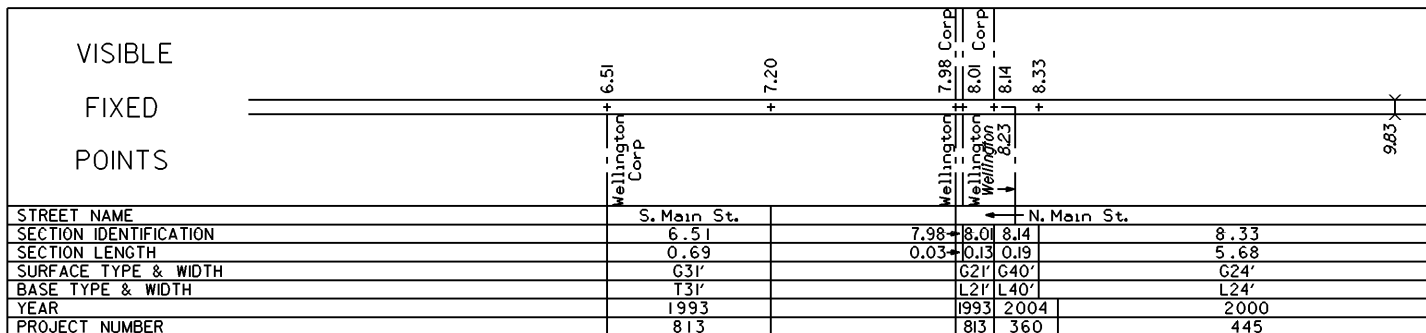

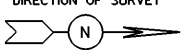

STATE OF OHIO - DEPARTMENT OF TRANSPORTATION  
STATE ROUTE SECTIONS ON CONTINUOUS MILEAGE STATIONING

DISTRICT 3  
COUNTY LORA IN  
ROUTE SR 58

MILES	10	11	12	13	14	15
VISIBLE FIXED POINTS			SR 303		14.01 US 20 14.02 Corp 14.12	14.99 Corp
DIRECTION OF SURVEY			12.02		US 20 Oberlin	Oberlin
STREET NAME			SR 303			
SECTION IDENTIFICATION			8.33		14.01	14.02 14.12 14.99
SECTION LENGTH			5.68		0.01	0.64
SURFACE TYPE & WIDTH			G24'		0.10	G24'
BASE TYPE & WIDTH			L24'			K20', L4'
YEAR			2000			1994
PROJECT NUMBER			445			616

PERPETUATION

VISIBLE FIXED POINTS			SR 303		US 20 Corp 14.01 Corp 14.12	14.88 Corp
DIRECTION OF SURVEY			12.02		13.89 US 20/1402 Oberlin	Oberlin
STREET NAME			SR 303			
SECTION IDENTIFICATION			8.33		14.01	14.12 14.88
SECTION LENGTH			5.68		0.11	0.76
SURFACE TYPE & WIDTH			G24'			G24'
BASE TYPE & WIDTH			L24'			K20', L4'
YEAR				2000		
PROJECT NUMBER			445			

VISIBLE FIXED POINTS			SR 303		13.90 US 20 Corp 14.01 Corp 14.12 14.24	14.88 Corp
DIRECTION OF SURVEY			12.02		13.89 US 20/1402 Oberlin	Oberlin
STREET NAME			SR 303			
SECTION IDENTIFICATION			8.33		13.90 14.01 14.12	14.24
SECTION LENGTH			5.57		0.11 0.11 0.12	0.64
SURFACE TYPE & WIDTH			G24'		0.36 0.36	G24'
BASE TYPE & WIDTH			L24'		0.36 0.36	K20', L4'
YEAR			2000		2006	2000
PROJECT NUMBER			445		6015	445

STATE OF OHIO - DEPARTMENT OF TRANSPORTATION  
STATE ROUTE SECTIONS ON CONTINUOUS MILEAGE STATIONING

DISTRICT 3  
COUNTY LORA IN  
ROUTE SR 58

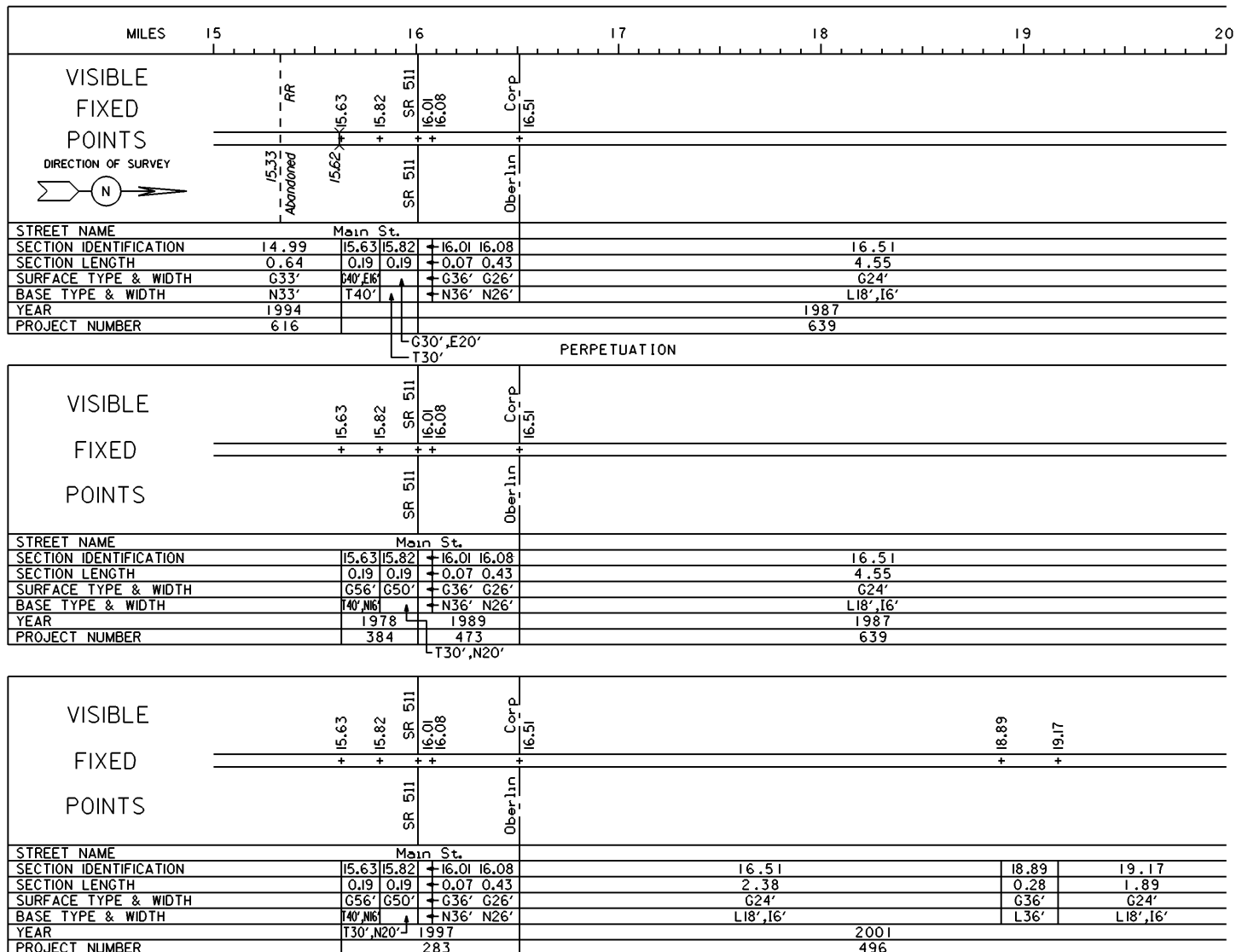

STATE OF OHIO - DEPARTMENT OF TRANSPORTATION  
STATE ROUTE SECTIONS ON CONTINUOUS MILEAGE STATIONING

DISTRICT 3  
COUNTY LORA IN  
ROUTE SR 58

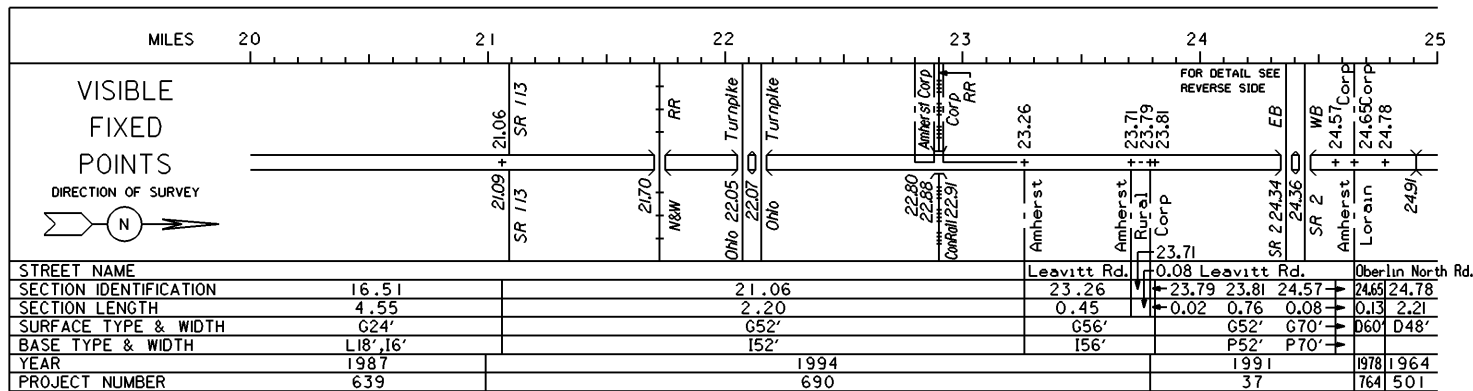

PERPETUATION

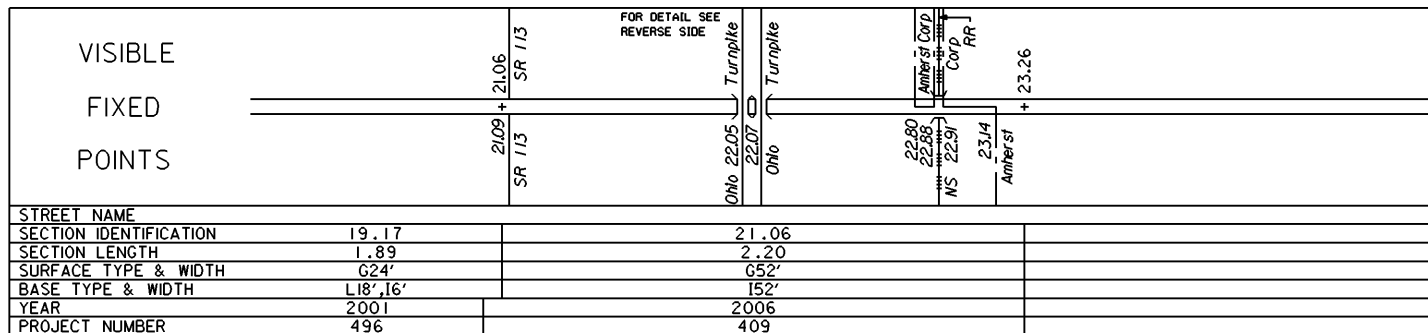
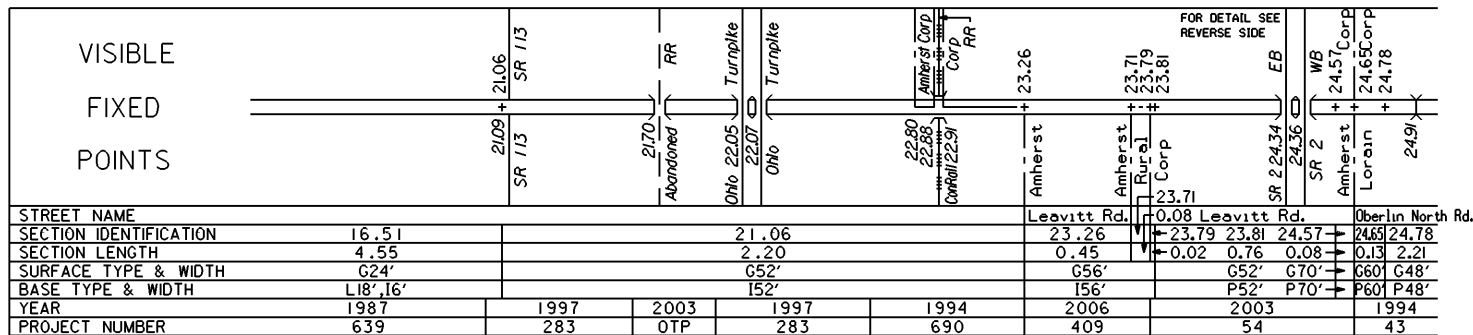

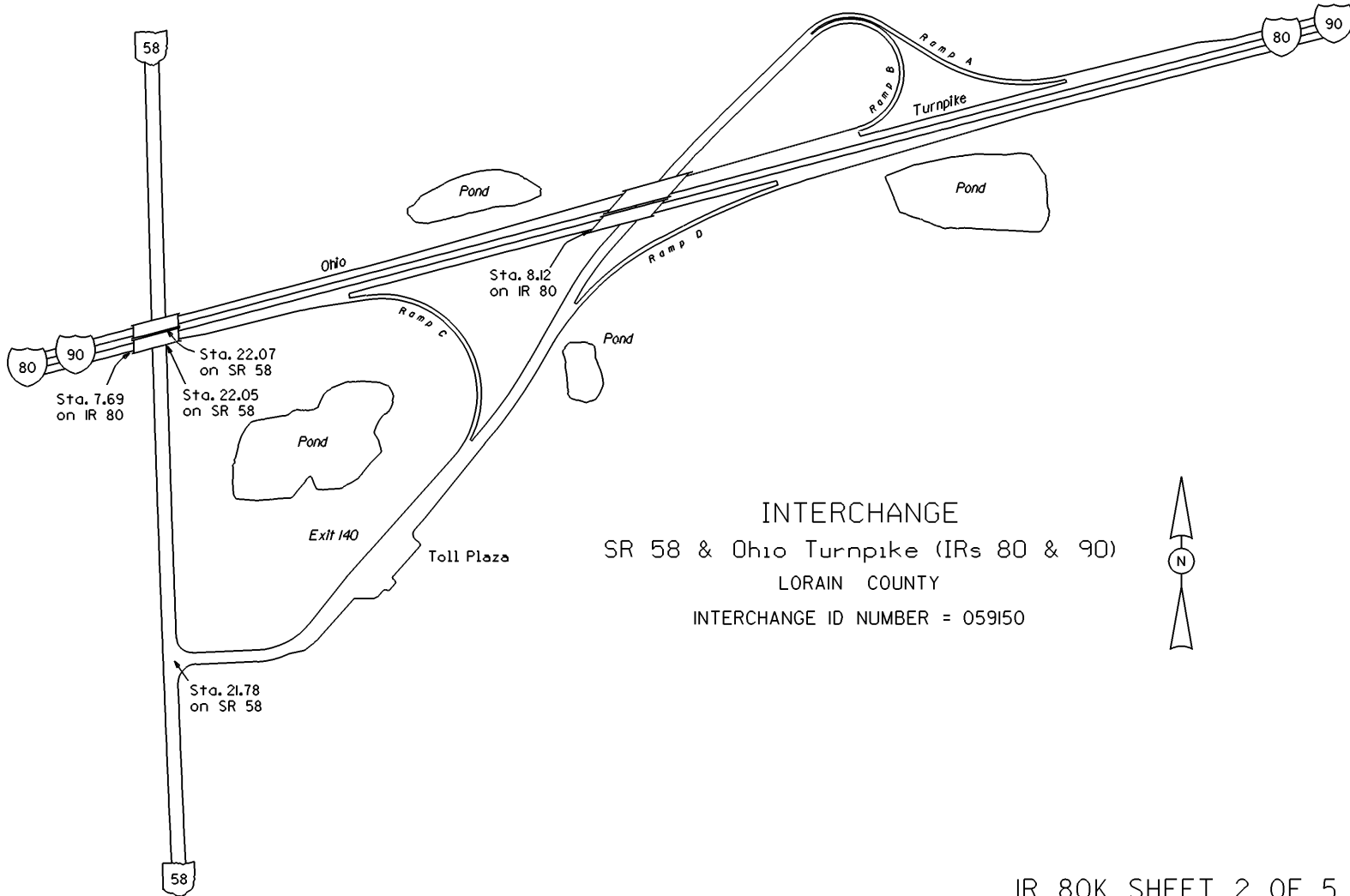

INTERCHANGE  
 SR 58 & Ohio Turnpike (IRs 80 & 90)  
 LORAIN COUNTY  
 INTERCHANGE ID NUMBER = 059150

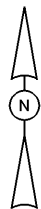

IR 80K SHEET 2 OF 5  
 SR 58 SHEET 5 OF 6



INTERCHANGE  
SR 2 & SR 58  
(Leavitt Rd.)  
LORAIN COUNTY  
INTERCHANGE ID NUMBER = 058800

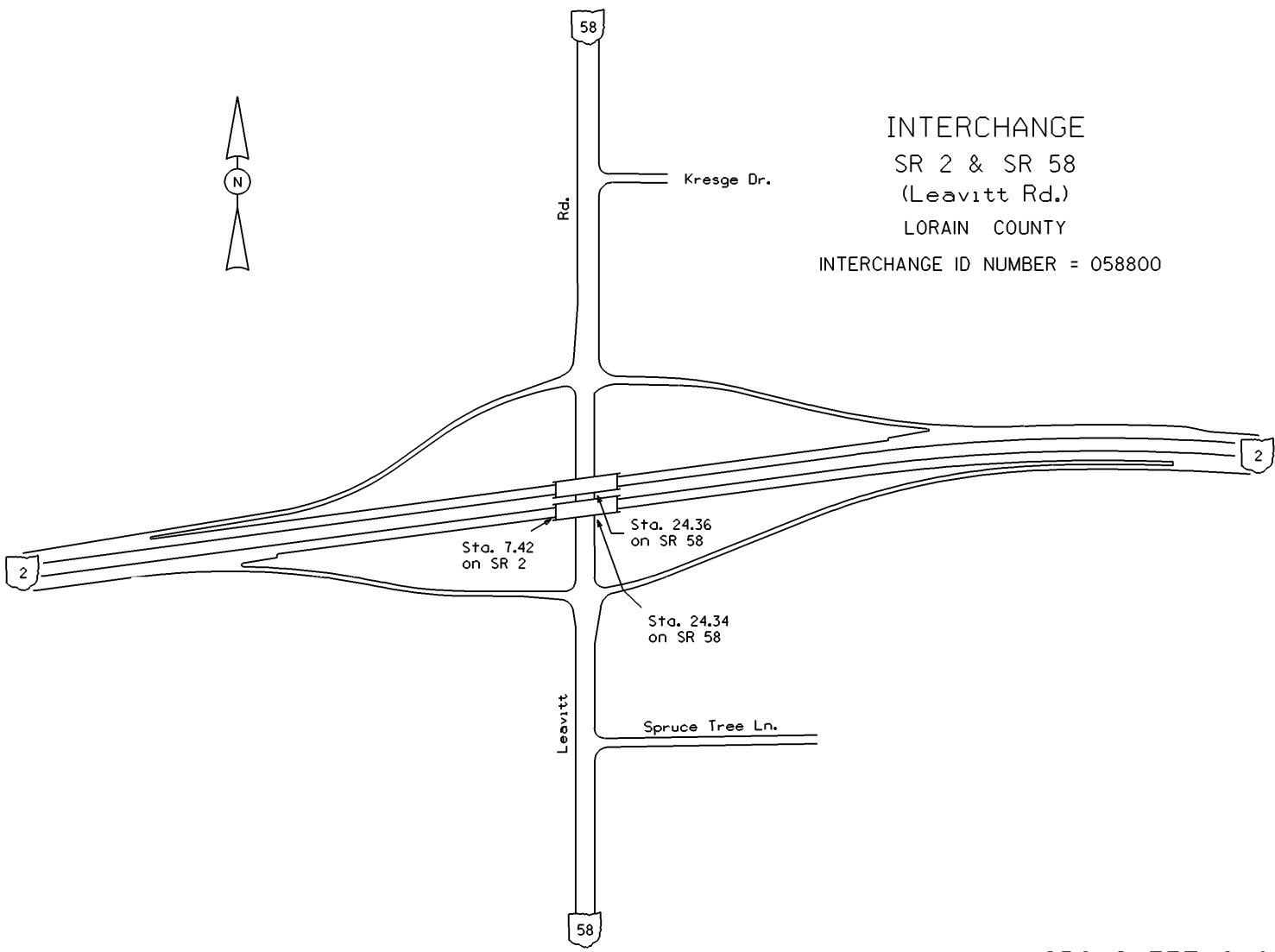

STATE OF OHIO - DEPARTMENT OF TRANSPORTATION  
STATE ROUTE SECTIONS ON CONTINUOUS MILEAGE STATIONING

DISTRICT 3  
COUNTY LORAIN  
ROUTE SR 58

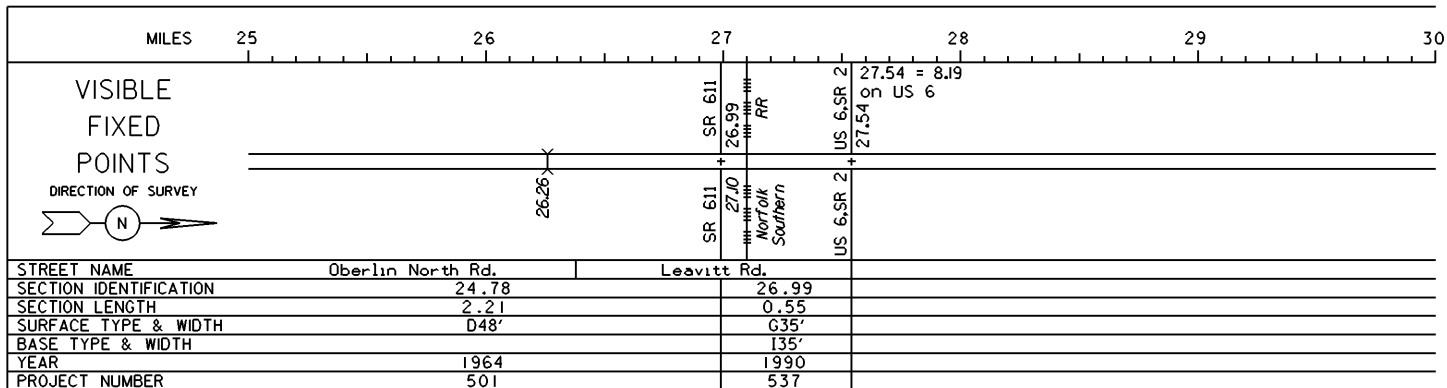

PERPETUATION

