

STATE OF OHIO - DEPARTMENT OF TRANSPORTATION

STATE ROUTE SECTIONS ON CONTINUOUS MILEAGE STATIONING

DISTRICT	2
COUNTY	LUCAS
ROUTE	SR 65

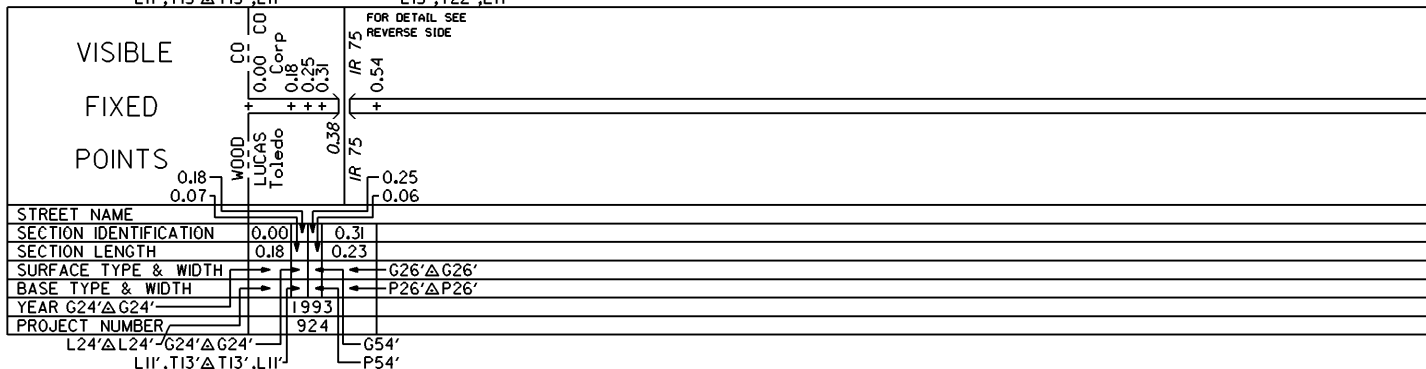
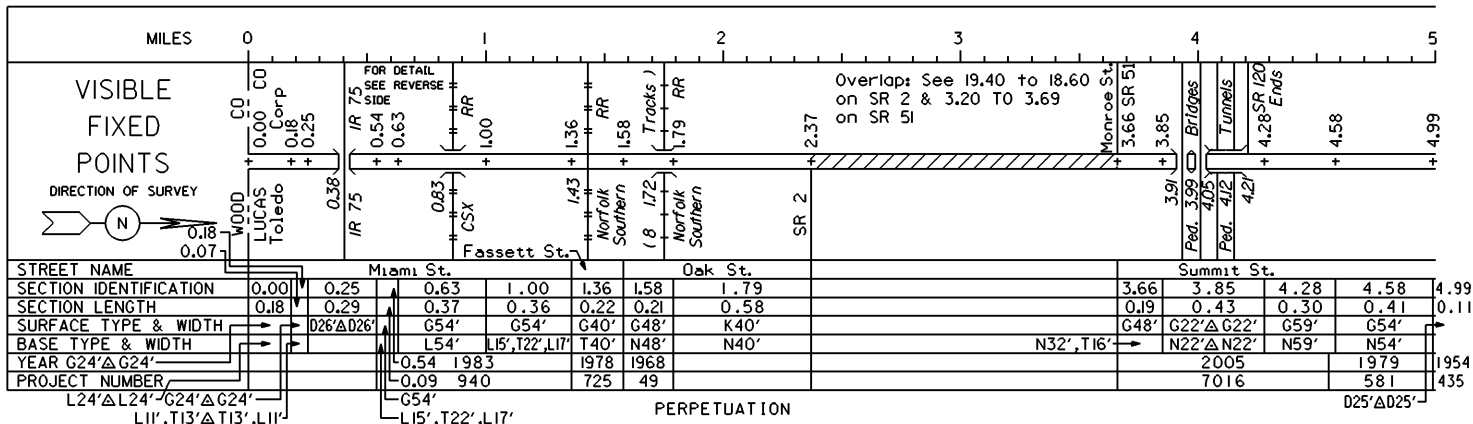

VISIBLE	
FIXED	
POINTS	
STREET NAME	
SECTION IDENTIFICATION	
SECTION LENGTH	
SURFACE TYPE & WIDTH	
BASE TYPE & WIDTH	
YEAR	
PROJECT NUMBER	

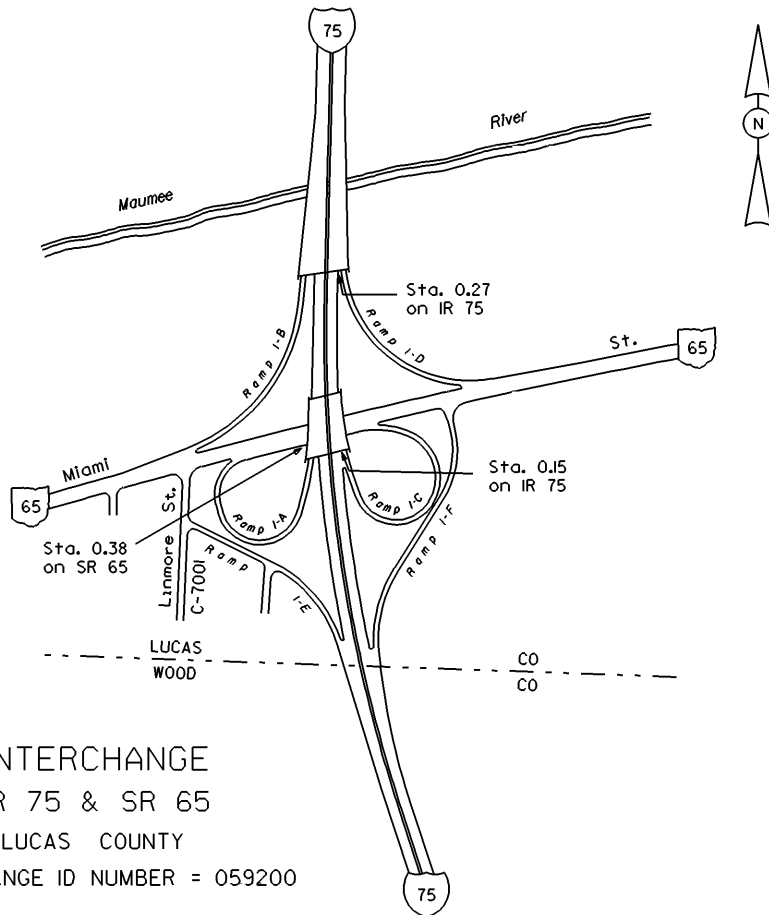

INTERCHANGE
 IR 75 & SR 65
 LUCAS COUNTY
 INTERCHANGE ID NUMBER = 059200

STATE OF OHIO - DEPARTMENT OF TRANSPORTATION

STATE ROUTE SECTIONS ON CONTINUOUS MILEAGE STATIONING

DISTRICT	2
COUNTY	LUCAS
ROUTE	SR 65

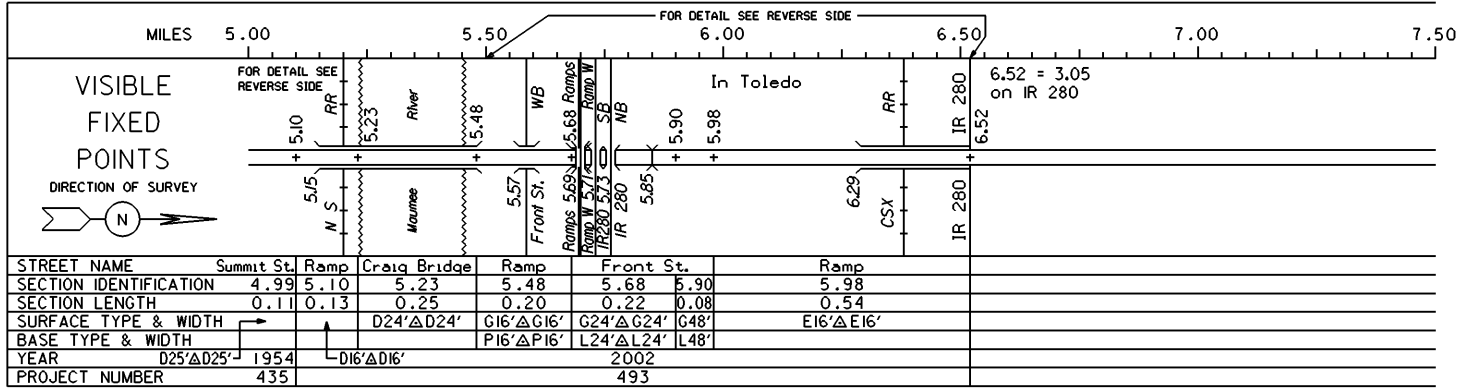

PERPETUATION

VISIBLE

FIXED

POINTS

STREET NAME
SECTION IDENTIFICATION
SECTION LENGTH
SURFACE TYPE & WIDTH
BASE TYPE & WIDTH
YEAR
PROJECT NUMBER

VISIBLE

FIXED

POINTS

STREET NAME
SECTION IDENTIFICATION
SECTION LENGTH
SURFACE TYPE & WIDTH
BASE TYPE & WIDTH
YEAR
PROJECT NUMBER

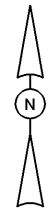
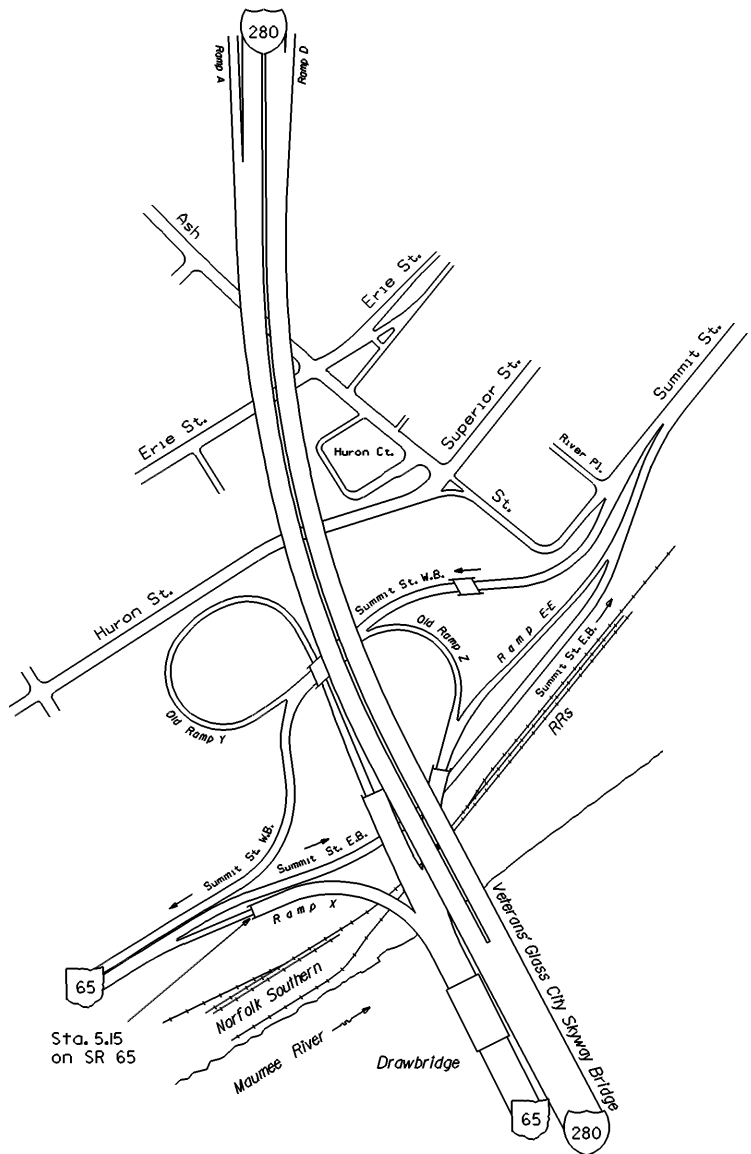

INTERCHANGE
 IR 280, SR 65, Summit St.
 LUCAS COUNTY
 INTERCHANGE ID NUMBER = 060650

IR280 SHEET 2 OF 3
 SR65 SHEET 2 OF 2

REVISED Jan 2008

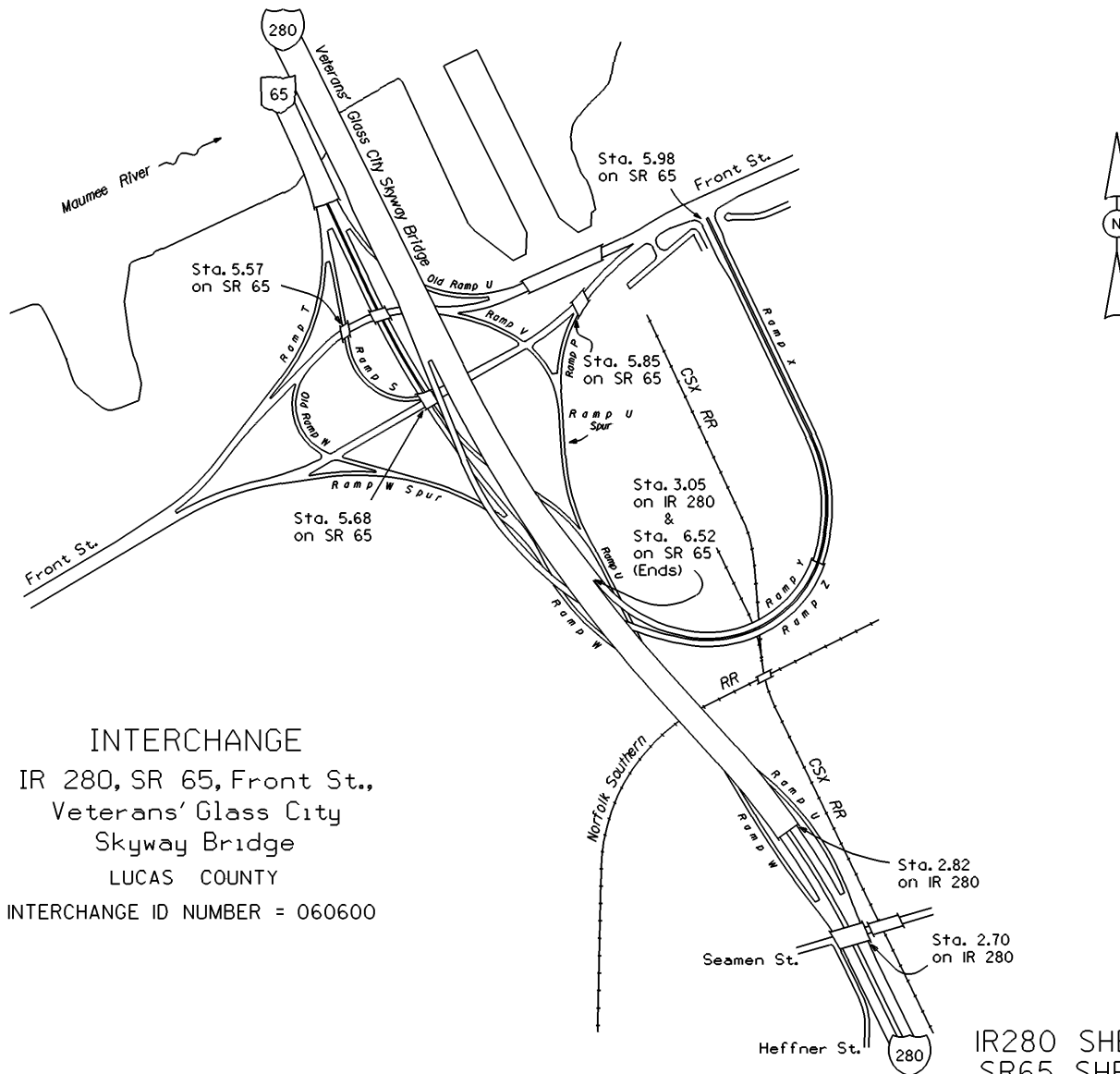

INTERCHANGE
 IR 280, SR 65, Front St.,
 Veterans' Glass City
 Skyway Bridge
 LUCAS COUNTY
 INTERCHANGE ID NUMBER = 060600

IR280 SHEET 2 OF 3
 SR65 SHEET 2 OF 2

REVISED Jan 2008