

STATE OF OHIO - DEPARTMENT OF TRANSPORTATION

STATE ROUTE SECTIONS ON CONTINUOUS MILEAGE STATIONING

DISTRICT 2
 COUNTY LUCAS
 ROUTE SR 184

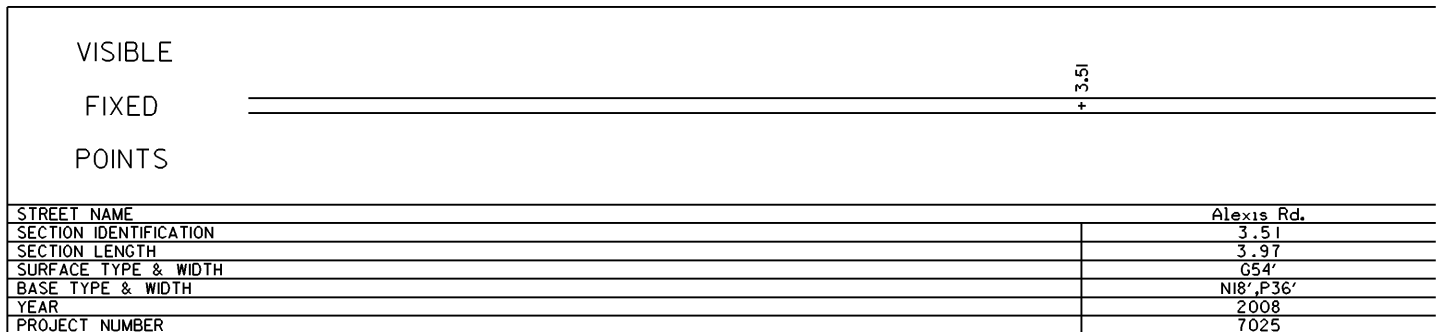

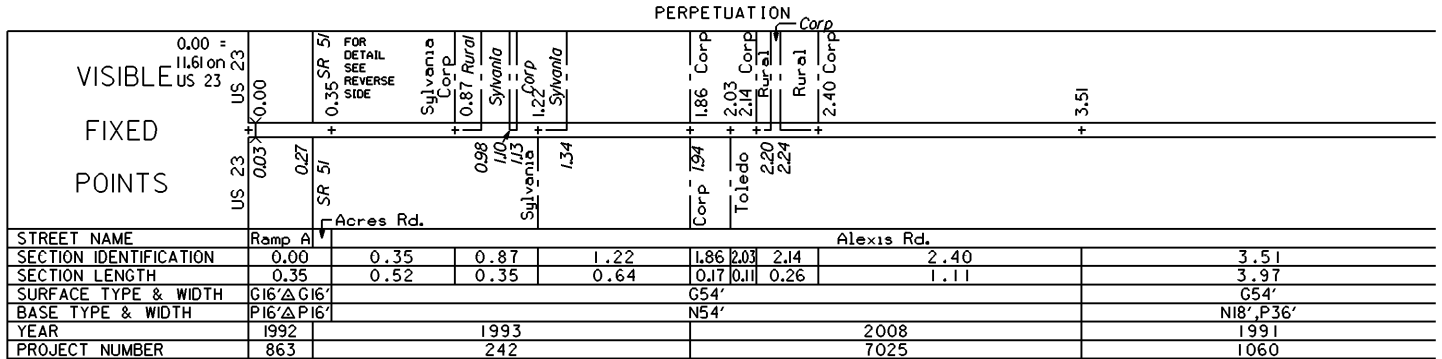
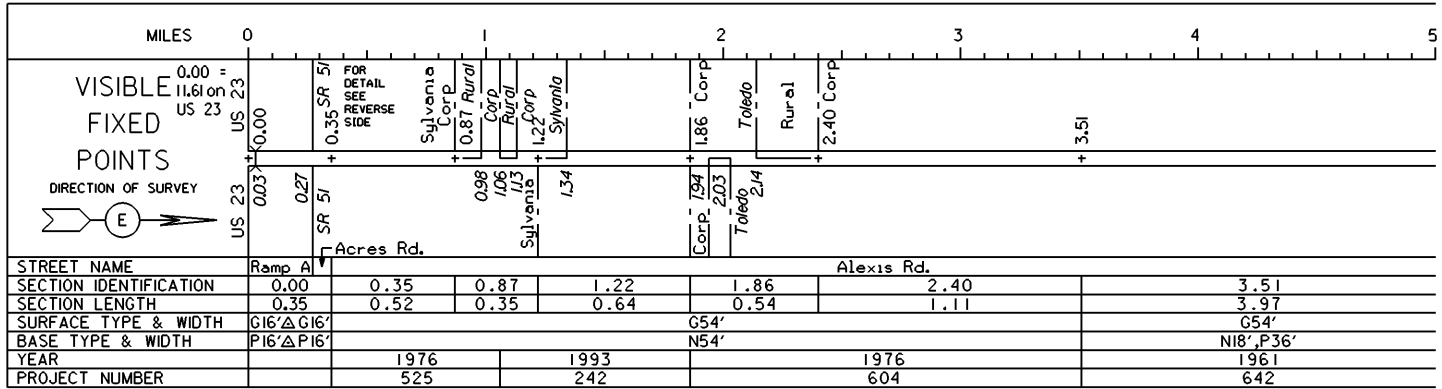

INTERCHANGE
USs 23 & 223,
SRs 51 & 184
LUCAS COUNTY
INTERCHANGE ID NUMBER = 061900

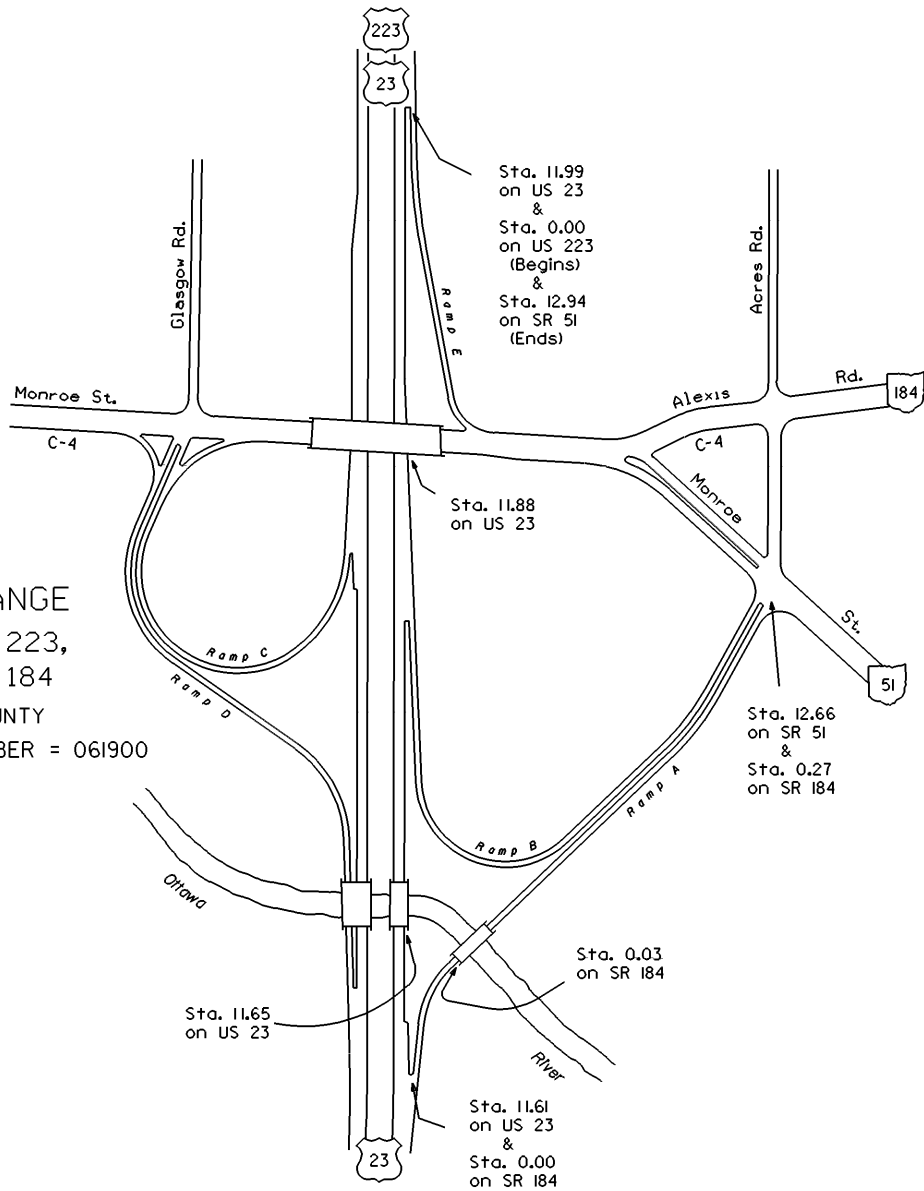

US23 SHEET 3 OF 3
US223 SHEET 1 OF 1
SR51 SHEET 3 OF 3
SR184 SHEET 1 OF 3

STATE OF OHIO - DEPARTMENT OF TRANSPORTATION

STATE ROUTE SECTIONS ON CONTINUOUS MILEAGE STATIONING

DISTRICT	2
COUNTY	LUCAS
ROUTE	SR 184

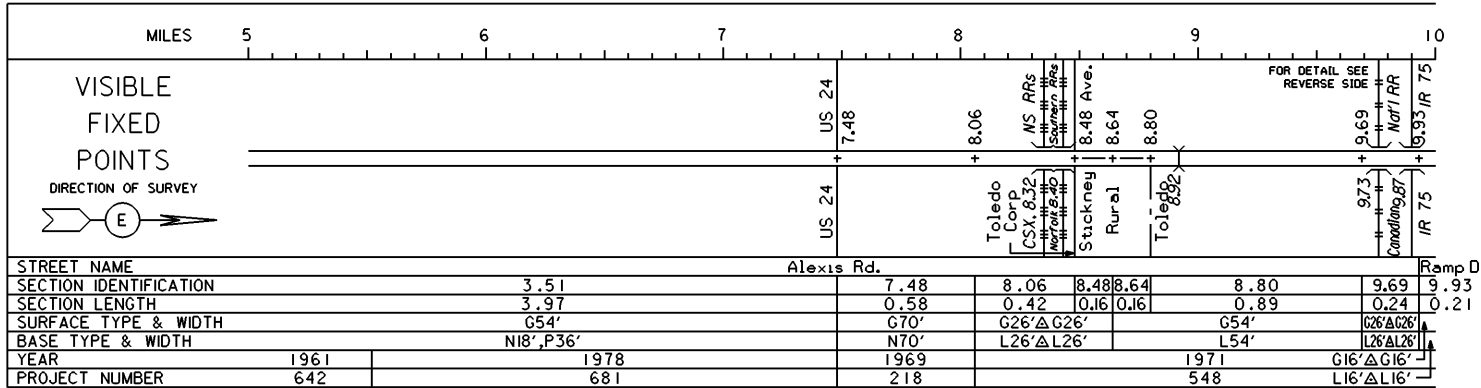

PERPETUATION

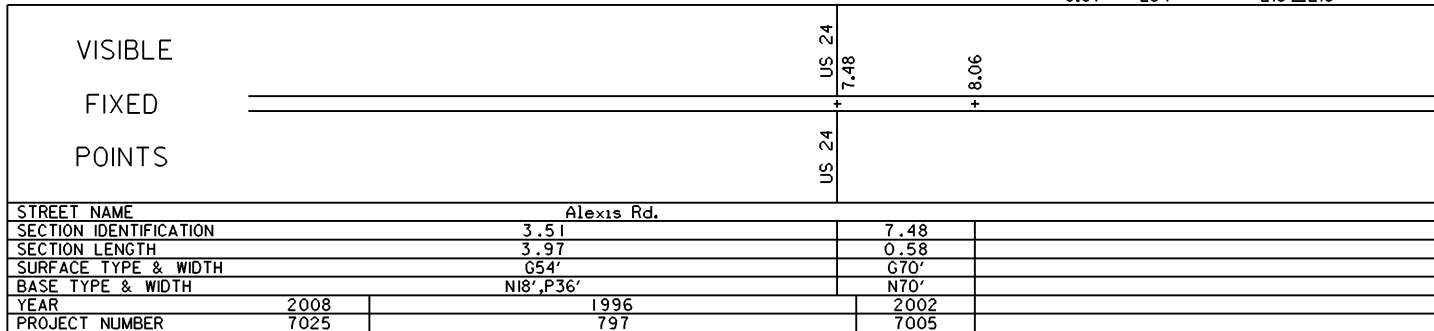
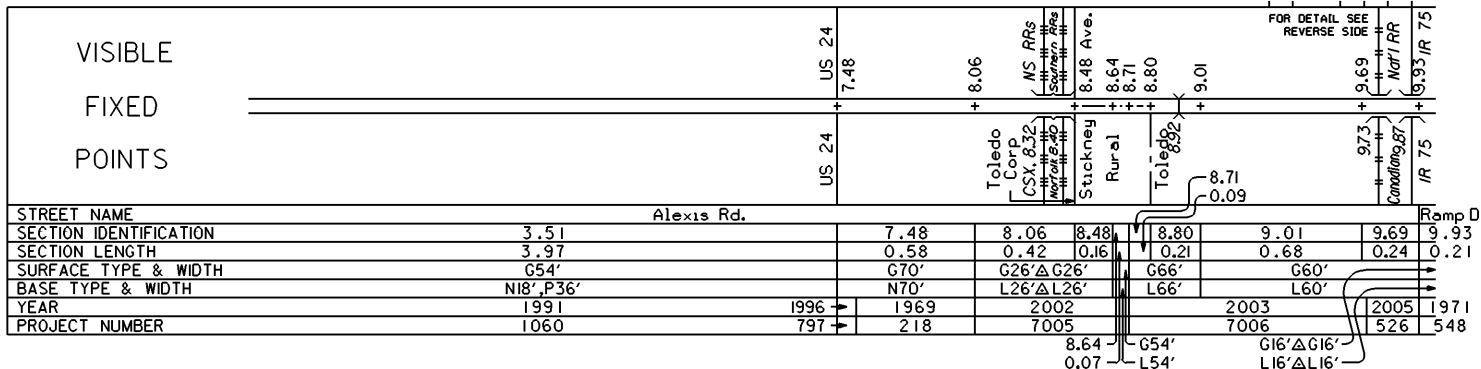

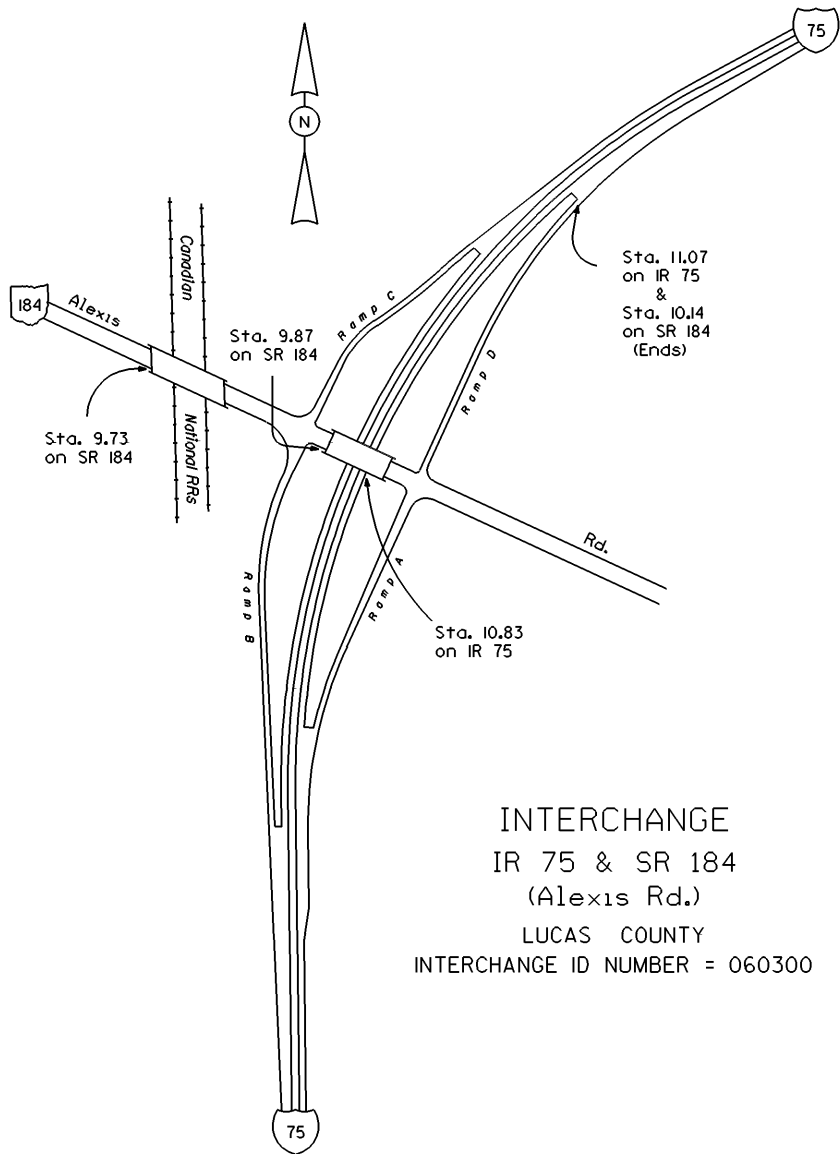

INTERCHANGE
 IR 75 & SR 184
 (Alexis Rd.)
 LUCAS COUNTY
 INTERCHANGE ID NUMBER = 060300

STATE OF OHIO - DEPARTMENT OF TRANSPORTATION

STATE ROUTE SECTIONS ON CONTINUOUS MILEAGE STATIONING

DISTRICT 2
 COUNTY LUCAS
 ROUTE SR 184

	MILES	10.00	10.20	10.40	10.60	10.80	11.00
VISIBLE FIXED POINTS DIRECTION OF SURVEY 		IR 75	10.14 = 11.07 on IR 75.				
		IR 75	10.14				
STREET NAME		Ramp D					
SECTION IDENTIFICATION		9.93					
SECTION LENGTH		0.21					
SURFACE TYPE & WIDTH		G16'△G16'					
BASE TYPE & WIDTH		L16'△L16'					
YEAR		1971					
PROJECT NUMBER		548					

PERPETUATION

VISIBLE FIXED POINTS	IR 75	10.14 = 11.07 on IR 75.
	IR 75	10.14
STREET NAME		Ramp D
SECTION IDENTIFICATION		9.93
SECTION LENGTH		0.21
SURFACE TYPE & WIDTH		G16'△G16'
BASE TYPE & WIDTH		L16'△L16'
YEAR		1971
PROJECT NUMBER		548

VISIBLE FIXED POINTS	
STREET NAME	
SECTION IDENTIFICATION	
SECTION LENGTH	
SURFACE TYPE & WIDTH	
BASE TYPE & WIDTH	
YEAR	
PROJECT NUMBER	