

STATE OF OHIO - DEPARTMENT OF TRANSPORTATION

STATE ROUTE SECTIONS ON CONTINUOUS MILEAGE STATIONING

DISTRICT 6
 COUNTY MADISON
 ROUTE IR 71

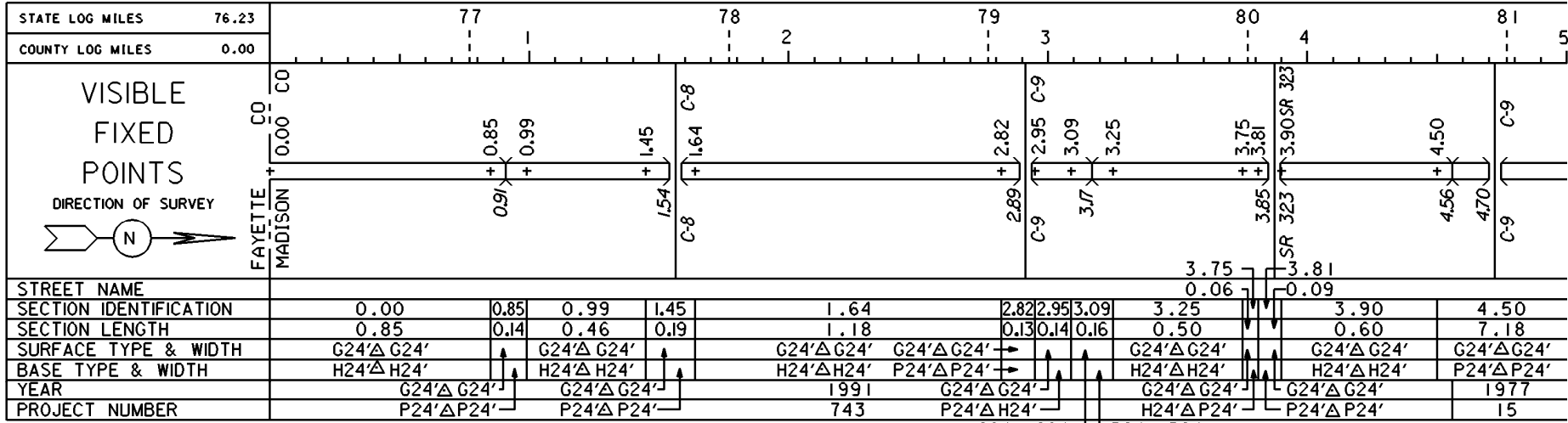

PERPETUATION

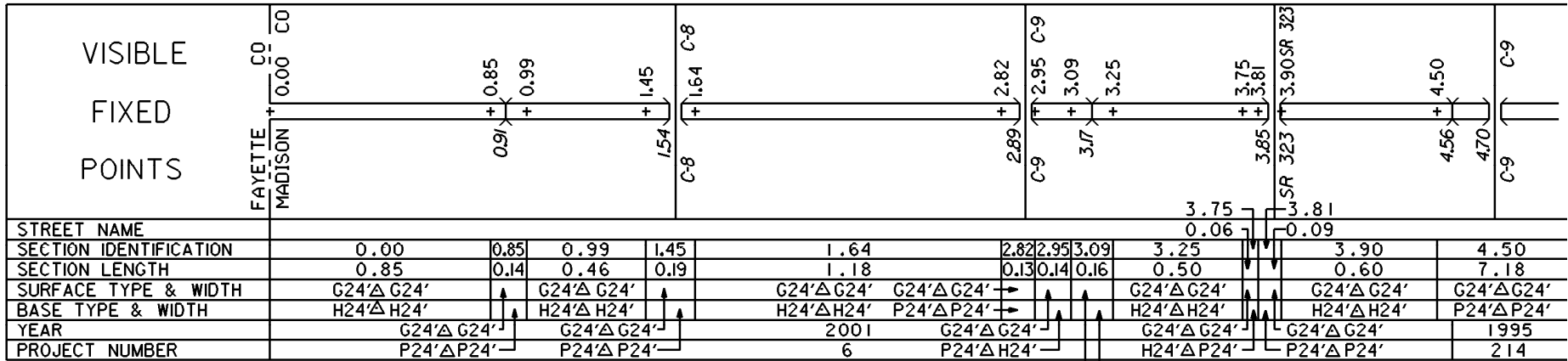

VISIBLE
 FIXED
 POINTS

STREET NAME _____

SECTION IDENTIFICATION _____

SECTION LENGTH _____

SURFACE TYPE & WIDTH _____

BASE TYPE & WIDTH _____

YEAR _____

PROJECT NUMBER _____

STATE OF OHIO - DEPARTMENT OF TRANSPORTATION

STATE ROUTE SECTIONS ON CONTINUOUS MILEAGE STATIONING

DISTRICT 6
 COUNTY MADISON
 ROUTE IR 71

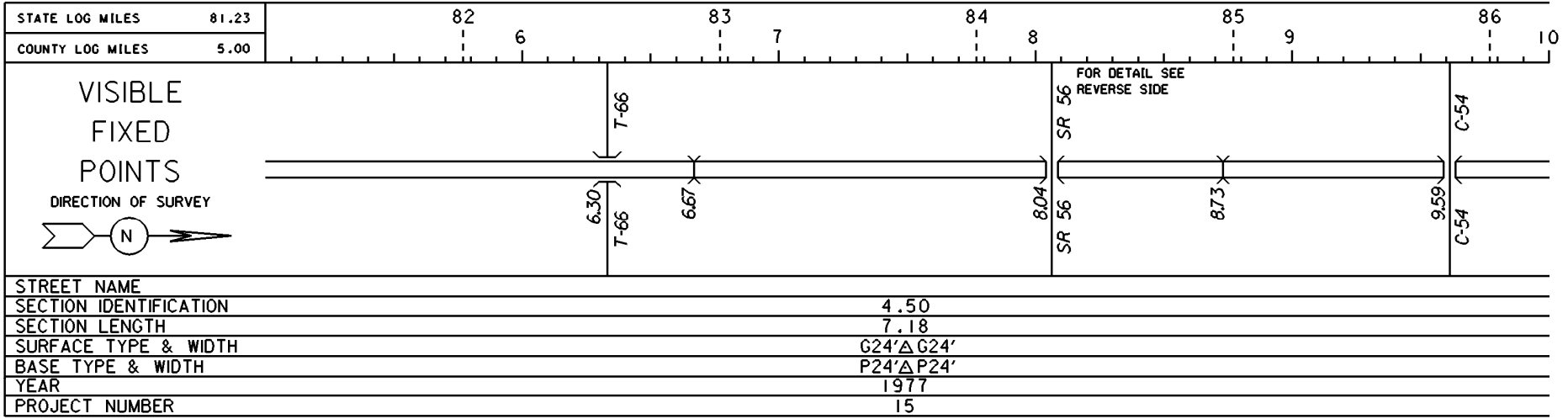

PERPETUATION

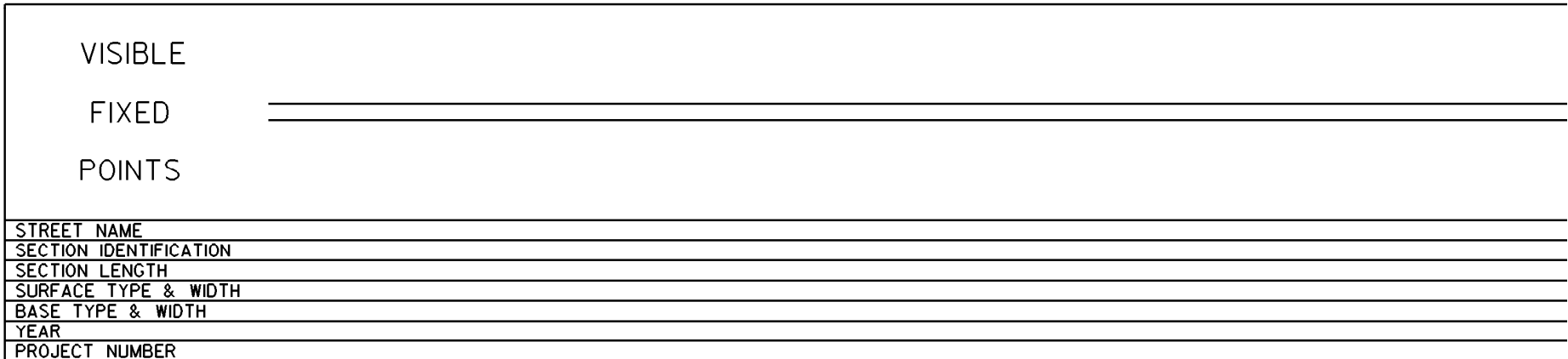
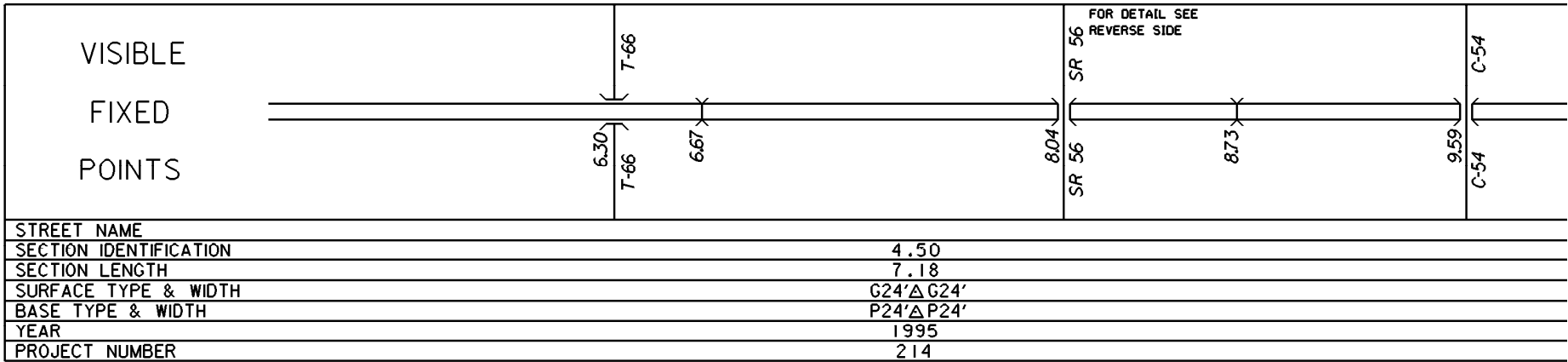

INTERCHANGE
IR 71 & SR 56
MADISON COUNTY
INTERCHANGE ID NUMBER = 062700

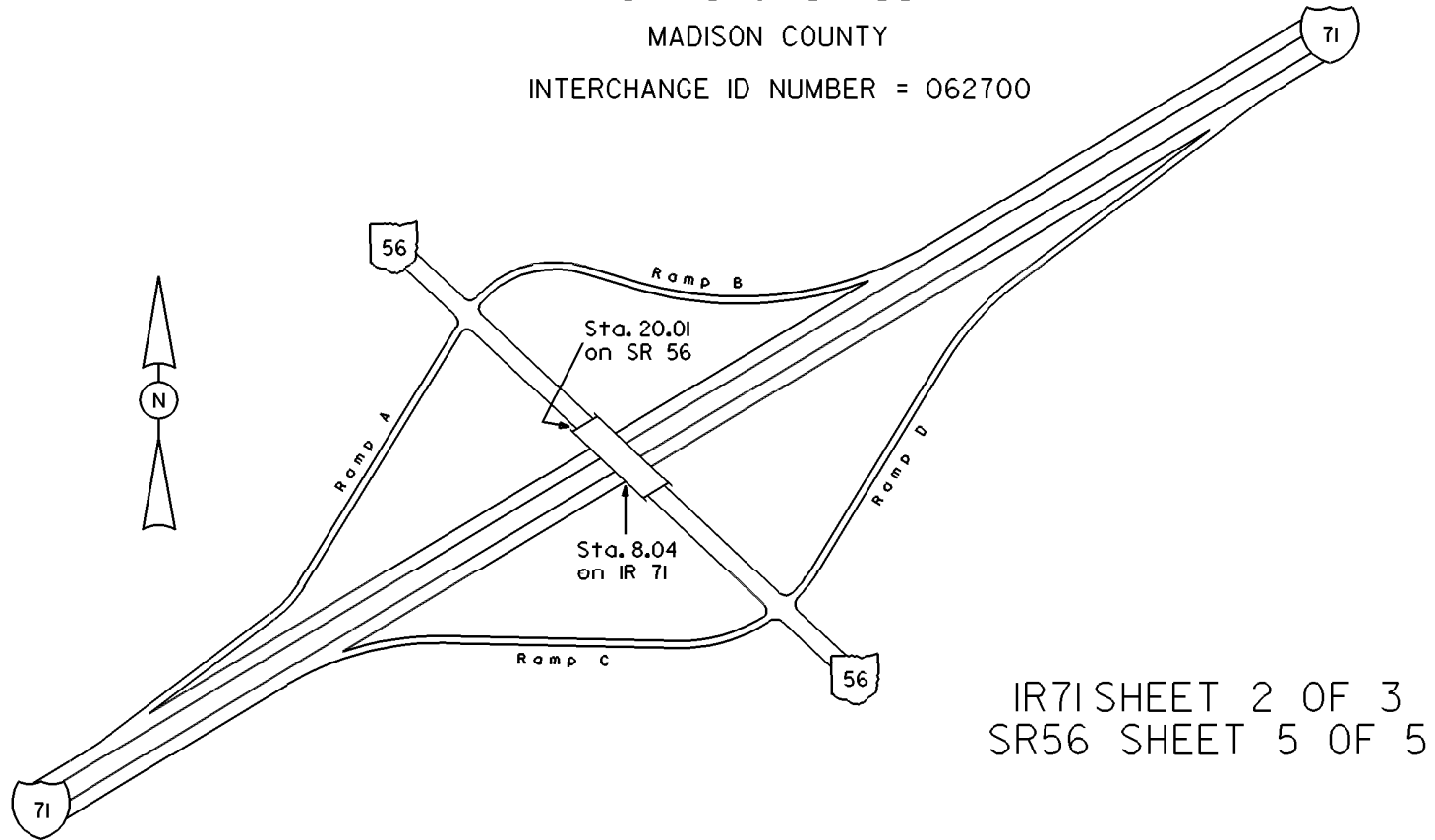

STATE OF OHIO - DEPARTMENT OF TRANSPORTATION

STATE ROUTE SECTIONS ON CONTINUOUS MILEAGE STATIONING

DISTRICT	6
COUNTY	MADISON
ROUTE	IR 71

STATE LOG MILES	86.23				
COUNTY LOG MILES	10.00	10.40	87 10.80	11.20	11.60 12.00

VISIBLE
FIXED
POINTS

DIRECTION OF SURVEY

11.45

C-56

11.68

C-56
MADISON
PICKAWAY

STREET NAME	
SECTION IDENTIFICATION	4.50
SECTION LENGTH	7.18
SURFACE TYPE & WIDTH	G24' Δ G24'
BASE TYPE & WIDTH	P24' Δ P24'
YEAR	1977
PROJECT NUMBER	15

PERPETUATION

VISIBLE
FIXED
POINTS

11.45

C-56

11.68

C-56
MADISON
PICKAWAY

STREET NAME	
SECTION IDENTIFICATION	4.50
SECTION LENGTH	7.18
SURFACE TYPE & WIDTH	G24' Δ G24'
BASE TYPE & WIDTH	P24' Δ P24'
YEAR	1995
PROJECT NUMBER	214

VISIBLE
FIXED
POINTS

STREET NAME	
SECTION IDENTIFICATION	
SECTION LENGTH	
SURFACE TYPE & WIDTH	
BASE TYPE & WIDTH	
YEAR	
PROJECT NUMBER	