

STATE OF OHIO - DEPARTMENT OF TRANSPORTATION
STATE ROUTE SECTIONS ON CONTINUOUS MILEAGE STATIONING

DISTRICT 10
COUNTY MEigs
ROUTE SR 338-J

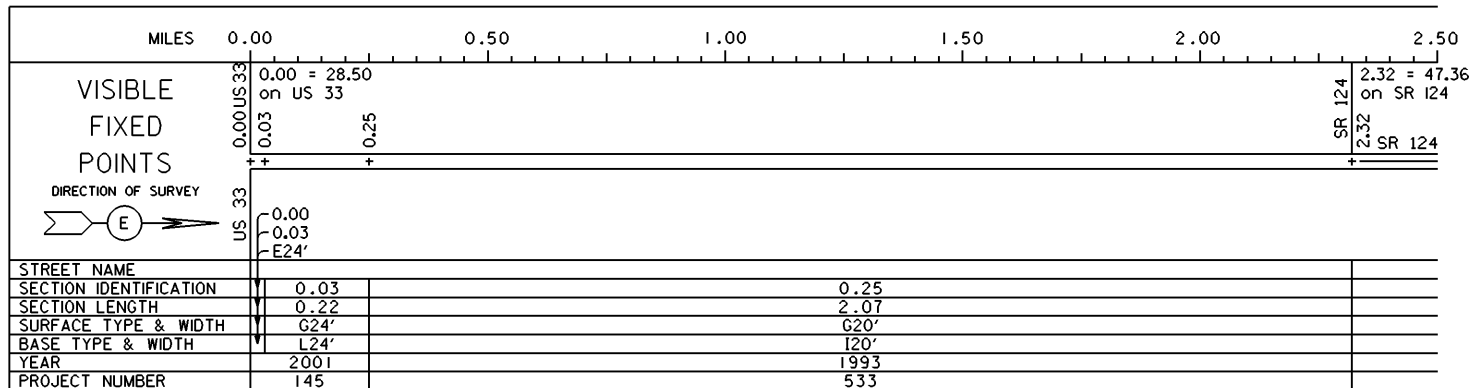

PERPETUATION

VISIBLE

FIXED _____

POINTS

STREET NAME _____

SECTION IDENTIFICATION _____

SECTION LENGTH _____

SURFACE TYPE & WIDTH _____

BASE TYPE & WIDTH _____

YEAR _____

PROJECT NUMBER _____

VISIBLE

FIXED _____

POINTS

STREET NAME _____

SECTION IDENTIFICATION _____

SECTION LENGTH _____

SURFACE TYPE & WIDTH _____

BASE TYPE & WIDTH _____

YEAR _____

PROJECT NUMBER _____