

STATE OF OHIO - DEPARTMENT OF TRANSPORTATION

STATE ROUTE SECTIONS ON CONTINUOUS MILEAGE STATIONING

DISTRICT	10
COUNTY	MEIGS
ROUTE	SR 833

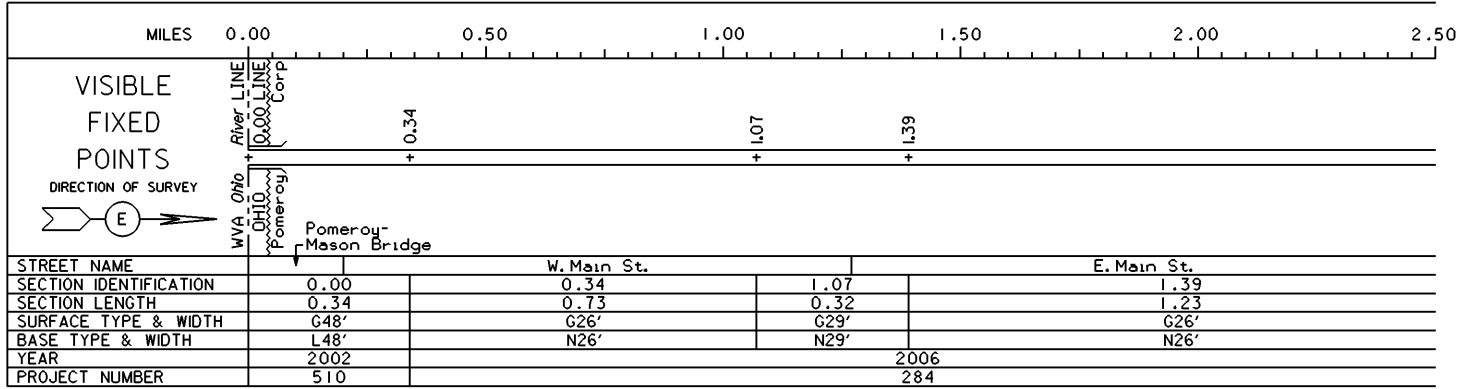

PERPETUATION

VISIBLE _____

FIXED _____

POINTS _____

STREET NAME _____

SECTION IDENTIFICATION _____

SECTION LENGTH _____

SURFACE TYPE & WIDTH _____

BASE TYPE & WIDTH _____

YEAR _____

PROJECT NUMBER _____

VISIBLE _____

FIXED _____

POINTS _____

STREET NAME _____

SECTION IDENTIFICATION _____

SECTION LENGTH _____

SURFACE TYPE & WIDTH _____

BASE TYPE & WIDTH _____

YEAR _____

PROJECT NUMBER _____

STATE OF OHIO - DEPARTMENT OF TRANSPORTATION
STATE ROUTE SECTIONS ON CONTINUOUS MILEAGE STATIONING

DISTRICT 10
COUNTY MEigs
ROUTE SR 833

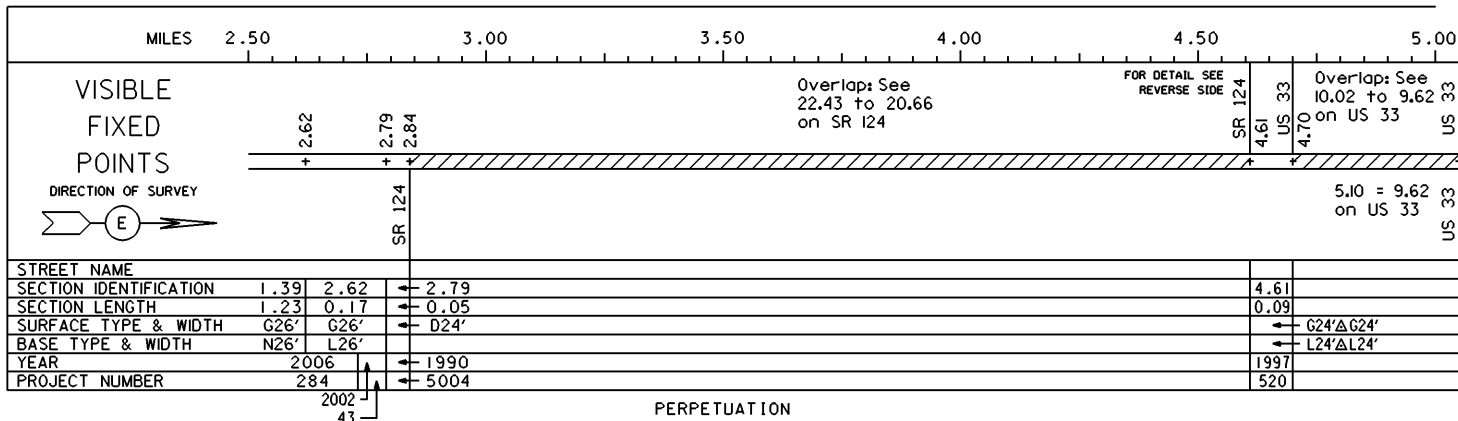

VISIBLE
FIXED
POINTS

STREET NAME
SECTION IDENTIFICATION
SECTION LENGTH
SURFACE TYPE & WIDTH
BASE TYPE & WIDTH
YEAR
PROJECT NUMBER

VISIBLE
FIXED
POINTS

STREET NAME
SECTION IDENTIFICATION
SECTION LENGTH
SURFACE TYPE & WIDTH
BASE TYPE & WIDTH
YEAR
PROJECT NUMBER

INTERCHANGE
 US 33, SRs 7, 124 & 833
 MEIGS COUNTY
 INTERCHANGE ID NUMBER = 067700

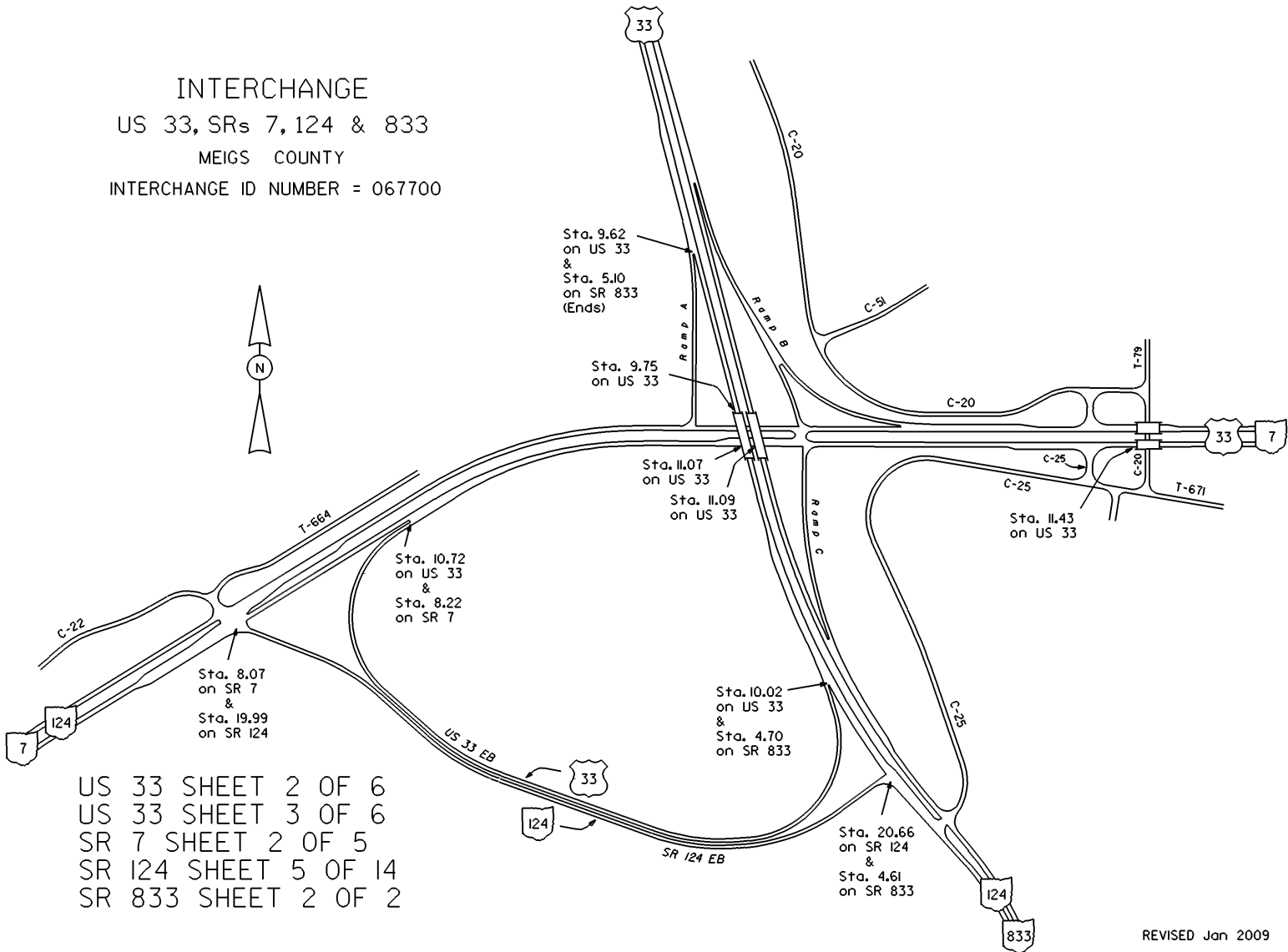

US 33 SHEET 2 OF 6
 US 33 SHEET 3 OF 6
 SR 7 SHEET 2 OF 5
 SR 124 SHEET 5 OF 14
 SR 833 SHEET 2 OF 2