

STATE OF OHIO - DEPARTMENT OF TRANSPORTATION

STATE ROUTE SECTIONS ON CONTINUOUS MILEAGE STATIONING

DISTRICT	7
COUNTY	MIAMI
ROUTE	IR 75

STATE LOG MILES	65.34	66	67	68	69	70	71
COUNTY LOG MILES	0.00						
VISIBLE FIXED POINTS DIRECTION OF SURVEY 	CO 0.00 CO MIAMI MONTGOMERY	T-224 Ginghams- burg Charleston Rd.	T-222 Shoop Rd.	C-150 Evanston Tipp City Corp.	SR 571 2.62 SR 571 Tipp City Corp. 3.44 Tipp City Corp. 3.57	T-224 Ginghams- burg Charleston Rd.	T-222 Shoop Rd.
STREET NAME	Expressway						
SECTION IDENTIFICATION	0.00	1.52	1.92	3.44	3.57	4.16	4.16
SECTION LENGTH	1.52	1.92	0.13	0.59	0.92	0.92	0.92
SURFACE TYPE & WIDTH	G36' Δ G36'						
BASE TYPE & WIDTH	P24', L12' Δ L12', P24'						
YEAR	2000						1996
PROJECT NUMBER	404						291

PERPETUATION

FOR DETAIL SEE REVERSE SIDE

VISIBLE FIXED POINTS	
STREET NAME	Expressway
SECTION IDENTIFICATION	4.16
SECTION LENGTH	0.92
SURFACE TYPE & WIDTH	G36' Δ G36'
BASE TYPE & WIDTH	P24', L12' Δ L12', P24'
YEAR	2000 1996
PROJECT NUMBER	404 291

VISIBLE FIXED POINTS	
STREET NAME	
SECTION IDENTIFICATION	
SECTION LENGTH	
SURFACE TYPE & WIDTH	
BASE TYPE & WIDTH	
YEAR	
PROJECT NUMBER	

INTERCHANGE
IR 75 & SR 571
MIAMI COUNTY
INTERCHANGE ID NUMBER = 067900

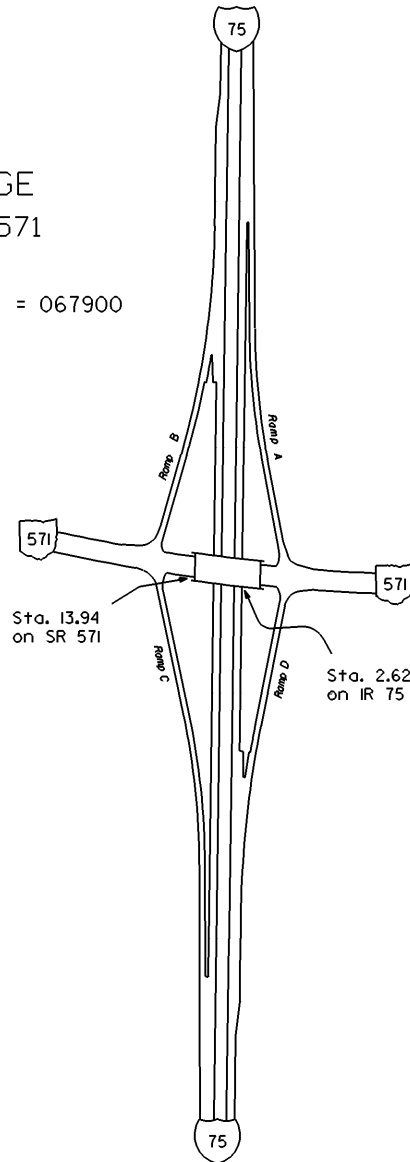

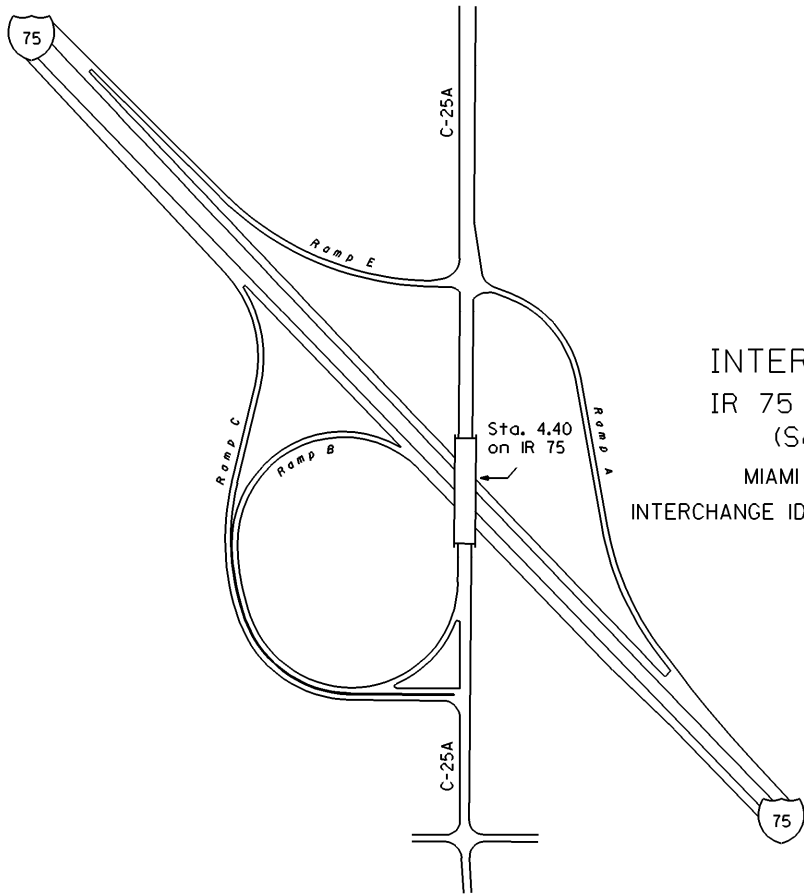

INTERCHANGE
IR 75 & C-25A
(South)

MIAMI COUNTY
INTERCHANGE ID NUMBER = 068000

STATE OF OHIO - DEPARTMENT OF TRANSPORTATION

STATE ROUTE SECTIONS ON CONTINUOUS MILEAGE STATIONING

DISTRICT 7
 COUNTY MIAMI
 ROUTE IR 75

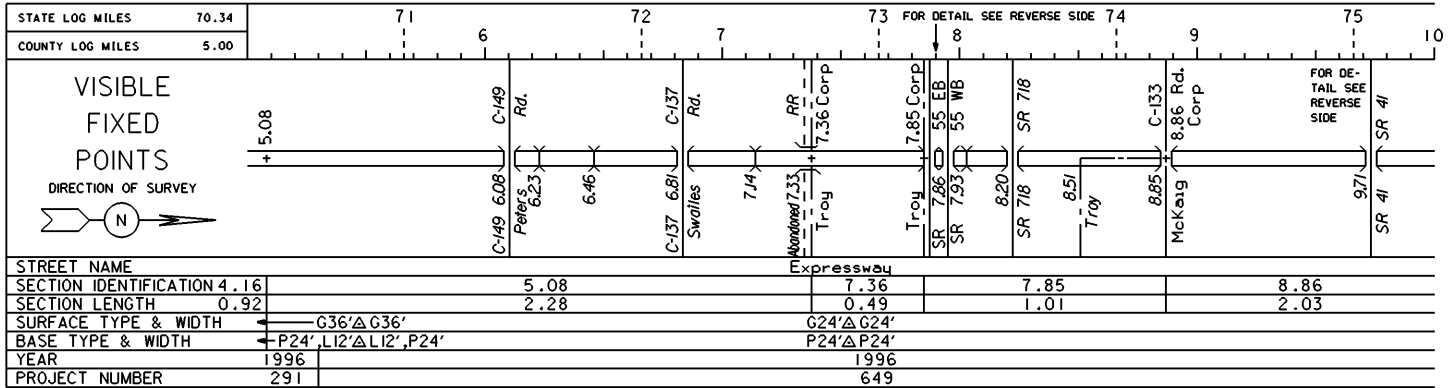

PERPETUATION

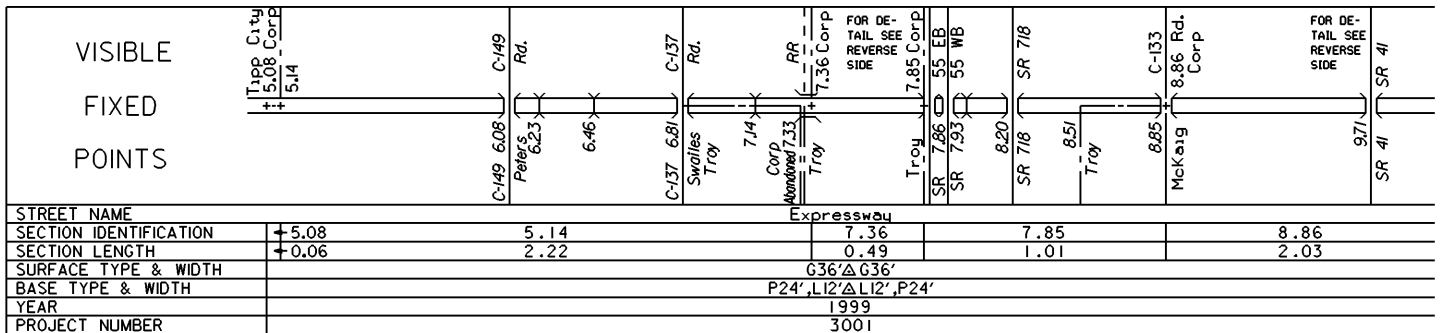
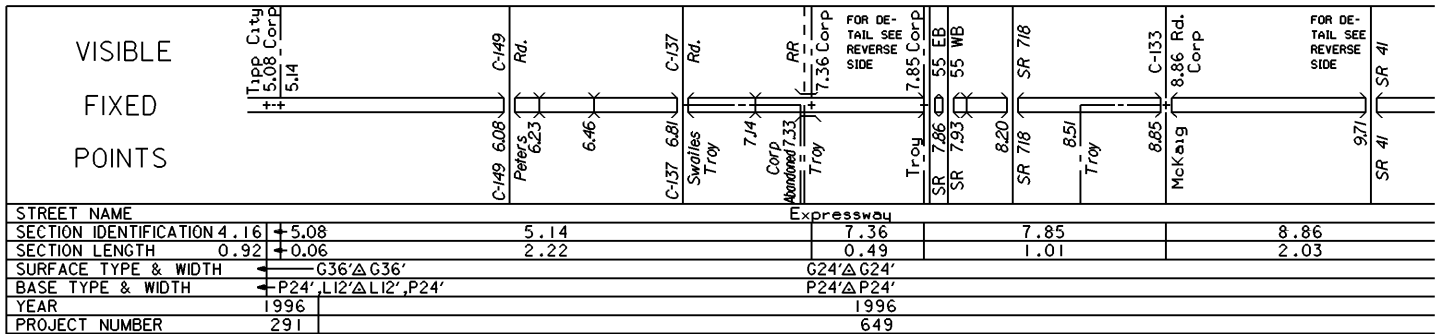

INTERCHANGE
IR 75 & SR 55
MIAMI COUNTY
INTERCHANGE ID NUMBER = 068100

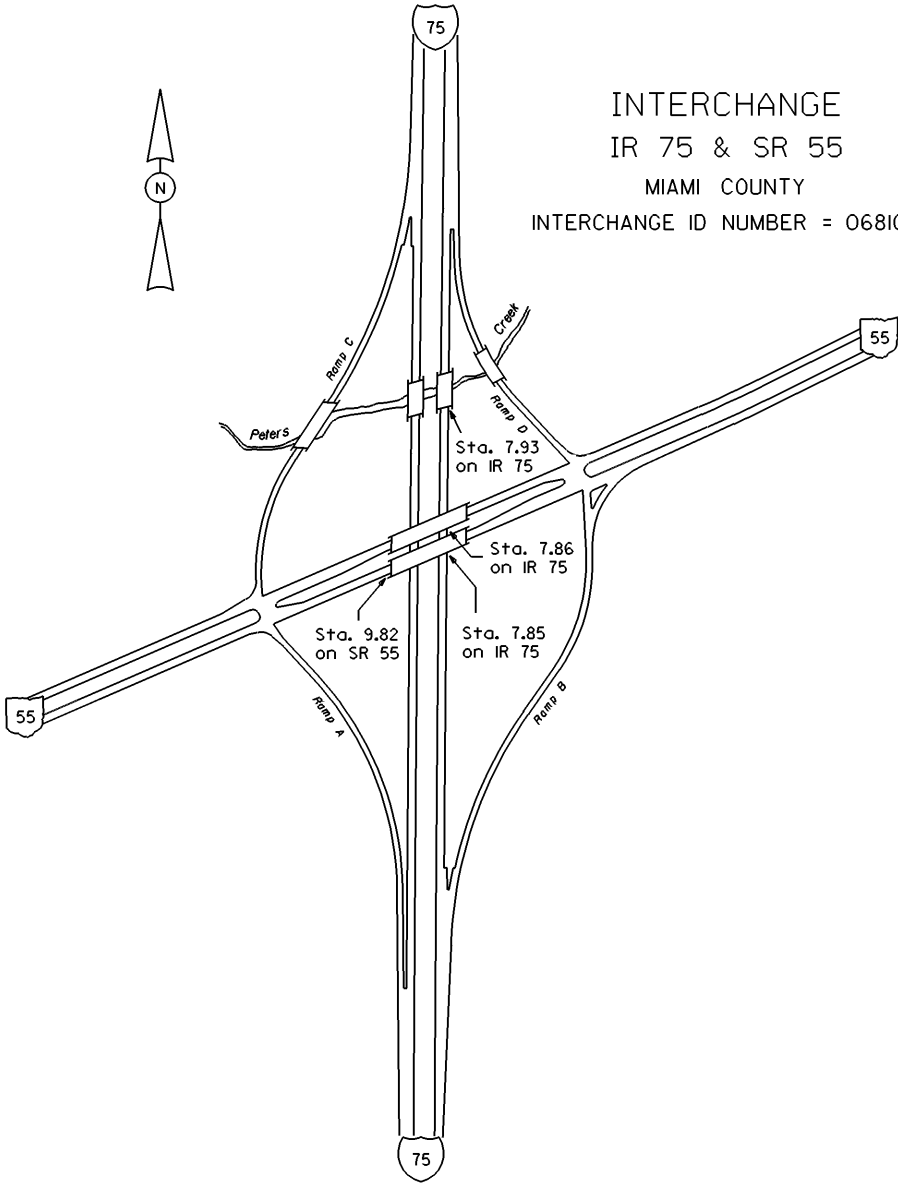

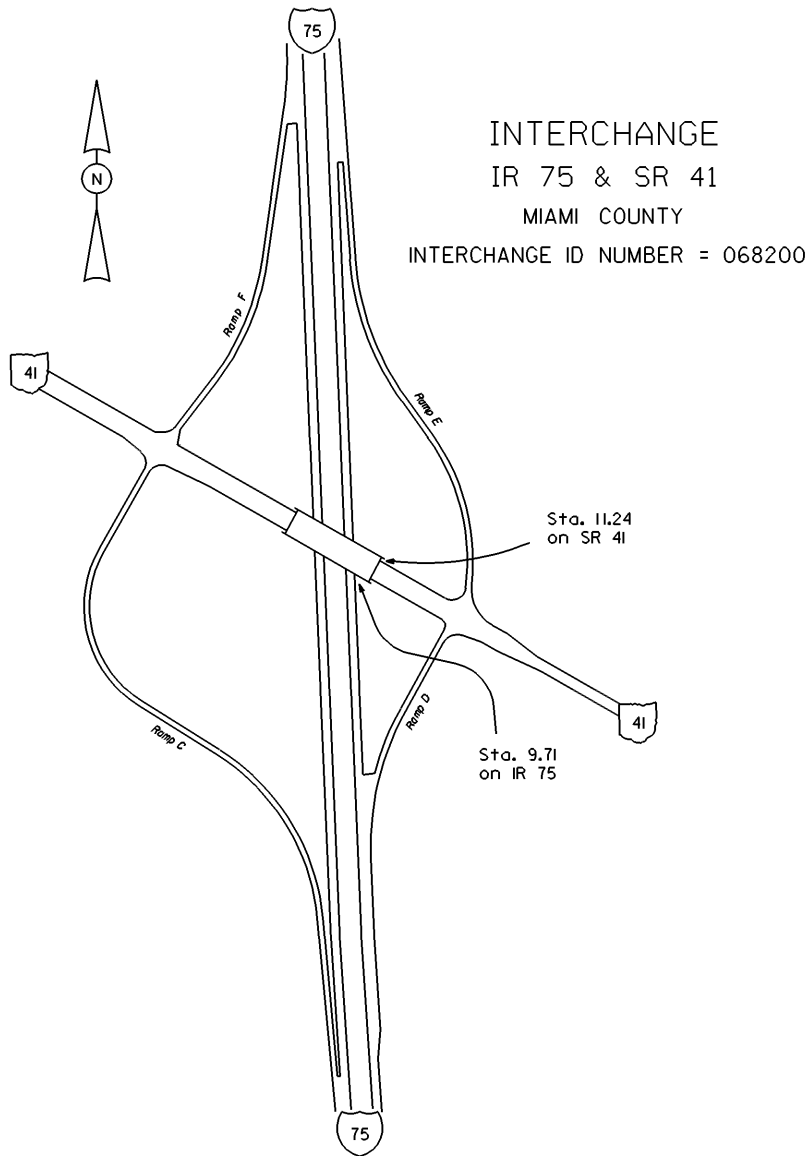

IR75 SHEET 2 OF 4
SR41 SHEET 3 OF 4

STATE OF OHIO - DEPARTMENT OF TRANSPORTATION

STATE ROUTE SECTIONS ON CONTINUOUS MILEAGE STATIONING

DISTRICT	7
COUNTY	MIAMI
ROUTE	1R 75

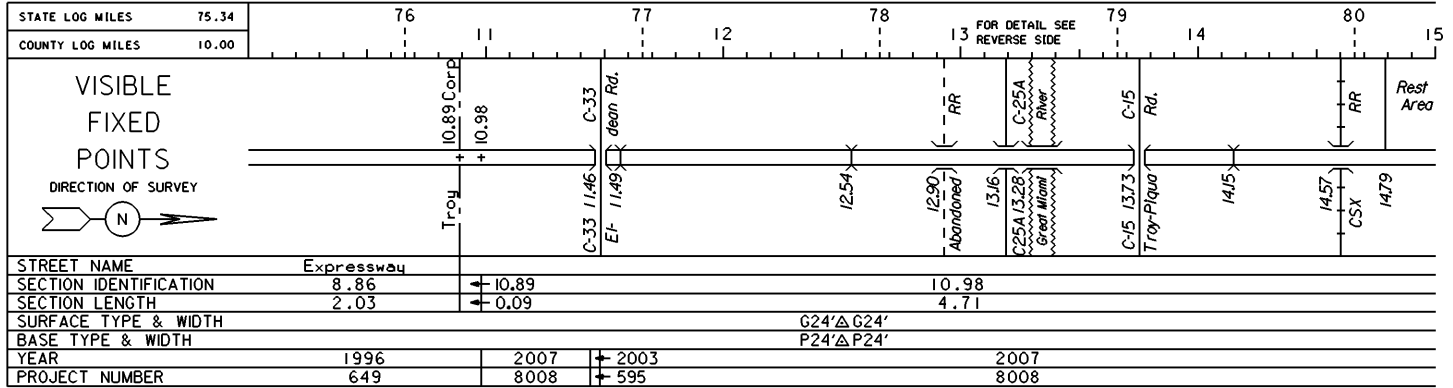

PERPETUATION

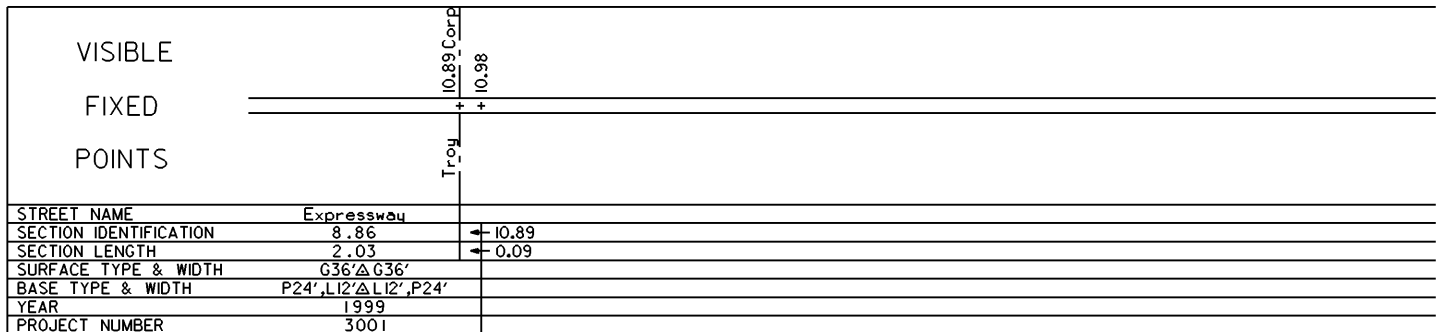
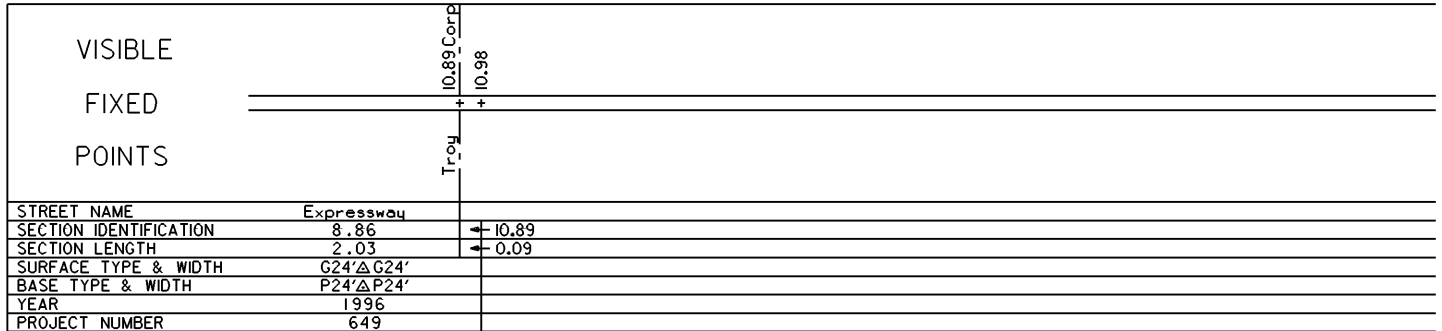

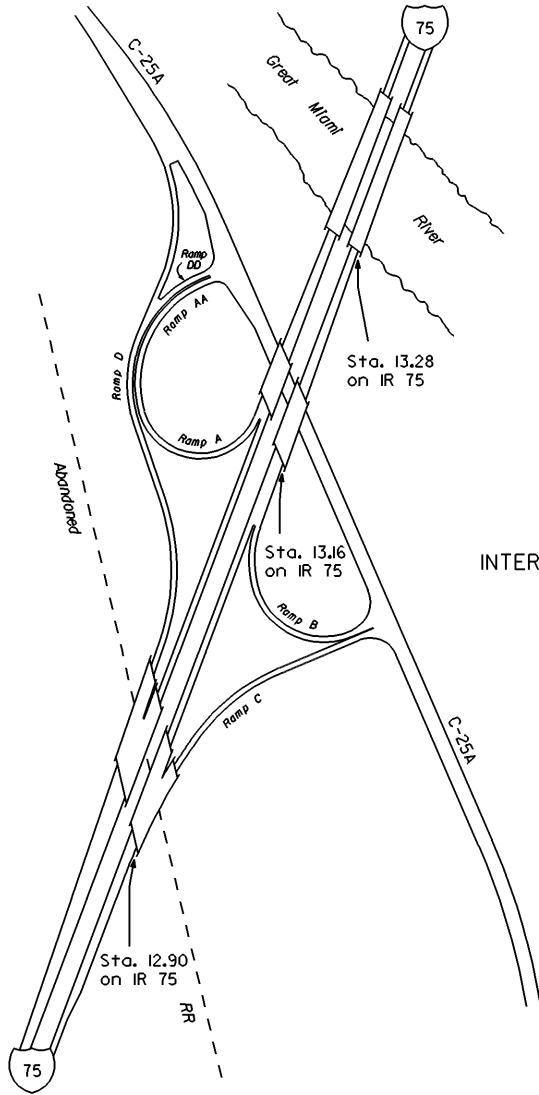

INTERCHANGE
IR 75 & C-25A
(Central)
MIAMI COUNTY
INTERCHANGE ID NUMBER = 068300

STATE OF OHIO - DEPARTMENT OF TRANSPORTATION

STATE ROUTE SECTIONS ON CONTINUOUS MILEAGE STATIONING

DISTRICT	7
COUNTY	MIAMI
ROUTE	1R 75

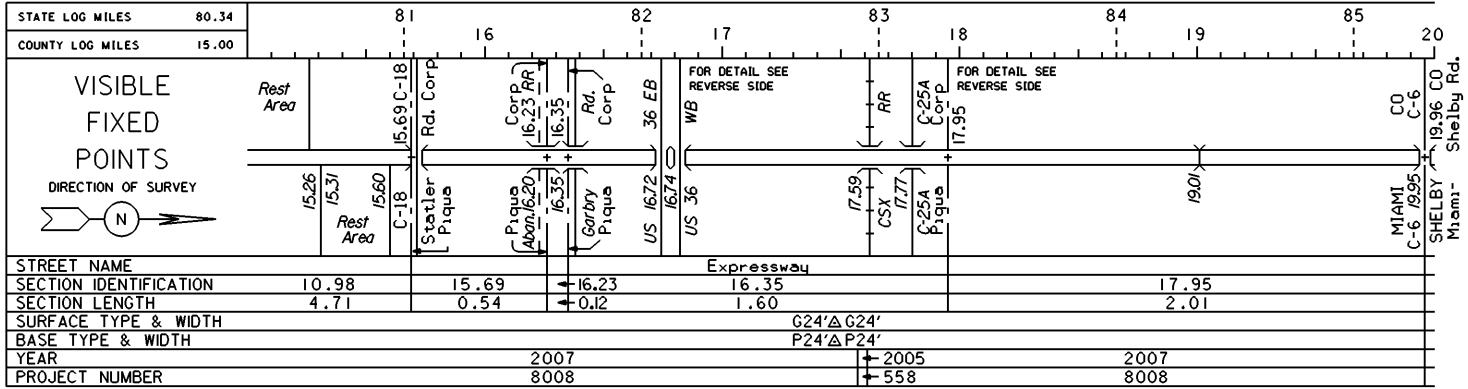

PERPETUATION

VISIBLE

FIXED

POINTS

STREET NAME
SECTION IDENTIFICATION
SECTION LENGTH
SURFACE TYPE & WIDTH
BASE TYPE & WIDTH
YEAR
PROJECT NUMBER

VISIBLE

FIXED

POINTS

STREET NAME
SECTION IDENTIFICATION
SECTION LENGTH
SURFACE TYPE & WIDTH
BASE TYPE & WIDTH
YEAR
PROJECT NUMBER



INTERCHANGE
IR 75 & US 36
MIAMI COUNTY
INTERCHANGE ID NUMBER = 068400

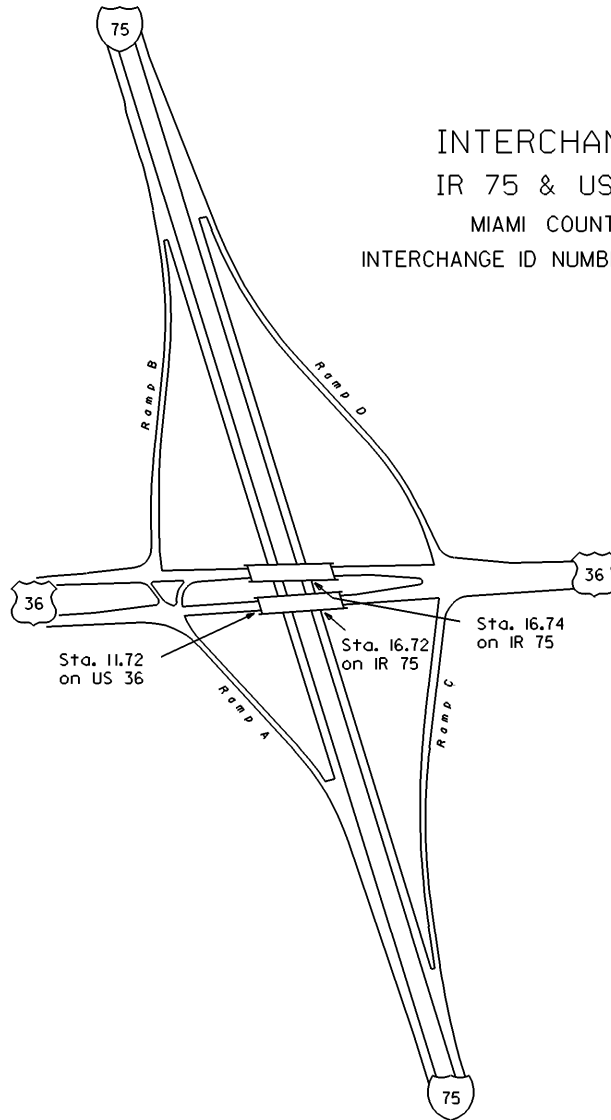

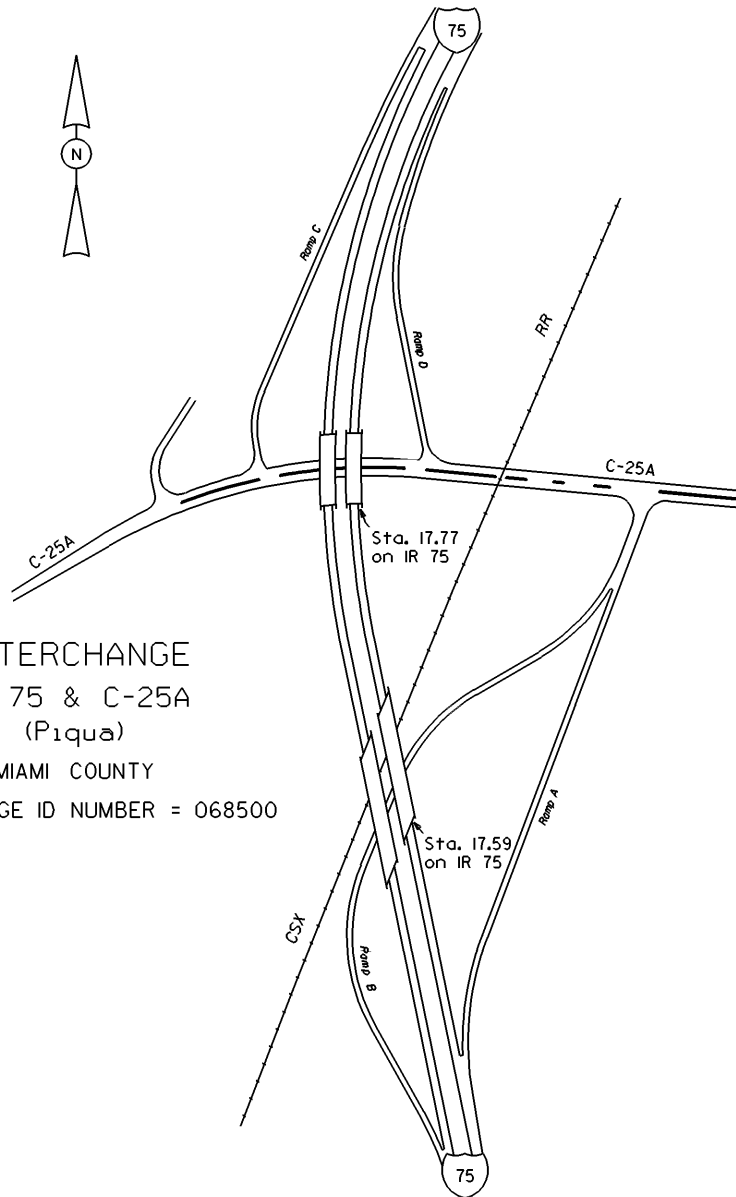

INTERCHANGE
IR 75 & C-25A
(Piqua)
MIAMI COUNTY
INTERCHANGE ID NUMBER = 068500