

STATE OF OHIO - DEPARTMENT OF TRANSPORTATION

STATE ROUTE SECTIONS ON CONTINUOUS MILEAGE STATIONING

DISTRICT	7
COUNTY	MIAMI
ROUTE	SR 41

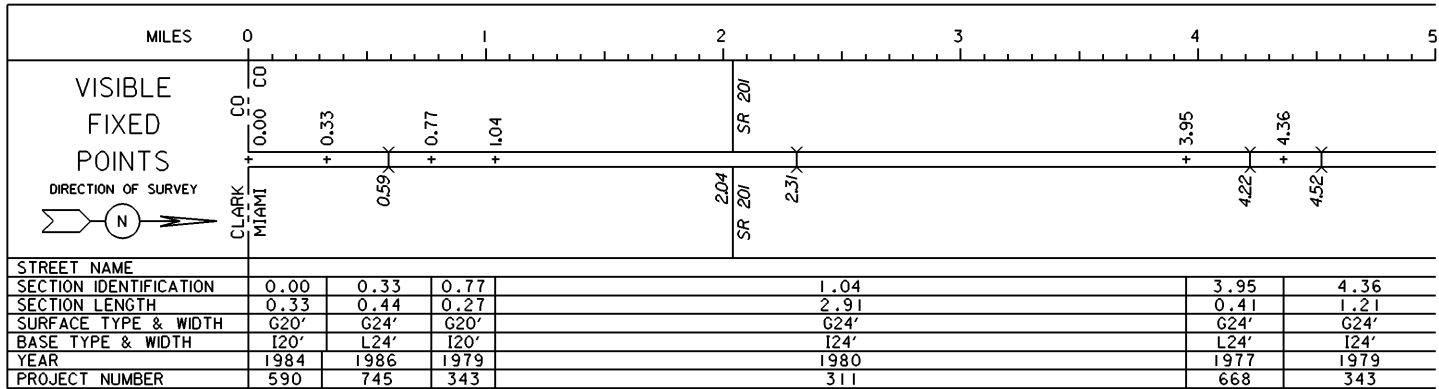

PERPETUATION

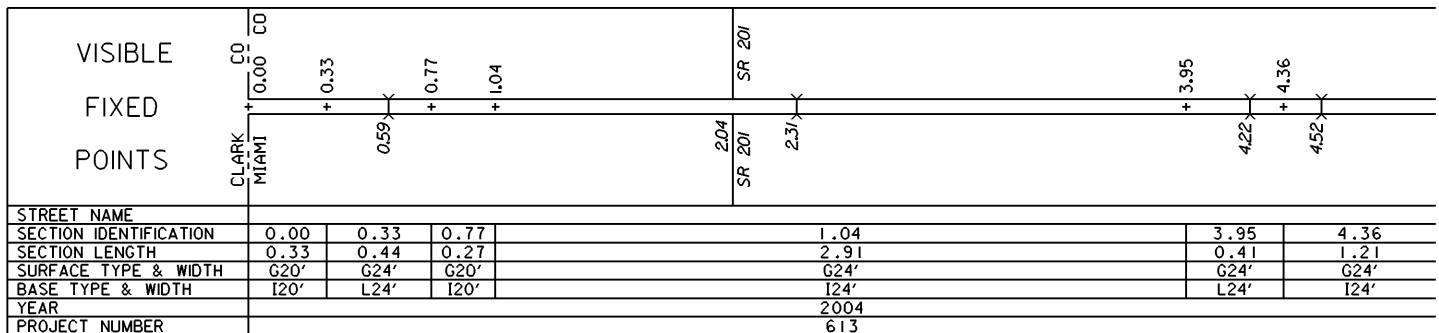
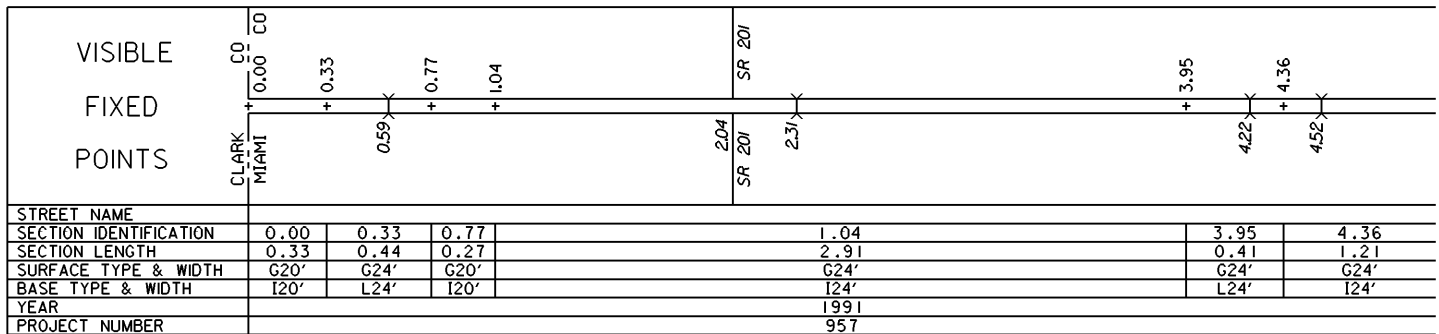

STATE OF OHIO - DEPARTMENT OF TRANSPORTATION
STATE ROUTE SECTIONS ON CONTINUOUS MILEAGE STATIONING

DISTRICT 7
COUNTY MIAMI
ROUTE SR 41

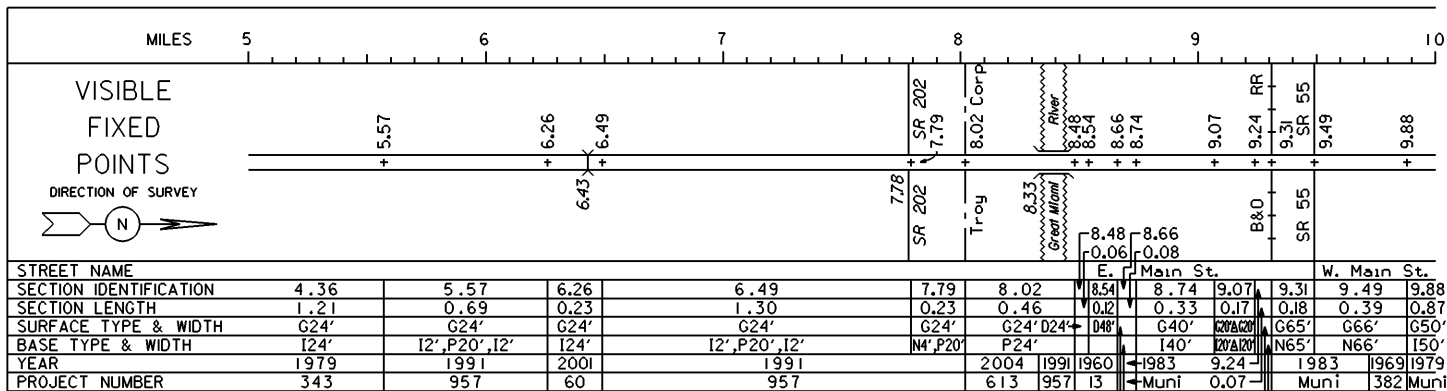

PERPETUATION

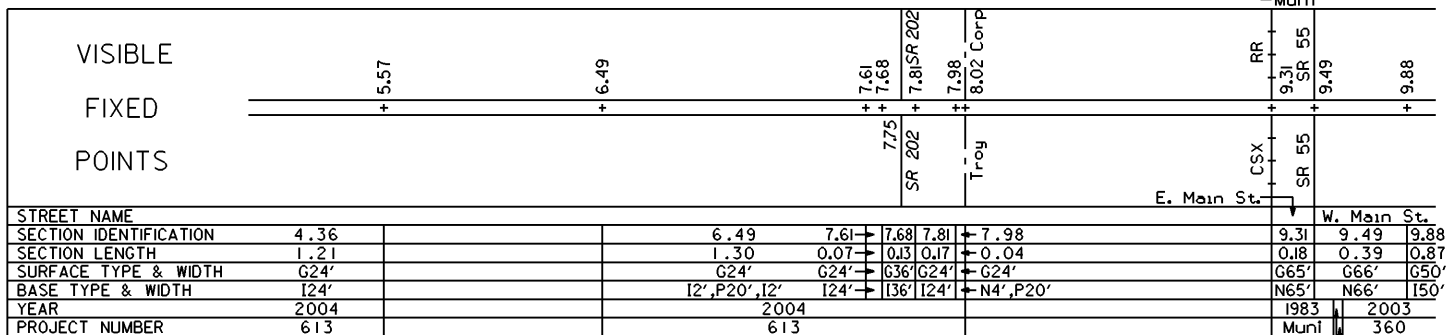
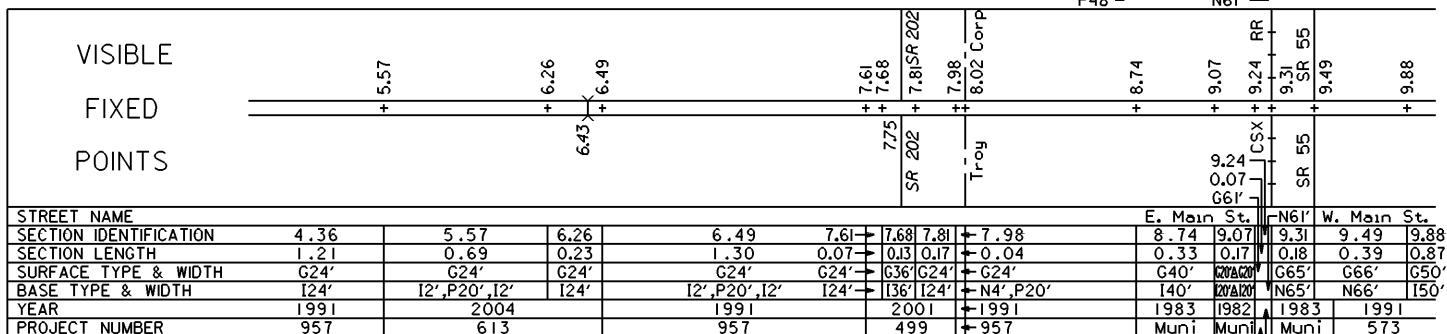

STATE OF OHIO - DEPARTMENT OF TRANSPORTATION
STATE ROUTE SECTIONS ON CONTINUOUS MILEAGE STATIONING

DISTRICT 7
COUNTY MIAMI
ROUTE SR 41

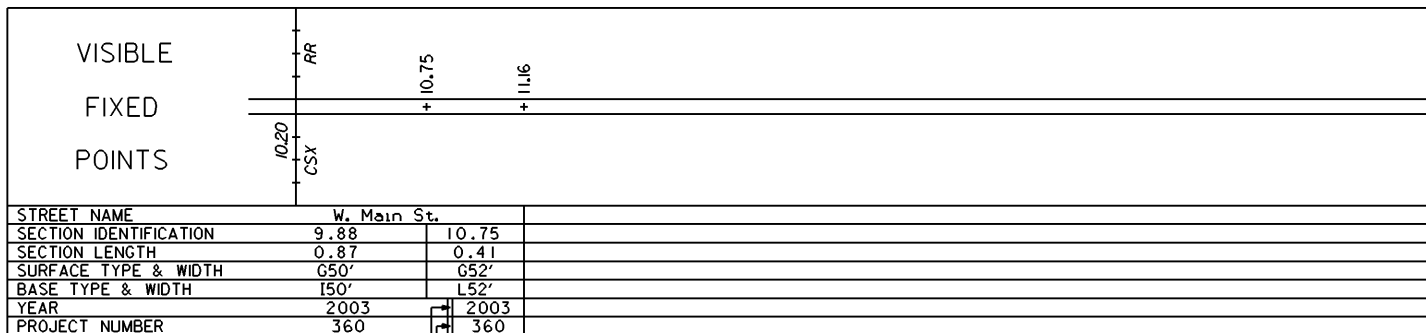
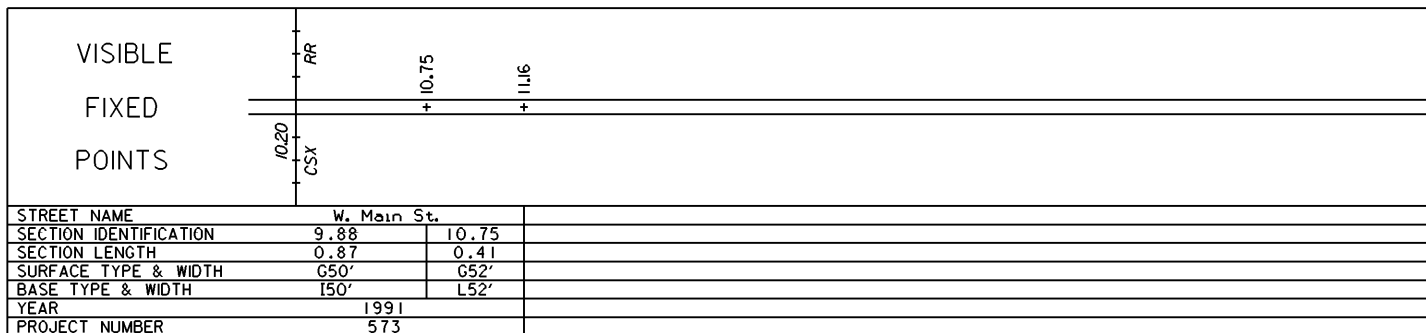
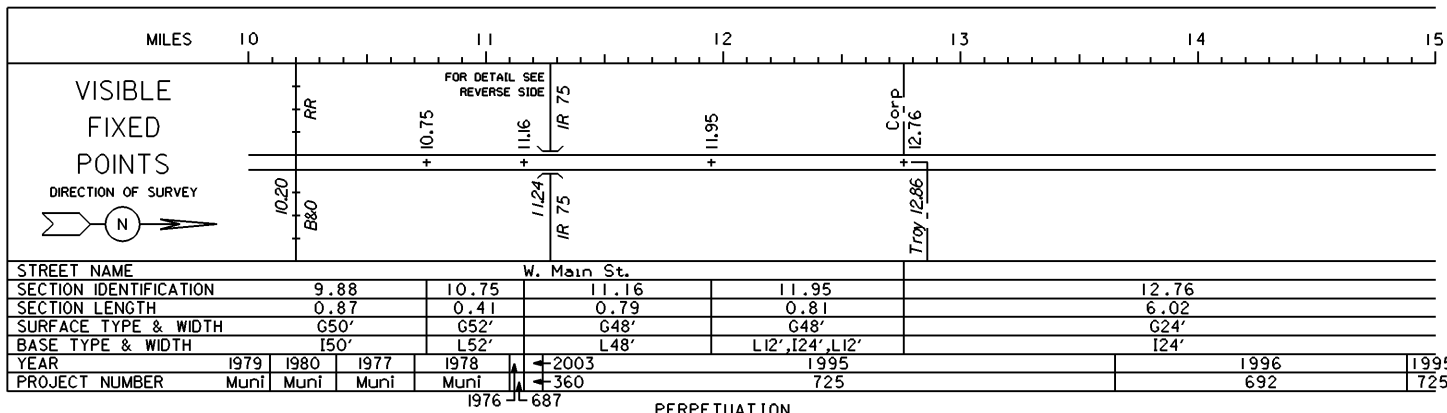

2005
169

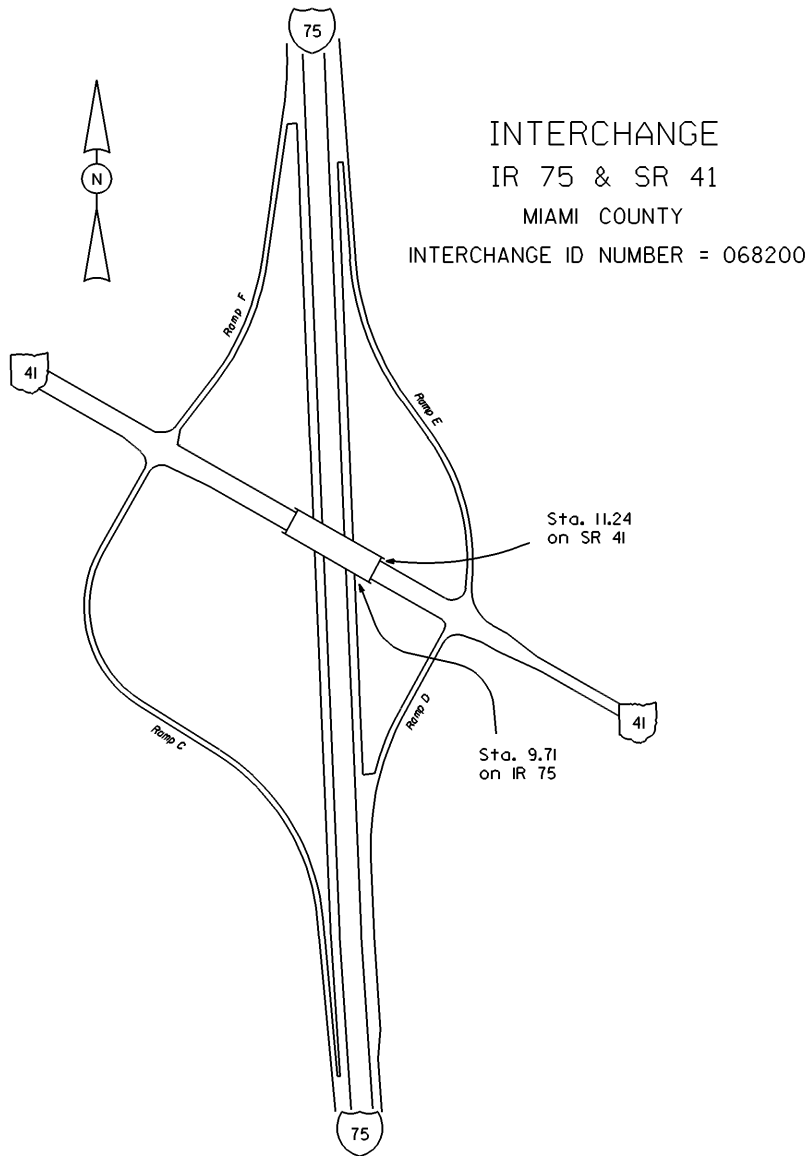

IR75 SHEET 2 OF 4
SR41 SHEET 3 OF 4

STATE OF OHIO - DEPARTMENT OF TRANSPORTATION
STATE ROUTE SECTIONS ON CONTINUOUS MILEAGE STATIONING

DISTRICT 7
COUNTY MIAMI
ROUTE SR 41

MILES	15	16	17	18	19	20			
VISIBLE FIXED POINTS DIRECTION OF SURVEY 						18.78 Corp Covington / 1879	19.04 SR 48 19.07	US 36 19.54	19.54 = 4.08 on US 36 SR 48
						Troy St. 18.78	High St. 19.07	US 36 19.54	
STREET NAME						Troy St.	High St.		
SECTION IDENTIFICATION	12.76					18.78	19.07		
SECTION LENGTH	6.02					0.26	0.47		
SURFACE TYPE & WIDTH	G24'					G20'	G38'		
BASE TYPE & WIDTH	I24'					I20'	T38'		
YEAR	1995					2005	1974		
PROJECT NUMBER	725					407	224		
PERPETUATION									
						SR 48 19.07	US 36 19.54	19.54 = 4.08 on US 36 SR 48	
VISIBLE FIXED POINTS							US 36		
							High St. 19.07		
STREET NAME							High St.		
SECTION IDENTIFICATION							19.07		
SECTION LENGTH							0.47		
SURFACE TYPE & WIDTH							G38'		
BASE TYPE & WIDTH							T38'		
YEAR							1992		
PROJECT NUMBER							911		
VISIBLE FIXED POINTS						SR 48 19.07	US 36 19.54	19.54 = 4.08 on US 36 SR 48	
							US 36		
STREET NAME							High St.		
SECTION IDENTIFICATION							19.07		
SECTION LENGTH							0.47		
SURFACE TYPE & WIDTH							G38'		
BASE TYPE & WIDTH							T38'		
YEAR							2005		
PROJECT NUMBER							407		