

STATE OF OHIO - DEPARTMENT OF TRANSPORTATION

STATE ROUTE SECTIONS ON CONTINUOUS MILEAGE STATIONING

DISTRICT	7
COUNTY	MIAMI
ROUTE	SR 571

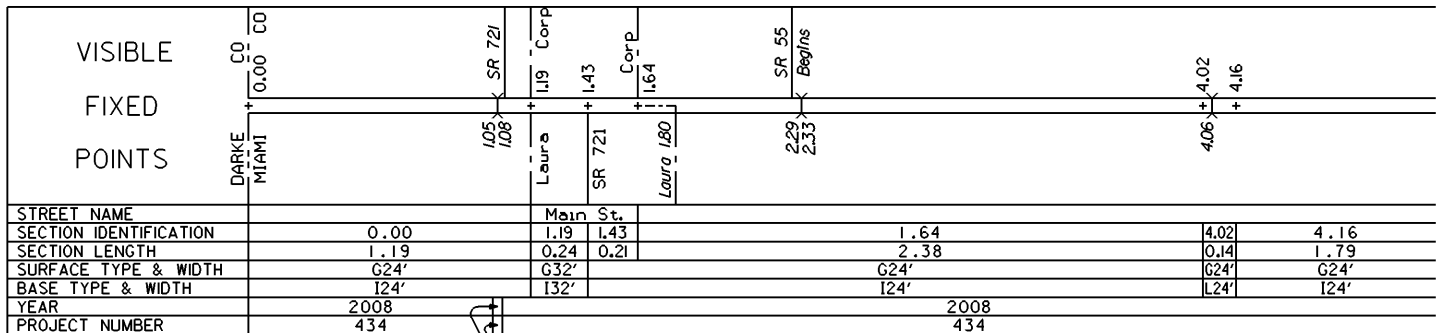
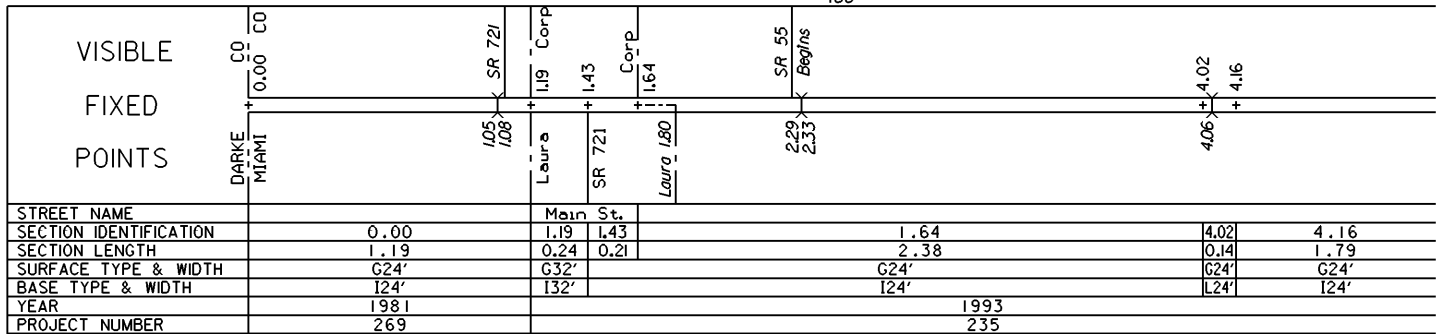
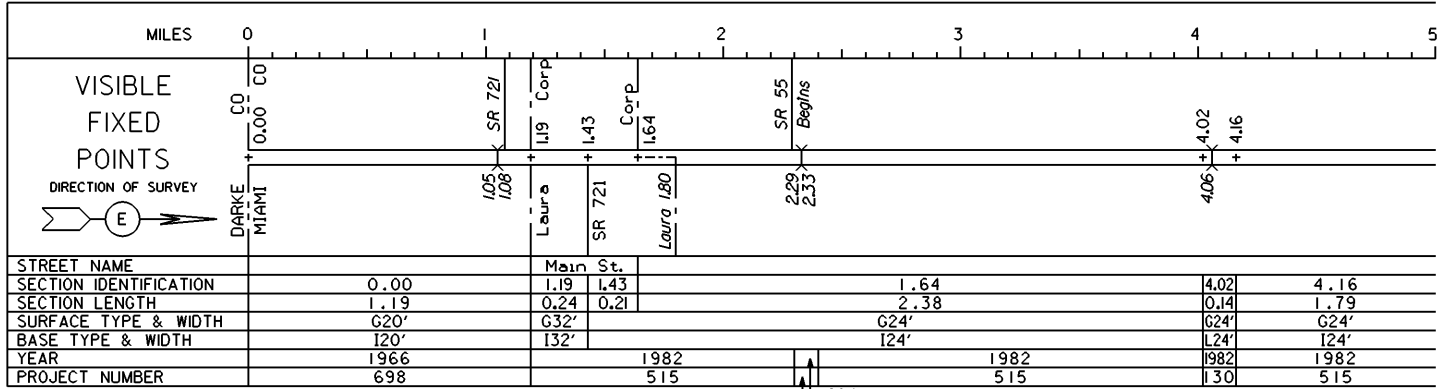

2008
74

STATE OF OHIO - DEPARTMENT OF TRANSPORTATION

STATE ROUTE SECTIONS ON CONTINUOUS MILEAGE STATIONING

DISTRICT 7
 COUNTY MIAMI
 ROUTE SR 571

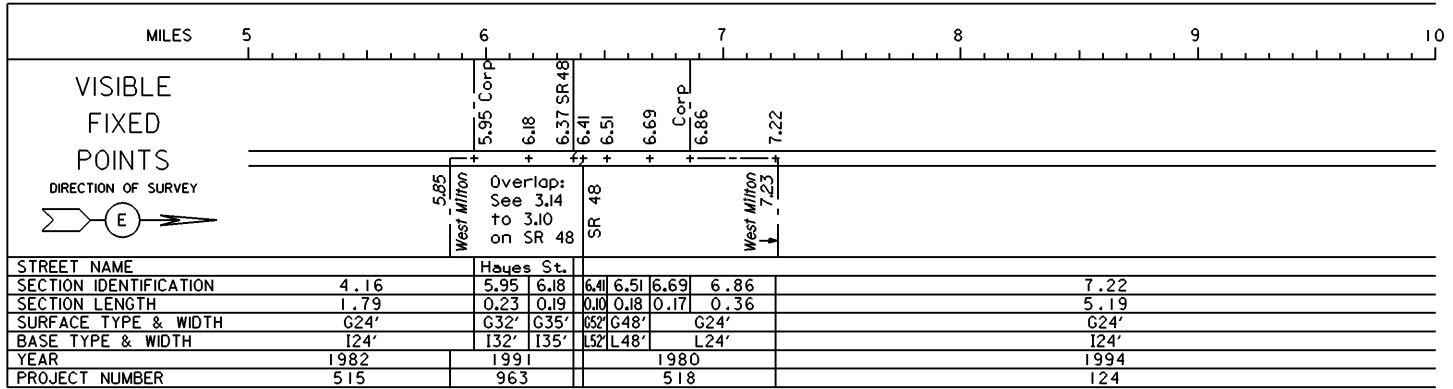

PERPETUATION

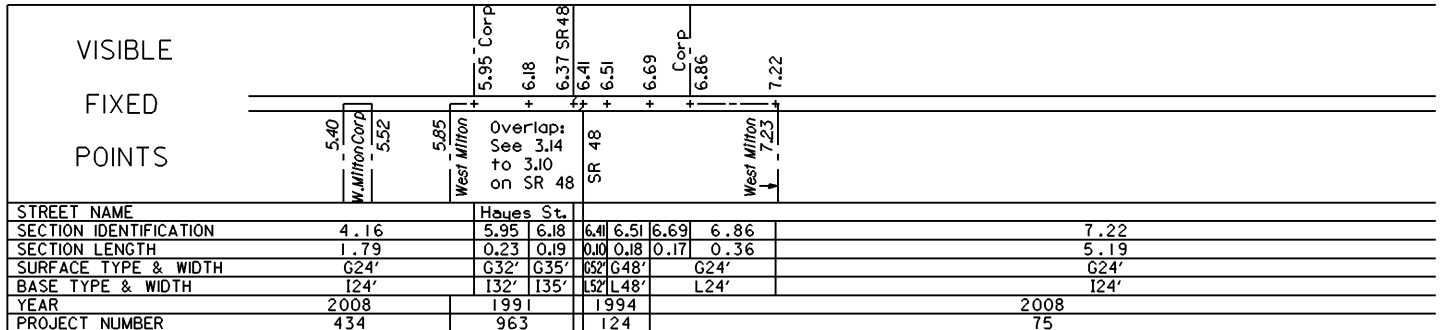
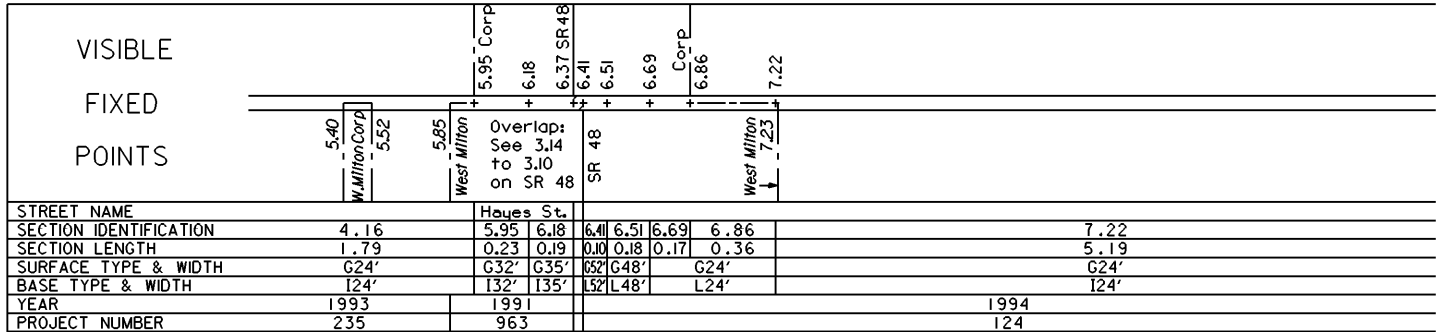

STATE OF OHIO - DEPARTMENT OF TRANSPORTATION
STATE ROUTE SECTIONS ON CONTINUOUS MILEAGE STATIONING

DISTRICT 7
COUNTY MIAMI
ROUTE SR 571

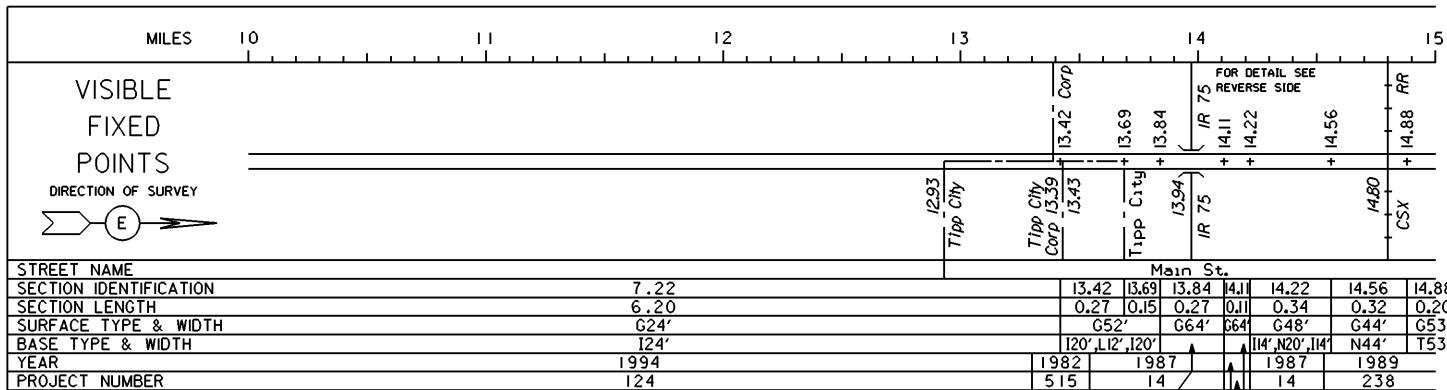

PERPETUATION

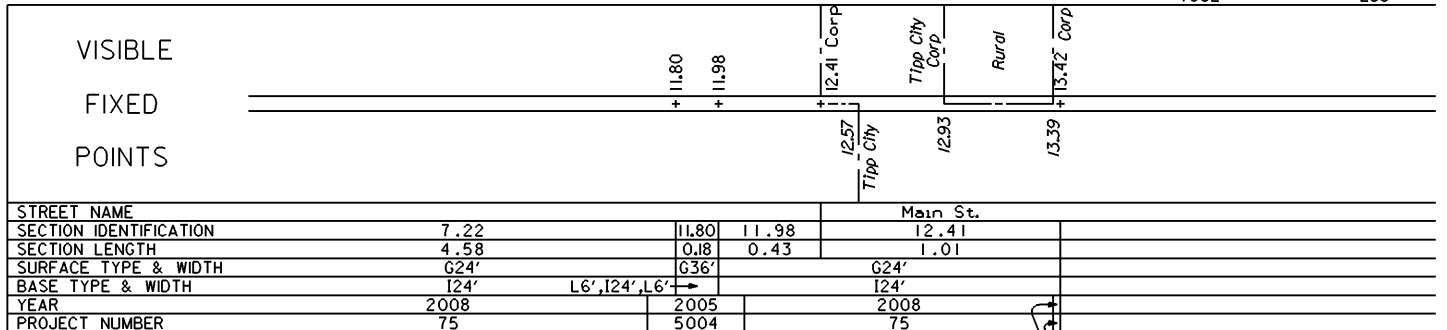
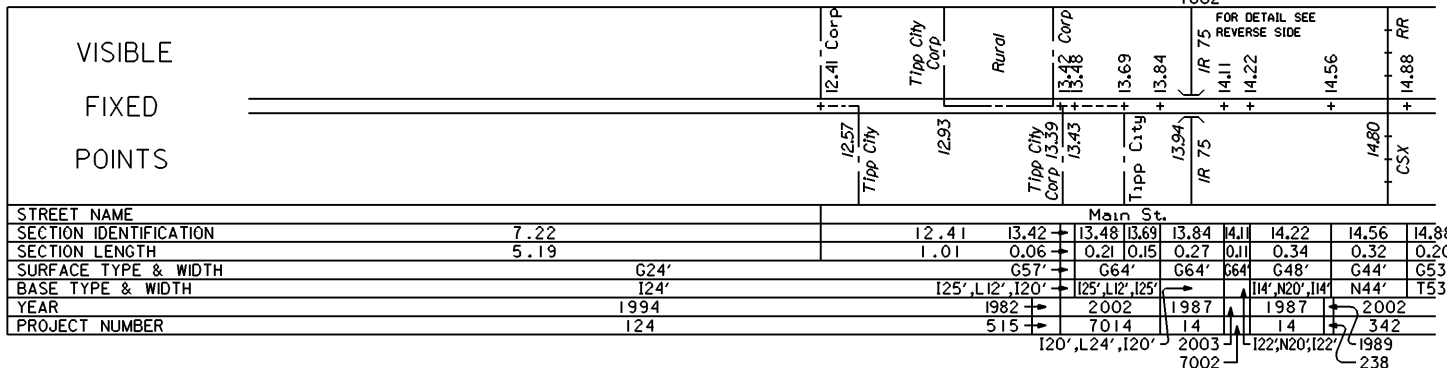

1982
515

INTERCHANGE
IR 75 & SR 571
MIAMI COUNTY
INTERCHANGE ID NUMBER = 067900

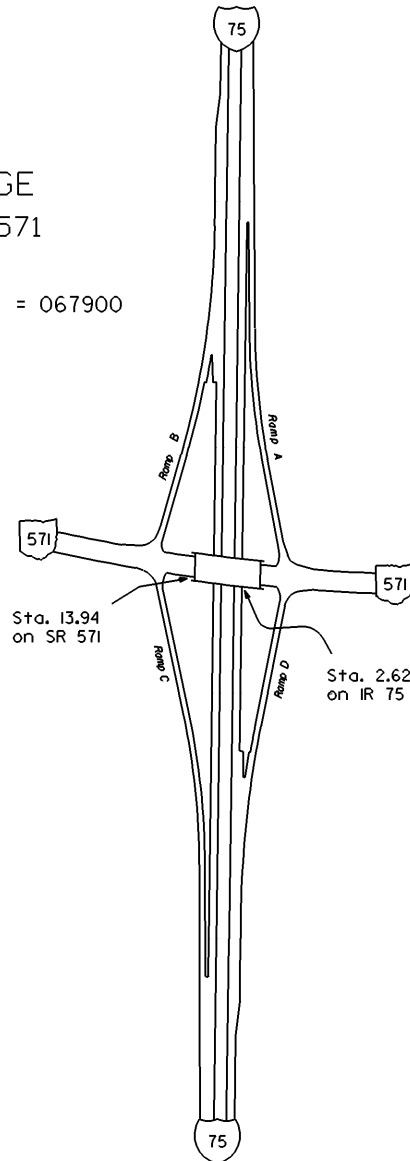

STATE OF OHIO - DEPARTMENT OF TRANSPORTATION
STATE ROUTE SECTIONS ON CONTINUOUS MILEAGE STATIONING

DISTRICT 7
COUNTY MIAMI
ROUTE SR 571

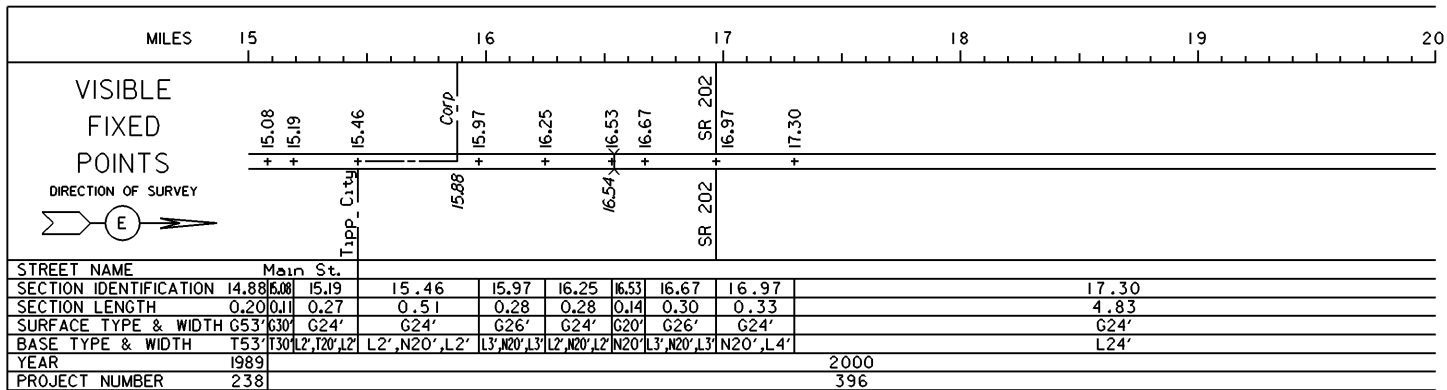

PERPETUATION

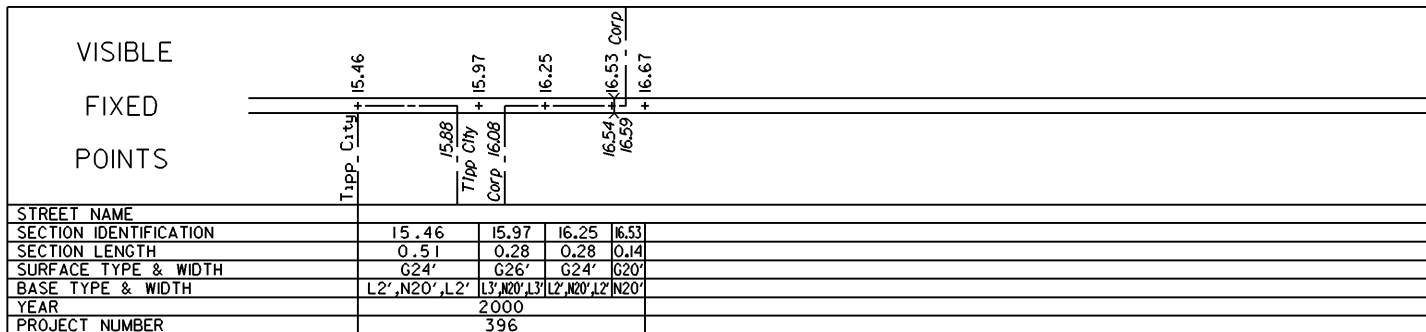
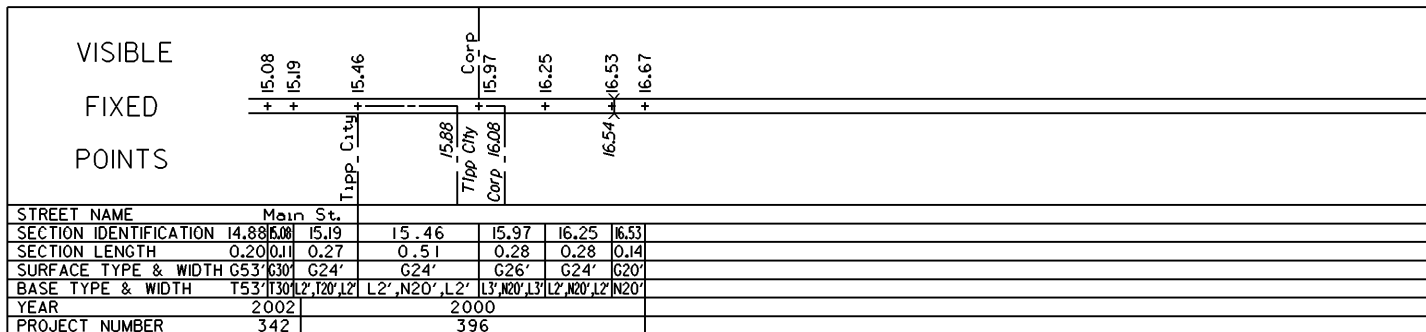

STATE OF OHIO - DEPARTMENT OF TRANSPORTATION

STATE ROUTE SECTIONS ON CONTINUOUS MILEAGE STATIONING

DISTRICT	7
COUNTY	MIAMI
ROUTE	SR 571

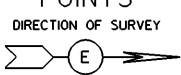
MILES	20.00	20.50	21.00	21.50	22.00	22.50
VISIBLE FIXED POINTS						CO 22.13 CO
DIRECTION OF SURVEY	SR 201					MIAMI CLARK
	2008 SR 201					
STREET NAME						
SECTION IDENTIFICATION	17.30					
SECTION LENGTH	4.83					
SURFACE TYPE & WIDTH	G24'					
BASE TYPE & WIDTH	L24'					
YEAR	2000					
PROJECT NUMBER	396					

PERPETUATION

VISIBLE FIXED POINTS						
STREET NAME						
SECTION IDENTIFICATION						
SECTION LENGTH						
SURFACE TYPE & WIDTH						
BASE TYPE & WIDTH						
YEAR						
PROJECT NUMBER						

VISIBLE FIXED POINTS						
STREET NAME						
SECTION IDENTIFICATION						
SECTION LENGTH						
SURFACE TYPE & WIDTH						
BASE TYPE & WIDTH						
YEAR						
PROJECT NUMBER						