

STATE OF OHIO - DEPARTMENT OF TRANSPORTATION

STATE ROUTE SECTIONS ON CONTINUOUS MILEAGE STATIONING

DISTRICT 5  
 COUNTY MUSKINGUM  
 ROUTE IR 70

STATE LOG MILES	142.30	143	143.73	144.22	145	146	147	5
COUNTY LOG MILES	0.00							
VISIBLE FIXED POINTS DIRECTION OF SURVEY 	CO MUSKINGUM 0.00 CO	C-30 Rd. 0.76 +	FOR DETAIL SEE REVERSE SIDE	CO MUSKINGUM 1.46 CO	198	C-28 Rd. 2.99 S. Hopewell	C-34 Rd. 4.60 Ridge	
STREET NAME								
SECTION IDENTIFICATION	0.00	0.76				1.46		
SECTION LENGTH	0.76	0.70				4.27		
SURFACE TYPE & WIDTH	G24' Δ G24'					G24' Δ G24'		
BASE TYPE & WIDTH	L24' Δ L24'					H24' Δ H24'		
YEAR	1999					1994		
PROJECT NUMBER	401					833		

PERPETUATION

VISIBLE  
 FIXED  
 POINTS

=====

STREET NAME	
SECTION IDENTIFICATION	
SECTION LENGTH	
SURFACE TYPE & WIDTH	
BASE TYPE & WIDTH	
YEAR	
PROJECT NUMBER	

VISIBLE  
 FIXED  
 POINTS

=====

STREET NAME	
SECTION IDENTIFICATION	
SECTION LENGTH	
SURFACE TYPE & WIDTH	
BASE TYPE & WIDTH	
YEAR	
PROJECT NUMBER	

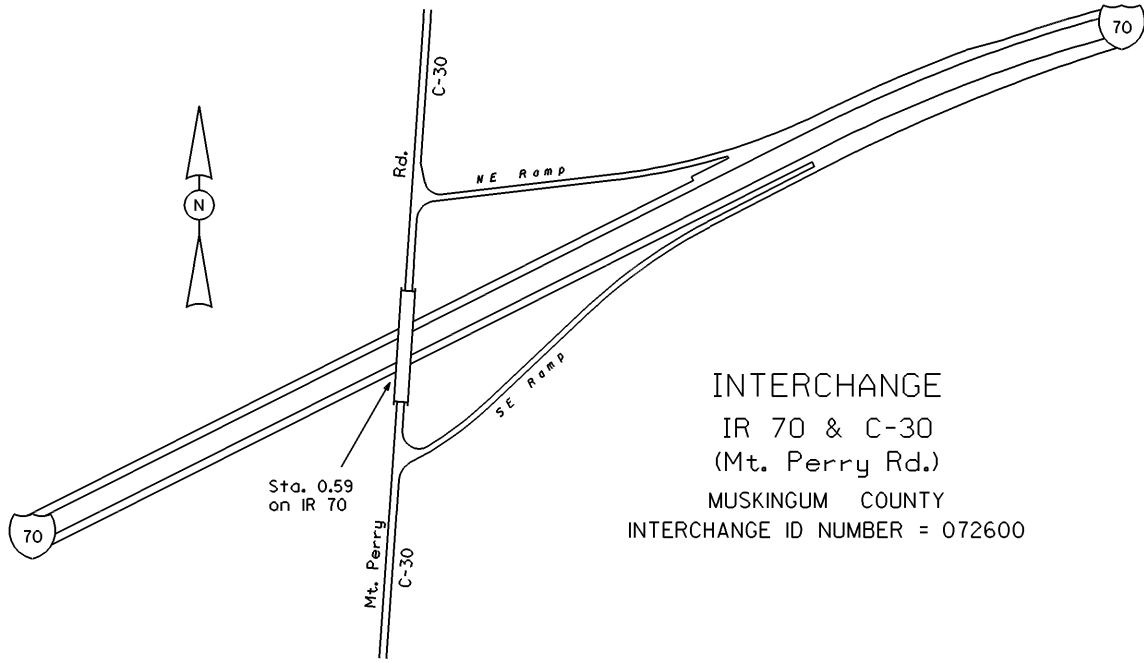

INTERCHANGE  
IR 70 & C-30  
(Mt. Perry Rd.)  
MUSKINGUM COUNTY  
INTERCHANGE ID NUMBER = 072600

# STATE OF OHIO - DEPARTMENT OF TRANSPORTATION

STATE ROUTE SECTIONS ON CONTINUOUS MILEAGE STATIONING

DISTRICT	5
COUNTY	MUSKINGUM
ROUTE	1R 70

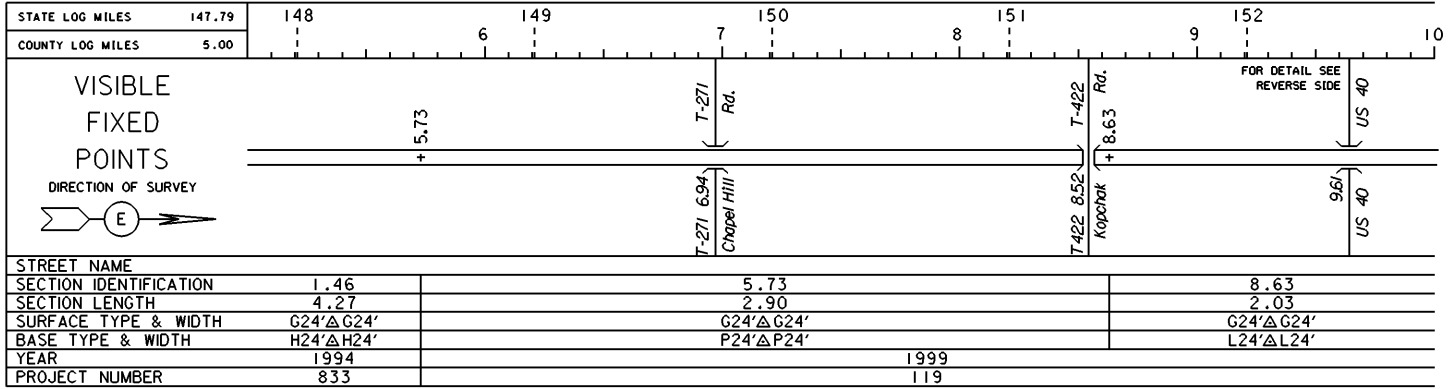

PERPETUATION

VISIBLE  
FIXED  
POINTS

STREET NAME	
SECTION IDENTIFICATION	
SECTION LENGTH	
SURFACE TYPE & WIDTH	
BASE TYPE & WIDTH	
YEAR	
PROJECT NUMBER	

VISIBLE  
FIXED  
POINTS

STREET NAME	
SECTION IDENTIFICATION	
SECTION LENGTH	
SURFACE TYPE & WIDTH	
BASE TYPE & WIDTH	
YEAR	
PROJECT NUMBER	

INTERCHANGE  
IR 70 & US 40  
MUSKINGUM COUNTY  
INTERCHANGE ID NUMBER = 072700

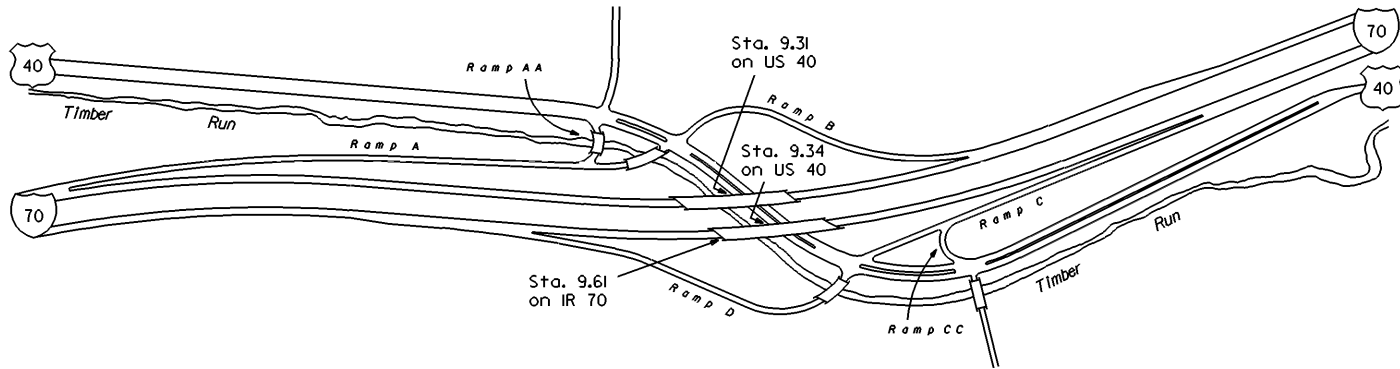
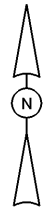

STATE OF OHIO - DEPARTMENT OF TRANSPORTATION

STATE ROUTE SECTIONS ON CONTINUOUS MILEAGE STATIONING

DISTRICT 5  
 COUNTY MUSKINGUM  
 ROUTE IR 70

STATE LOG MILES	152.79	153	10.50	11.00	11.50	12.00	12.50
COUNTY LOG MILES	10.00						
VISIBLE FIXED POINTS DIRECTION OF SURVEY 							
STREET NAME							
SECTION IDENTIFICATION	8.63	10.66	10.92	10.97	11.59	11.76	12.16
SECTION LENGTH	2.03	0.26	0.05	0.62	0.17	0.40	0.96
SURFACE TYPE & WIDTH	G24'ΔG24'	D24'ΔD24'		G24'ΔG24'	G36'ΔG36'	D24'ΔD24'	G24'ΔG24'
BASE TYPE & WIDTH	L24'ΔL24'			L24'ΔL24'	P36'ΔP36'		L24'ΔL24'
YEAR		1999				1991	1999
PROJECT NUMBER		119				458	119

PERPETUATION

VISIBLE

FIXED

POINTS

STREET NAME	
SECTION IDENTIFICATION	
SECTION LENGTH	
SURFACE TYPE & WIDTH	
BASE TYPE & WIDTH	
YEAR	
PROJECT NUMBER	

VISIBLE

FIXED

POINTS

STREET NAME	
SECTION IDENTIFICATION	
SECTION LENGTH	
SURFACE TYPE & WIDTH	
BASE TYPE & WIDTH	
YEAR	
PROJECT NUMBER	

INTERCHANGE  
IR 70 & SR 60G  
MUSKINGUM COUNTY  
INTERCHANGE ID NUMBER = 072800

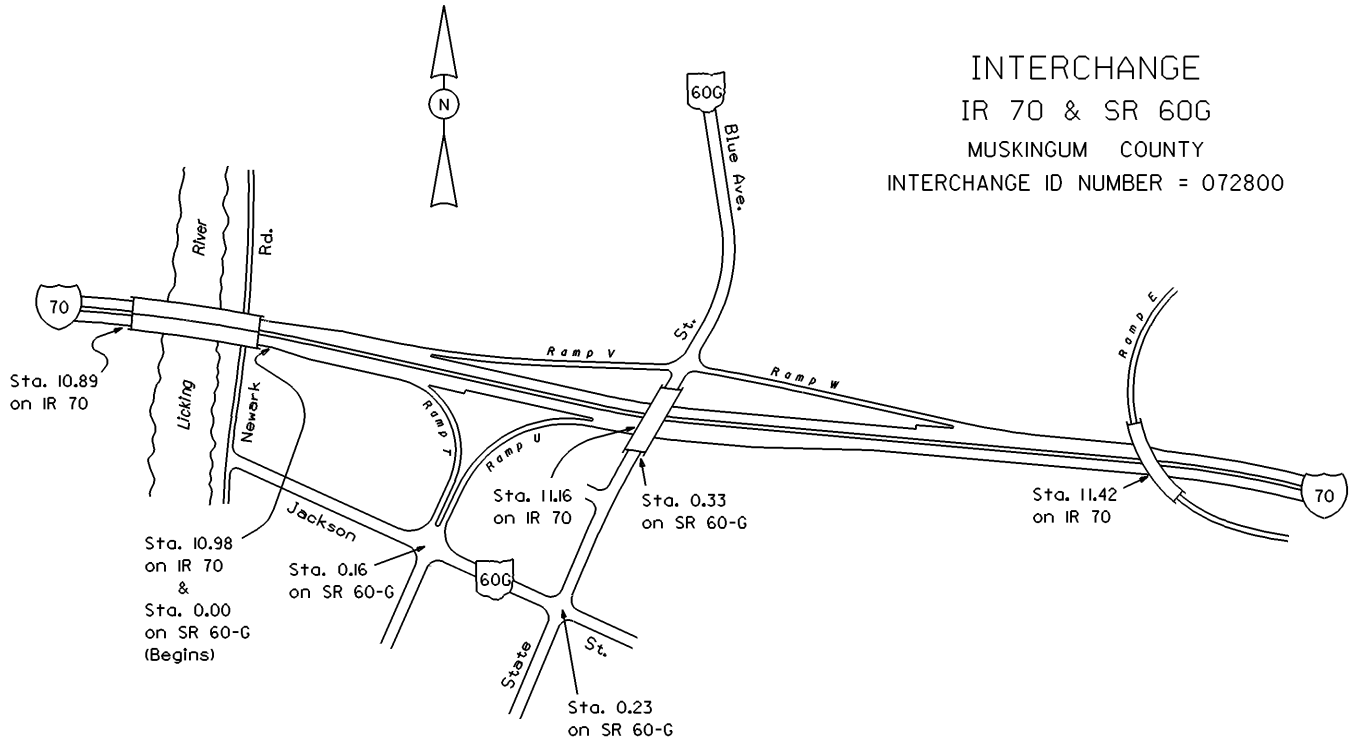



INTERCHANGE  
IR 70 & Maple Ave.  
MUSKINGUM COUNTY  
INTERCHANGE ID NUMBER = 072830

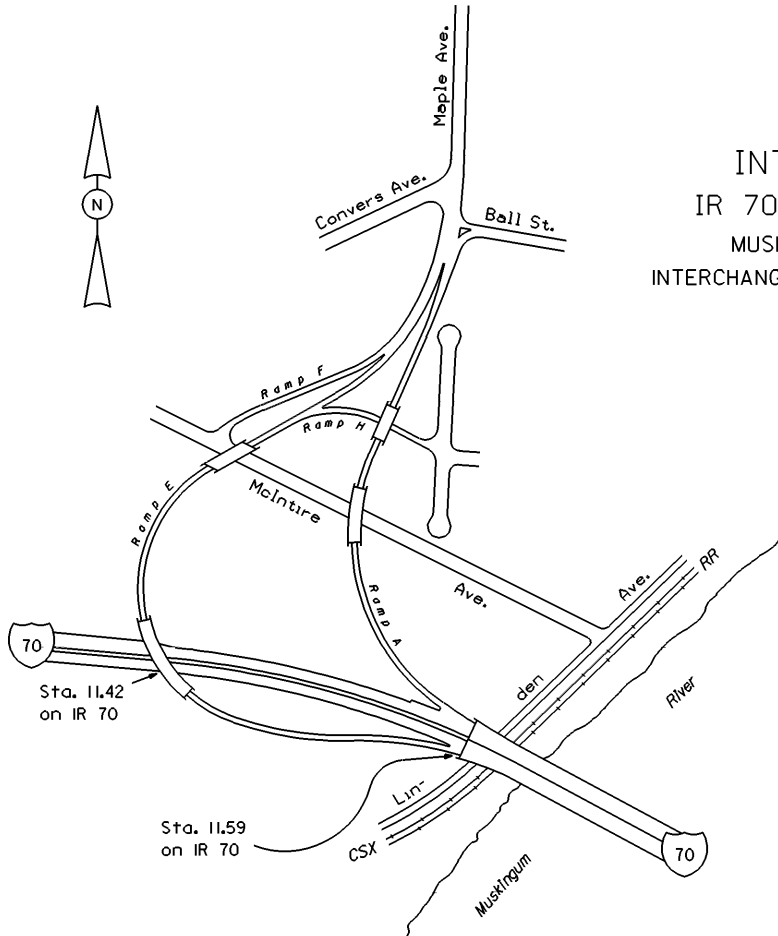

INTERCHANGE  
 IR 70, SRs 60, 60D,  
 146 & 146D  
 MUSKINGUM COUNTY  
 INTERCHANGE ID NUMBER = 072860

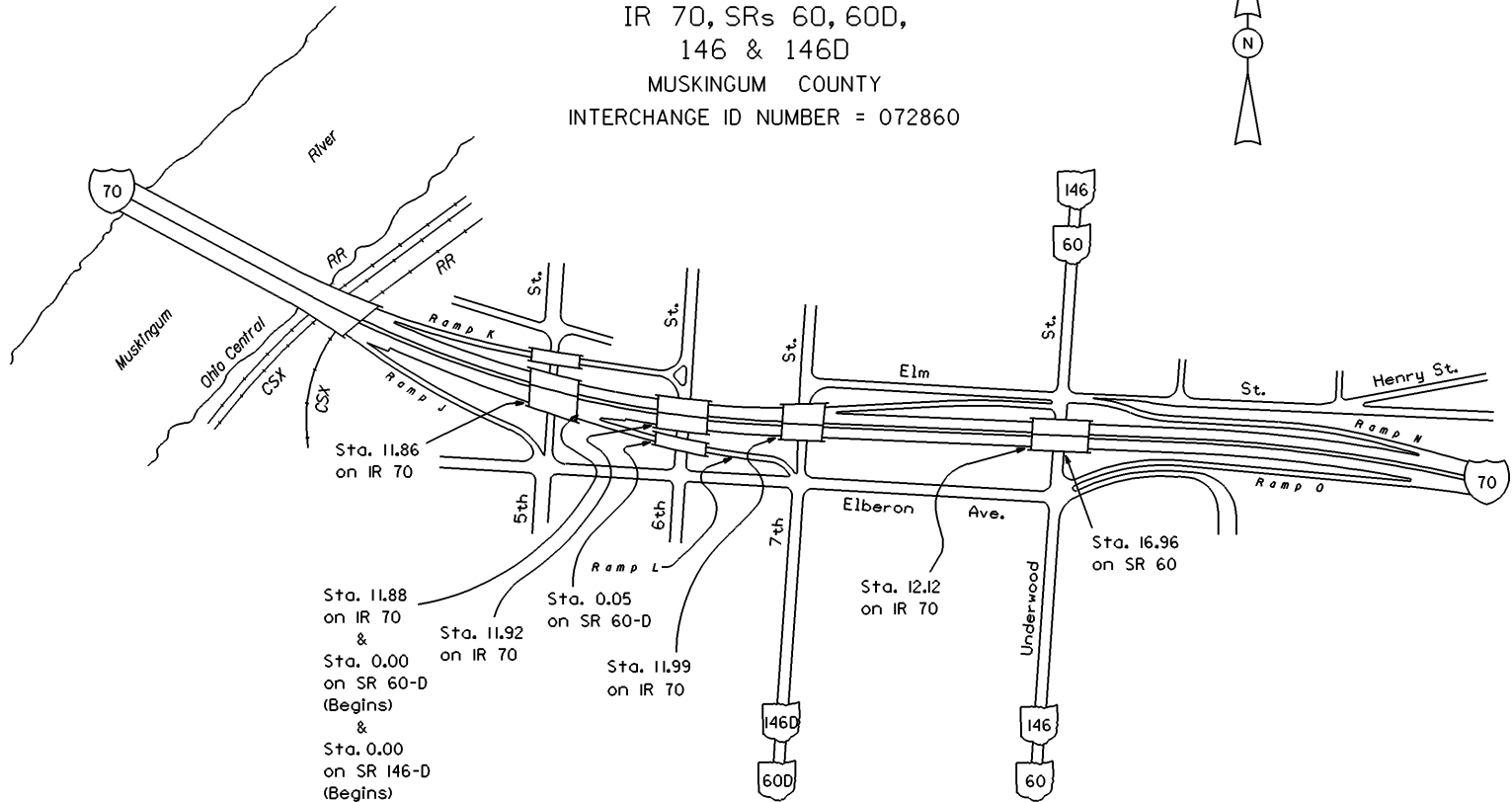

IR70 SHEET 3 OF 7  
 SR60 SHEET 4 OF 8  
 SR60D SHEET 1 OF 1



# STATE OF OHIO - DEPARTMENT OF TRANSPORTATION

STATE ROUTE SECTIONS ON CONTINUOUS MILEAGE STATIONING

DISTRICT 5  
 COUNTY MUSKINGUM  
 ROUTE IR 70

STATE LOG MILES	155.29	13.00      156      13.50      14.00      157      14.50      15.00				
COUNTY LOG MILES	12.50					
VISIBLE FIXED POINTS DIRECTION OF SURVEY 	12.61 Hamline Ave.	13.06 Abner Zanesville Corporation RR	13.12 + 13.22	14.30 + 14.38	14.47 + 14.47	FOR DETAIL SEE REVERSE SIDE SR 93
STREET NAME						
SECTION IDENTIFICATION	12.16	13.12	13.22	14.30	14.47	
SECTION LENGTH	0.96	0.10	1.08	0.17	1.57	
SURFACE TYPE & WIDTH	G24'Δ G24'		G24'Δ G24'	G24'Δ G24'	G24'Δ G24'	
BASE TYPE & WIDTH	L24'Δ L24'		H24'Δ H24'	L24'Δ L24'	H24'Δ H24'	
YEAR	1999			1998		
PROJECT NUMBER	119			92		

### PERPETUATION

VISIBLE  
FIXED  
POINTS

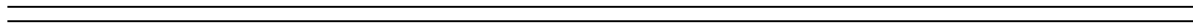

STREET NAME	
SECTION IDENTIFICATION	
SECTION LENGTH	
SURFACE TYPE & WIDTH	
BASE TYPE & WIDTH	
YEAR	
PROJECT NUMBER	

VISIBLE  
FIXED  
POINTS

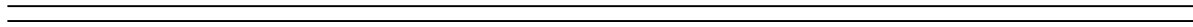

STREET NAME	
SECTION IDENTIFICATION	
SECTION LENGTH	
SURFACE TYPE & WIDTH	
BASE TYPE & WIDTH	
YEAR	
PROJECT NUMBER	

INTERCHANGE  
IR 70 & SR 93  
MUSKINGUM COUNTY  
INTERCHANGE ID NUMBER = 072900

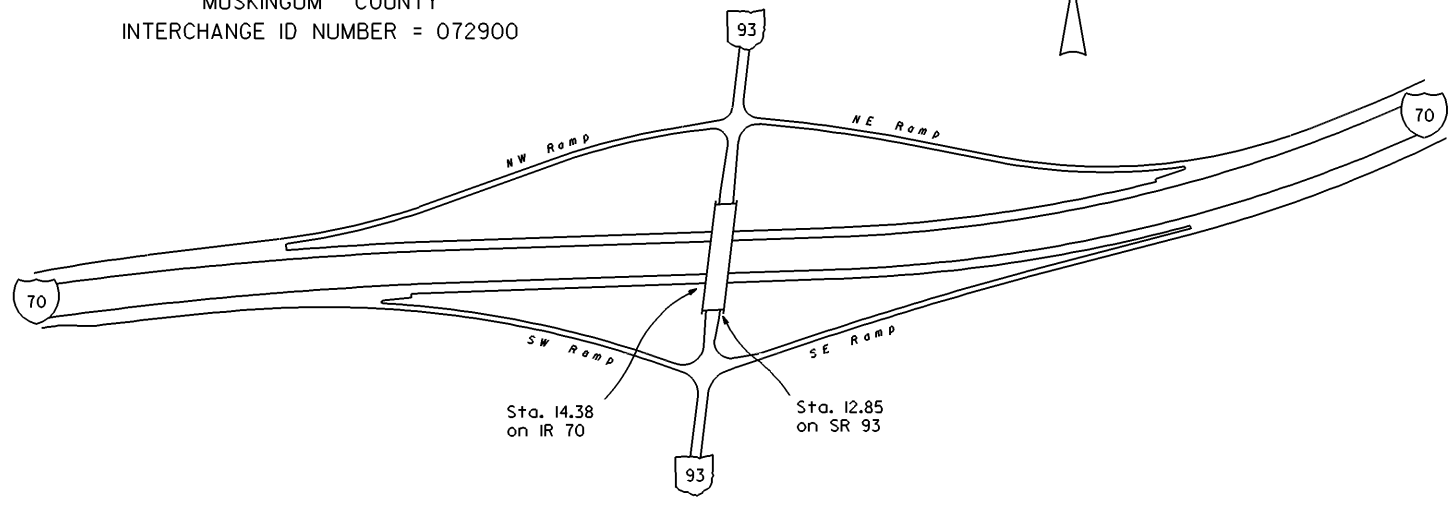
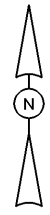

# STATE OF OHIO - DEPARTMENT OF TRANSPORTATION

STATE ROUTE SECTIONS ON CONTINUOUS MILEAGE STATIONING

DISTRICT	5
COUNTY	MUSKINGUM
ROUTE	1R 70

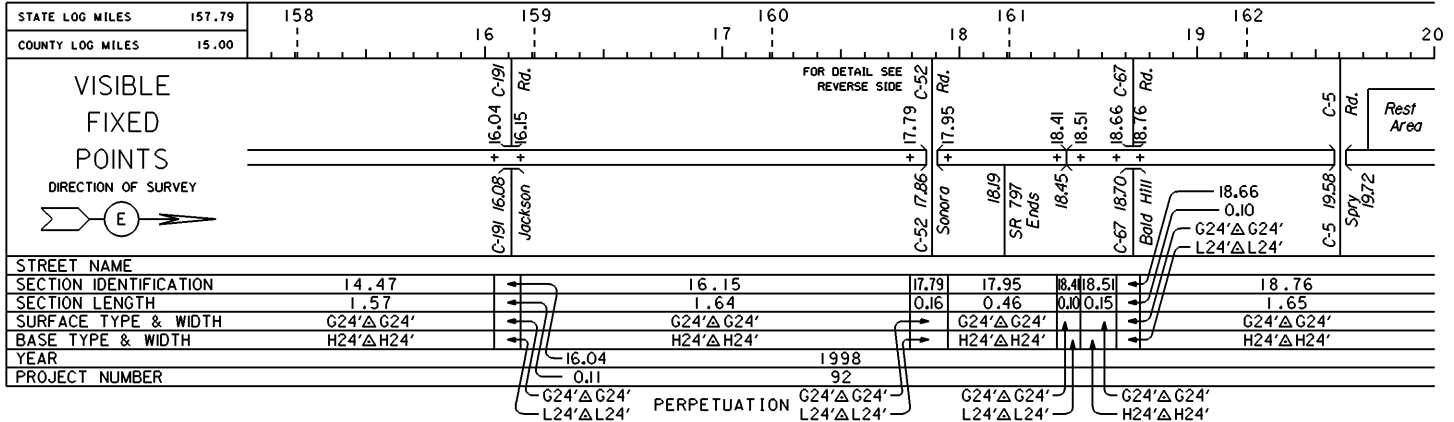

VISIBLE  
FIXED  
POINTS

STREET NAME	
SECTION IDENTIFICATION	
SECTION LENGTH	
SURFACE TYPE & WIDTH	
BASE TYPE & WIDTH	
YEAR	
PROJECT NUMBER	

VISIBLE  
FIXED  
POINTS

STREET NAME	
SECTION IDENTIFICATION	
SECTION LENGTH	
SURFACE TYPE & WIDTH	
BASE TYPE & WIDTH	
YEAR	
PROJECT NUMBER	

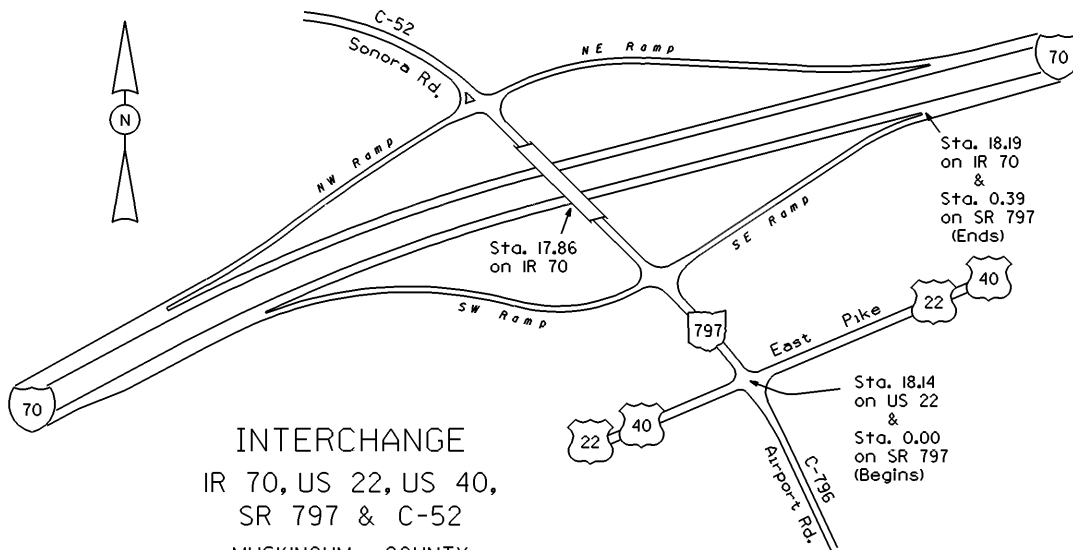

INTERCHANGE  
 IR 70, US 22, US 40,  
 SR 797 & C-52  
 MUSKINGUM COUNTY  
 INTERCHANGE ID NUMBER = 073000

Sta. 18.19  
 on IR 70  
 &  
 Sta. 0.39  
 on SR 797  
 (Ends)

Sta. 18.14  
 on US 22  
 &  
 Sta. 0.00  
 on SR 797  
 (Begins)

# STATE OF OHIO - DEPARTMENT OF TRANSPORTATION

STATE ROUTE SECTIONS ON CONTINUOUS MILEAGE STATIONING

DISTRICT	5
COUNTY	MUSKINGUM
ROUTE	1R 70

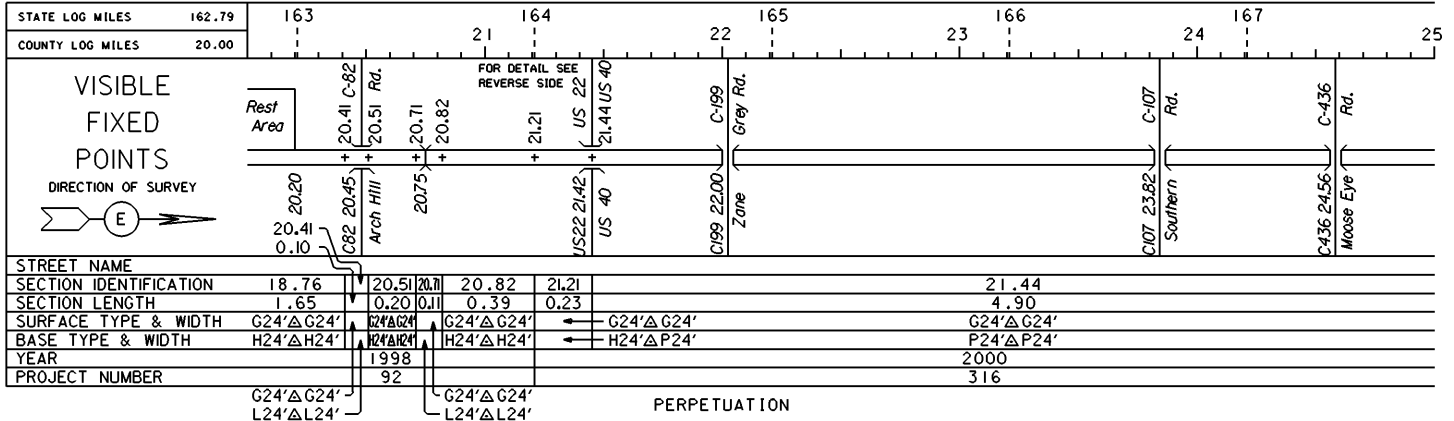

VISIBLE  
FIXED  
POINTS

\_\_\_\_\_

STREET NAME	
SECTION IDENTIFICATION	
SECTION LENGTH	
SURFACE TYPE & WIDTH	
BASE TYPE & WIDTH	
YEAR	
PROJECT NUMBER	

VISIBLE  
FIXED  
POINTS

\_\_\_\_\_

STREET NAME	
SECTION IDENTIFICATION	
SECTION LENGTH	
SURFACE TYPE & WIDTH	
BASE TYPE & WIDTH	
YEAR	
PROJECT NUMBER	

INTERCHANGE  
IR 70, US 22 & US 40  
MUSKINGUM COUNTY  
INTERCHANGE ID NUMBER = 073100

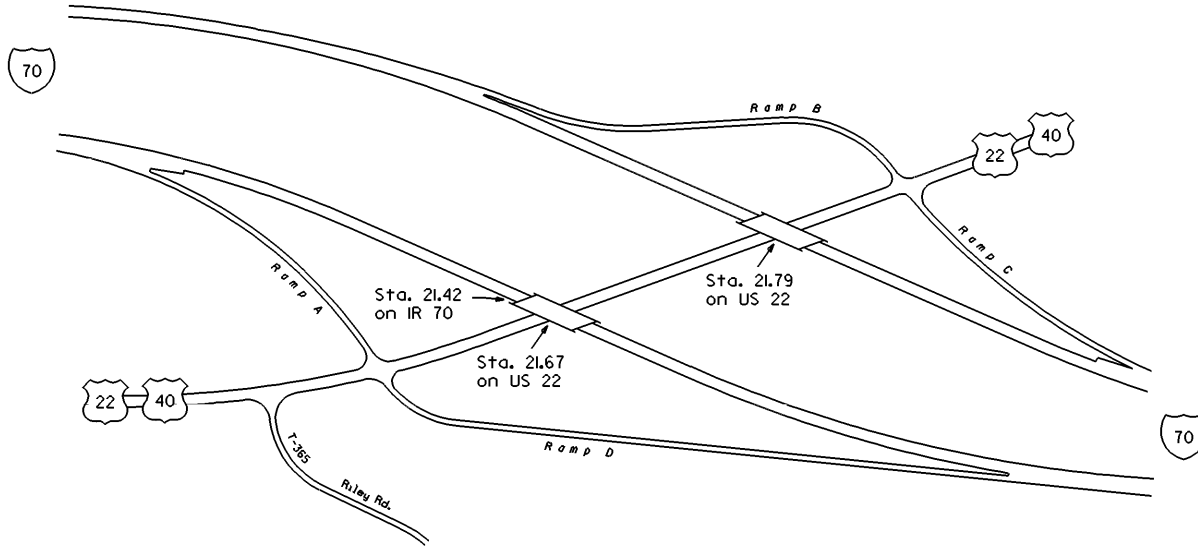

# STATE OF OHIO - DEPARTMENT OF TRANSPORTATION

STATE ROUTE SECTIONS ON CONTINUOUS MILEAGE STATIONING

DISTRICT	5
COUNTY	MUSKINGUM
ROUTE	1R 70

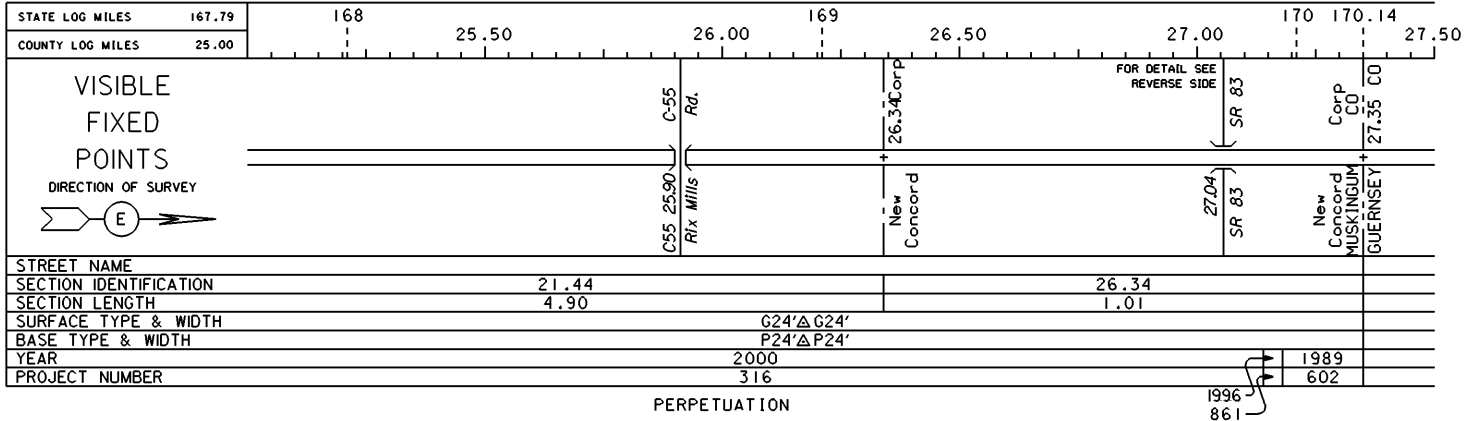

VISIBLE  
FIXED  
POINTS

---



---

STREET NAME	
SECTION IDENTIFICATION	
SECTION LENGTH	
SURFACE TYPE & WIDTH	
BASE TYPE & WIDTH	
YEAR	
PROJECT NUMBER	

VISIBLE  
FIXED  
POINTS

---



---

STREET NAME	
SECTION IDENTIFICATION	
SECTION LENGTH	
SURFACE TYPE & WIDTH	
BASE TYPE & WIDTH	
YEAR	
PROJECT NUMBER	

INTERCHANGE  
IR 70 & SR 83  
MUSKINGUM COUNTY  
INTERCHANGE ID NUMBER = 073200

