

STATE OF OHIO - DEPARTMENT OF TRANSPORTATION  
STATE ROUTE SECTIONS ON CONTINUOUS MILEAGE STATIONING

DISTRICT 10  
COUNTY NOBLE  
ROUTE SR 83

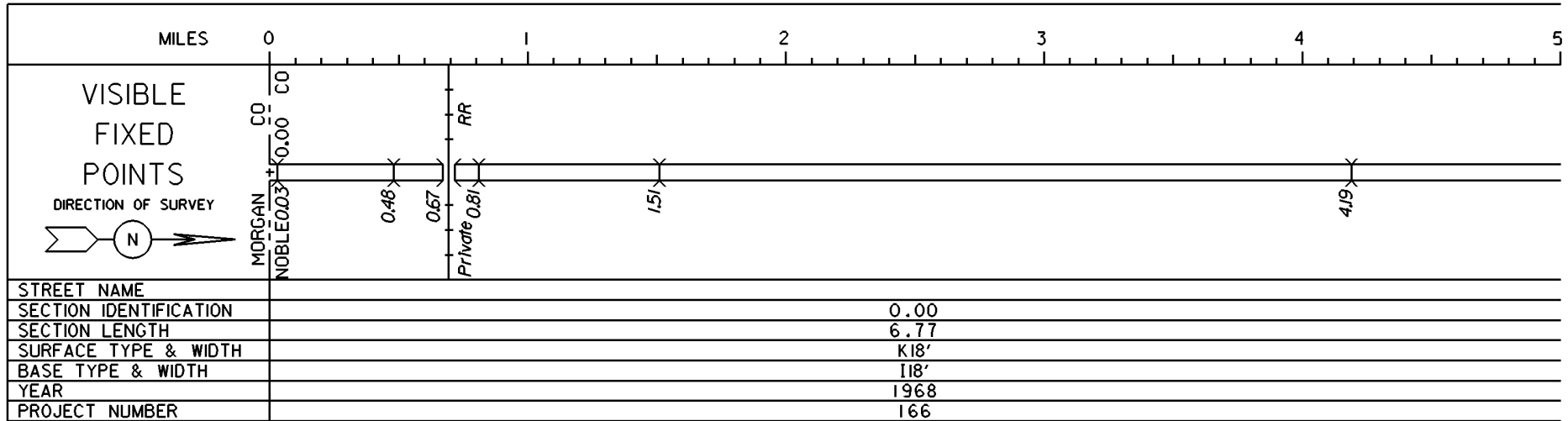

PERPETUATION

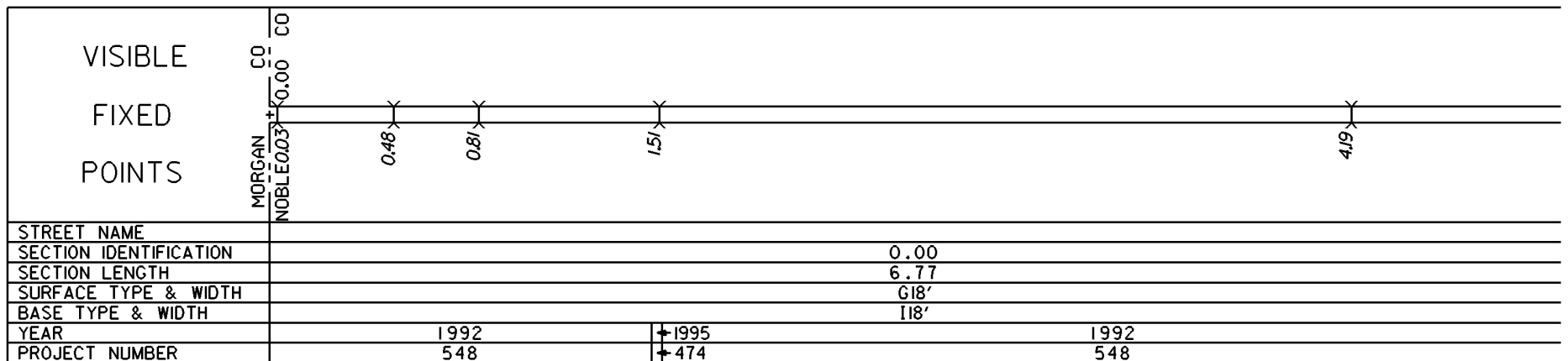
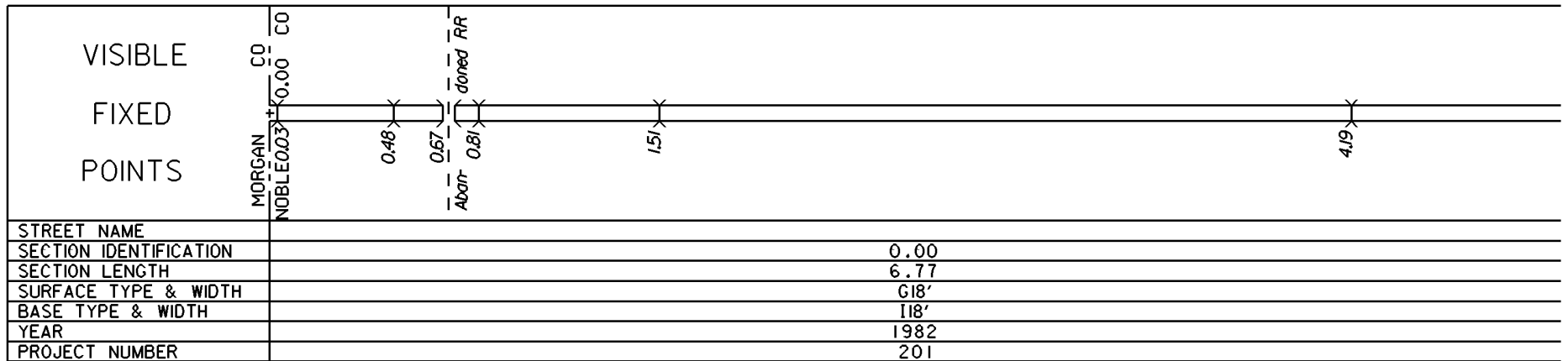

STATE OF OHIO - DEPARTMENT OF TRANSPORTATION  
STATE ROUTE SECTIONS ON CONTINUOUS MILEAGE STATIONING

DISTRICT 10  
COUNTY NOBLE  
ROUTE SR 83

MILES	5.00	5.50	6.00	6.50	7.00	7.50
VISIBLE FIXED POINTS			RR		CO	CO
DIRECTION OF SURVEY			6.33 Private		NOBLE GUERNSEY	6.77 CO
STREET NAME						
SECTION IDENTIFICATION	0.00					
SECTION LENGTH	6.77					
SURFACE TYPE & WIDTH	K18'					
BASE TYPE & WIDTH	I18'					
YEAR	1968					
PROJECT NUMBER	166					

PERPETUATION

VISIBLE FIXED POINTS			RR		CO	CO
			6.33 Abandoned		NOBLE GUERNSEY	6.77 CO
STREET NAME						
SECTION IDENTIFICATION	0.00					
SECTION LENGTH	6.77					
SURFACE TYPE & WIDTH	G18'					
BASE TYPE & WIDTH	I18'					
YEAR	1982					
PROJECT NUMBER	201					

VISIBLE FIXED POINTS			RR		CO	CO
			6.33 Abandoned		NOBLE GUERNSEY	6.77 CO
STREET NAME						
SECTION IDENTIFICATION	0.00					
SECTION LENGTH	6.77					
SURFACE TYPE & WIDTH	G18'					
BASE TYPE & WIDTH	I18'					
YEAR	1992					
PROJECT NUMBER	548					