

STATE OF OHIO - DEPARTMENT OF TRANSPORTATION

STATE ROUTE SECTIONS ON CONTINUOUS MILEAGE STATIONING

DISTRICT 2  
 COUNTY SANDUSKY  
 ROUTE SR 53

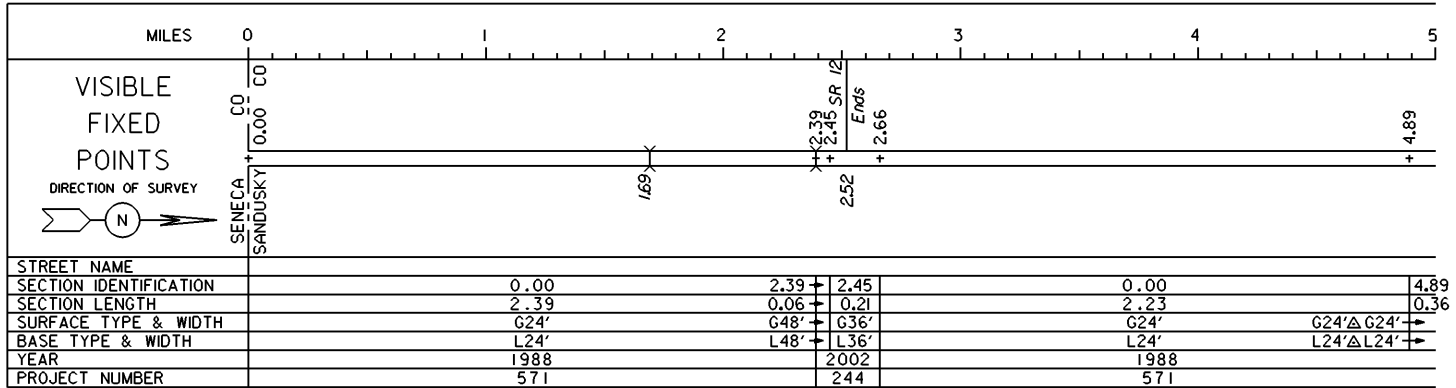

PERPETUATION

VISIBLE  
 FIXED  
 POINTS

---

STREET NAME  
 SECTION IDENTIFICATION  
 SECTION LENGTH  
 SURFACE TYPE & WIDTH  
 BASE TYPE & WIDTH  
 YEAR  
 PROJECT NUMBER

VISIBLE  
 FIXED  
 POINTS

---

STREET NAME  
 SECTION IDENTIFICATION  
 SECTION LENGTH  
 SURFACE TYPE & WIDTH  
 BASE TYPE & WIDTH  
 YEAR  
 PROJECT NUMBER

STATE OF OHIO - DEPARTMENT OF TRANSPORTATION  
STATE ROUTE SECTIONS ON CONTINUOUS MILEAGE STATIONING

DISTRICT 2  
COUNTY SANDUSKY  
ROUTE SR 53

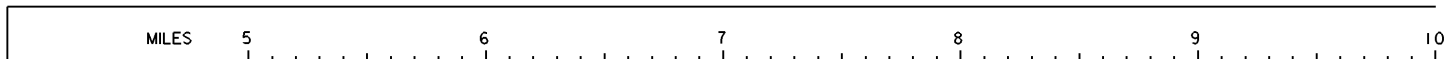

VISIBLE  
FIXED  
POINTS

DIRECTION OF SURVEY

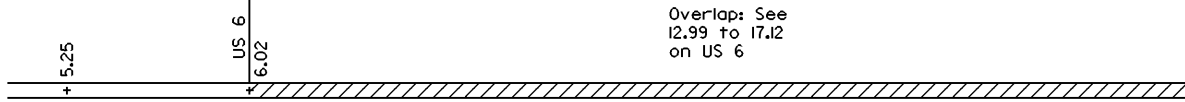

STREET NAME		
SECTION IDENTIFICATION	4.89	5.25
SECTION LENGTH	0.36	0.77
SURFACE TYPE & WIDTH	G24' Δ G24'	G24'
BASE TYPE & WIDTH	L24' Δ L24'	L24'
YEAR	1988	1978
PROJECT NUMBER	571	111

PERPETUATION

VISIBLE  
FIXED  
POINTS

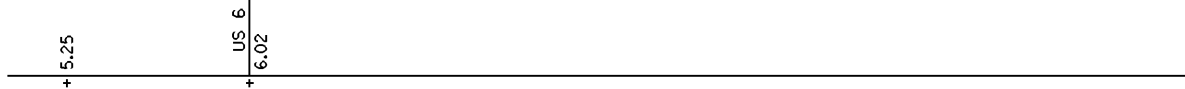

STREET NAME		
SECTION IDENTIFICATION	5.25	
SECTION LENGTH	0.77	
SURFACE TYPE & WIDTH	G24'	
BASE TYPE & WIDTH	L24'	
YEAR	1988	
PROJECT NUMBER	571	

VISIBLE  
FIXED  
POINTS

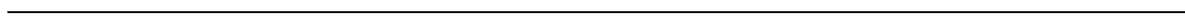

STREET NAME		
SECTION IDENTIFICATION		
SECTION LENGTH		
SURFACE TYPE & WIDTH		
BASE TYPE & WIDTH		
YEAR		
PROJECT NUMBER		

STATE OF OHIO - DEPARTMENT OF TRANSPORTATION  
STATE ROUTE SECTIONS ON CONTINUOUS MILEAGE STATIONING

DISTRICT 2  
COUNTY SANDUSKY  
ROUTE SR 53

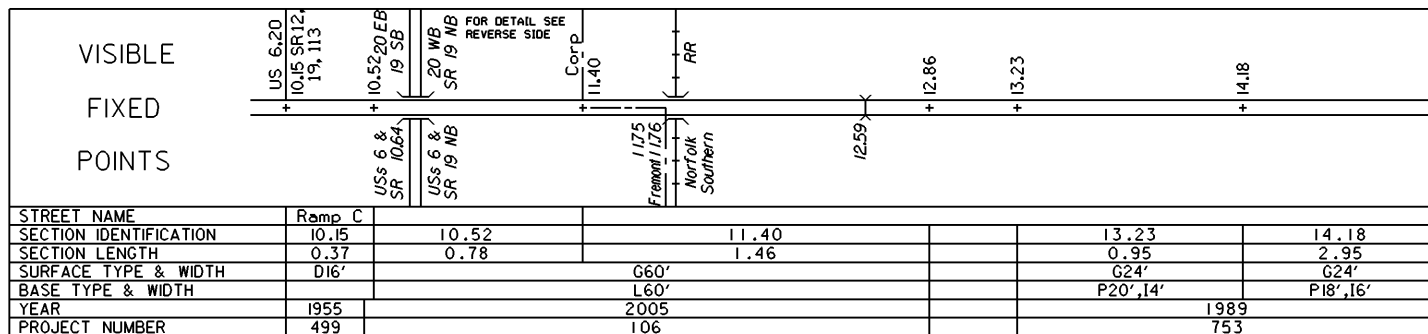
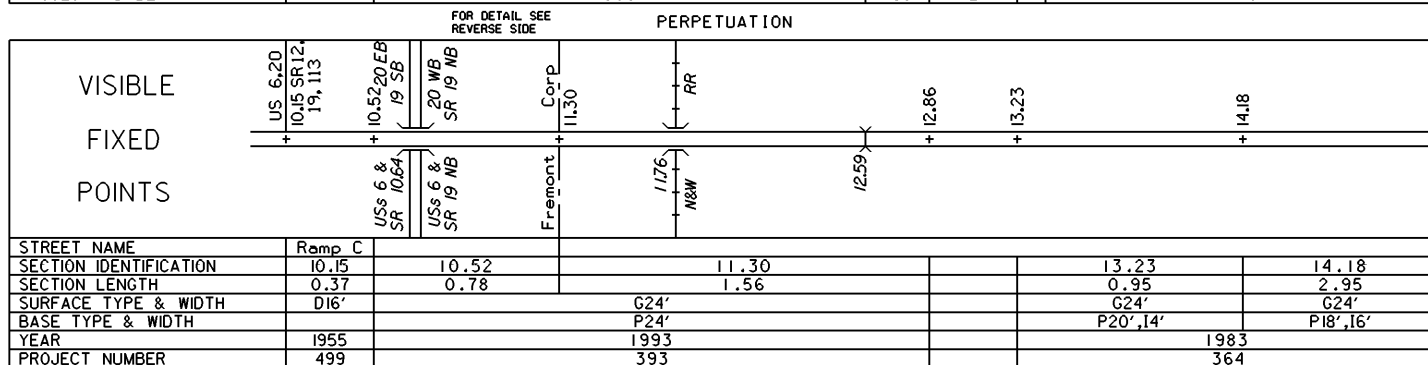
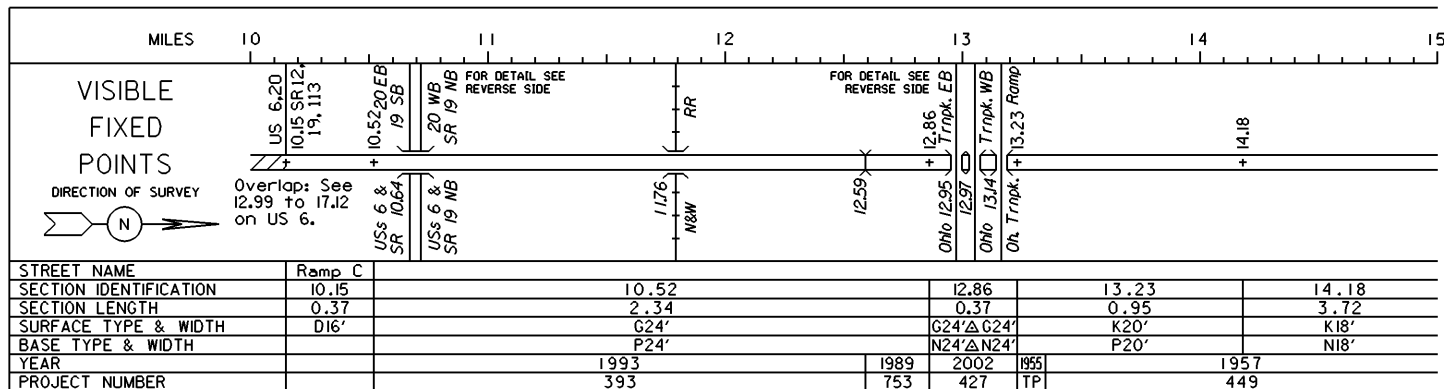

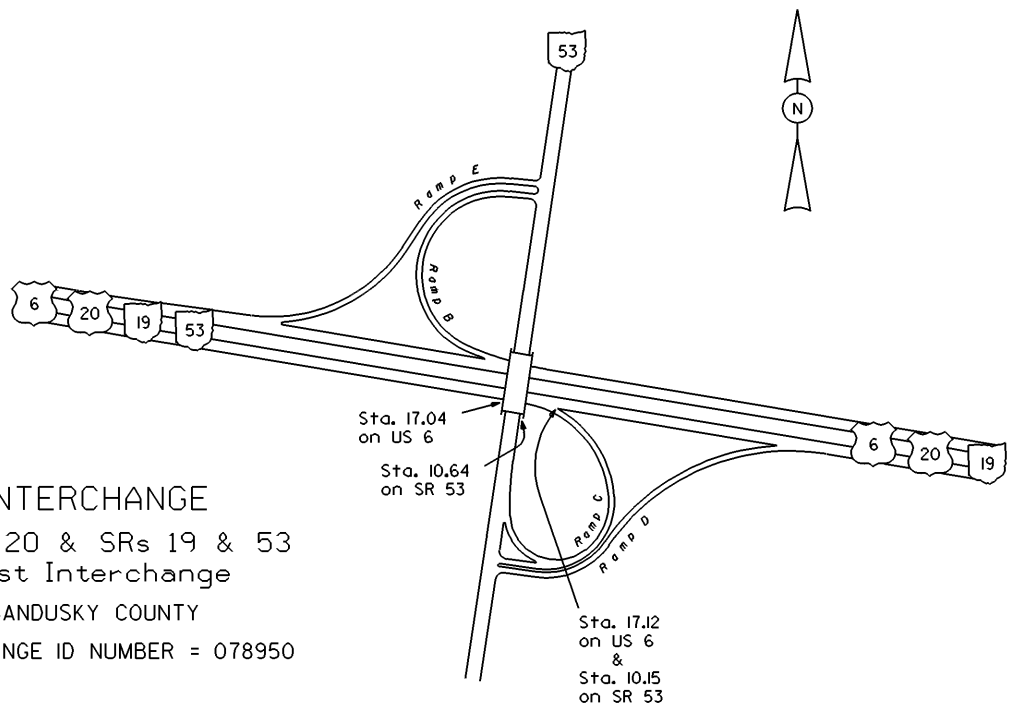

INTERCHANGE  
 USs 6, 20 & SRs 19 & 53  
 East Interchange  
 SANDUSKY COUNTY  
 INTERCHANGE ID NUMBER = 078950



INTERCHANGE  
SR 53 & Ohio Turnpike  
(IRs 80, 90)  
SANDUSKY COUNTY  
INTERCHANGE ID NUMBER = 079500

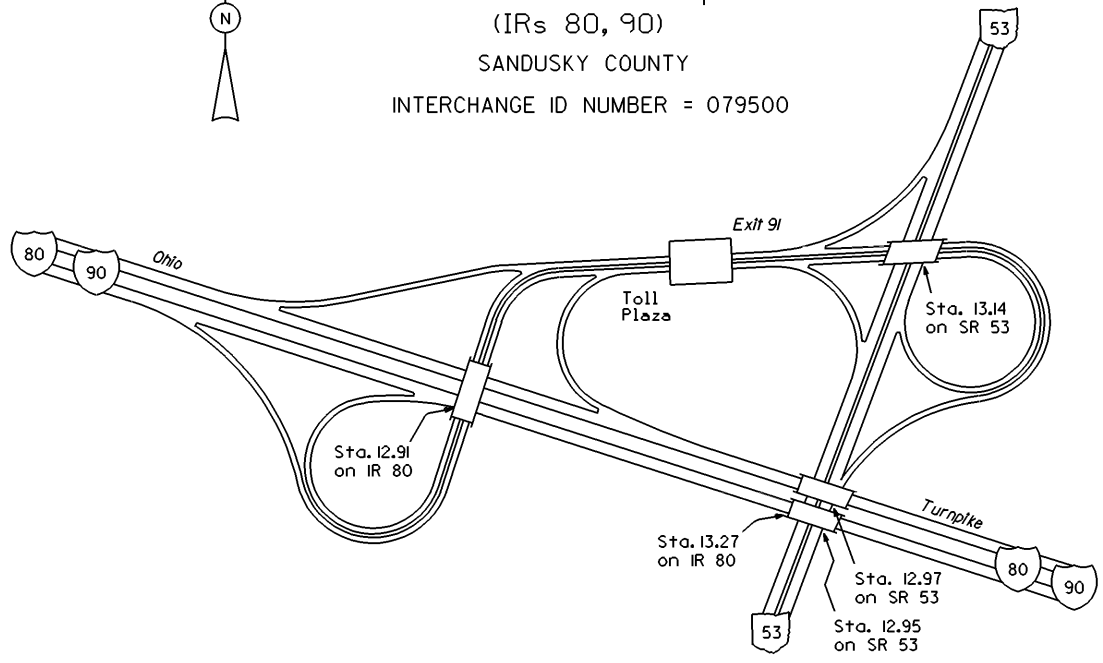

STATE OF OHIO - DEPARTMENT OF TRANSPORTATION

STATE ROUTE SECTIONS ON CONTINUOUS MILEAGE STATIONING

DISTRICT 2  
 COUNTY SANDUSKY  
 ROUTE SR 53

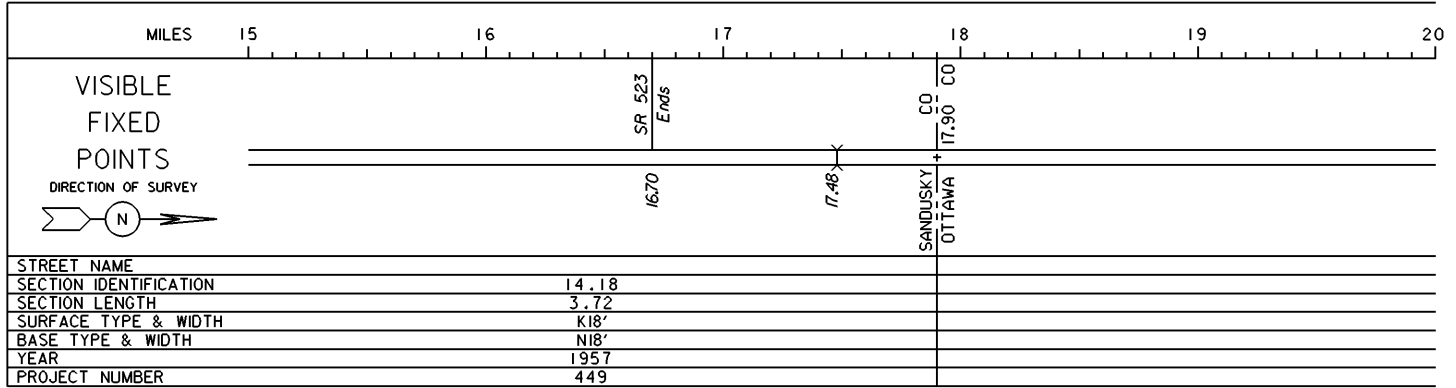

PERPETUATION

