

STATE OF OHIO - DEPARTMENT OF TRANSPORTATION
STATE ROUTE SECTIONS ON CONTINUOUS MILEAGE STATIONING

DISTRICT 2
COUNTY SANDUSKY
ROUTE SR 635

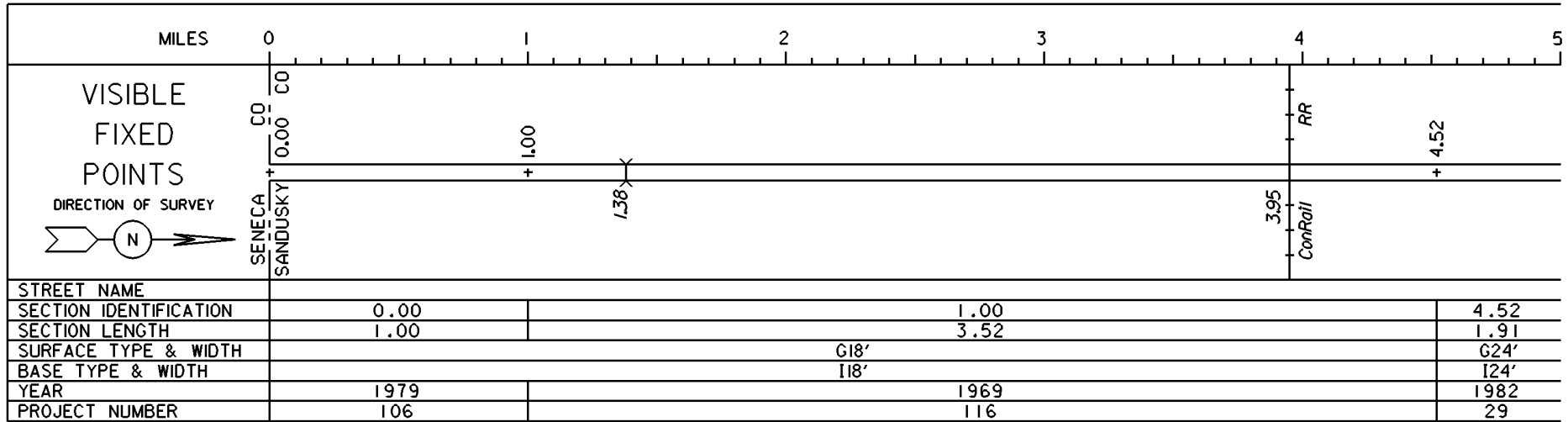

PERPETUATION

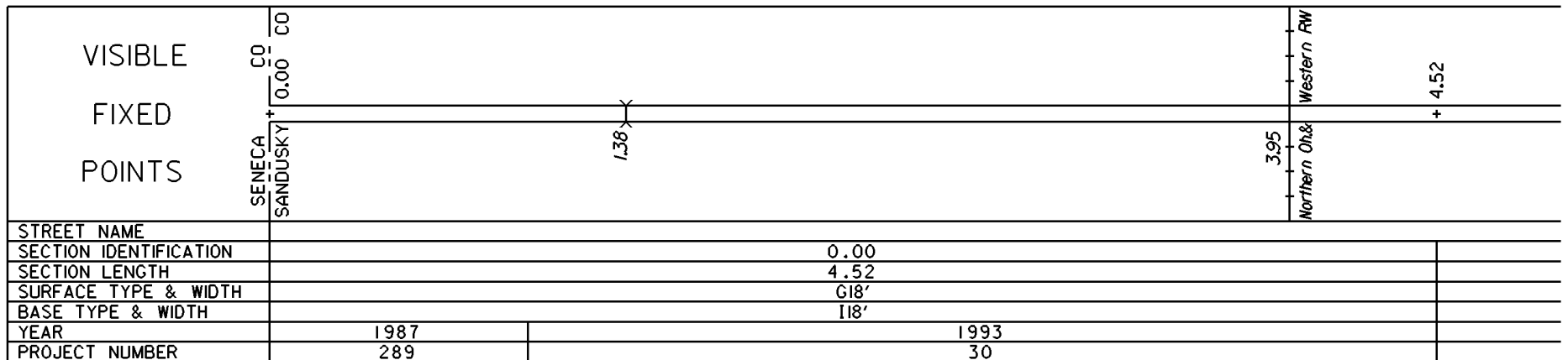
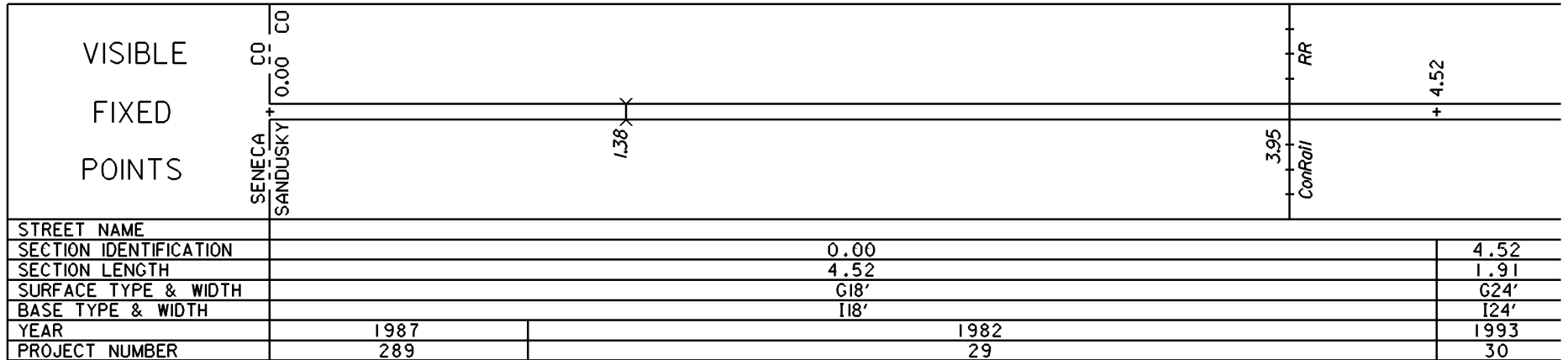

STATE OF OHIO - DEPARTMENT OF TRANSPORTATION
STATE ROUTE SECTIONS ON CONTINUOUS MILEAGE STATIONING

DISTRICT 2
COUNTY SANDUSKY
ROUTE SR 635

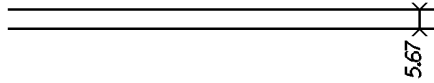
	MILES	5.00	5.50	6.00	6.50	7.00	7.50
VISIBLE FIXED POINTS DIRECTION OF SURVEY 					US 6 6.43 + US 6	6.43 = 7.52 on US 6	
STREET NAME							
SECTION IDENTIFICATION		4.52					
SECTION LENGTH		1.91					
SURFACE TYPE & WIDTH		G24'					
BASE TYPE & WIDTH		I24'					
YEAR		1982					
PROJECT NUMBER		29					

PERPETUATION

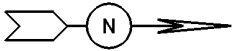
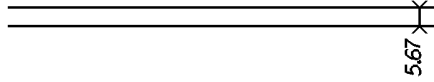
	MILES	5.00	5.50	6.00	6.50	7.00	7.50
VISIBLE FIXED POINTS DIRECTION OF SURVEY 					US 6 6.43 + US 6	6.43 = 7.52 on US 6	
STREET NAME							
SECTION IDENTIFICATION		4.52					
SECTION LENGTH		1.91					
SURFACE TYPE & WIDTH		G24'					
BASE TYPE & WIDTH		I24'					
YEAR		1993					
PROJECT NUMBER		30					

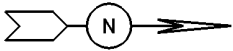
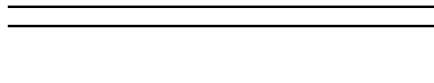
	MILES	5.00	5.50	6.00	6.50	7.00	7.50
VISIBLE FIXED POINTS DIRECTION OF SURVEY 					US 6 6.43 + US 6	6.43 = 7.52 on US 6	
STREET NAME							
SECTION IDENTIFICATION							
SECTION LENGTH							
SURFACE TYPE & WIDTH							
BASE TYPE & WIDTH							
YEAR							
PROJECT NUMBER							