

STATE OF OHIO - DEPARTMENT OF TRANSPORTATION
STATE ROUTE SECTIONS ON CONTINUOUS MILEAGE STATIONING

DISTRICT 4
COUNTY TRUMBULL
ROUTE SR 45

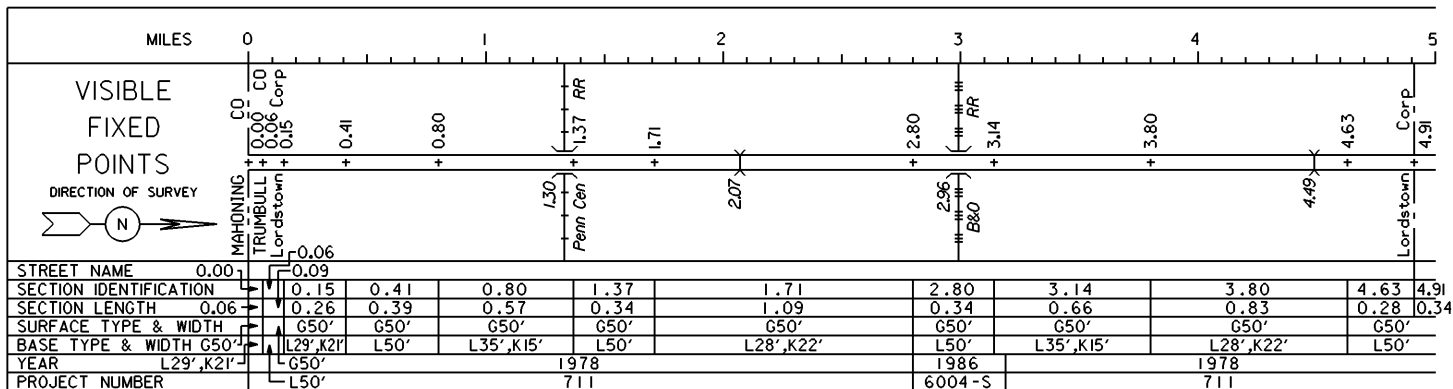

PERPETUATION

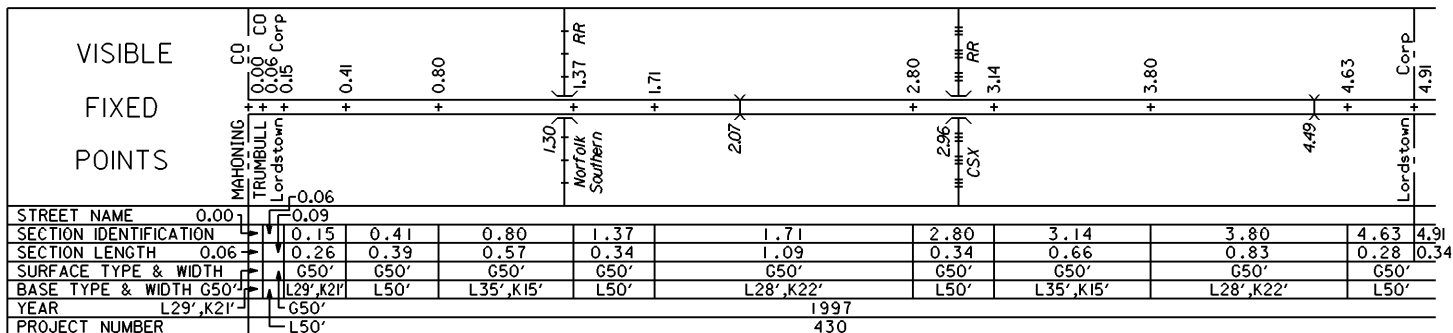

VISIBLE
FIXED
POINTS

STREET NAME _____
SECTION IDENTIFICATION _____
SECTION LENGTH _____
SURFACE TYPE & WIDTH _____
BASE TYPE & WIDTH _____
YEAR _____
PROJECT NUMBER _____

STATE OF OHIO - DEPARTMENT OF TRANSPORTATION

STATE ROUTE SECTIONS ON CONTINUOUS MILEAGE STATIONING

DISTRICT 4
 COUNTY TRUMBULL
 ROUTE SR 45

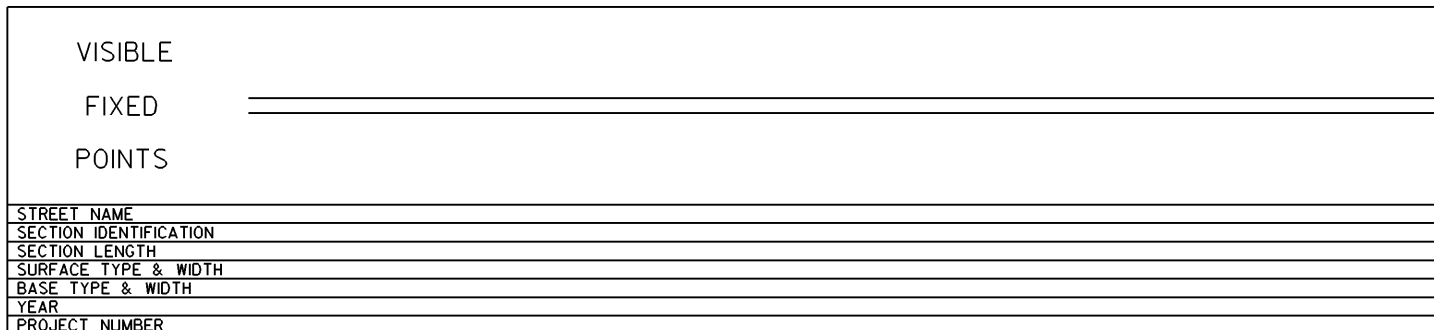
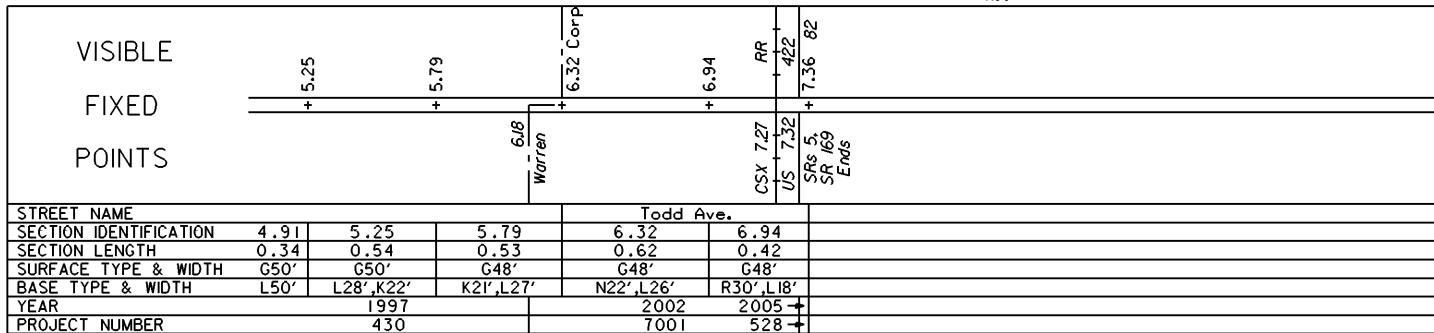
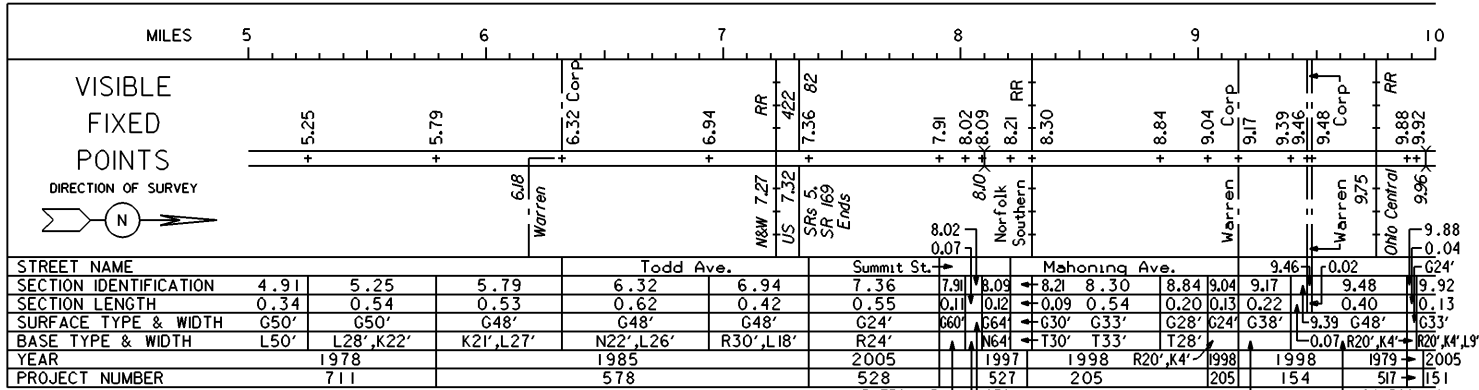

INTERCHANGE
SRs 5, 45 & 82
TRUMBULL COUNTY
INTERCHANGE ID NUMBER = 090500

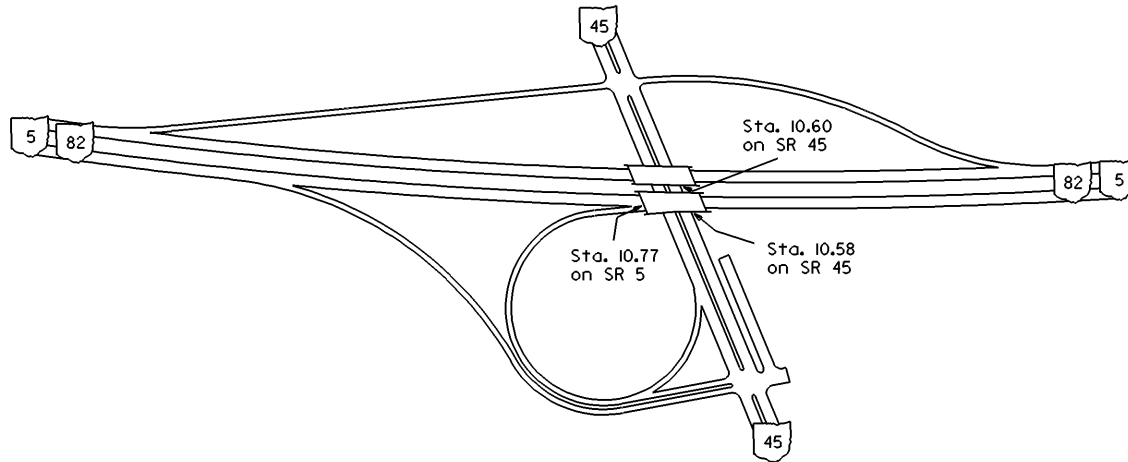

SR5 SHEET 3 OF 8
SR45 SHEET 3 OF 6

REVISED Jan 2008

STATE OF OHIO - DEPARTMENT OF TRANSPORTATION
STATE ROUTE SECTIONS ON CONTINUOUS MILEAGE STATIONING

DISTRICT 4
COUNTY TRUMBULL
ROUTE SR 45

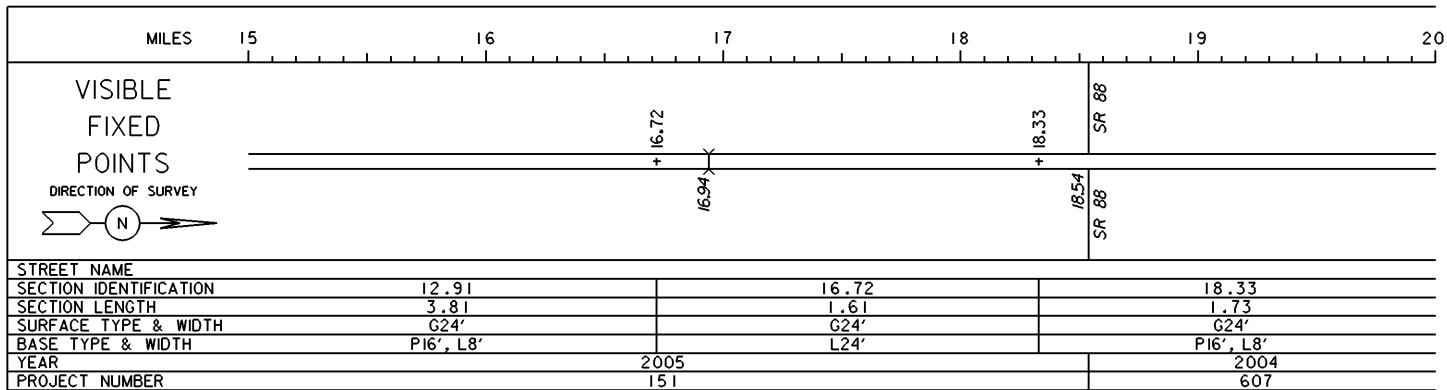

VISIBLE
FIXED
POINTS

STREET NAME
SECTION IDENTIFICATION
SECTION LENGTH
SURFACE TYPE & WIDTH
BASE TYPE & WIDTH
YEAR
PROJECT NUMBER

VISIBLE
FIXED
POINTS

STREET NAME
SECTION IDENTIFICATION
SECTION LENGTH
SURFACE TYPE & WIDTH
BASE TYPE & WIDTH
YEAR
PROJECT NUMBER

STATE OF OHIO - DEPARTMENT OF TRANSPORTATION

STATE ROUTE SECTIONS ON CONTINUOUS MILEAGE STATIONING

DISTRICT 4
 COUNTY TRUMBULL
 ROUTE SR 45

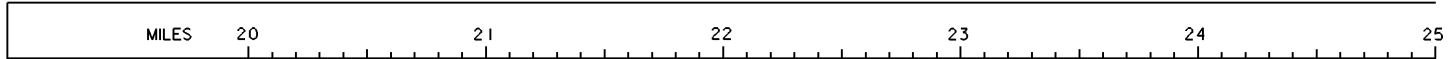

VISIBLE
 FIXED
 POINTS

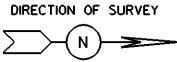

+ 20.06
 20.03

+ 20.28

+ 21.17

SR 87
 23.69
 SR 87

STREET NAME			
SECTION IDENTIFICATION	18.33	20.06	21.17
SECTION LENGTH	1.73	0.22	0.89
SURFACE TYPE & WIDTH	G24'	G24'	G24'
BASE TYPE & WIDTH	PI6',L8'	L24'	PI6',L8'
YEAR	2004	+ 2002	2004
PROJECT NUMBER	607	+ 395	607
			405

PERPETUATION

VISIBLE
 FIXED
 POINTS

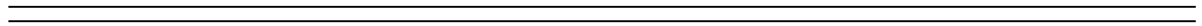

STREET NAME
SECTION IDENTIFICATION
SECTION LENGTH
SURFACE TYPE & WIDTH
BASE TYPE & WIDTH
YEAR
PROJECT NUMBER

VISIBLE
 FIXED
 POINTS

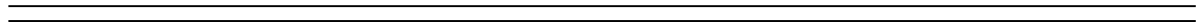

STREET NAME
SECTION IDENTIFICATION
SECTION LENGTH
SURFACE TYPE & WIDTH
BASE TYPE & WIDTH
YEAR
PROJECT NUMBER

STATE OF OHIO - DEPARTMENT OF TRANSPORTATION

STATE ROUTE SECTIONS ON CONTINUOUS MILEAGE STATIONING

DISTRICT 4
 COUNTY TRUMBULL
 ROUTE SR 45

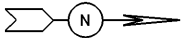
MILES	25.00	25.50	26.00	26.50	27.00	27.50
VISIBLE FIXED POINTS DIRECTION OF SURVEY 				CO TRUMBULL ASHTABULA + 26.41 CO		
STREET NAME						
SECTION IDENTIFICATION	21.17					
SECTION LENGTH	5.24					
SURFACE TYPE & WIDTH	G24'					
BASE TYPE & WIDTH	K16',L8'					
YEAR	2002					
PROJECT NUMBER	405					

PERPETUATION

VISIBLE FIXED POINTS						
STREET NAME						
SECTION IDENTIFICATION						
SECTION LENGTH						
SURFACE TYPE & WIDTH						
BASE TYPE & WIDTH						
YEAR						
PROJECT NUMBER						

VISIBLE FIXED POINTS						
STREET NAME						
SECTION IDENTIFICATION						
SECTION LENGTH						
SURFACE TYPE & WIDTH						
BASE TYPE & WIDTH						
YEAR						
PROJECT NUMBER						