

STATE OF OHIO - DEPARTMENT OF TRANSPORTATION

STATE ROUTE SECTIONS ON CONTINUOUS MILEAGE STATIONING

DISTRICT 10
 COUNTY VINTON
 ROUTE SR 677

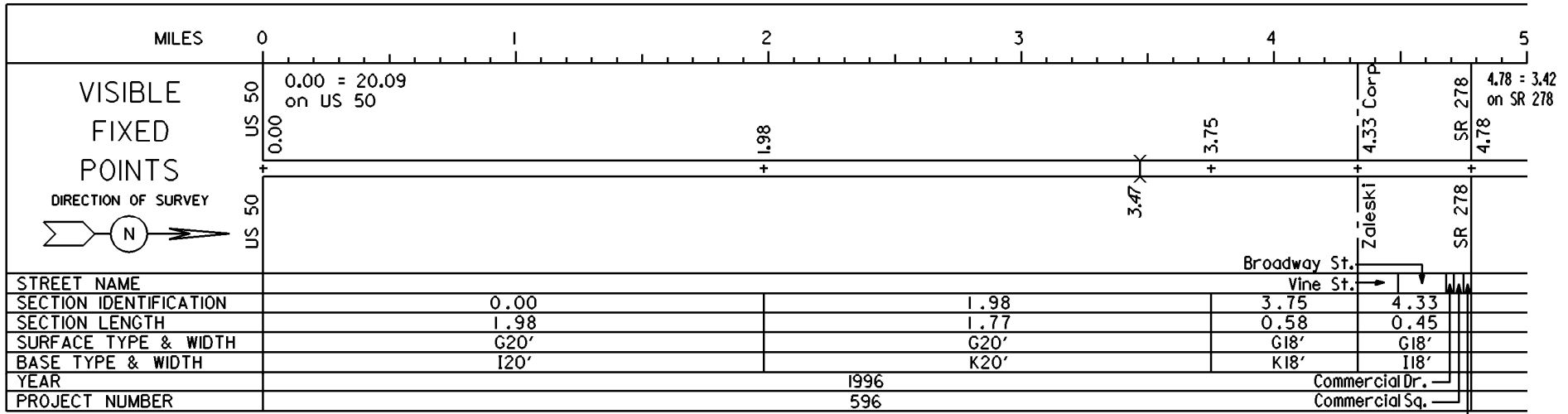

PERPETUATION

VISIBLE
 FIXED
 POINTS

STREET NAME
 SECTION IDENTIFICATION
 SECTION LENGTH
 SURFACE TYPE & WIDTH
 BASE TYPE & WIDTH
 YEAR
 PROJECT NUMBER

VISIBLE
 FIXED
 POINTS

STREET NAME
 SECTION IDENTIFICATION
 SECTION LENGTH
 SURFACE TYPE & WIDTH
 BASE TYPE & WIDTH
 YEAR
 PROJECT NUMBER