

STATE OF OHIO - DEPARTMENT OF TRANSPORTATION

STATE ROUTE SECTIONS ON CONTINUOUS MILEAGE STATIONING

DISTRICT	3
COUNTY	WAYNE
ROUTE	SR 585

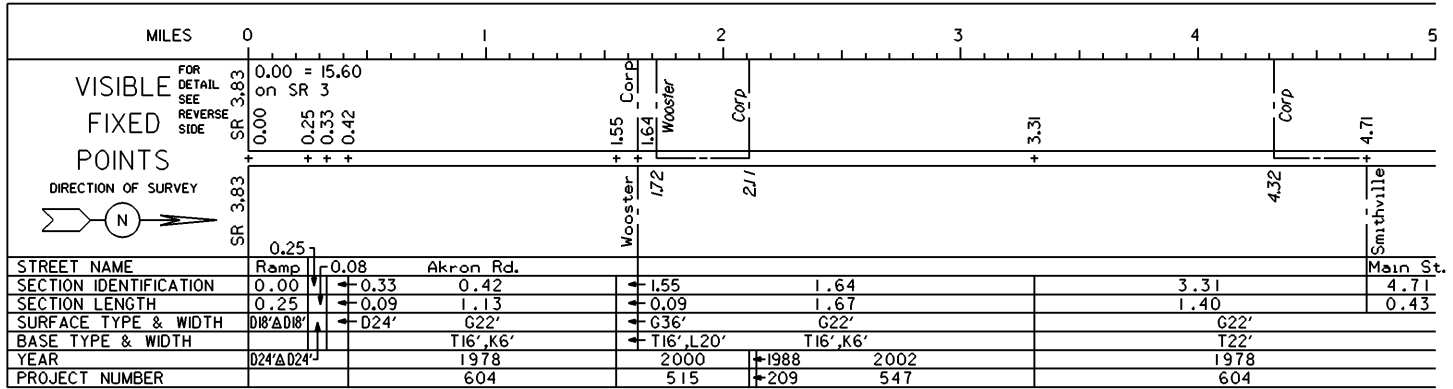

PERPETUATION

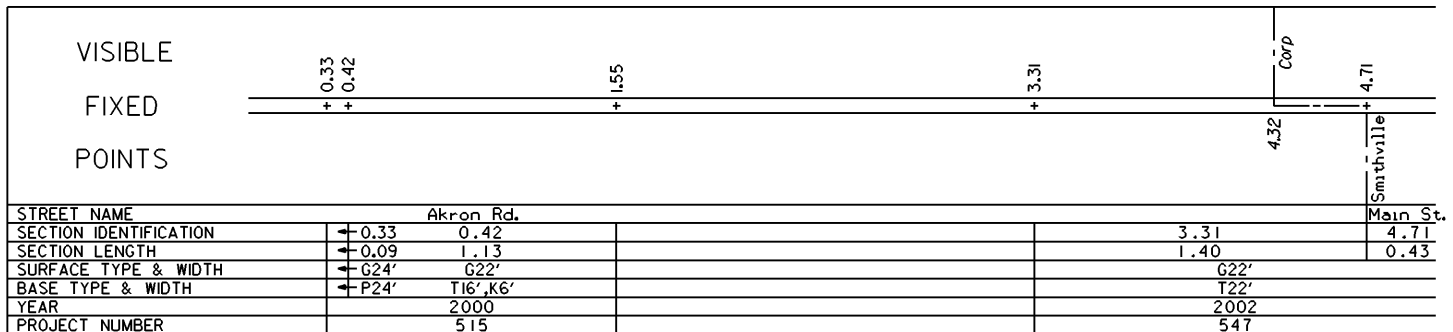
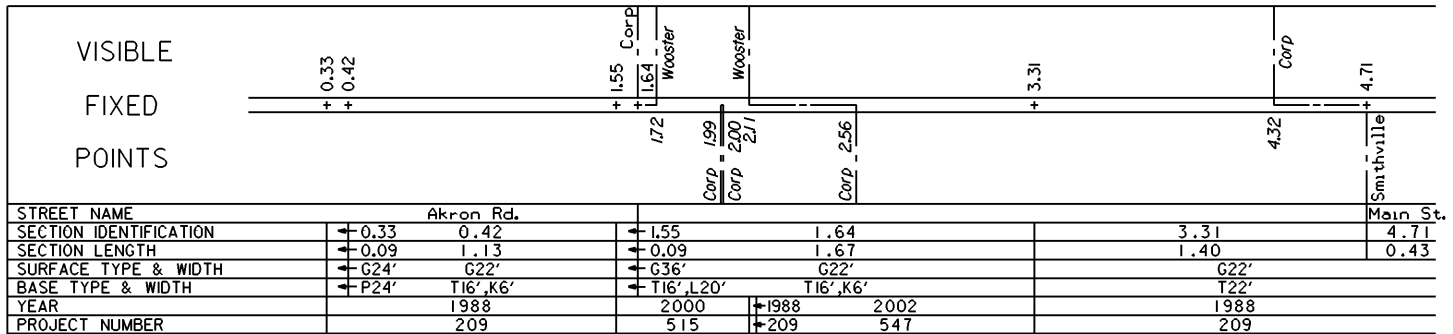

INTERCHANGE
 SRs 3, 83, 585, E. Bowman Rd. & Akron Rd.
 WAYNE COUNTY
 INTERCHANGE ID NUMBER = 097200

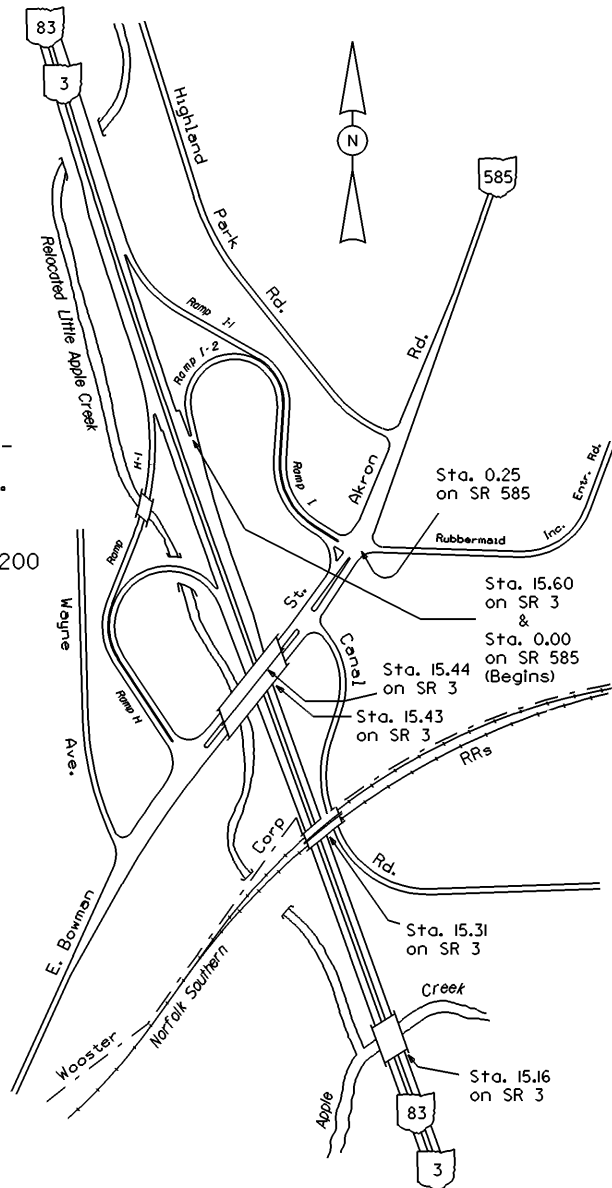

STATE OF OHIO - DEPARTMENT OF TRANSPORTATION
STATE ROUTE SECTIONS ON CONTINUOUS MILEAGE STATIONING

DISTRICT 3
COUNTY WAYNE
ROUTE SR 585

	MILES 10	11	12	13	14	15
VISIBLE FIXED POINTS DIRECTION OF SURVEY 	+ 10.79	+ 11.04			+ 13.71 SR 604 Ends	+ 13.90
			SR 57			Overlap: See 18.31 to 19.17 on SR 94
			SR 57 12/17		SR 94	
STREET NAME						
SECTION IDENTIFICATION	8.83	10.79	11.04		13.71	14.76
SECTION LENGTH	1.96	0.25	2.67		0.19	2.20
SURFACE TYPE & WIDTH	G20'	G24'	G20'		G24'	G24'
BASE TYPE & WIDTH	T20'	T20',L4'	T20'		L24'	P24'
YEAR	1988	1989	1988	1997	1978	1984
PROJECT NUMBER	209	87	209	602	604	628

PERPETUATION

VISIBLE FIXED POINTS	+ 10.79	+ 11.04			+ 13.71 SR 604 Ends	+ 13.90
			SR 57			Overlap: See 18.22 to 19.08 on SR 94
			SR 57 12/17		SR 94	
STREET NAME						
SECTION IDENTIFICATION	8.83	10.79	11.04		13.71	14.76
SECTION LENGTH	1.96	0.25	2.67		0.19	2.20
SURFACE TYPE & WIDTH	G20'	G24'	G20'		G24'	G24'
BASE TYPE & WIDTH	T20'	T20',L4'	T20'		L24'	P24'
YEAR	2002		1988	1997	1988	1997
PROJECT NUMBER	547		209	602	209	602

VISIBLE FIXED POINTS	+ 11.04	+ 11.96	+ 12.33 SR 57 Ends	+ 12.42	+ 13.71 SR 604 Ends	+ 13.90
			SR 57 12/17		SR 94	
STREET NAME						
SECTION IDENTIFICATION		11.04	11.96	12.33	12.42	13.71
SECTION LENGTH		0.92	0.37	0.09	1.29	0.19
SURFACE TYPE & WIDTH		G20'	G36'	G24'	G20'	G24'
BASE TYPE & WIDTH		T20'	T20',L16'	T20',L4'	T20'	L24'
YEAR		2002	2002	1997		
PROJECT NUMBER		547	495	602		

STATE OF OHIO - DEPARTMENT OF TRANSPORTATION
STATE ROUTE SECTIONS ON CONTINUOUS MILEAGE STATIONING

DISTRICT 3
COUNTY WAYNE
ROUTE SR 585

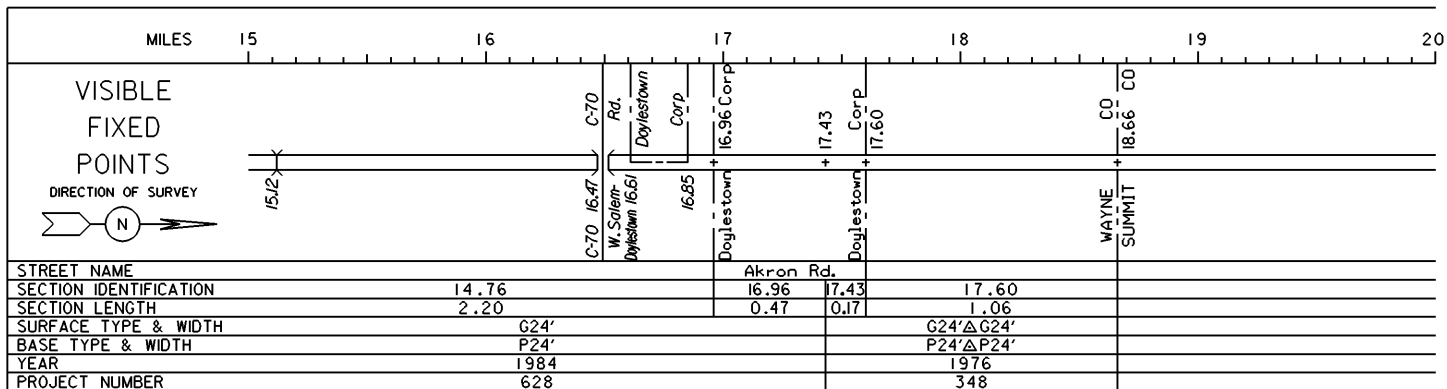

PERPETUATION

