

STATE OF OHIO - DEPARTMENT OF TRANSPORTATION

STATE ROUTE SECTIONS ON CONTINUOUS MILEAGE STATIONING

DISTRICT	2
COUNTY	WOOD
ROUTE	SR 64

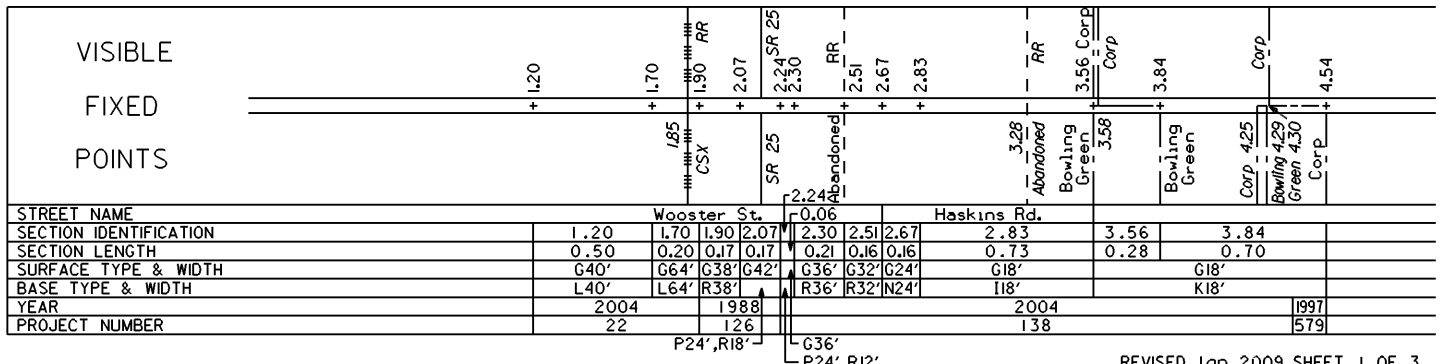

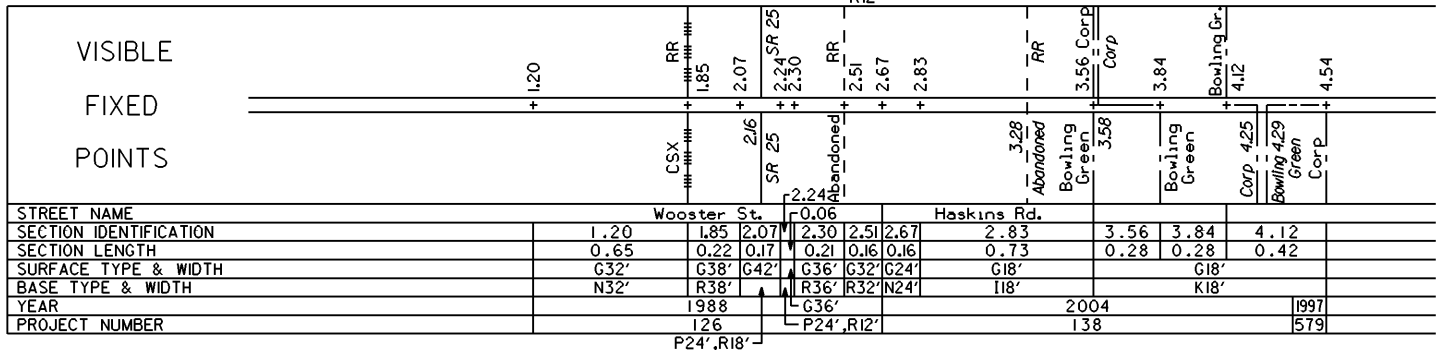
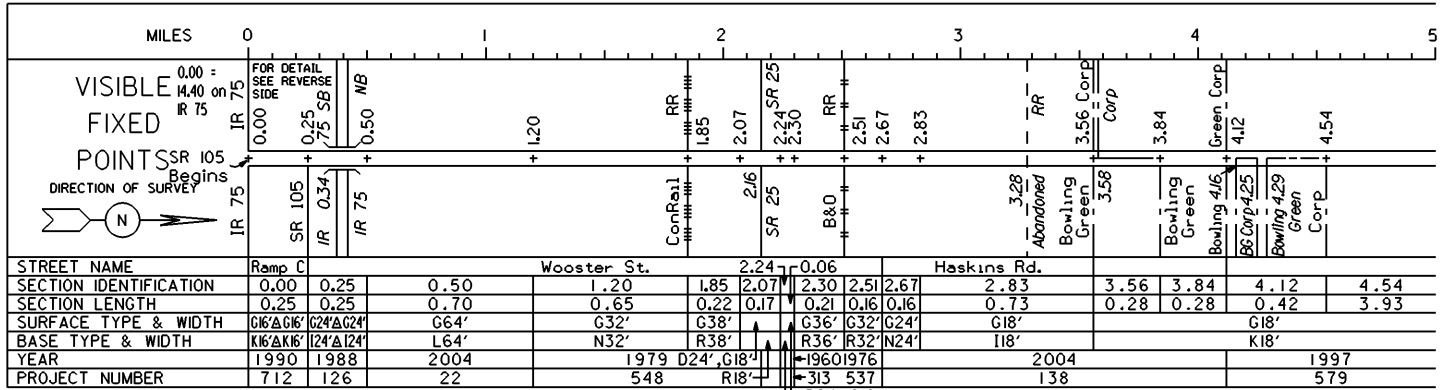
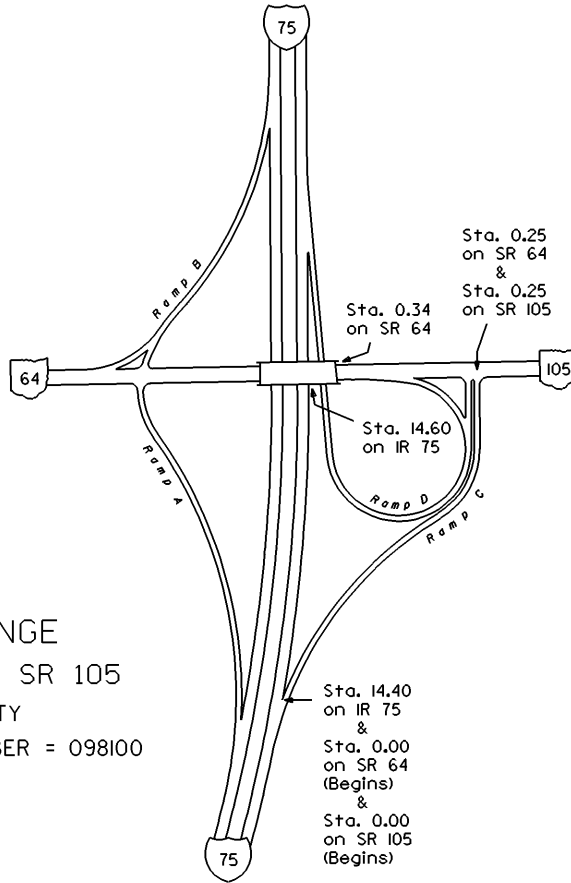

INTERCHANGE
IR 75, SR 64 & SR 105
WOOD COUNTY
INTERCHANGE ID NUMBER = 098100

STATE OF OHIO - DEPARTMENT OF TRANSPORTATION
STATE ROUTE SECTIONS ON CONTINUOUS MILEAGE STATIONING

DISTRICT 2
COUNTY WOOD
ROUTE SR 64

MILES	5	6	7	8	9	10					
VISIBLE FIXED POINTS						8.47 Corp	SR 582	9.03	9.26	RR	9.74
						Haskins	SR 582		9.38	B&O	
DIRECTION OF SURVEY											
STREET NAME						Findlay St.					
SECTION IDENTIFICATION	4.54					8.47	9.03	9.26	9.74		
SECTION LENGTH	3.93					0.56	0.23	0.48	0.33		
SURFACE TYPE & WIDTH	G18'					K18'	G20'	G30'	G20'		
BASE TYPE & WIDTH	K18'					K18'	K20'	K30'	K20'		
YEAR	1997					1957		1977			
PROJECT NUMBER	579					223		536			

PERPETUATION

VISIBLE FIXED POINTS						8.47 Corp	SR 582	9.03	9.26	RR	9.74
						Haskins	SR 582		9.38	Abandoned	
STREET NAME						Findlay St.					
SECTION IDENTIFICATION						8.47	9.03	9.26	9.74		
SECTION LENGTH						0.56	0.23	0.48	0.33		
SURFACE TYPE & WIDTH						G18'	G20'	G30'	G20'		
BASE TYPE & WIDTH						K18'	K20'	K30'	K20'		
YEAR						1973		1989			
PROJECT NUMBER						163		506			

VISIBLE FIXED POINTS						8.47 Corp	SR 582	9.03			
						Haskins	SR 582				
STREET NAME						Findlay St.					
SECTION IDENTIFICATION						8.47					
SECTION LENGTH						0.56					
SURFACE TYPE & WIDTH						G18'					
BASE TYPE & WIDTH						K18'					
YEAR						1988					
PROJECT NUMBER						126					

STATE OF OHIO - DEPARTMENT OF TRANSPORTATION

STATE ROUTE SECTIONS ON CONTINUOUS MILEAGE STATIONING

DISTRICT	2
COUNTY	WOOD
ROUTE	SR 64

	MILES	10.00	10.50	11.00	11.50	12.00	12.50
VISIBLE FIXED POINTS DIRECTION OF SURVEY 	Corp	10.07		11.32	11.56	11.87	12.12
	Haskins			11.33		11.89	12.03
	SR 65			11.33		11.89	12.03
						SR 65	WOOD
							LUCAS
STREET NAME		Findlay St.					
SECTION IDENTIFICATION		10.07		11.32		11.87	
SECTION LENGTH		1.25		0.24		0.25	
SURFACE TYPE & WIDTH		G20'		G24'		G24'	
BASE TYPE & WIDTH		K20'		K18',L6'		K18',L6'	
YEAR		1977		1970		1947	
PROJECT NUMBER		536		501		447	

PERPETUATION

VISIBLE FIXED POINTS	Corp	10.07		11.33	11.56	11.87	12.12
	Haskins			11.33		11.89	12.03
	SR 65			11.33		11.89	12.03
						SR 65	WOOD
							LUCAS
STREET NAME		Findlay St.					
SECTION IDENTIFICATION		10.07		11.33		11.87	
SECTION LENGTH		1.26		0.23		0.25	
SURFACE TYPE & WIDTH		G20'		G24'		G24'	
BASE TYPE & WIDTH		K20'		K18',L6'		P24'	
YEAR		1989		1984		1970	
PROJECT NUMBER		506		516		501	

VISIBLE FIXED POINTS	Corp	10.07	10.22	10.34	11.33	11.56	11.87	12.12
	Haskins		Haskins		11.33		11.89	12.03
	Corp		10.22		11.33		11.89	12.03
	Haskins		Haskins		11.33		11.89	12.03
	Corp		10.34		11.33		11.89	12.03
	Haskins		Haskins		11.33		11.89	12.03
	SR 65				11.33		11.89	12.03
							SR 65	WOOD
								LUCAS
STREET NAME		Findlay St.						
SECTION IDENTIFICATION		10.07		10.34		11.87		
SECTION LENGTH		0.15		0.99		0.25		
SURFACE TYPE & WIDTH		G18'		G24'		G24'		
BASE TYPE & WIDTH		K18'		K18',L6'		P24'		
YEAR		1989		1995		1988		
PROJECT NUMBER		506		210		375		