

STATE OF OHIO - DEPARTMENT OF TRANSPORTATION  
STATE ROUTE SECTIONS ON CONTINUOUS MILEAGE STATIONING

DISTRICT 11  
COUNTY COLUMBIANA  
ROUTE SR 267

MILES	0	1	2	3	4	5
VISIBLE FIXED POINTS	0.00 = 6.27 on SR 7					
	0.08	0.24	0.41	1.74	2.63	3.73
DIRECTION OF SURVEY						
STREET NAME	0.00	Lisbon St.				
SECTION IDENTIFICATION	0.08	0.24	0.41	1.74	2.63	3.73
SECTION LENGTH	0.08	0.17	1.33	0.89	1.10	0.66
SURFACE TYPE & WIDTH	G26'	G30'	G26'	G22'	G24'	G24'
BASE TYPE & WIDTH	D24'	120', 16'	R14', K6', L6'	R14', K6', L2'	12', N18', L4'	N16', K4', L4'
YEAR	1969		2000	2001	1991	1980
PROJECT NUMBER	6		431	550	1010	182

PERPETUATION

VISIBLE FIXED POINTS				2.63	3.73	4.39	4.52	4.72	4.88
STREET NAME									
SECTION IDENTIFICATION				2.63	3.73	4.39	4.52	4.72	4.88
SECTION LENGTH				1.10	0.66	0.13	0.20	0.16	0.51
SURFACE TYPE & WIDTH				G24'	G24'	G24'	G24'	G24'	G24'
BASE TYPE & WIDTH				12', N18', L4'	N16', K4', L4'	L24'	N16', K4', L4'	N20', L4'	P24'
YEAR				2001		1991			1990
PROJECT NUMBER				550		1010			788

VISIBLE FIXED POINTS					3.73	4.39	4.52	4.72	4.88
STREET NAME									
SECTION IDENTIFICATION					3.73	4.39	4.52	4.72	4.88
SECTION LENGTH					0.66	0.13	0.20	0.16	0.51
SURFACE TYPE & WIDTH					G24'	G24'	G24'	G24'	G24'
BASE TYPE & WIDTH					N16', K4', L4'	L24'	N16', K4', L4'	N20', L4'	P24'
YEAR						2001			
PROJECT NUMBER						550			

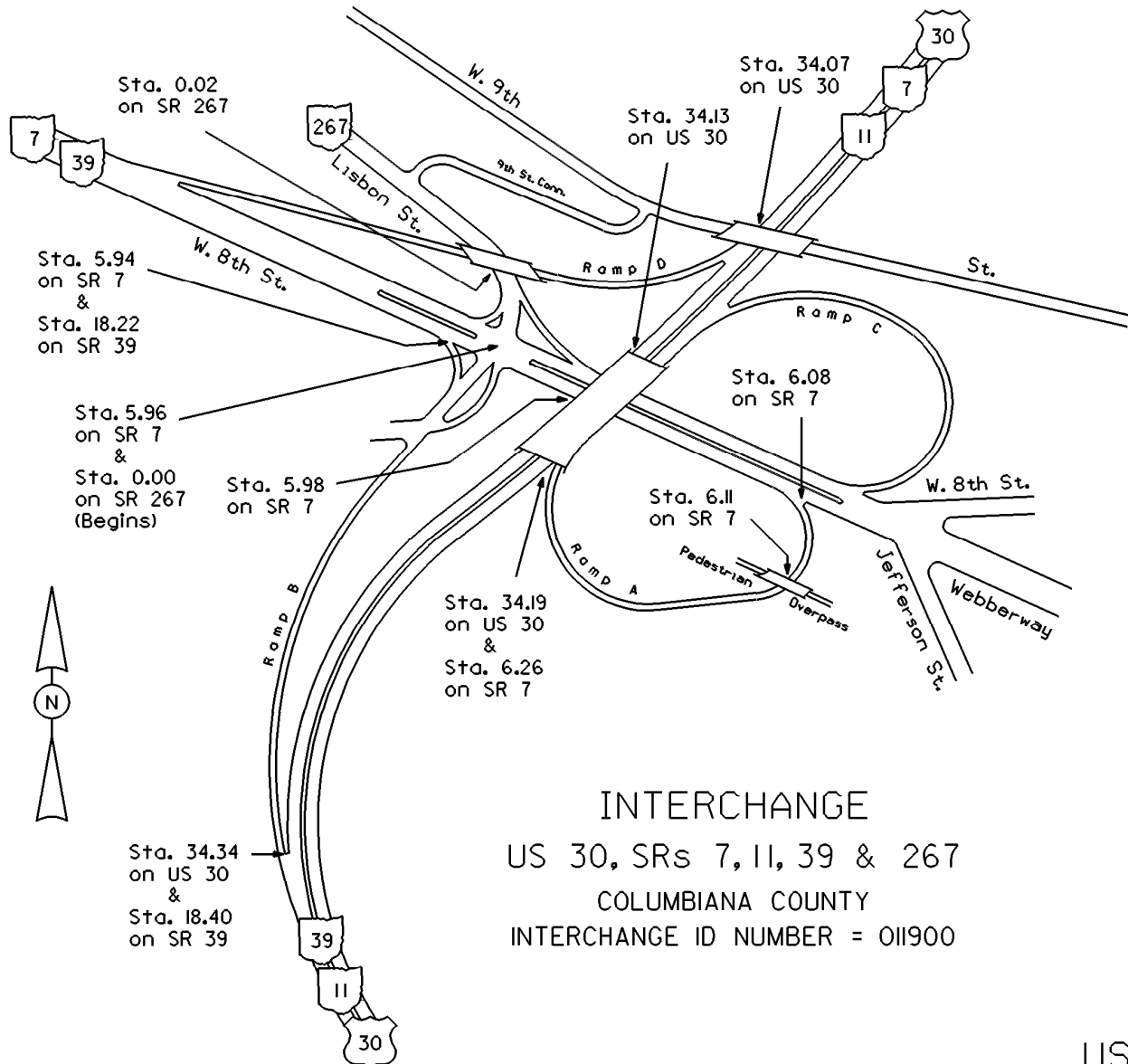

Sta. 0.02  
on SR 267

Sta. 5.94  
on SR 7  
&  
Sta. 18.22  
on SR 39

Sta. 5.96  
on SR 7  
&  
Sta. 0.00  
on SR 267  
(Begins)

Sta. 5.98  
on SR 7

Sta. 34.34  
on US 30  
&  
Sta. 18.40  
on SR 39

Sta. 34.13  
on US 30

Sta. 34.19  
on US 30  
&  
Sta. 6.26  
on SR 7

Sta. 34.07  
on US 30

Sta. 6.08  
on SR 7

Sta. 6.11  
on SR 7

INTERCHANGE  
US 30, SRs 7, 11, 39 & 267  
COLUMBIANA COUNTY  
INTERCHANGE ID NUMBER = 011900

US 30 SHEET 7 OF 8  
SR 7 SHEET 2 OF 6  
SR 39 SHEET 4 OF 5  
SR 267 SHEET 1 OF 2

STATE OF OHIO - DEPARTMENT OF TRANSPORTATION  
STATE ROUTE SECTIONS ON CONTINUOUS MILEAGE STATIONING

DISTRICT 11  
COUNTY COLUMBIANA  
ROUTE SR 267

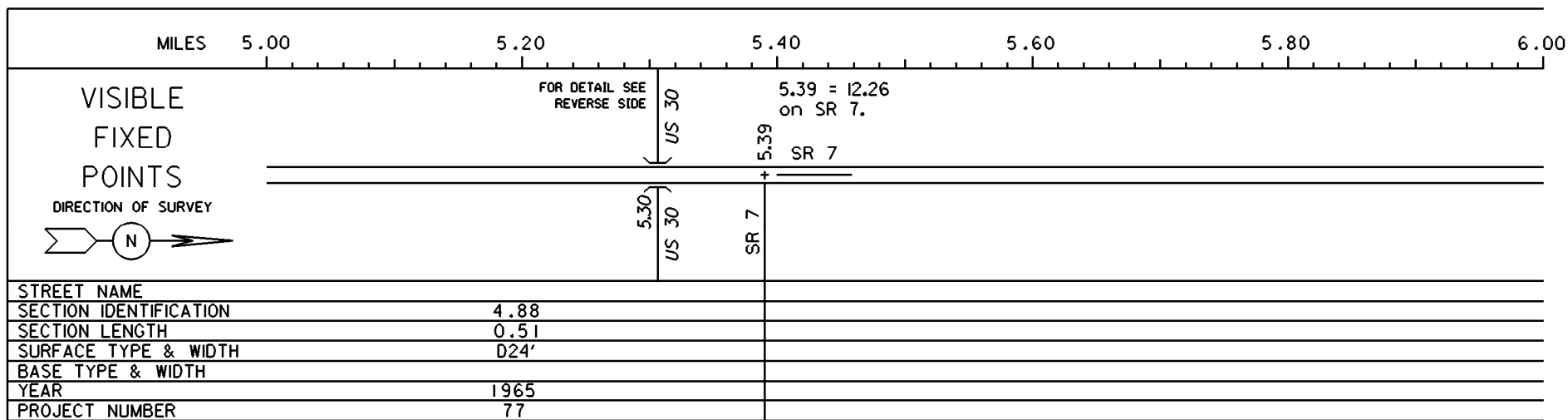

PERPETUATION

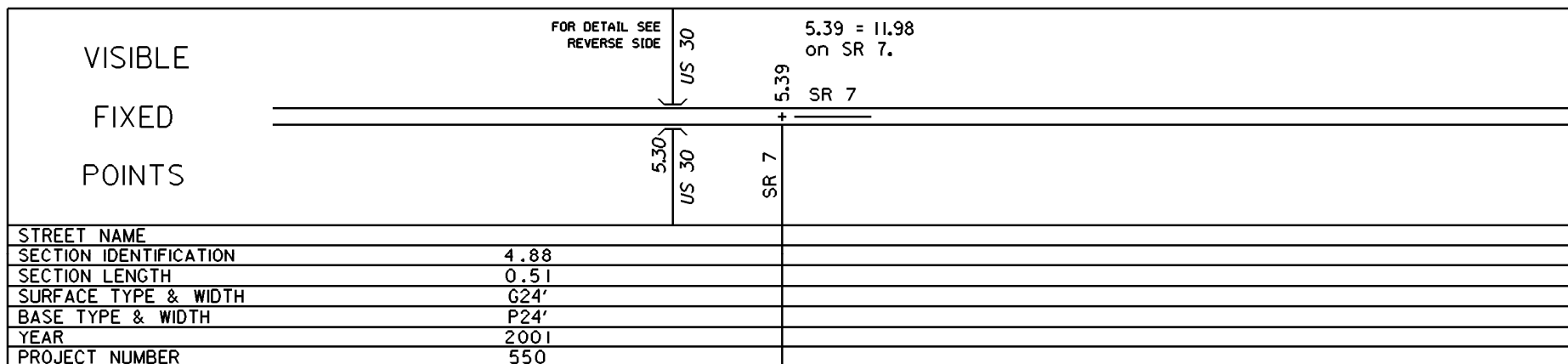
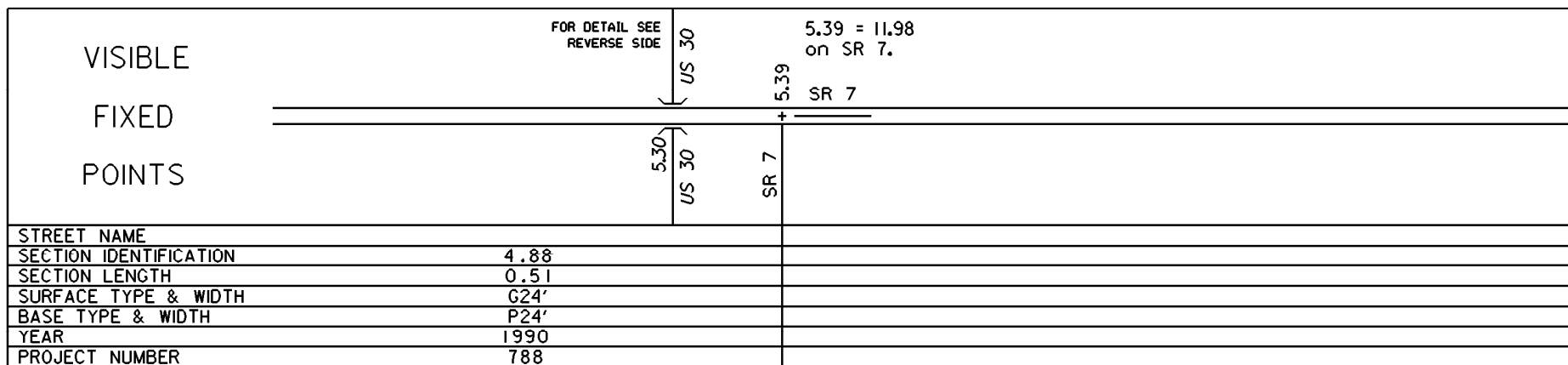

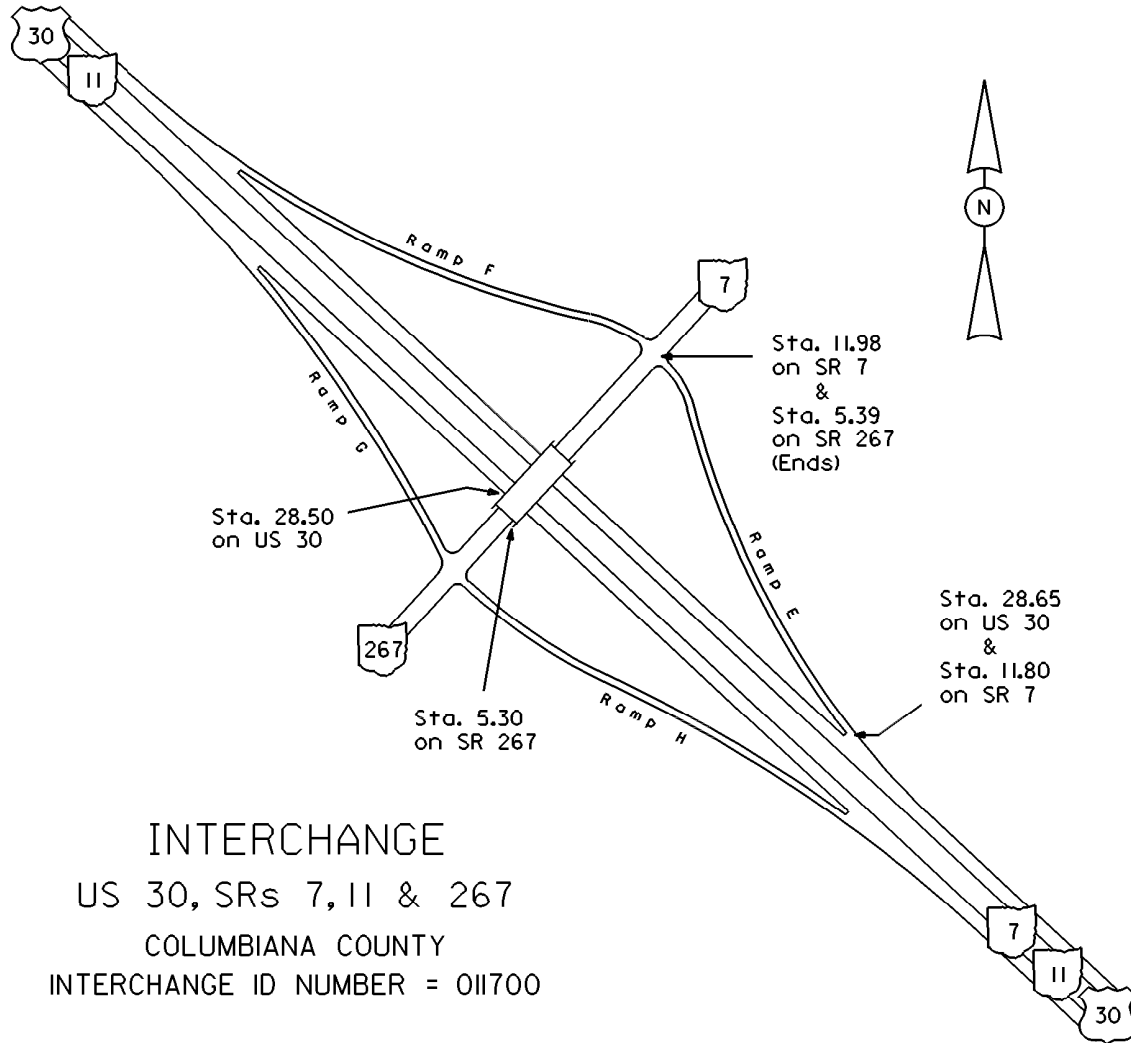

INTERCHANGE  
 US 30, SRs 7, 11 & 267  
 COLUMBIANA COUNTY  
 INTERCHANGE ID NUMBER = 011700

US 30 SHEET 6 OF 8  
 SR 7 SHEET 3 OF 6  
 SR 267 SHEET 2 OF 2