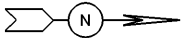

STATE OF OHIO - DEPARTMENT OF TRANSPORTATION

STATE ROUTE SECTIONS ON CONTINUOUS MILEAGE STATIONING

DISTRICT 12  
 COUNTY GEAUGA  
 ROUTE SR 168

MILES		0	1	2	3	4	5
VISIBLE FIXED POINTS SR 528 & SR 168 Begin DIRECTION OF SURVEY 	US 422	0.00 = 17.35 on US 422					
	SR 88.528	0.00	0.21	0.74			
		Overlap: See 2.07 to 2.28 on SR 88					
STREET NAME							
SECTION IDENTIFICATION		0.21		0.74			
SECTION LENGTH		0.53		7.16			
SURFACE TYPE & WIDTH		G18'		G20'			
BASE TYPE & WIDTH		K18'		I20'			
YEAR		1999		1988			
PROJECT NUMBER		422		317			

PERPETUATION

VISIBLE						
FIXED			0.74			
POINTS						
STREET NAME						
SECTION IDENTIFICATION		0.74				
SECTION LENGTH		7.16				
SURFACE TYPE & WIDTH		G20'				
BASE TYPE & WIDTH		I20'				
YEAR		1999		1988		
PROJECT NUMBER		422		317		

VISIBLE					
FIXED					
POINTS					
STREET NAME					
SECTION IDENTIFICATION					
SECTION LENGTH					
SURFACE TYPE & WIDTH					
BASE TYPE & WIDTH					
YEAR					
PROJECT NUMBER					

STATE OF OHIO - DEPARTMENT OF TRANSPORTATION  
STATE ROUTE SECTIONS ON CONTINUOUS MILEAGE STATIONING

DISTRICT 12  
COUNTY GEAUGA  
ROUTE SR 168

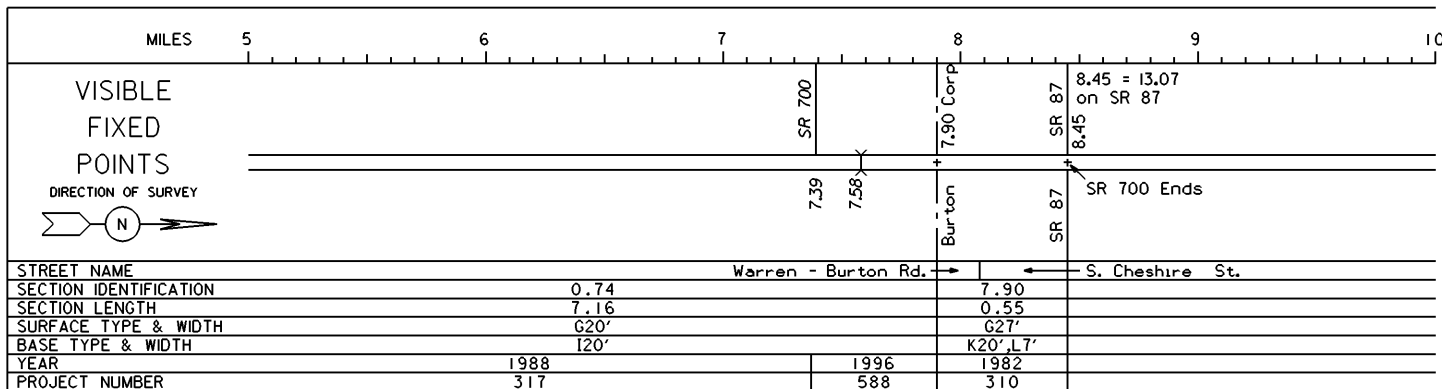

PERPETUATION

