

STATE OF OHIO - DEPARTMENT OF TRANSPORTATION

STATE ROUTE SECTIONS ON CONTINUOUS MILEAGE STATIONING

DISTRICT 9
 COUNTY LAWRENCE
 ROUTE SR 378

MILES		0	1	2	3	4	5	
VISIBLE FIXED POINTS	SR 243	0.00 = 11.59 on SR 243					Overlap: See 6.48 to 5.89 on SR 217.	
		0.09					4.95	
DIRECTION OF SURVEY							SR 217	
STREET NAME								
SECTION IDENTIFICATION		0.00		0.09				
SECTION LENGTH		0.09		4.86				
SURFACE TYPE & WIDTH		G22'		G18'				
BASE TYPE & WIDTH		122'		118'				
YEAR		1995		1985				
PROJECT NUMBER		406		971				

PERPETUATION

VISIBLE FIXED POINTS	SR 243	0.00 = 11.59 on SR 243					Overlap: See 6.34 to 5.75 on SR 217.	
		0.09					4.95	
STREET NAME								
SECTION IDENTIFICATION		0.00		0.09				
SECTION LENGTH		0.09		4.86				
SURFACE TYPE & WIDTH		G22'		G18'				
BASE TYPE & WIDTH		122'		118'				
YEAR				2004				
PROJECT NUMBER				497				

VISIBLE FIXED POINTS							
STREET NAME							
SECTION IDENTIFICATION							
SECTION LENGTH							
SURFACE TYPE & WIDTH							
BASE TYPE & WIDTH							
YEAR							
PROJECT NUMBER							

STATE OF OHIO - DEPARTMENT OF TRANSPORTATION
STATE ROUTE SECTIONS ON CONTINUOUS MILEAGE STATIONING

DISTRICT 9
COUNTY LAWRENCE
ROUTE SR 378

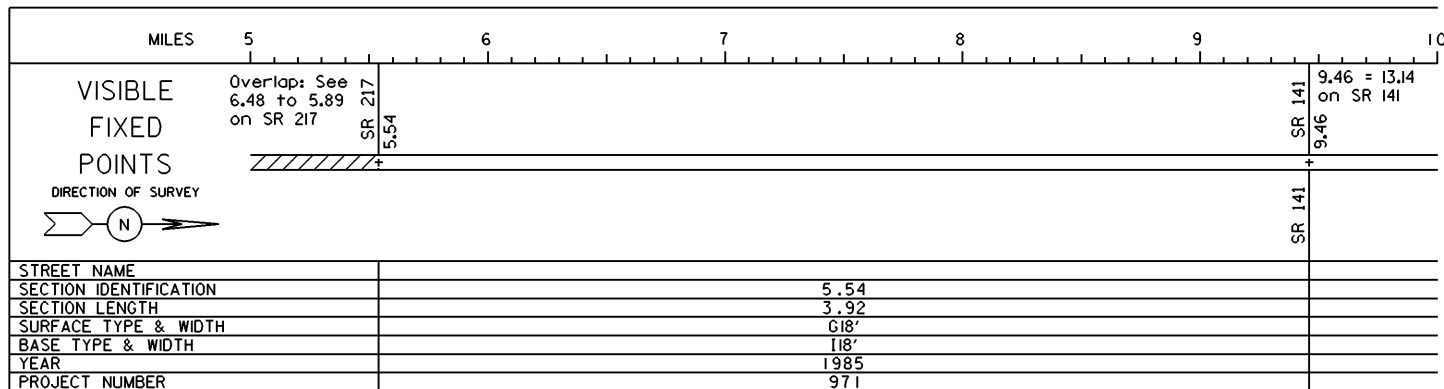

PERPETUATION

