

STATE OF OHIO - DEPARTMENT OF TRANSPORTATION
STATE ROUTE SECTIONS ON CONTINUOUS MILEAGE STATIONING

DISTRICT 10
COUNTY MEigs
ROUTE SR 248

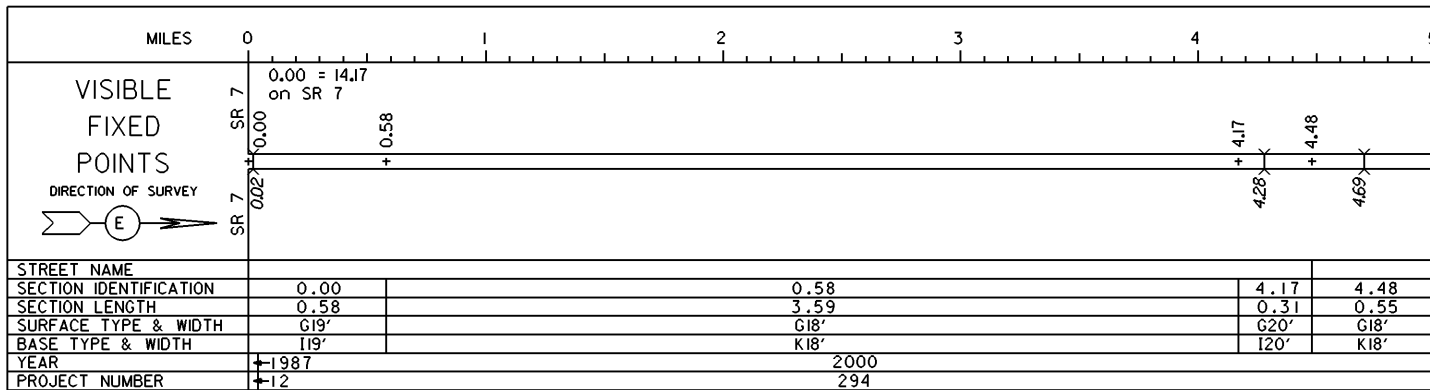

PERPETUATION

VISIBLE
FIXED
POINTS

STREET NAME
SECTION IDENTIFICATION
SECTION LENGTH
SURFACE TYPE & WIDTH
BASE TYPE & WIDTH
YEAR
PROJECT NUMBER

VISIBLE
FIXED
POINTS

STREET NAME
SECTION IDENTIFICATION
SECTION LENGTH
SURFACE TYPE & WIDTH
BASE TYPE & WIDTH
YEAR
PROJECT NUMBER

STATE OF OHIO - DEPARTMENT OF TRANSPORTATION
STATE ROUTE SECTIONS ON CONTINUOUS MILEAGE STATIONING

DISTRICT 10
COUNTY MEigs
ROUTE SR 248

MILES		5	6	7	8	9	10	
VISIBLE FIXED POINTS		+15.03					SR 124 9.15	9.15 = 57.41 on SR 124
DIRECTION OF SURVEY								SR 124
STREET NAME								
SECTION IDENTIFICATION		4.48						5.03
SECTION LENGTH		0.55						4.12
SURFACE TYPE & WIDTH		G18'						G18'
BASE TYPE & WIDTH		K18'						I18'
YEAR		2000						
PROJECT NUMBER		294						

PERPETUATION

VISIBLE FIXED POINTS		=====					
STREET NAME							
SECTION IDENTIFICATION							
SECTION LENGTH							
SURFACE TYPE & WIDTH							
BASE TYPE & WIDTH							
YEAR							
PROJECT NUMBER							

VISIBLE FIXED POINTS		=====					
STREET NAME							
SECTION IDENTIFICATION							
SECTION LENGTH							
SURFACE TYPE & WIDTH							
BASE TYPE & WIDTH							
YEAR							
PROJECT NUMBER							