

# US-224/I-75 Interchange Bridge Replacement

## Agenda

- ⌚ 6:00 – 7:00 Open House
- ⌚ 7:00 – 7:20 Project Presentation
- ⌚ 7:20 – 7:30 Questions and Responses
- ⌚ 7:30 – 8:00 Public Comments



---

Presentation will  
start shortly



---

# US-224/I-75 Interchange Bridge Replacement

---



# Project History

- ⌚ Bridge Was Built in 1956
- ⌚ 50 Year Design Life
- ⌚ Interchange Study in 2006



# Interchange Study Showed

- ⦿ Bridge is Structurally Deficient
- ⦿ Bridge Functionally Obsolete
- ⦿ Interchange Has Inadequate Capacity



# Structurally Deficient

- Built In 1956
- Deck , Superstructure, Substructure Are All Showing Their Age
- Substantial Repairs or Replacement Are Needed



# Functionally Obsolete

- ④ 3 of 5 Lanes are 11' instead of 12'
- ④ Shoulder is 3' 10" instead of 4'
- ④ Clearance Over I-75 is 16.1' instead of 17'



# Inadequate Capacity

- ⌚ More Traffic on US 224
  - ⌚ 2014 ADT – 22,260
  - ⌚ 2034 ADT – 30,250
- ⌚ Insufficient lanes
- ⌚ Insufficient Storage in the Lanes



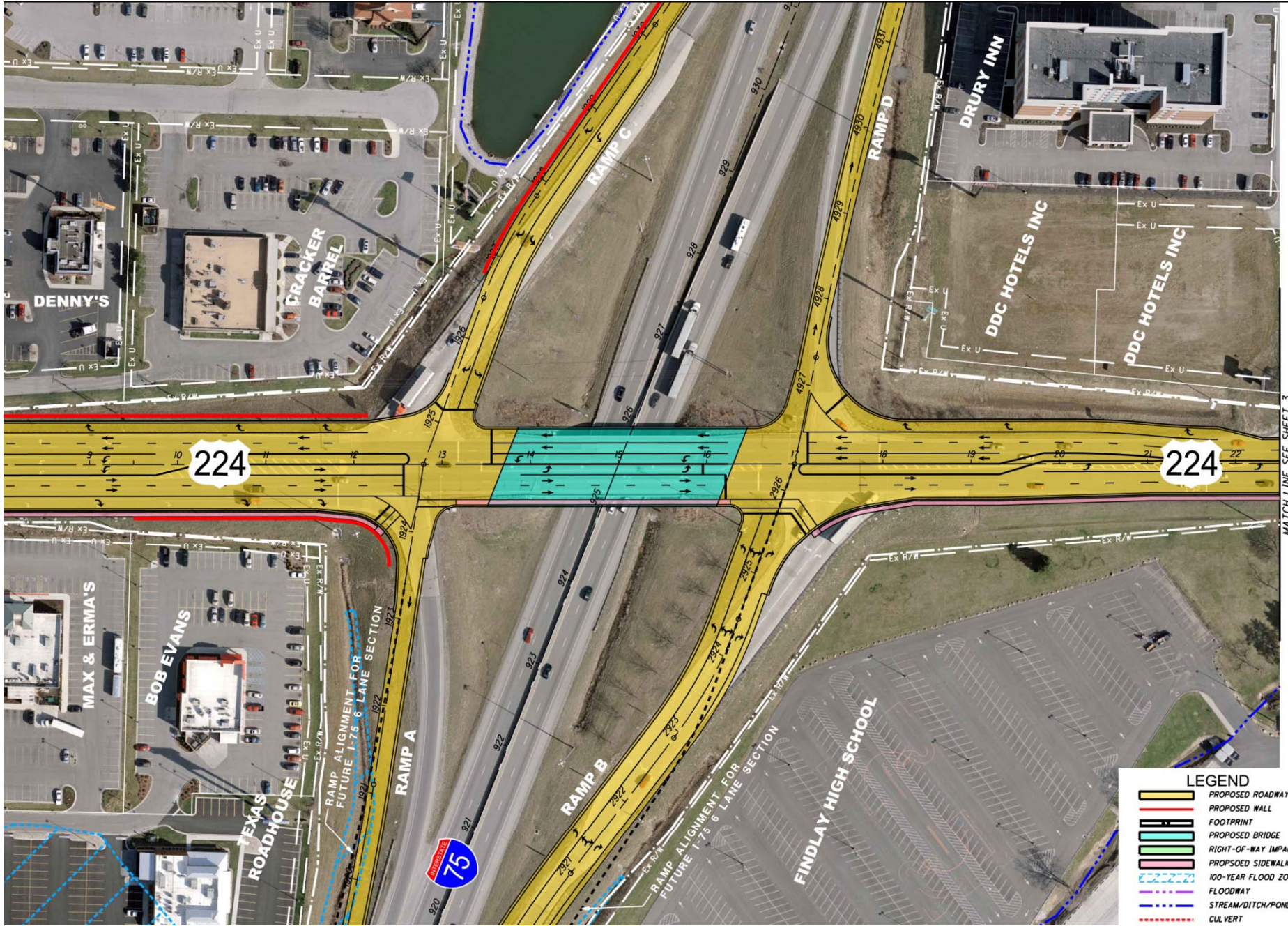

**LEGEND**

	PROPOSED ROADWAY
	PROPOSED WALL
	FOOTPRINT
	PROPOSED BRIDGE
	RIGHT-OF-WAY IMPACTS
	PROPOSED SIDEWALK
	100-YEAR FLOOD ZONE
	FLOODWAY
	STREAM/DITCH/POND
	CULVERT

MATCH LINE SEE SHEET 3

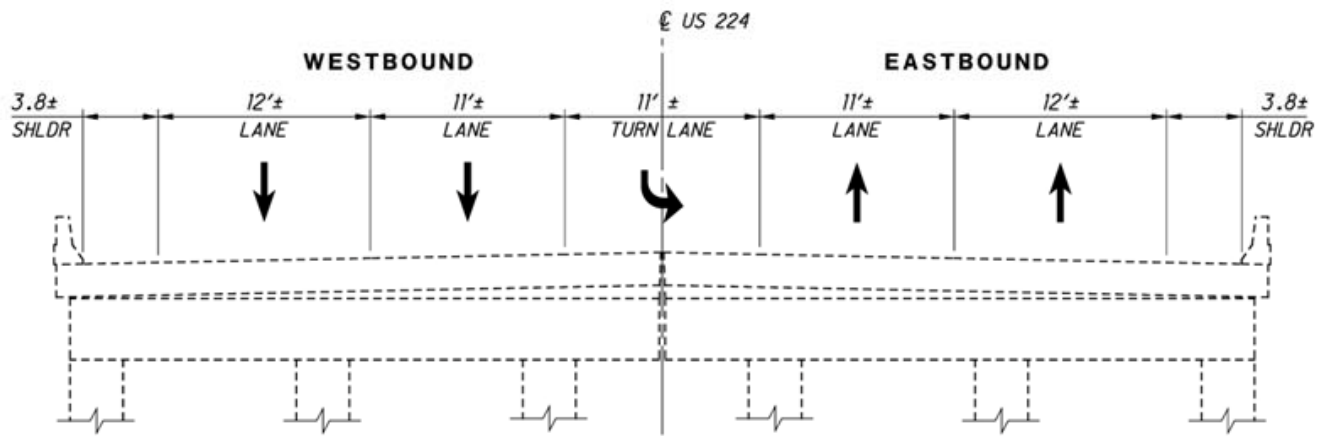

**US 224 - EXISTING BRIDGE SECTION**

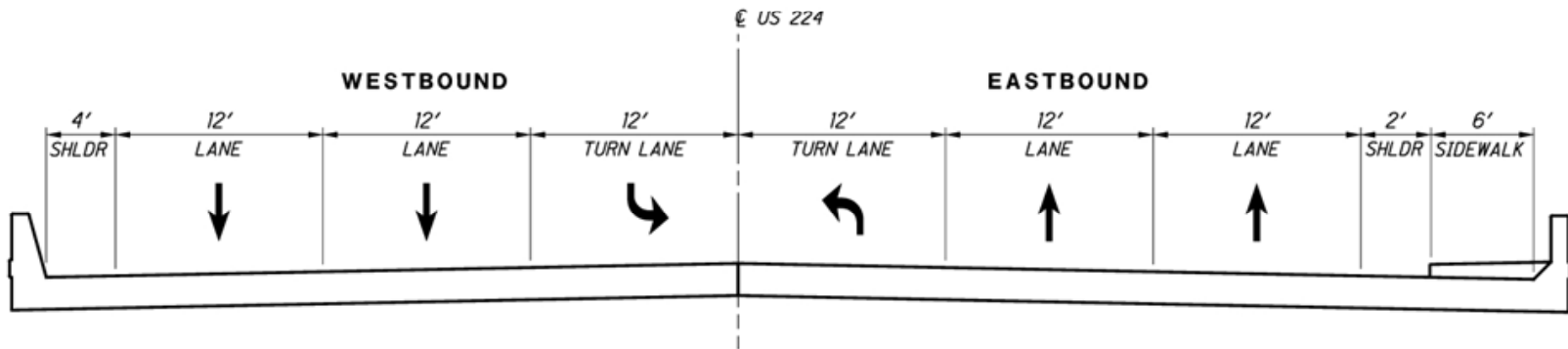

**US 224 - PROPOSED BRIDGE SECTION**

# Will You Close The Freeway During Construction?

- ④ NO
- ④ We Will Not Close the Freeway Except ...
  - ④ For One or Two Weekends
    - ④ Close the Bridge
    - ④ Divert Interstate Traffic to Ramps
  - ④ For Brief Safety Closures



# One or Two Weekend Closures of I-75

Divert Interstate traffic to ramps

Prohibit local access

From Friday evening to Monday morning



# Brief Closures Needed for Safety

- ◆ Place Beams and Signs over Roadway
- ◆ Brief Closures – 15 Minutes Long
- ◆ Clear Traffic Backlog Before Next Closure
- ◆ Restricted Hours  
11 pm to 5 am



# Will You Close US 224 During Construction

- ⦿ Option 1 – Close and Demolish
- ⦿ Option 2 – Part-Width Construction



# Close and Demolish

- Close Bridge for 90-120 Days
- Open 3 Lanes to Traffic
- Complete All Construction in 6-7 Months
- One Construction Season

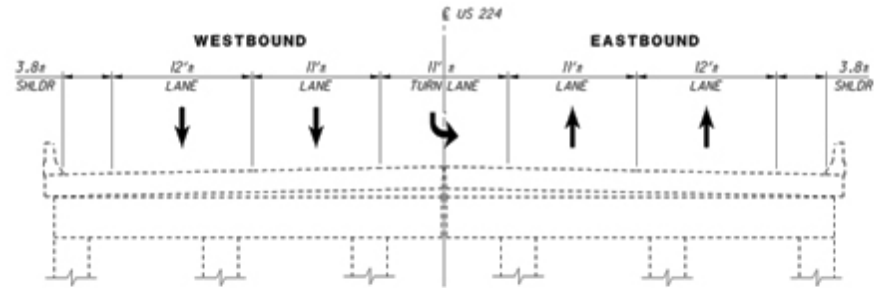

US 224 - EXISTING BRIDGE SECTION

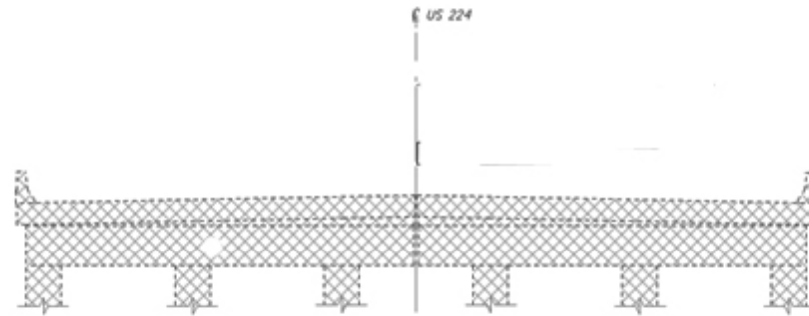

US 224 - PHASE 1 BRIDGE SECTION

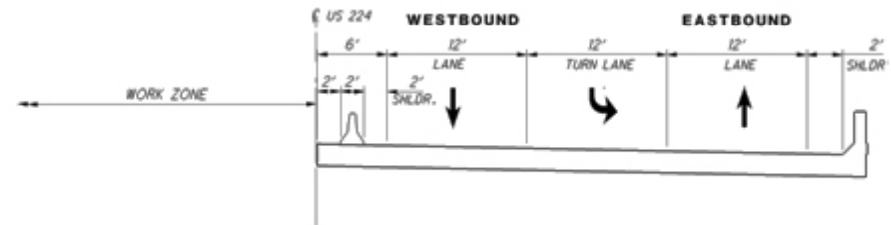

US 224 - PHASE 2 BRIDGE SECTION

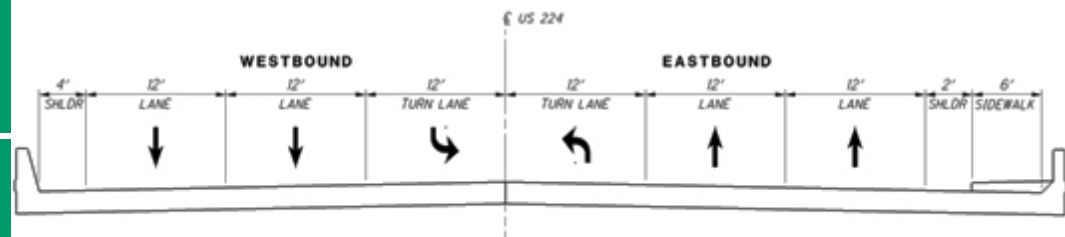

US 224 - PROPOSED BRIDGE SECTION

# Part-Width

- Maintain 2 Lanes of Traffic and Build One Side
- Open 3 Lanes to Traffic and Build Other Side
- Complete in 10-13 Months
- Potentially Take Two Construction Seasons

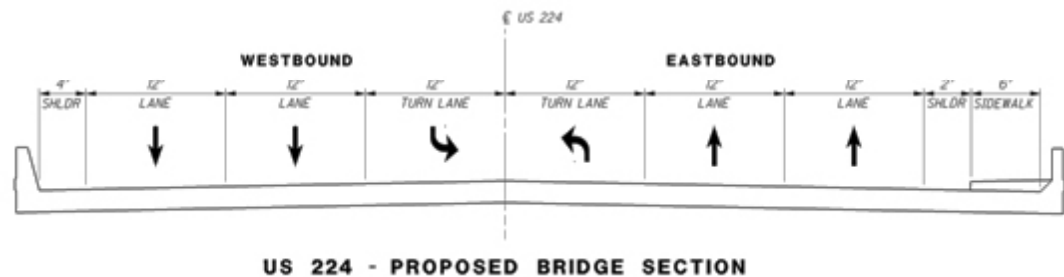
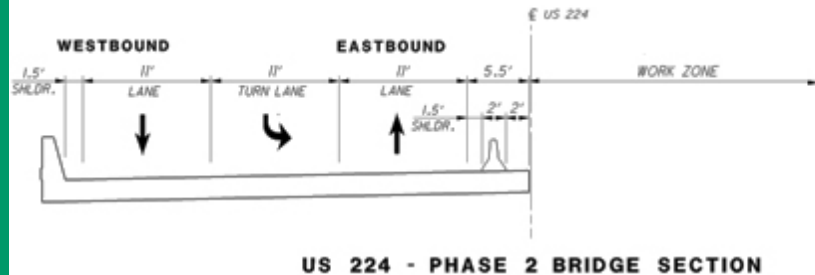
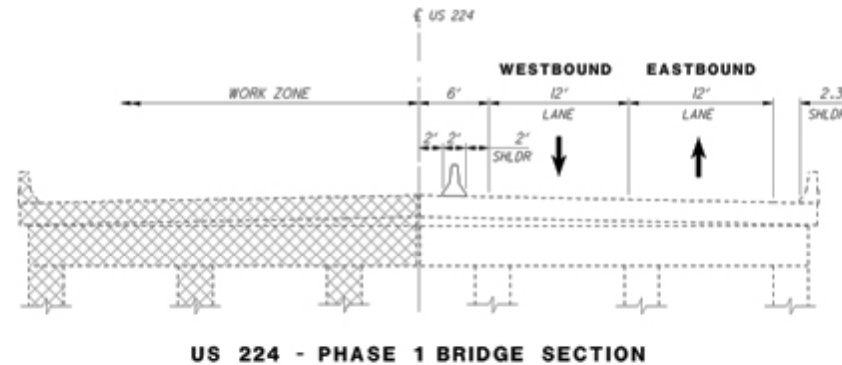
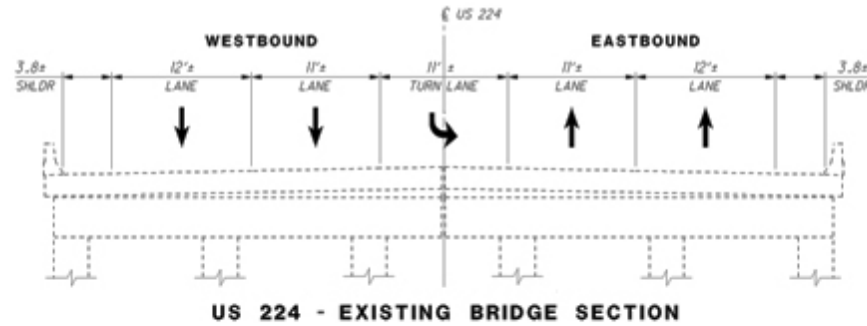

# Will there be detours

- ④ Option 1 Will Have an Official Detour
- ④ Option 2 Will Not Have an Official Detour
  - ④ If drivers avoid the area, the situation will be better for everybody



# What will it cost

- ⌚ We will develop detailed cost during the next step, the detailed design process
- ⌚ Similar projects elsewhere in the state have cost between \$14.0 and \$16.0 million
- ⌚ Best current estimate is \$14.1 million



# How long will construction take

- ⌚ We will develop a detailed schedule after we select an alternative
- ⌚ Best current estimate
  - ⌚ Option 1 will take 6 to 7 months
  - ⌚ Option 2 will take 10 to 13 months
- ⌚ Any schedule is dependant on weather and other unpredictable factors



# Safety

- ⦿ This is a Major Construction Project
  - ⦿ Orange Barrels
  - ⦿ Construction Workers
- ⦿ Please
  - ⦿ Slow Down
  - ⦿ Remain Alert
  - ⦿ Allow Extra Travel Time
  - ⦿ Be Courteous
  - ⦿ Be Patient
  - ⦿ Do Not Tailgate





OHIO DEPARTMENT OF  
TRANSPORTATION

# Comments

- ④ Register to speak
- ④ Go to the microphone
- ④ State your name, address, and any organization you represent
- ④ Keep your comments under 3 minutes
- ④ You may also make written comments
- ④ Written and verbal comments are treated the same





# OHIO DEPARTMENT OF TRANSPORTATION

Send comments to  
[Ram.Nunna@ch2m.com](mailto:Ram.Nunna@ch2m.com)