



# OHIO DEPARTMENT OF TRANSPORTATION

TED STRICKLAND, OHIO GOVERNOR

JOLENE M. MOLITORIS, ODOT DIRECTOR



## I-475 Salisbury Road/Dussel Drive Project

May 14, 2009, The Pinnacle, Maumee

Public Meeting



# **ODOT**

# **I-475 Salisbury**

# **Interchange Modification**

**David Dysard, AICP**  
District Two Deputy Director

**Theresa Pollick**  
Public Information Officer

**Michael T. Gramza, P.E.**  
District Construction Engineer

# I-475 Salisbury/Dussel Project



# I-475 Salisbury/Dussel Project

## Reasons for Project:

### 1. REDUCE CONGESTION

- Improve left turn movements with half cloverleaf interchange
- Widen Dussel Drive and Salisbury Road

### 2. Meet current standards of ODOT/ FHWA bridge height

### 3. Future US 23/I-475 development



# I-475 Salisbury/Dussel Project

## General Information

- **Construction 3 Year Project**  
Start: May 2009  
Complete: November 2011
- **Project cost : \$24,291,649**
- **Contractor: Miller Bros. Const. Inc, of Archbold, Ohio**



# I-475 Salisbury/Dussel Project Description

## 1. Interstate 475 Interchange Modifications

- Add 2 loop ramps
- Reconfigure existing ramps

## 2. Replace Salisbury bridge over I-475

## 3. Widen Salisbury Rd. & Dussel Dr. from Strayer Road to old Maumee Firehouse

- 6 lanes plus turn lanes

## 4. Other Work - Improve Drainage , Upgrade Interchange Lighting , Signal Upgrades, Landscaping



# I-475 Salisbury/Dussel Project

## Key dates:

### Start Work:

May 11, 2009

### Drainage West end:

June-July 2009

### 7 day Closure Salisbury:

June 1, 2009

### Begin road work Salisbury:

July 2009

### Project Completion :

November 2011



# I-475 Salisbury/Dussel Project

## Interstate 475 Maintenance of Traffic

- Overnight I-475 lane closures
- The ramp from eastbound Salisbury to northbound I-475 will close. Access to other ramps will be maintained with minimal short-term closures
- Bridge will be built one half at a time



# I-475 Salisbury/Dussel Project

## Salisbury/Dussel Maintenance of Traffic

- Constructing Salisbury/Dussel one half at a time, working on the north half first
- Local business access will remain open
- One lane in each direction with a turn lane at intersections



The background features a repeating pattern of white icons on a light green grid. The icons represent various modes of transportation: a bicycle, a bus, a truck, an airplane, a train, a car, a person walking, and a boat.

# **I-475/ Salisbury/ Dussel 2009 Construction What to Expect...**

# I-475 Salisbury/Dussel Project

1. I-475/ US 23
2. Salisbury Road Drainage Work
3. North half of Salisbury Rd. /Dussel Dr. and I-475 bridge



# I-475 Salisbury/Dussel Project

## 1. I-475/US 23

Nighttime lane closures in both directions on I-475/23 for shoulder work

Expect intermittent nighttime lane closures throughout the project for traffic shifts, structural steel placement and concrete bridge deck placement



# I-475 Salisbury/Dussel Project

## 2. Salisbury Road Drainage Work

**PHASE 1 – 7 DAYS JUNE 1**

Salisbury Rd. in both directions is closed from just west of Strayer Road. to just west of Manley Rd

Briarfield Blvd. will be open and used as a detour



# Salisbury Drainage –Phase 1

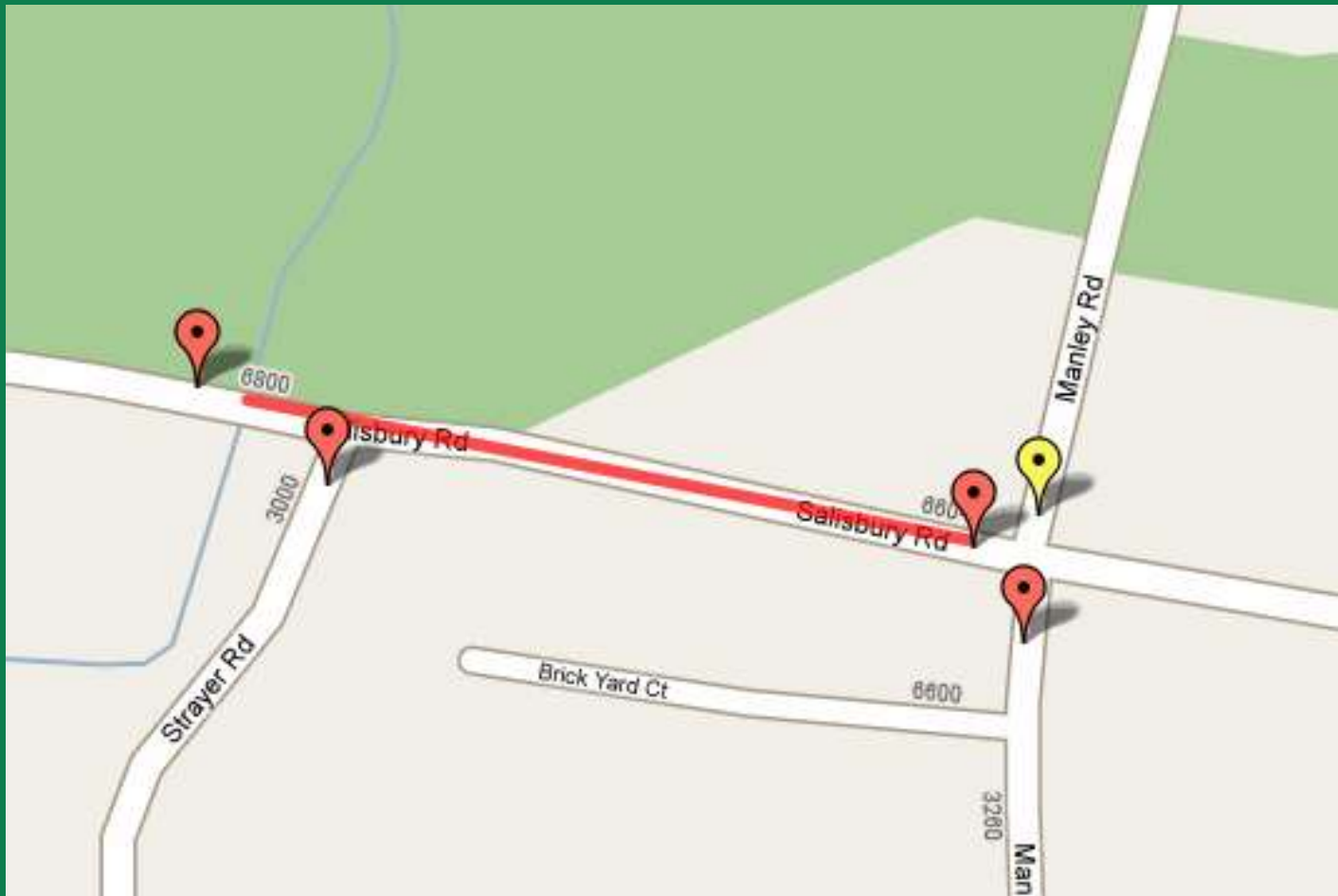

# Salisbury Drainage – Detour



# I-475 Salisbury/Dussel Project

## 2. Salisbury Road Drainage Work

**PHASE 2 – 21 DAYS JUNE - JULY**

Eastbound Salisbury will be closed between east of Strayer Road. to west of Briarfield Blvd

Westbound Salisbury open to traffic but subject to lane closures

Briarfield Blvd. will remain open and used as detour route



# Salisbury Drainage – Phase 2

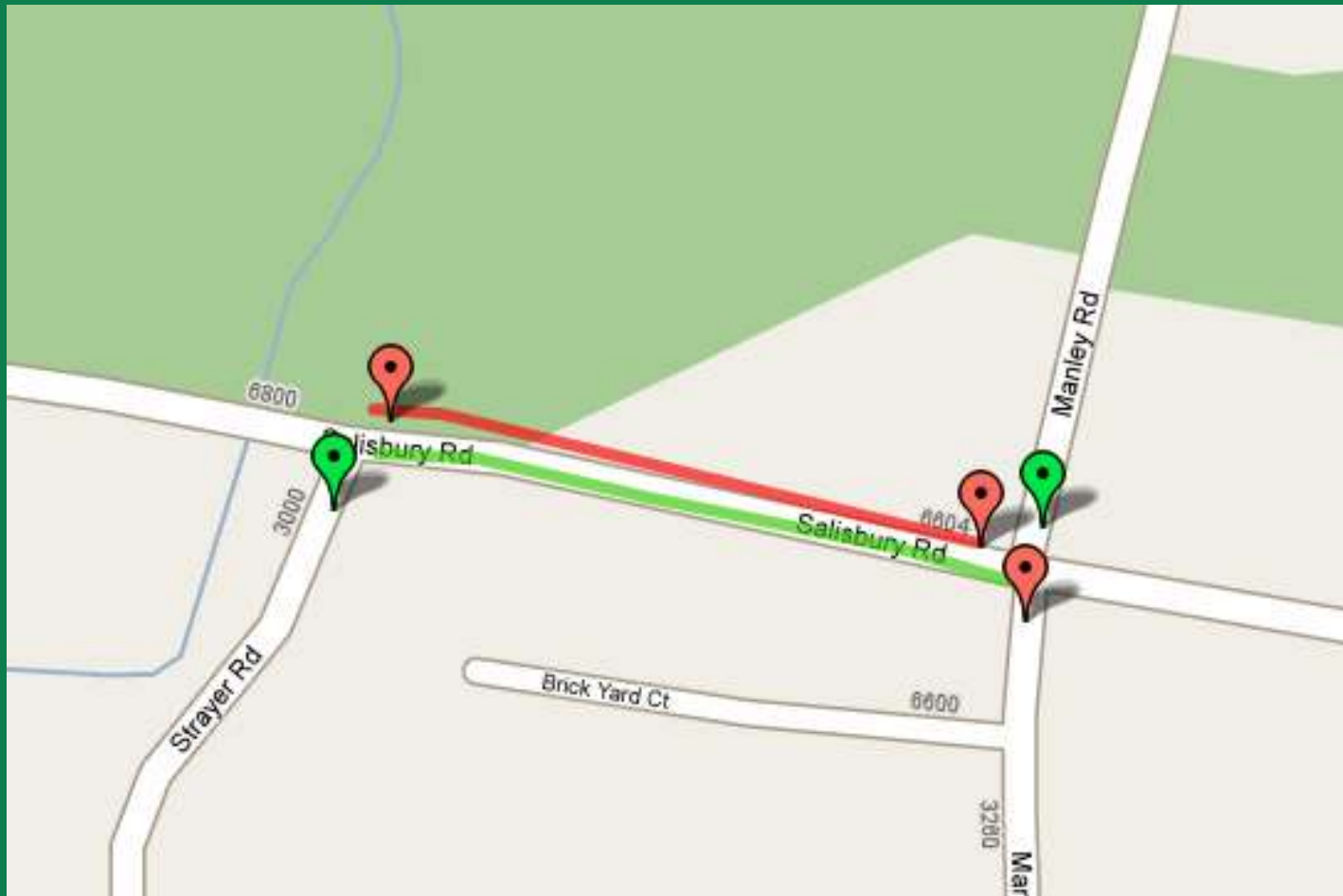

# I-475 Salisbury/Dussel Project

## 3. North-Half Construction

### Salisbury/ Dussel and I-475 bridge

This phase of work will not begin until drainage work is complete and portions of the I-475 work are complete

Estimated timeline: After July 4, 2009

This phase of work is scheduled to go into the summer of 2010



# I-475 Salisbury/Dussel Project

## 3. North-Half Construction Salisbury Road & Dussel Drive

Access to businesses will be maintained

All intersections (Ford, Arrowhead, Briarfield, Manley) will remain open

Traffic in both directions will be pushed to the south half of the road. One thru lane and one left turn lane will be provided at each intersection.



# I-475 Salisbury/Dussel Project

## 3. North-Half Construction I-475 Bridge & Ramps

Access to and from I-475 will be maintained *except ...*

Access from eastbound Salisbury Road to northbound I-475 will be closed. Detour: SB I-475 ; US 24; NB I-475.

**\*\*It is not known at this time when this closure will take place. Details provided at a later date.**



# MAINTENANCE OF TRAFFIC SCHEMATIC - PHASE 2

**MAINTENANCE OF TRAFFIC NOTES:**

**PHASE 2**  
 THE CONTRACTOR SHALL CONSTRUCT TEMPORARY PAVEMENT ON THE SOUTH SIDE OF SALISBURY ROAD FROM STA. 84+18 TO STA. 81+77. WIDTH VARIES FROM 2'-0" TO 14'-0". ALSO, TEMPORARY PAVEMENT IS TO BE CONSTRUCTED ON THE NORTH SIDE OF SALISBURY ROAD/USSEL DRIVE AT THE FOLLOWING LOCATIONS: STA. 88+45 TO STA. 88+45, STA. 111+28 TO STA. 111+38 AND STA. 123+45 TO STA. 123+45. SEE PLAN SHEETS FOR DETAILS. SEE SHEET 30A FOR PROPOSED PARTIAL CONCRETE PAVEMENT CONSTRUCTION BETWEEN STA. 83+18 AND STA. 84+00.

THE CONTRACTOR SHALL CONSTRUCT THE NORTH SIDE OF THE NEW SALISBURY ROAD/USSEL DRIVE BRIDGE OVER I-475 AND THE PROPOSED WESTBOUND LANES OF SALISBURY ROAD/USSEL DRIVE BETWEEN STA. 78+30 TO STA. 124+30 EXCEPT THE INTERSECTIONS OF ANNOHEAD DRIVE AND FOND STREET. TWO WAY TRAFFIC AND A LEFT TURN LANE SHALL BE MAINTAINED ON LANES VARYING FROM 10' TO 12' ON EXISTING EASTBOUND SALISBURY ROAD/USSEL DRIVE. THE CONTRACTOR SHALL MAINTAIN ACCESS TO ORANGEVALE LANE, ANNOHEAD ROAD, FOND STREET, EXISTING RAMPS A, B, C AND D, AND ALL PROPERTIES ALONG SALISBURY ROAD/USSEL DRIVE. THE CONTRACTOR SHALL CONSTRUCT PROPOSED RAMP A FROM STA. 135+00 TO STA. 135+00 AND FROM STA. 136+25 TO STA. 135+50 (I-475). WHILE RAMP A IS UNDER CONSTRUCTION TRAFFIC SHALL UTILIZE THE TEMPORARY PAVEMENT CONSTRUCTED IN PHASE 1. THE CONTRACTOR SHALL CONSTRUCT PROPOSED RAMP B FROM STA. 124+30 TO STA. 113+70 OR (I-475). WHILE RAMP B IS UNDER CONSTRUCTION, NORTHBOUND TRAFFIC CAN EXIT I-475 ON THE TEMPORARY PAVEMENT CONSTRUCTED IN PHASE 1. THE CONTRACTOR SHALL CONSTRUCT PROPOSED RAMP C FROM STA. 118+50 TO STA. 127+00 AND FROM STA. 134+00 TO STA. 135+50 (I-475). THE CONTRACTOR SHALL CONSTRUCT PROPOSED RAMP E FROM STA. 124+10 TO STA. 124+71.51 (I-475). WHILE RAMP E IS UNDER CONSTRUCTION, SOUTHBOUND TRAFFIC CAN EXIT I-475 ON THE TEMPORARY PAVEMENT CONSTRUCTED IN PHASE 1. THE CONTRACTOR SHALL CONSTRUCT PROPOSED RAMP F FROM STA. 134+50 TO STA. 143+00 AND FROM STA. 141+50 TO STA. 143+00.

**PHASE 2A**  
 SOUTHBOUND TRAFFIC CAN EXIT I-475 USING THE PROPOSED EXIT TERMINAL AND PROPOSED RAMP E. THE TEMPORARY PAVEMENT SHALL BE REMOVED AT THIS TIME ALONG WITH EXISTING RAMP D. THE CONTRACTOR SHALL COMPLETE CONSTRUCTION OF PROPOSED RAMP F FROM STA. 140+00 TO STA. 141+50 AND THE INTERSECTION WITH SALISBURY ROAD/USSEL DRIVE.

**PHASE 2B**  
 THE CONTRACTOR SHALL CONSTRUCT TEMPORARY PAVEMENT FROM EXISTING RAMP A NEAR THE INTERSECTION OF SALISBURY ROAD/USSEL DRIVE TO STA. 135+00. PROPOSED RAMP A.

**PHASE 2C**  
 THE CONTRACTOR SHALL COMPLETE RAMP A FROM STA. 135+00 TO STA. 136+25 AND STA. 135+50 (I-475) TO STA. 133+88.42. THE TEMPORARY PAVEMENT CONSTRUCTED IN PHASE 1 CAN BE REMOVED. THE CONTRACTOR SHALL THEN COMPLETE THE INTERSECTIONS OF ANNOHEAD DRIVE AND FOND STREET ON THE NORTH SIDE.

**PHASE 2D**  
 THE CONTRACTOR SHALL PROVIDE A DETOUR FOR EASTBOUND SALISBURY/USSEL TO NORTHBOUND I-475. THE CONTRACTOR SHALL DETOUR TRAFFIC OVER EXISTING RAMP C SOUTHBOUND OVER I-475 TO THE U.S. 24 INTERCHANGE FOLLOWING SIGNALS TO GET BACK TO I-475 NORTHBOUND. THE CONTRACTOR SHALL PROVIDE SIGNALS TO DIRECT THE WESTBOUND TRAFFIC OVER PROPOSED RAMP A TO I-475 NORTHBOUND.

**PHASE 2E**  
 CONSTRUCT THE REMAINING PORTION OF USSEL DRIVE BETWEEN STA. 80+00 AND STA. 100+50.

**LOCATION OF PORTABLE CHANGEBAR MESSAGE SIGNS:**  
 STA. 8+00 NB I-475  
 STA. 280+00 SB I-475

- LEGEND**
- Phase 1 █
  - Phase 2 █
  - Phase 2a █
  - Phase 2b █
  - Phase 2c █

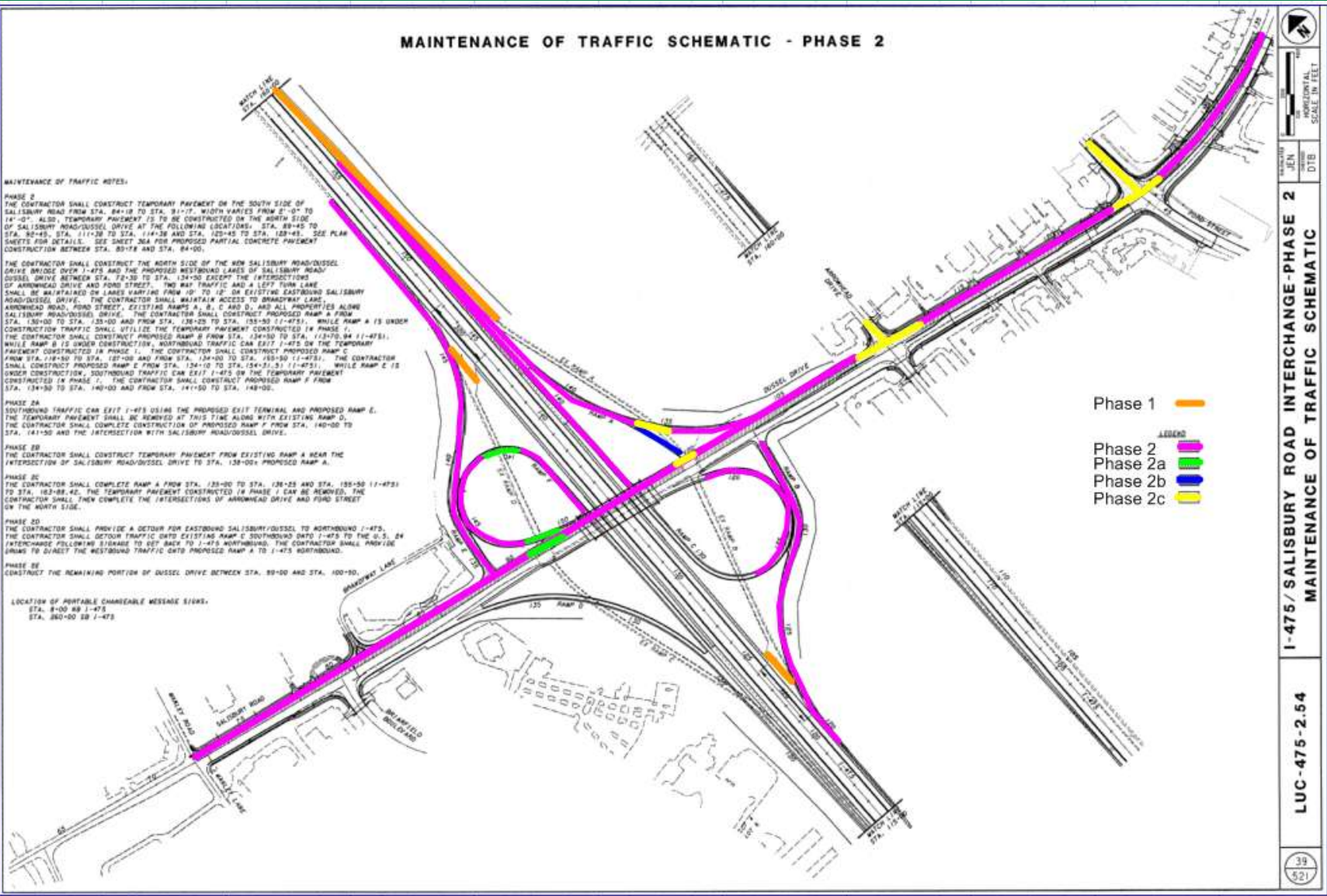

DATE: JEN  
 DRAWN: DTB

HORIZONTAL SCALE IN FEET

**I-475/SALISBURY ROAD INTERCHANGE-PHASE 2**

**MAINTENANCE OF TRAFFIC SCHEMATIC**

LUC-475-2.54

39

521

# I-475 Salisbury/Dussel Project

**Beyond 2009...**

**July 2010** - South side construction along Salisbury, Dussel and I-475

**Signal Work** - Various signals including at the I-475 ramps , Briarfield, Manley, Arrowhead, Ford

**Landscaping** – Trees in infield, grass etc.



# I-475 Salisbury/Dussel Project

## South-Half Construction

### Salisbury/ Dussel and I-475 bridge

This phase of work will not begin until the north half of construction is complete

Estimated timeline: After July 4, 2010

This phase of work is scheduled to go into November 2011



# I-475 Salisbury/Dussel Project

## South-Half Construction

### Salisbury Road & Dussel Drive

Access to businesses will be maintained

All intersections (Ford, Arrowhead, Briarfield, Manley) will remain open

Traffic in both directions will be pushed to the north half of the road. One thru lane and one left turn lane will be provided at each intersection.



# MAINTENANCE OF TRAFFIC SCHEMATIC - PHASE 4

## MAINTENANCE OF TRAFFIC NOTES:

**PHASE A**  
 THE CONTRACTOR SHALL MAINTAIN THE DETOUR ESTABLISHED IN PHASE 2D FOR EASTBOUND TRAFFIC TO WORTHINGTON I-475 USING EXISTING RAMP C. THE CONTRACTOR SHALL CONSTRUCT THE SOUTH SIDE OF THE NEW SALISBURY ROAD/DUSSEL DRIVE BRIDGE OVER I-475 AND THE PROPOSED EASTBOUND LANES OF SALISBURY ROAD/DUSSEL DRIVE BETWEEN STA. 72+85 TO STA. 134+50 EXCEPT FOR THE INTERSECTIONS OF BRIANFIELD BOULEVARD, ARROWHEAD DRIVE AND FOND STREET. TWO WAY TRAFFIC AND A LEFT TURN LANE SHALL BE MAINTAINED ON THOSE TWICE FOOT LANES ON THE COMPLETED WESTBOUND SALISBURY ROAD/DUSSEL DRIVE. THE CONTRACTOR SHALL MAINTAIN ACCESS TO BRIANFIELD BOULEVARD, ARROWHEAD ROAD, FOND STREET, EXISTING RAMP B AND C, AND ALL ADJACENT LOTS ALONG SALISBURY ROAD/DUSSEL DRIVE. THE CONTRACTOR SHALL COMPLETE RAMP B CONSTRUCTION TO DUSSEL DRIVE. THE CONTRACTOR SHALL CONSTRUCT RAMP D FROM STA. 111+50 TO STA. 111+475 TO STA. 121+50 AND STA. 122+00 TO STA. 141+00. WHILE RAMP D IS UNDER CONSTRUCTION TRAFFIC SHALL UTILIZE THE TEMPORARY PAVEMENT CONSTRUCTED IN PHASE 3. THE CONTRACTOR SHALL CONSTRUCT PROPOSED RAMP F FROM STA. 111+50 TO STA. 111+475 TO STA. 124+50.

**PHASE 4A**  
 NORTHBOUND TRAFFIC SHALL EXIT I-475 USING THE PROPOSED RAMP B. WESTBOUND TRAFFIC SHALL USE PROPOSED RAMP F TO ACCESS I-475 SOUTHBOUND. THE TEMPORARY PAVEMENT CONSTRUCTED IN PHASE 3 SHALL BE REMOVED AT THIS TIME ALONG WITH EXISTING RAMP B. THE CONTRACTOR SHALL COMPLETE CONSTRUCTION OF RAMP C AT THE INTERSECTION WITH SALISBURY ROAD/DUSSEL DRIVE AND STA. 127+00 TO STA. 124+50.

**PHASE 4B**  
 THE CONTRACTOR SHALL CONSTRUCT TEMPORARY PAVEMENT FROM EXISTING RAMP C NEAR THE INTERSECTION OF SALISBURY ROAD/DUSSEL DRIVE TO STA. 120+00 PROPOSED RAMP D.

**PHASE 4C**  
 THE CONTRACTOR SHALL COMPLETE RAMP D FROM STA. 80+00 TO STA. 80+00 TO STA. 111+50 AND STA. 121+50 TO STA. 122+00. THE CONTRACTOR SHALL THEN PROVIDE SHOULDER TO DIRECT EASTBOUND TRAFFIC TO PROPOSED RAMP D TO ACCESS I-475 SOUTHBOUND. THE TEMPORARY PAVEMENT CONSTRUCTED IN PHASE 3 CAN BE REMOVED. THE CONTRACTOR SHALL THEN COMPLETE THE INTERSECTIONS OF BRIANFIELD BOULEVARD, ARROWHEAD DRIVE AND FOND STREET ON THE SOUTH SIDE. THE CONTRACTOR SHALL THEN COMPLETE SALISBURY ROAD IN THE AREA OF EXISTING RAMP C. THE INTERSECTION OF SALISBURY ROAD/DUSSEL DRIVE AT EXISTING RAMP B, AND REMOVE THE REMAINDER OF EXISTING RAMP B AND EXISTING RAMP C.

AFTER COMPLETION OF PHASE 4C, THE CONTRACTOR SHALL REMOVE THE EXISTING OR TEMPORARY PAVEMENT AND CONSTRUCT THE PROPOSED PAVEMENT AT LOCATIONS DESIGNATED IN THE PLANS. THIS WORK SHALL BE A CONTINUOUS OPERATION LASTING ONLY ONE MORNING PER LOCATION. UPON COMPLETION OF THIS WORK THE CONTRACTOR SHALL CONSTRUCT THE CONCRETE MEDIAN ALONG DUSSEL DRIVE FROM STA. 103+07 TO STA. 132+88.

### LOCATION OF PORTABLE CHANGEBLANK MESSAGE SIGNS:

STA. 840+00 I-475  
 STA. 060+00 SB I-475

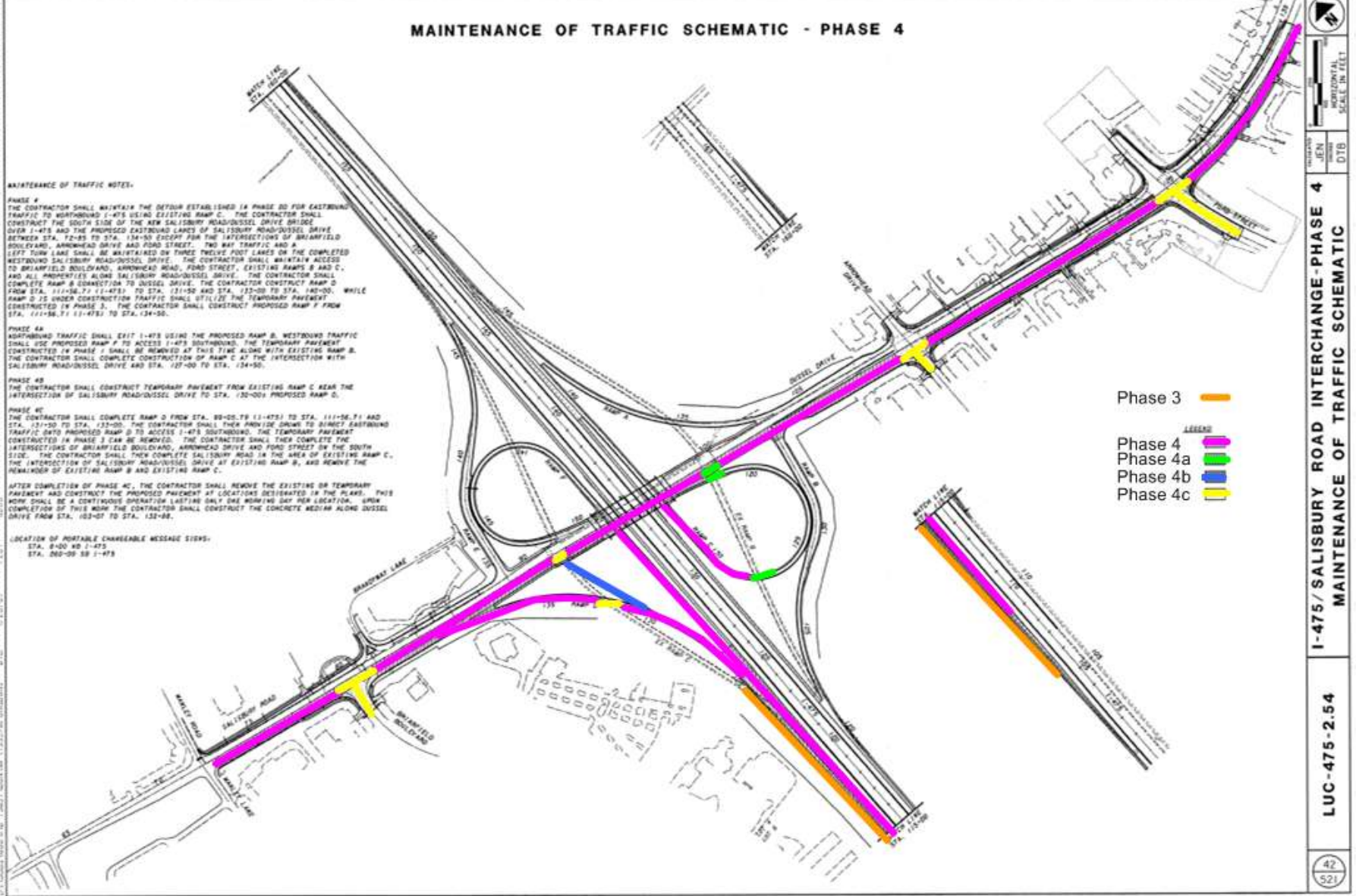

- Phase 3 █
- Phase 4 █
- Phase 4a █
- Phase 4b █
- Phase 4c █

I-475/SALISBURY ROAD INTERCHANGE - PHASE 4  
 MAINTENANCE OF TRAFFIC SCHEMATIC

LUC-475-2.54

42  
 521

# Project Updates

Traffic information available at  
[www.buckeyetraffic.org](http://www.buckeyetraffic.org)



Join E-mail List:  
[d02.pio@dot.state.oh.us](mailto:d02.pio@dot.state.oh.us)  
Subject: I-475 Project

ODOT District Two Website:  
[www.dot.state.oh.us/districts/D02](http://www.dot.state.oh.us/districts/D02)



**Questions?**