

**ODOT District 11
No Passing Zone Log (TUS)**

Route: **0250R (STUSUS00250**C)**

From: **0.000 LEAVE STA CO**

Length: **27.142**

Direction: **East**

To: **27.142 ENTER HAS CO**

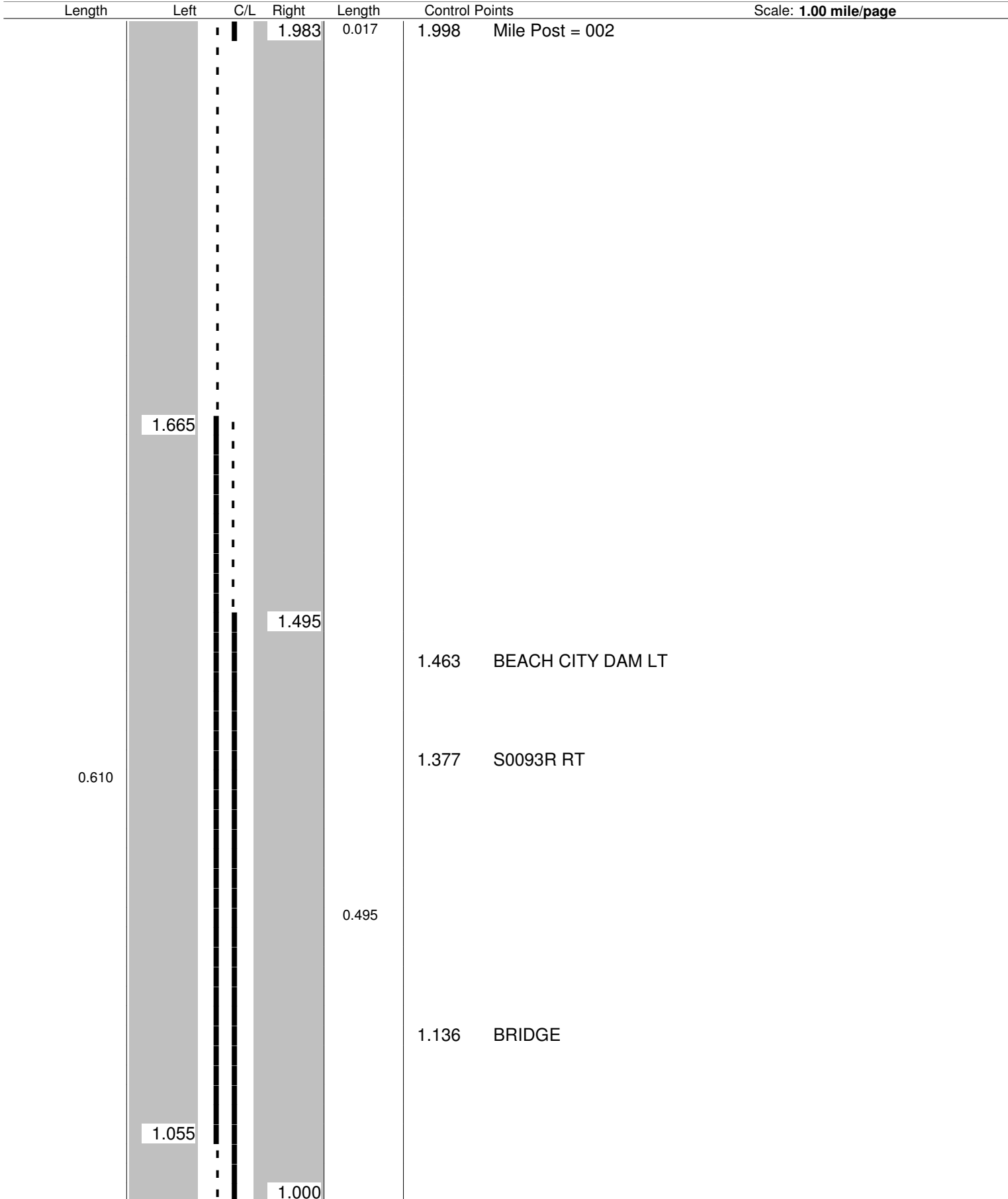

Sheet total equivalent length of solid line: 1.262

Accum. total: 1.847

**ODOT District 11
No Passing Zone Log (TUS)**

Route: **0250R (STUSUS00250**C)**

From: **0.000 LEAVE STA CO**

Length: **27.142** Direction: **East**

To: **27.142 ENTER HAS CO**

Length Left C/L Right Length Control Points Scale: **1.00 mile/page**

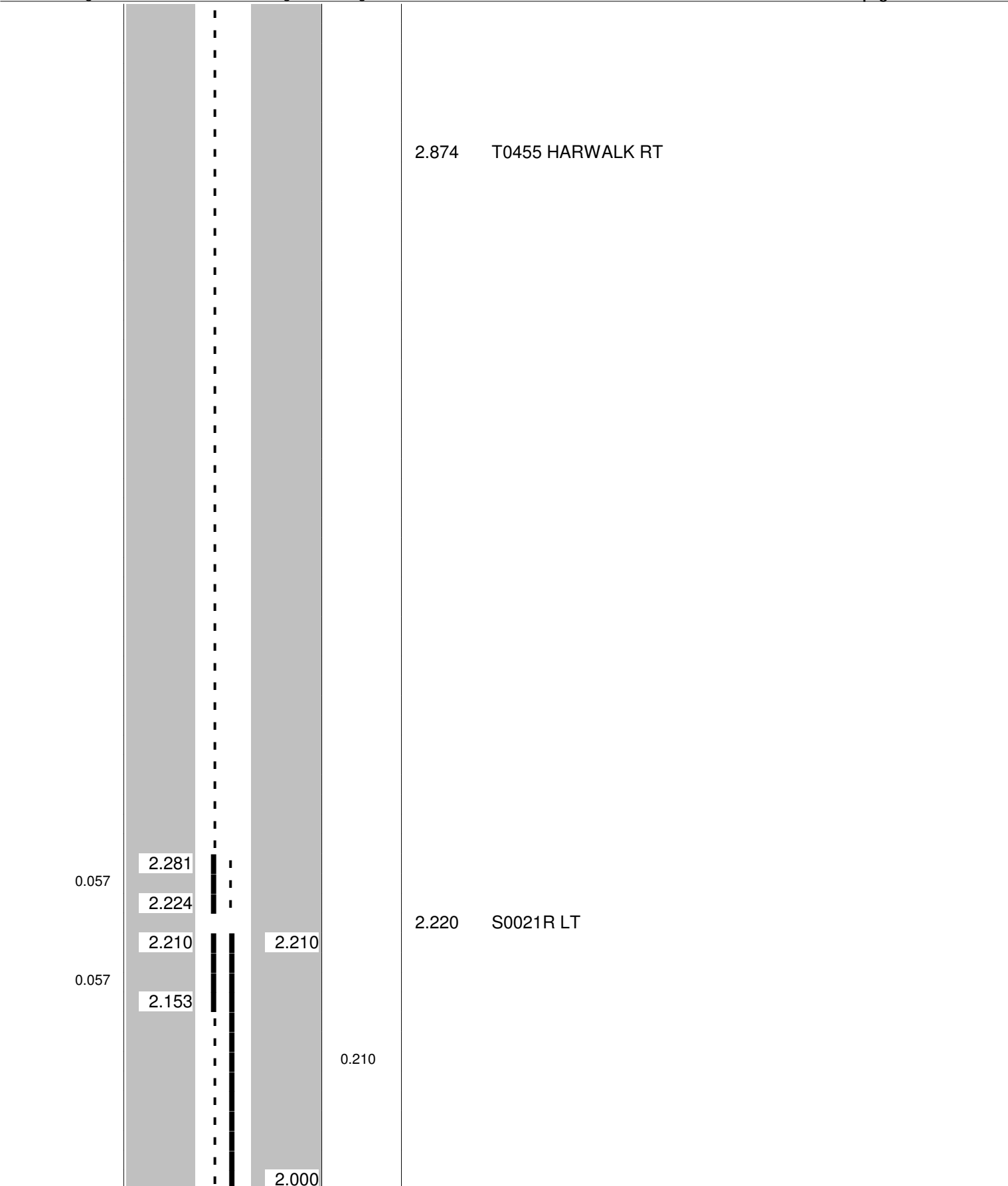

Sheet total equivalent length of solid line: 0.556

Accum. total: 2.403

**ODOT District 11
No Passing Zone Log (TUS)**

Route: **0250R (STUSUS00250**C)**

From: **0.000 LEAVE STA CO**

Length: **27.142** Direction: **East**

To: **27.142 ENTER HAS CO**

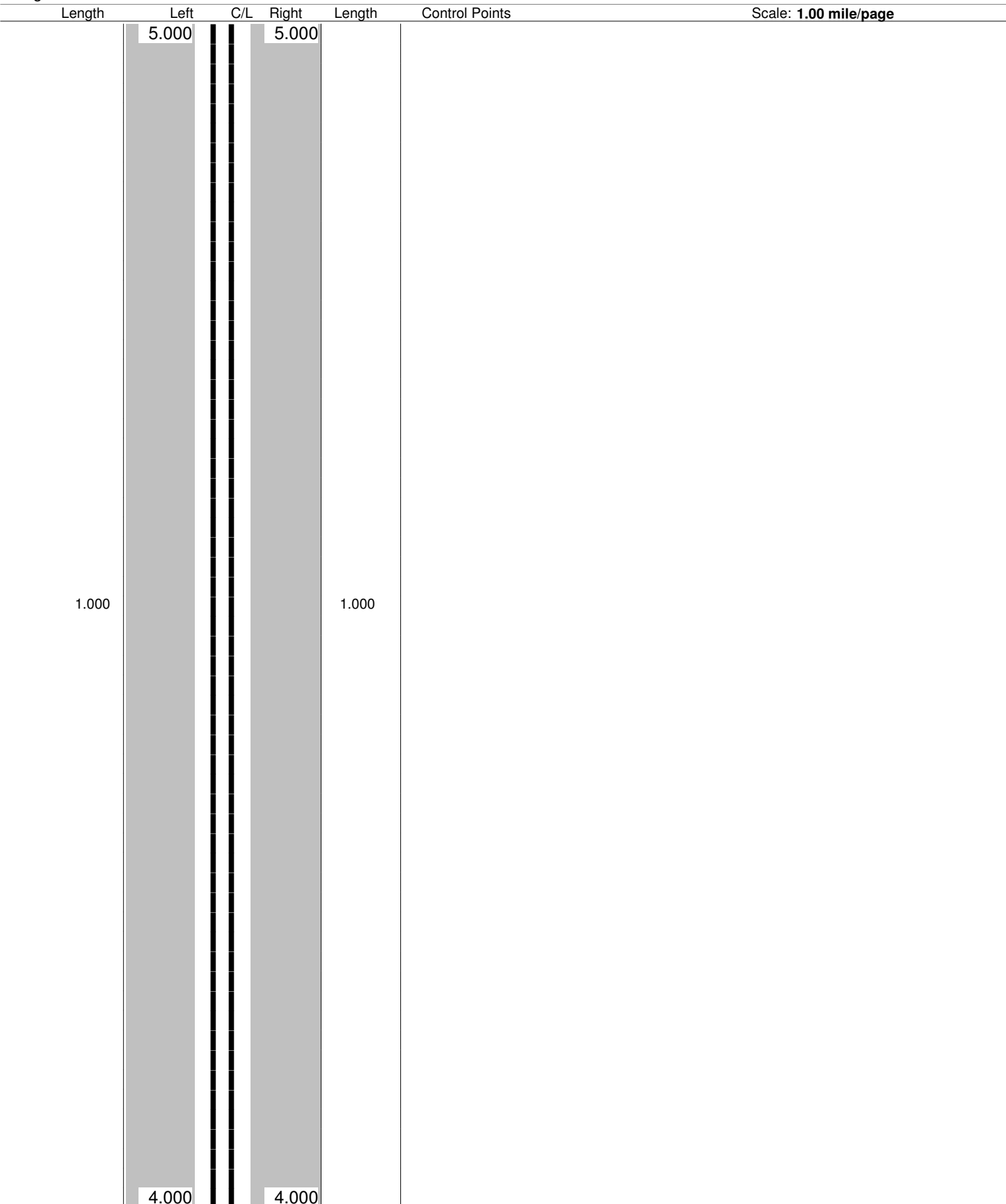

Sheet total equivalent length of solid line: 2.000

Accum. total: 5.915

**ODOT District 11
No Passing Zone Log (TUS)**

Route: **0250R (STUSUS00250**C)**

From: **0.000 LEAVE STA CO**

Length: **27.142** Direction: **East**

To: **27.142 ENTER HAS CO**

Length	Left	C/L	Right	Length	Control Points	Scale: 1.00 mile/page
	6.000		6.000			
	5.446		5.446		5.465 BEGIN 4 LANES 5.465 I0077R RAMPS - EAST OF I0077R RT	
0.289				0.288		
	5.157		5.158		5.267 I0077R Hwy Under Hwy 5.241 I0077R Hwy Under Hwy 5.207 I0077R RAMPS RT 5.172 I0077R RAMP RT	
0.041	5.140					
0.001	5.099		5.099	0.031 0.001	5.101 BRIDGE	
	5.052		5.052		5.061 T0425 RACE RT 5.023 LEAVE STRASBURG	
0.041				0.041		
0.011	5.011		5.011	0.011		

↑ 55mph

**ODOT District 11
No Passing Zone Log (TUS)**

Route: **0250R (STUSUS00250**C)**

From: **0.000 LEAVE STA CO**

Length: **27.142** Direction: **East**

To: **27.142 ENTER HAS CO**

Length	Left	C/L	Right	Length	Control Points	Scale: 1.00 mile/page
	24.000		24.000		23.982 Mile Post = 024	
0.538				0.538	23.715 BRIDGE	
					23.638 C0035 FETTE LT	
					23.588 T0287 FUHR LT	
					23.511 T1235 SHADYSIDE LT	
	23.462		23.462		23.450 S0800R	
					23.440 END 4 LANES	

**ODOT District 11
No Passing Zone Log (TUS)**

Route: **0250R (STUSUS00250**C)**

From: **0.000 LEAVE STA CO**

Length: **27.142** Direction: **East**

To: **27.142 ENTER HAS CO**

Length	Left	C/L	Right	Length	Control Points	Scale: 1.00 mile/page
	25.000		25.000			
1.000				1.000	24.599 T0299 IRISH RUN LT	
					24.209 BRIDGE	
					24.038 C0066 ROXFORD CHURCH LT	
	24.000		24.000			

**ODOT District 11
No Passing Zone Log (TUS)**

Route: **0250R (STUSUS00250**C)**

From: **0.000 LEAVE STA CO**

Length: **27.142** Direction: **East**

To: **27.142 ENTER HAS CO**

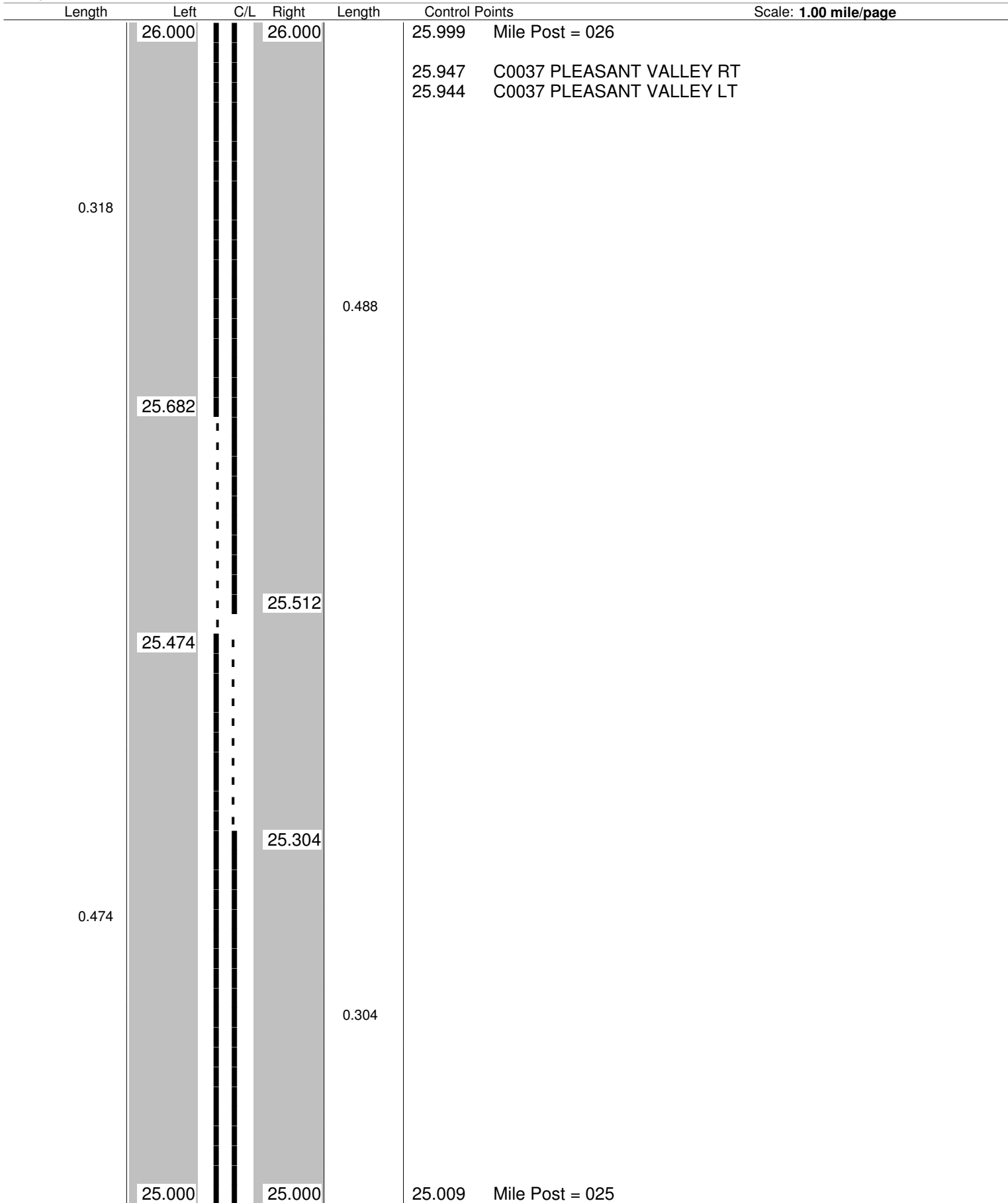

Sheet total equivalent length of solid line: 1.679

Accum. total: 11.579

**ODOT District 11
No Passing Zone Log (TUS)**

Route: **0250R (STUSUS00250**C)**

From: **0.000 LEAVE STA CO**

Length: **27.142** Direction: **East**

To: **27.142 ENTER HAS CO**

Length	Left	C/L	Right	Length	Control Points	Scale: 1.00 mile/page
					26.974 Mile Post = 027	
0.218	26.939		26.769	0.218		
	26.721					
	26.591		26.551			
			26.421		26.386 T0035 LONE PINE LT	
0.591				0.421		
	26.000		26.000			

**ODOT District 11
No Passing Zone Log (TUS)**

Route: **0250R (STUSUS00250**C)**

From: **0.000 LEAVE STA CO**

Length: **27.142**

Direction: **East**

To: **27.142 ENTER HAS CO**

Length	Left	C/L	Right	Length	Control Points	Scale: 1.00 mile/page
--------	------	-----	-------	--------	----------------	-----------------------

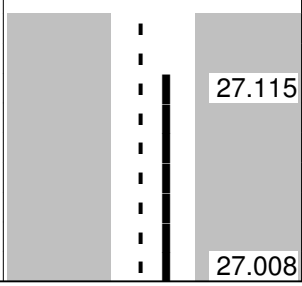

27.142 ENTER HAS CO

0.107