

Design Goal

“Aspire to a design that further defines and enhances the identity of Cleveland, reflects the technology of our time and respects Cleveland’s history and culture in a fiscally-responsible manner.”



Input & Design Selections

Preference Polling

- Aesthetic Committee Meeting
- On-line Polling
- Public Meeting

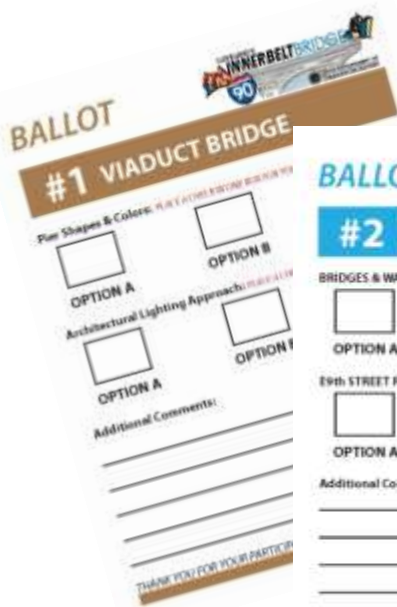

BALLOT
#1 VIADUCT BRIDGE

Plan Shapes & Colors: PLACE A CHECK IN ONE BOX FOR YOUR SELECTION

OPTION A

Architectural Lighting Approach: PLACE A CHECK IN ONE BOX FOR YOUR SELECTION

OPTION A

OPTION B

Additional Comments:

THANK YOU FOR YOUR PARTICIPATION!



BALLOT
#2 GATEWAY (DOWNTOWN) AREA BRIDGES

BRIDGES & WALLS: PLACE A CHECK IN ONE BOX FOR YOUR SELECTION

OPTION A

OPTION B

19th STREET RAILING: PLACE A CHECK IN ONE BOX FOR YOUR SELECTION

OPTION A

OPTION B

Additional Comments:

THANK YOU FOR YOUR PARTICIPATION!

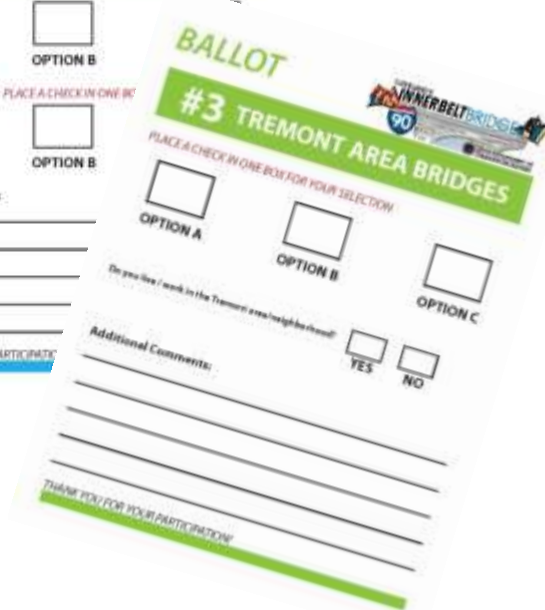

BALLOT
#3 TREMONT AREA BRIDGES

PLACE A CHECK IN ONE BOX FOR YOUR SELECTION

OPTION A

OPTION B

OPTION C

Do you live / work in the Tremont area (might be closed)?

YES

NO

Additional Comments:

THANK YOU FOR YOUR PARTICIPATION!

Preference Polling

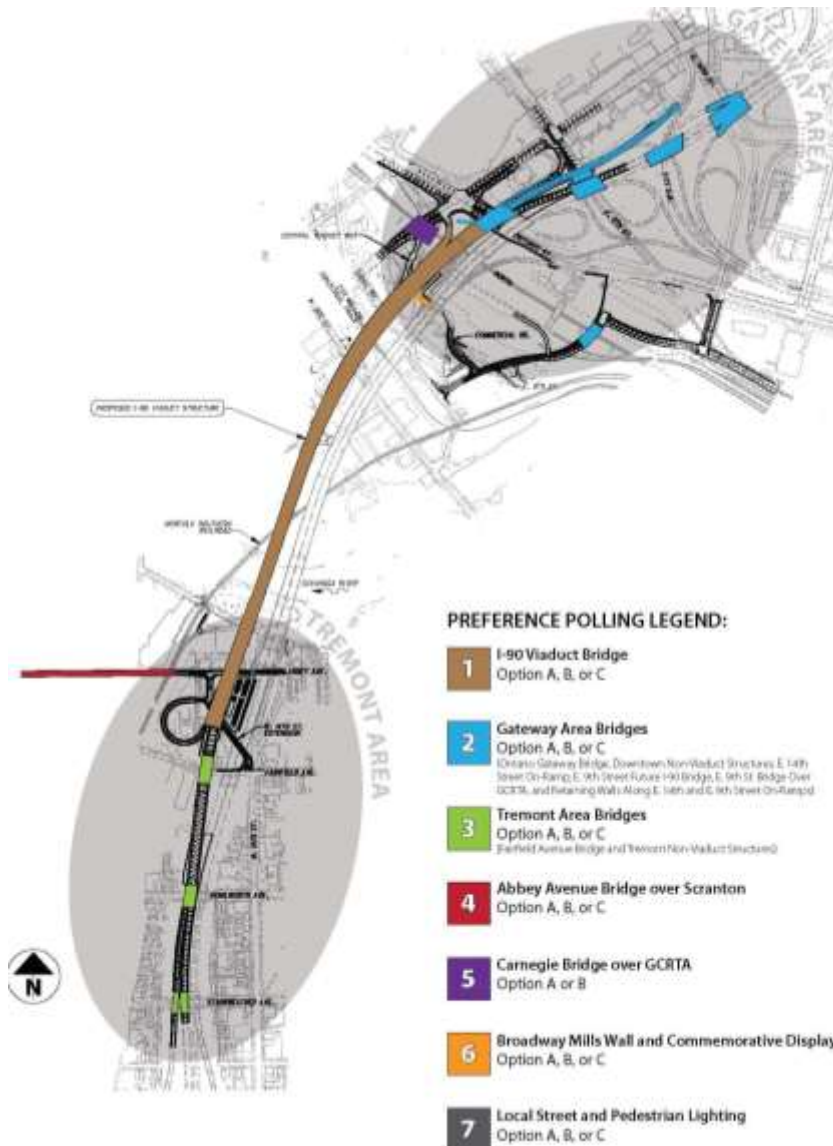

Preference Polling Results

Polling Results

- **Aesthetic Committee Meeting:** 11.30.10
 - 17 responses
 - 4 who live/work in Tremont neighborhood
- **Preliminary On-line Polling:** 12.15.10
 - 503 - 567 responses (depending on question)
 - 104 who live/work in Tremont
- **Public Meeting** 12.15.10:
 - 13- 20 responses (depending on question)
 - 10 who live/work in Tremont neighborhood

Polling Stations

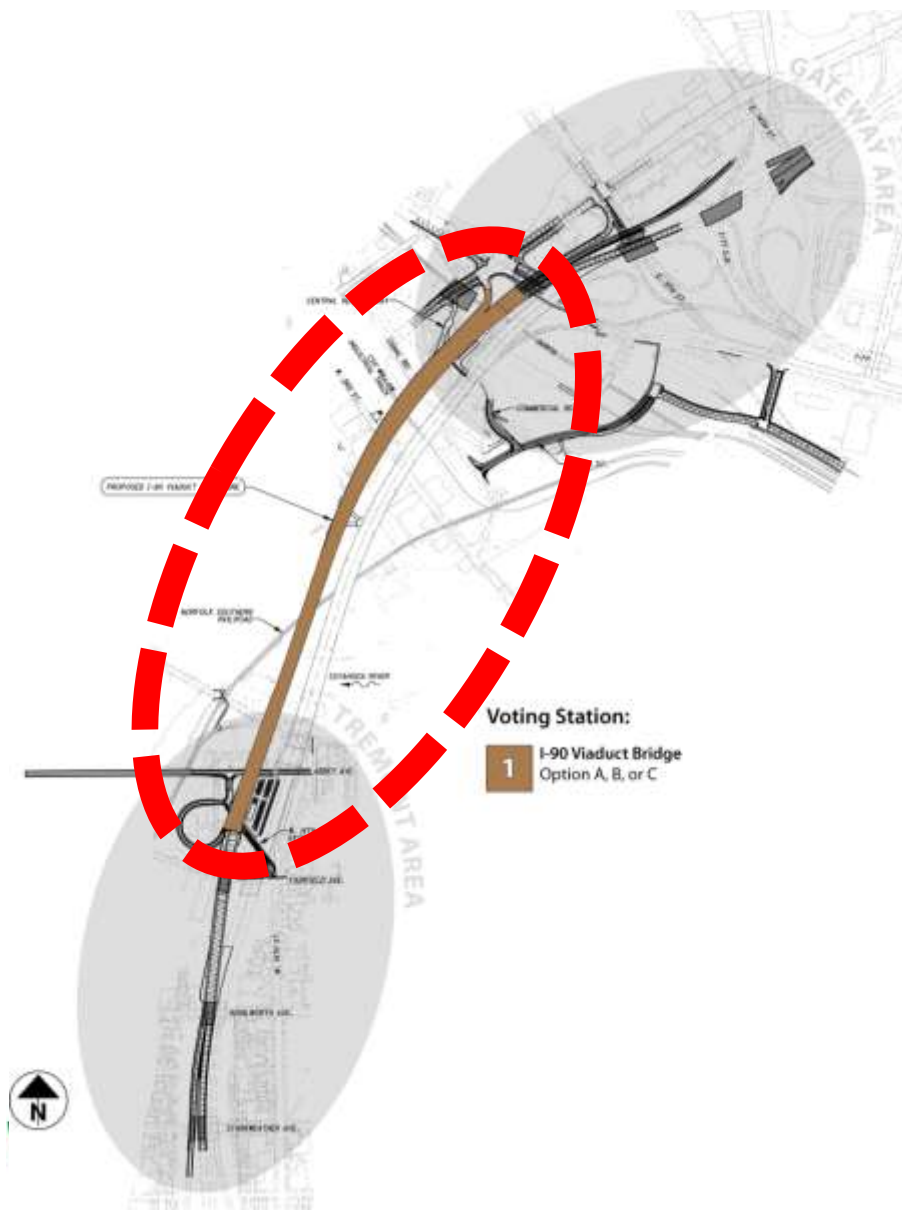

Station 1 Viaduct Bridge

Polling Questions:

- Select option for pier shapes and colors
- Select option for architectural lighting approach

Bridge Piers and Colors

Preference Polling Results

STATION 1: VIADUCT BRIDGE

	PIER SHAPES AND COLORS			COMMENT SUMMARY
AESTHETIC COMMITTEE MEETINGS Polling Results	OPTION A 47% 	OPTION B 29%	OPTION C 24%	<ul style="list-style-type: none">Desire for better options to transition girder to piers (pick up delta and/or girder placement on piers)
ONLINE VOTING Polling Results	OPTION A 37% 	OPTION B 35%	OPTION C 28%	
PUBLIC MEETING Polling Results	OPTION A 53% 	OPTION B 32%	OPTION C 16%	

Bridge Piers and Colors: Updated with Comments

Preference Polling Station 1 I-90 VIADUCT BRIDGE MAIN SPAN & APPROACH SPANS

OPTION A-3



I-90 VIADUCT BRIDGE - VIEW (1) LOOKING NORTH (DAY)



LOCATION MAP



I-90 VIADUCT BRIDGE - ELEVATION



MAIN SPAN PIER SIDE ELEVATION (PIERS 3-11)

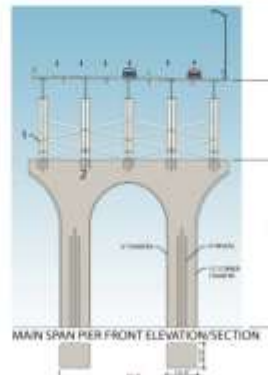

MAIN SPAN PIER FRONT ELEVATION/SECTION



APPROACH PIER FRONT ELEVATION/SECTION (PIERS 1-2 & 12-14)

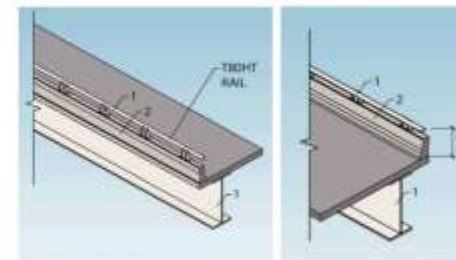

TRAFFIC RAIL ISOMETRIC

Architectural Lighting Approach

Preference Polling Results

STATION 1: VIADUCT BRIDGE

AESTHETIC
COMMITTEE
MEETINGS
Polling Results

ARCHITECTURAL LIGHTING APPROACH

OPTION A

59%

OPTION B

29%

OPTION C

12%

COMMENT SUMMARY

- Changing light on girders has 256+ color options
- Control panel (at electrical service point) could be programmed to "roll" any combination of colors.

ONLINE
VOTING
Polling Results

ARCHITECTURAL LIGHTING APPROACH

OPTION A

55%

OPTION B

17%

OPTION C

28%

COMMENT SUMMARY

PUBLIC
MEETING
Polling Results

ARCHITECTURAL LIGHTING APPROACH

OPTION A

67%

OPTION B

11%

OPTION C

22%

COMMENT SUMMARY

Architectural Lighting Approach

OPTION A

I-90 VIADUCT BRIDGE - VIEW LOOKING NORTH (NIGHT)

NOTE: PIER OPTION A SHOWN FOR REFERENCE ONLY. PREFERRED PIER OPTION WILL BE MATCHED WITH PREFERRED AESTHETIC LIGHTING OPTION.



Polling Stations

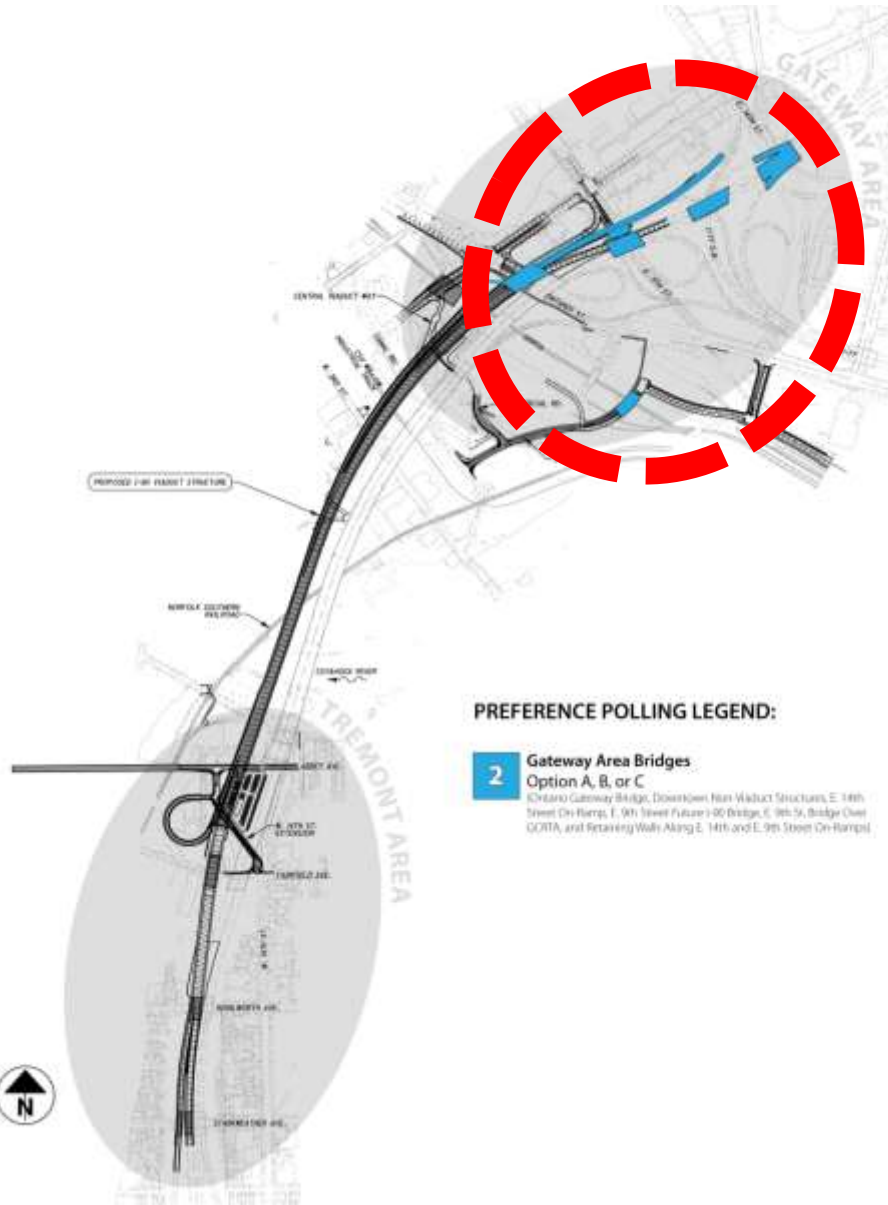

Station 2 Gateway (Downtown) Area Bridges









Polling Questions:

- Select option for bridges and walls
- Selection option for East 9th Street railing

Gateway Area Bridges

Preference Polling Results

STATION 2: GATEWAY (DOWNTOWN) AREA BRIDGES

	BRIDGES AND WALLS	COMMENT SUMMARY						
AESTHETIC COMMITTEE MEETINGS Polling Results	<table border="1"><thead><tr><th>OPTION A</th><th>OPTION B</th><th>OPTION C</th></tr></thead><tbody><tr><td>94% </td><td>0%</td><td>6%</td></tr></tbody></table>	OPTION A	OPTION B	OPTION C	94% 	0%	6%	
OPTION A	OPTION B	OPTION C						
94% 	0%	6%						
ONLINE VOTING Polling Results	<table border="1"><thead><tr><th>OPTION A</th><th>OPTION B</th><th>OPTION C</th></tr></thead><tbody><tr><td>64% </td><td>18%</td><td>18%</td></tr></tbody></table>	OPTION A	OPTION B	OPTION C	64% 	18%	18%	
OPTION A	OPTION B	OPTION C						
64% 	18%	18%						
PUBLIC MEETING Polling Results	<table border="1"><thead><tr><th>OPTION A</th><th>OPTION B</th><th>OPTION C</th></tr></thead><tbody><tr><td>67% </td><td>22%</td><td>11%</td></tr></tbody></table>	OPTION A	OPTION B	OPTION C	67% 	22%	11%	
OPTION A	OPTION B	OPTION C						
67% 	22%	11%						

E 9th Street Railing

Preference Polling Results

STATION 2: GATEWAY (DOWNTOWN) AREA BRIDGES

	E 9TH STREET RAILING	COMMENT SUMMARY						
AESTHETIC COMMITTEE MEETINGS Polling Results	<table border="1"><thead><tr><th>OPTION A</th><th>OPTION B</th><th>OPTION C</th></tr></thead><tbody><tr><td>35%</td><td>47% ✓</td><td>18%</td></tr></tbody></table>	OPTION A	OPTION B	OPTION C	35%	47% ✓	18%	<ul style="list-style-type: none">Chain link railing desired to be upgraded like other ODOT chain link fences on bridgesInvestigate simplifying parapet/tube rail crash barrier
OPTION A	OPTION B	OPTION C						
35%	47% ✓	18%						
ONLINE VOTING Polling Results	<table border="1"><thead><tr><th>OPTION A</th><th>OPTION B</th><th>OPTION C</th></tr></thead><tbody><tr><td>30%</td><td>49% ✓</td><td>21%</td></tr></tbody></table>	OPTION A	OPTION B	OPTION C	30%	49% ✓	21%	
OPTION A	OPTION B	OPTION C						
30%	49% ✓	21%						
PUBLIC MEETING Polling Results	<table border="1"><thead><tr><th>OPTION A</th><th>OPTION B</th><th>OPTION C</th></tr></thead><tbody><tr><td>31%</td><td>56% ✓</td><td>13%</td></tr></tbody></table>	OPTION A	OPTION B	OPTION C	31%	56% ✓	13%	
OPTION A	OPTION B	OPTION C						
31%	56% ✓	13%						

E 9th Street Railing

Preferred Option B with railing inset

OPTION B

- 1. MEDICI IVORY SW# 7558
 - 2. MODERN GRAY SW# 7632
 - 3. BLACK
- COLOR PALETTE

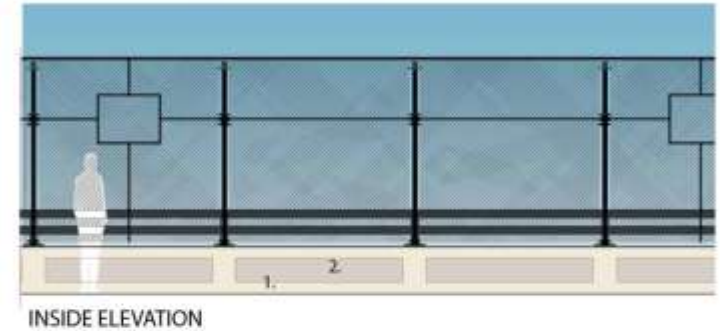
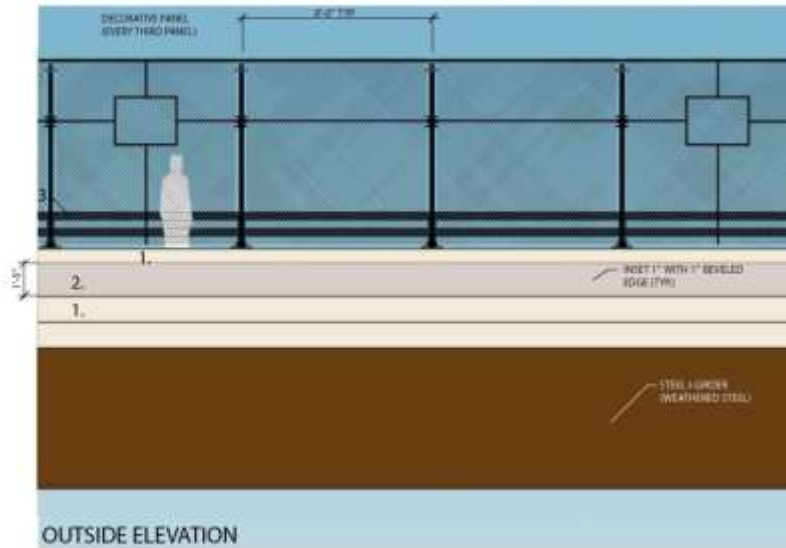

Polling Stations

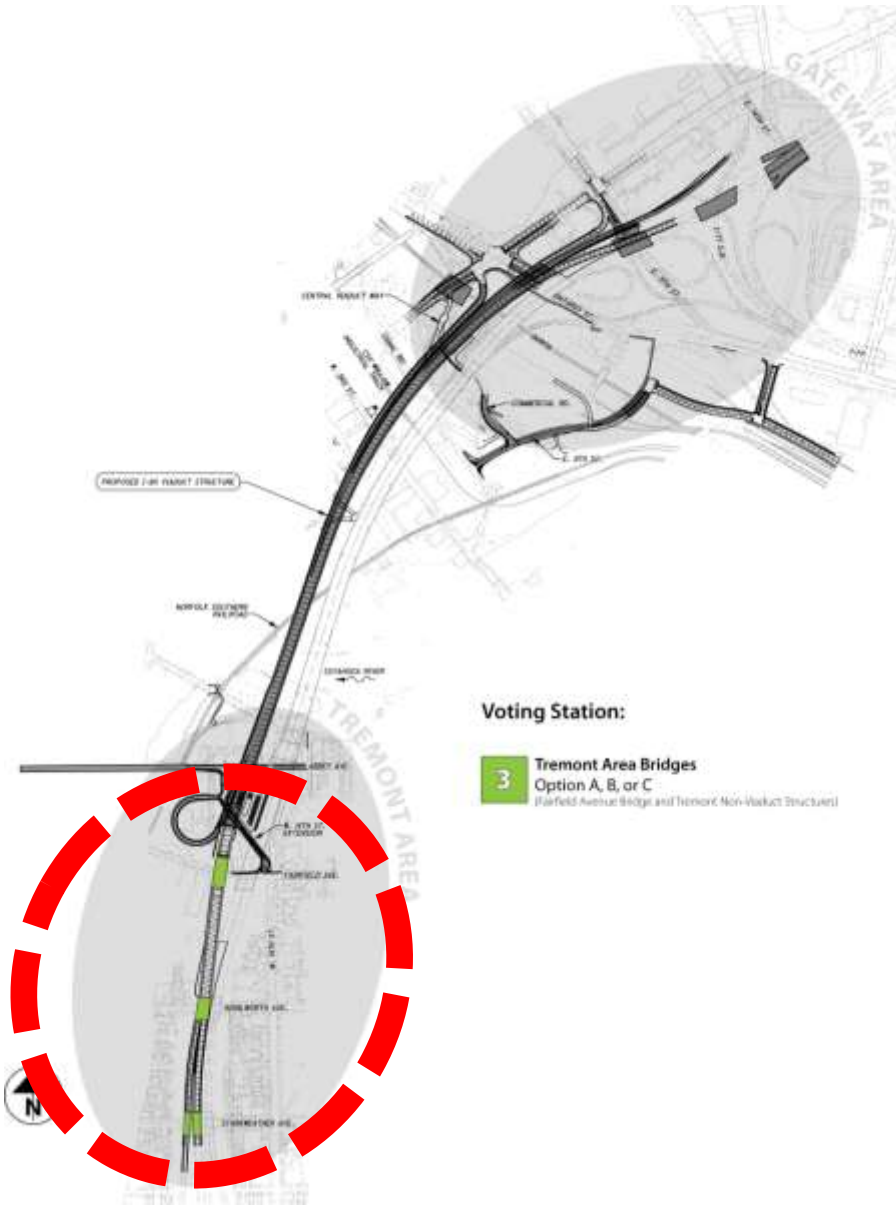

Station 3 Tremont Area Bridges

Polling Questions:

- Select option for bridges and walls
- Do you live/work in the Tremont neighborhood

Preference Polling Results

STATION 3: TREMONT AREA BRIDGES

<p>AESTHETIC COMMITTEE MEETINGS Polling Results</p>	<p>BRIDGES AND WALLS</p> <table border="1"> <tr> <td>OPTION A</td> <td>OPTION B</td> <td>OPTION C</td> </tr> <tr> <td>27%</td> <td>73%</td> <td>N/A</td> </tr> </table> <p>DO YOU LIVE / WORK IN THE TREMONT AREA?</p> <table border="1"> <tr> <td>YES</td> <td>NO</td> </tr> <tr> <td>33%</td> <td>67%</td> </tr> </table>	OPTION A	OPTION B	OPTION C	27%	73%	N/A	YES	NO	33%	67%	<p>COMMENT SUMMARY</p> <ul style="list-style-type: none"> Expand green wall program (both beneath overpass and outside the bridge) Question of art selection process Question whether artists can be paid <p>Tremont Live / Work Vote: Option A 25%; Option B 0%; Option C 0%; No Selection 75%</p>								
OPTION A	OPTION B	OPTION C																		
27%	73%	N/A																		
YES	NO																			
33%	67%																			
<p>ONLINE VOTING Polling Results</p>	<p>BRIDGES AND WALLS</p> <table border="1"> <tr> <td>OPTION A</td> <td>OPTION B</td> <td>OPTION C</td> </tr> <tr> <td>14%</td> <td>43%</td> <td>44%</td> </tr> </table> <p>DO YOU LIVE / WORK IN THE TREMONT AREA?</p> <table border="1"> <tr> <td>YES</td> <td>NO</td> </tr> <tr> <td>21%</td> <td>79%</td> </tr> </table>	OPTION A	OPTION B	OPTION C	14%	43%	44%	YES	NO	21%	79%	<p>COMMENT SUMMARY</p>  <table border="1"> <caption>Tremont Live / Work Votes</caption> <tr> <th>Option</th> <th>Percentage</th> </tr> <tr> <td>Option A</td> <td>14%</td> </tr> <tr> <td>Option B</td> <td>30%</td> </tr> <tr> <td>Option C</td> <td>56%</td> </tr> </table>	Option	Percentage	Option A	14%	Option B	30%	Option C	56%
OPTION A	OPTION B	OPTION C																		
14%	43%	44%																		
YES	NO																			
21%	79%																			
Option	Percentage																			
Option A	14%																			
Option B	30%																			
Option C	56%																			
<p>PUBLIC MEETING Polling Results</p>	<p>BRIDGES AND WALLS</p> <table border="1"> <tr> <td>OPTION A</td> <td>OPTION B</td> <td>OPTION C</td> </tr> <tr> <td>15%</td> <td>40%</td> <td>45%</td> </tr> </table> <p>DO YOU LIVE / WORK IN THE TREMONT AREA?</p> <table border="1"> <tr> <td>YES</td> <td>NO</td> </tr> <tr> <td>67%</td> <td>33%</td> </tr> </table>	OPTION A	OPTION B	OPTION C	15%	40%	45%	YES	NO	67%	33%	<p>COMMENT SUMMARY</p>								
OPTION A	OPTION B	OPTION C																		
15%	40%	45%																		
YES	NO																			
67%	33%																			

Tremont Area Bridges

Preference Polling Station 3

OPTION C

TREMONT AREA BRIDGES FAIRFIELD AVE. BRIDGE & TREMONT NON-VIADUCT STRUCTURES

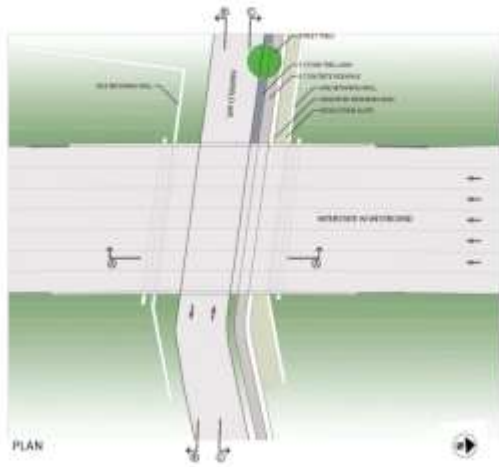

*NOTE: FAIRFIELD SELECTION FOR TRAFFIC RAIL AND BEAM COLOR WILL APPLY TO THE TRAFFIC RAIL AND BEAM COLOR FOR KENLWORTH AVE. AND STARKWEATHER AVE. BRIDGES. ALL EXISTING PERS AND WALLS AT THE KENLWORTH AVE. AND STARKWEATHER AVE. BRIDGES WILL REMAIN.

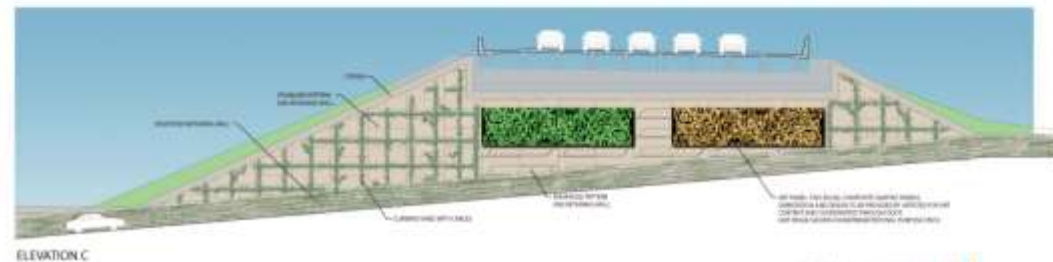
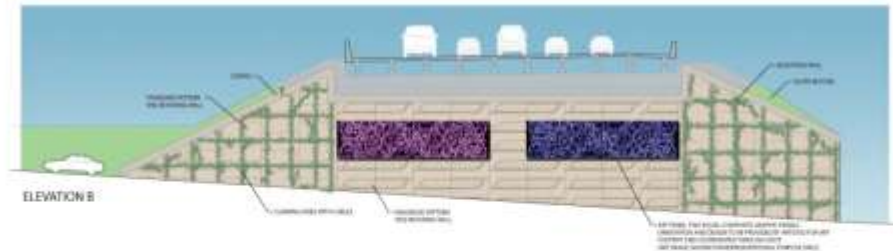
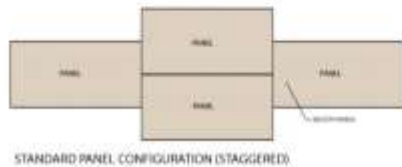
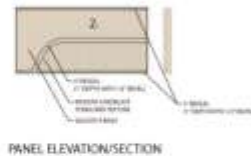

Polling Stations

Station 4 Abbey Avenue Bridge over Scranton

Polling Question:

- Select option for parapet and column style

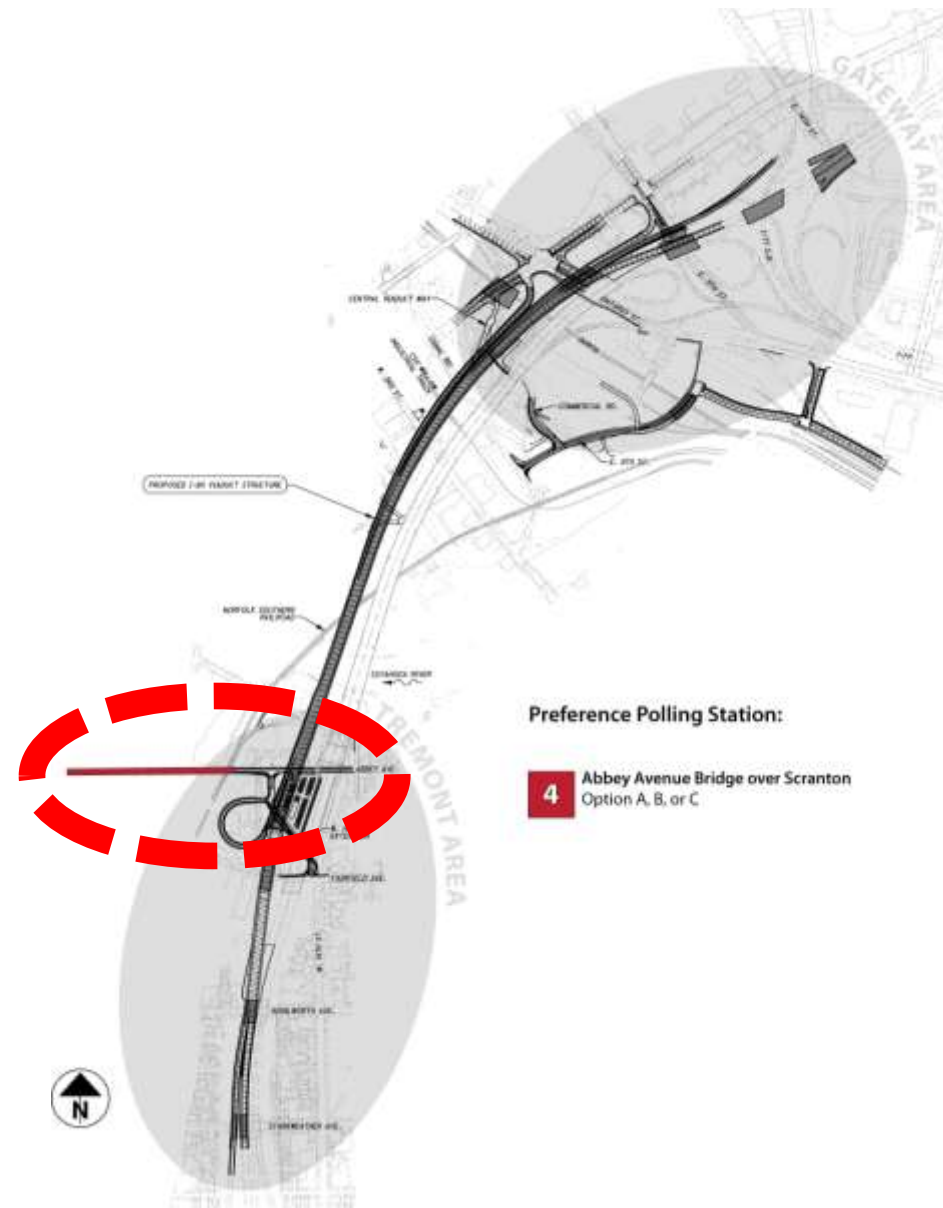

Abbey Ave Bridge over Scranton

Preference Polling Results

STATION 4: ABBEY AVENUE BRIDGE OVER SCRANTON

AESTHETIC COMMITTEE MEETINGS
Polling Results

PARAPET AND COLUMN STYLE

OPTION A

83%

OPTION B

17%

OPTION C

0%

COMMENT SUMMARY

- Match RTA Bridge

ONLINE VOTING
Polling Results

PARAPET AND COLUMN STYLE

OPTION A

28%

OPTION B

44%

OPTION C

28%

DO YOU LIVE / WORK IN THE TREMONT AREA?

YES

22%

NO

78%

COMMENT SUMMARY

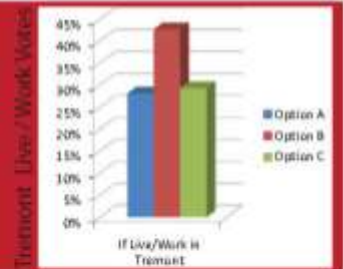

PUBLIC MEETING
Polling Results

PARAPET AND COLUMN STYLE

OPTION A

32%

OPTION B

58%

OPTION C

11%

DO YOU LIVE / WORK IN THE TREMONT AREA?

YES

69%

NO

31%

COMMENT SUMMARY

Abbey Ave Bridge over Scranton

Preference Polling Station 4 **4** **OPTION B** ABBEY AVENUE BRIDGE OVER SCRANTON

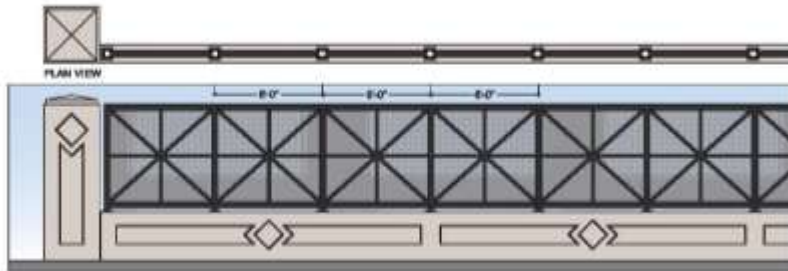

ELEVATION - DECORATIVE RAILING/VANDAL PROTECTIVE FENCE & PARAPET



PERSPECTIVE - ABBEY AVE.

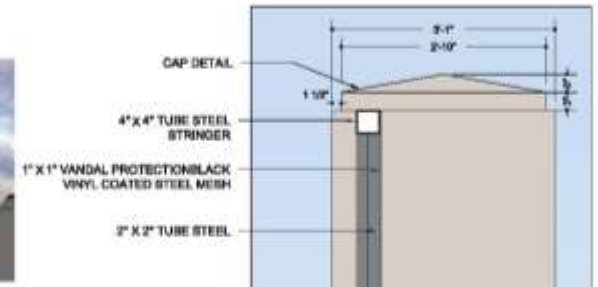

DECORATIVE RAILING - PHOTO FROM ABBEY AVENUE OVER GCRTA

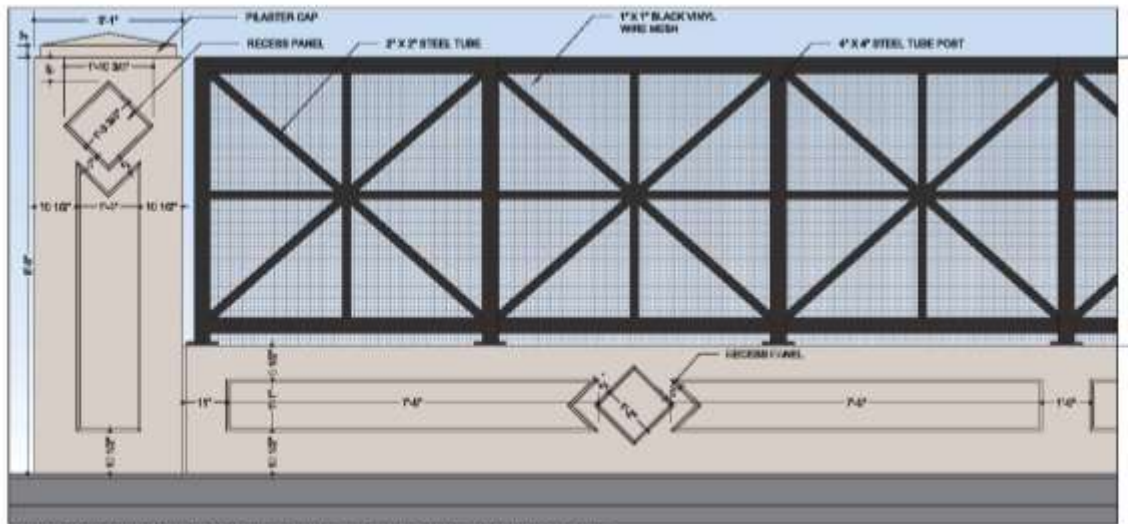

ENLARGED ELEVATION - DECORATIVE RAILING/VANDAL PROTECTIVE FENCE & PARAPET

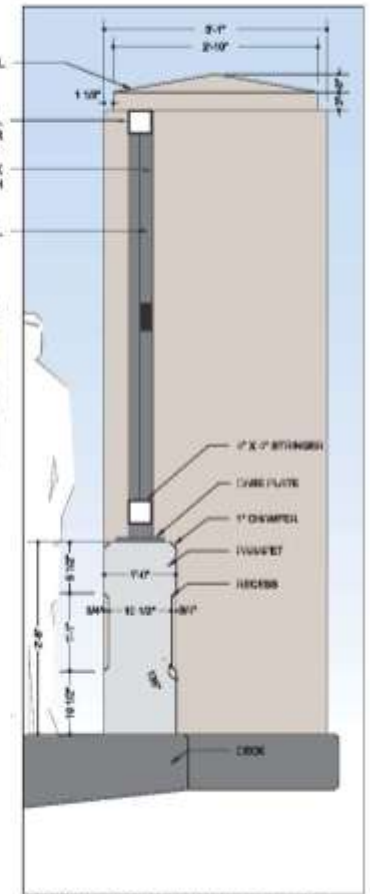

SECTION - DECORATIVE RAILING & PARAPET

Polling Stations

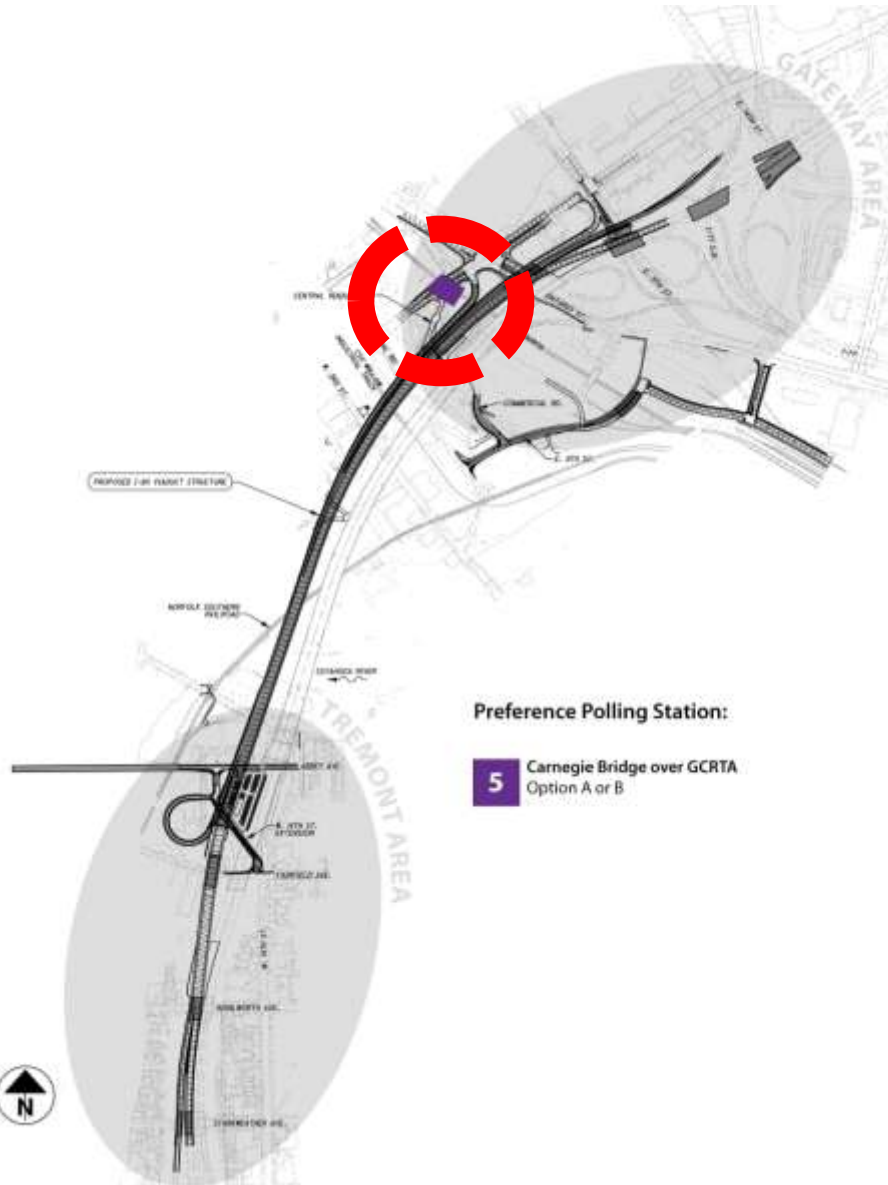

Station 5 Carnegie Bridge over GCRTA

Polling Question:

- Select option for fence style

Carnegie Bridge over GCRTA

Preference Polling Results

STATION 5: CARNEGIE AVE. BRIDGE OVER GCRTA

	FENCING OPTION	COMMENT SUMMARY				
AESTHETIC COMMITTEE MEETINGS Polling Results	<table border="1"><thead><tr><th>OPTION A</th><th>OPTION B</th></tr></thead><tbody><tr><td>29%</td><td>71% ✓</td></tr></tbody></table>	OPTION A	OPTION B	29%	71% ✓	<ul style="list-style-type: none">Match Abbey Avenue
OPTION A	OPTION B					
29%	71% ✓					
ONLINE VOTING Polling Results	<table border="1"><thead><tr><th>OPTION A</th><th>OPTION B</th></tr></thead><tbody><tr><td>25%</td><td>75% ✓</td></tr></tbody></table>	OPTION A	OPTION B	25%	75% ✓	
OPTION A	OPTION B					
25%	75% ✓					
PUBLIC MEETING Polling Results	<table border="1"><thead><tr><th>OPTION A</th><th>OPTION B</th></tr></thead><tbody><tr><td>10%</td><td>90% ✓</td></tr></tbody></table>	OPTION A	OPTION B	10%	90% ✓	
OPTION A	OPTION B					
10%	90% ✓					

Carnegie Bridge over GCRTA

Preference Polling Station 5 **CARNEGIE AVE. BRIDGE OVER GCRTA FENCING OPTIONS** OPTION B

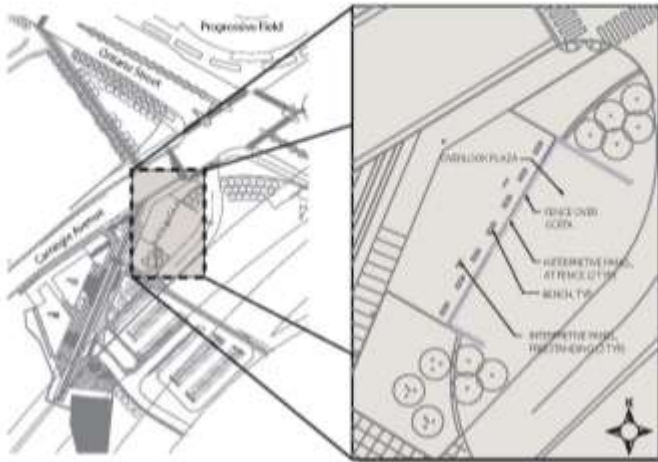

AREA KEY MAP

PLAN ENLARGEMENT

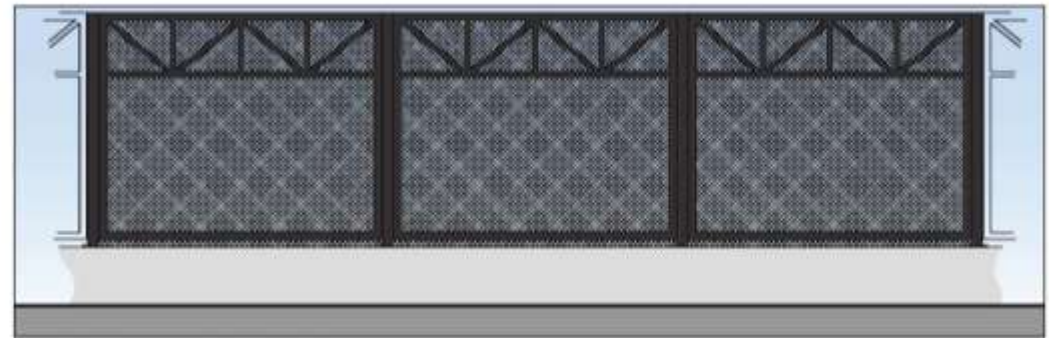

ELEVATION SHOWING MULTIPLE FENCE PANELS



PRECEDENT PHOTOS



3 DIMENSIONAL SITE MAP

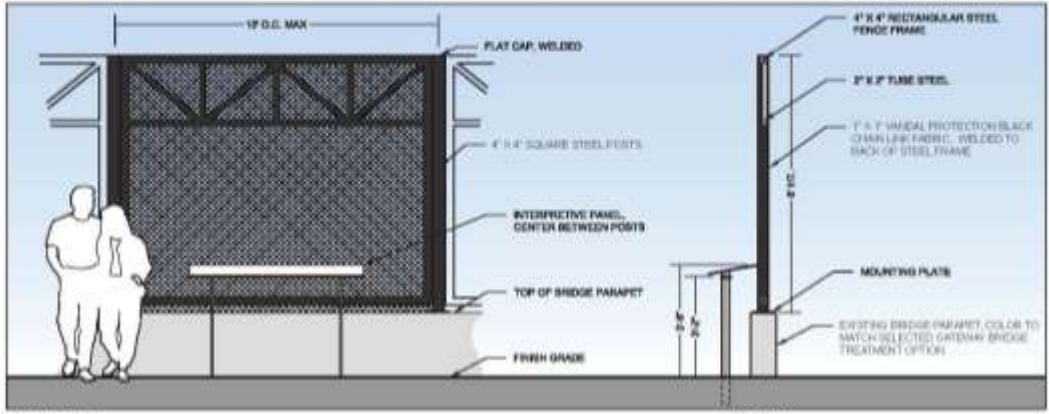

ELEVATION

SECTION

Polling Stations

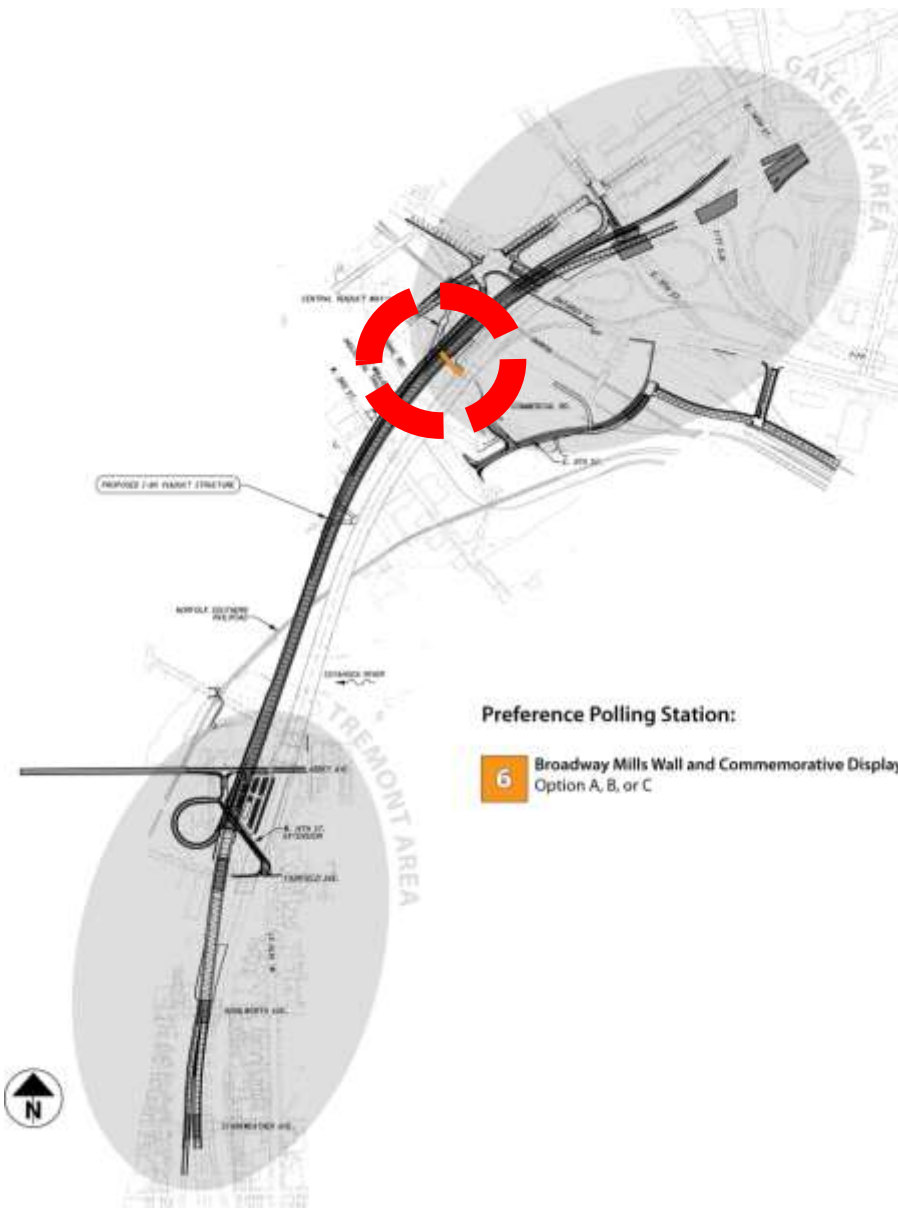

Preference Polling Station:

- 6 Broadway Mills Wall and Commemorative Display
Option A, B, or C

Station 6 Broadway Mills Wall

Polling Question:

- Select option for wall style

Broadway Mills Wall/Display

Preference Polling Results

STATION 6: BROADWAY MILLS COMMEMORATIVE WALL

	COMMEMORATIVE WALL OPTION			COMMENT SUMMARY
AESTHETIC COMMITTEE MEETINGS Polling Results	OPTION A 43% ✓	OPTION B 36%	OPTION C 21%	<ul style="list-style-type: none">Interpretive panel should be incorporated into wall, not separated from wallDesire to see better contextual views of where wall display exists relative to piers
ONLINE VOTING Polling Results	OPTION A 30%	OPTION B 21%	OPTION C 49% ✓	
PUBLIC MEETING Polling Results	OPTION A 44% ✓	OPTION B 22%	OPTION C 33%	<ul style="list-style-type: none">At Downtown/Flats Design Review Committee and Plan Commission meetings concern expressed about Option C introducing metal material into wall display (viewed as being inappropriate to Broadway Mills Building)

Broadway Mills Wall/Display

Preference Polling Station 6 BROADWAY MILLS WALL & COMMEMORATIVE DISPLAY

OPTION A

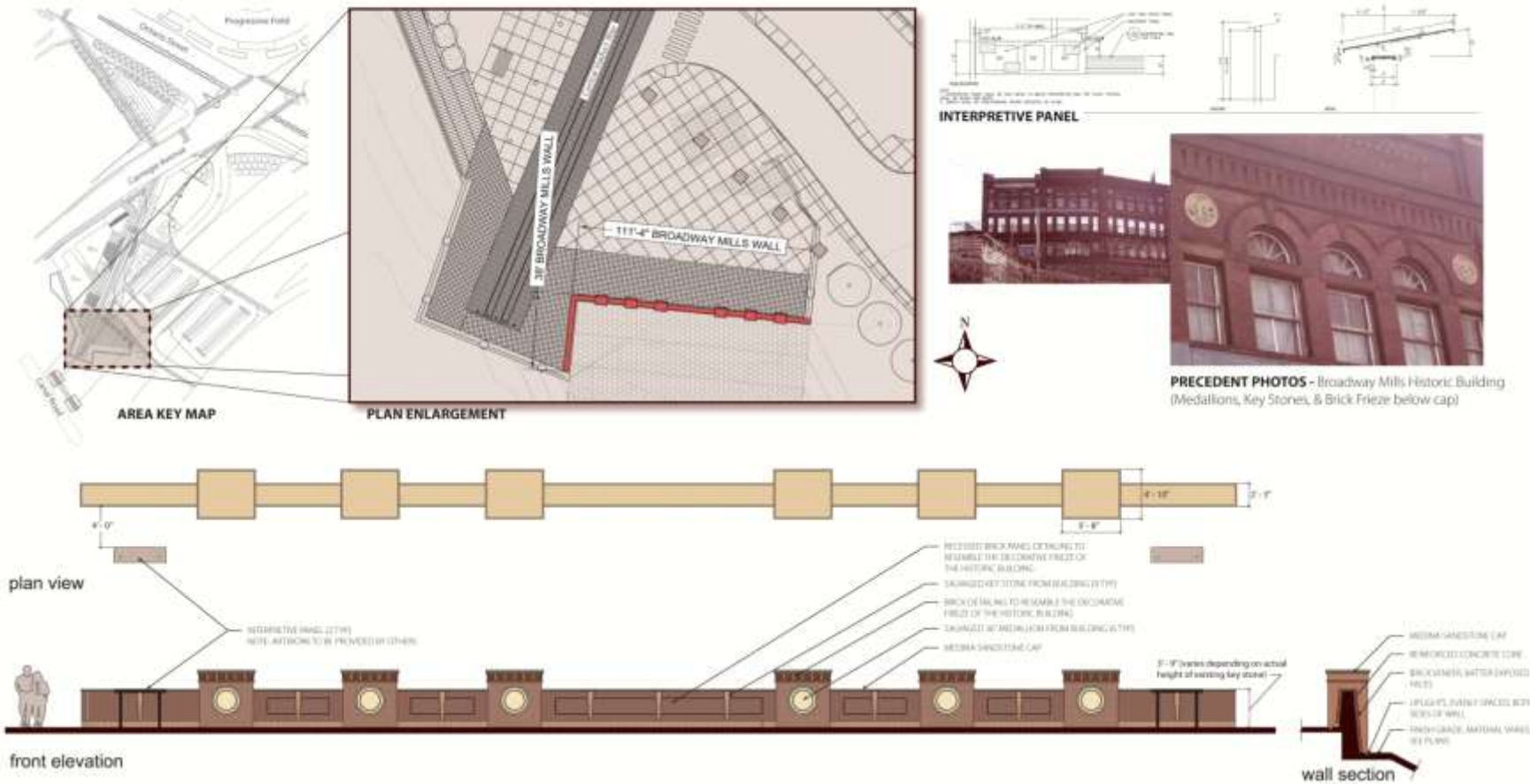

Polling Stations

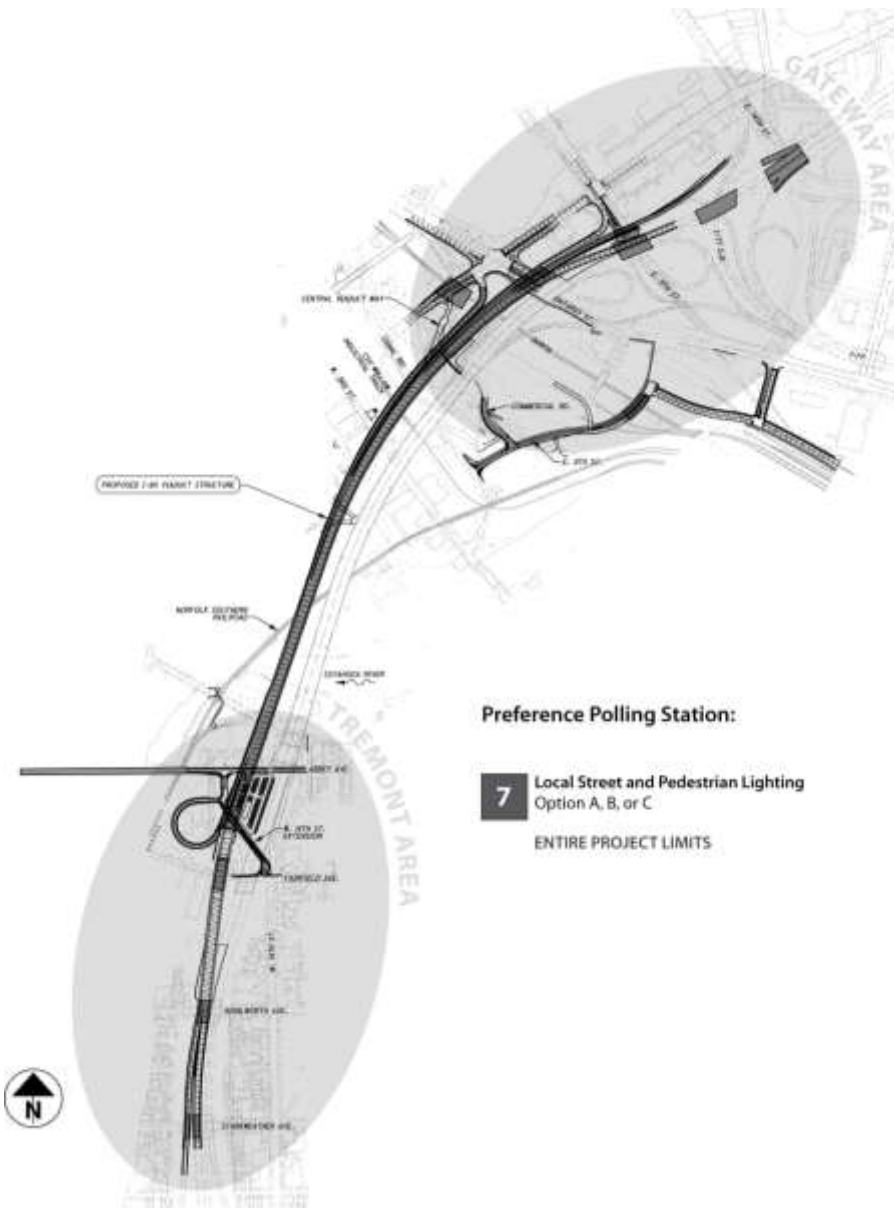

Station 7 Local Street and Pedestrian Lighting

Polling Question:

- Select option for lighting style

Local Street and Pedestrian Lighting

Preference Polling Results

STATION 7: LOCAL STREET & PEDESTRIAN LIGHTING

	LIGHTING STYLE			COMMENT SUMMARY
	OPTION A	OPTION B	OPTION C	
AESTHETIC COMMITTEE MEETINGS Polling Results	30%	60% ✓	10%	<ul style="list-style-type: none">Concern expressed about not integrating pedestrian lighting with "Historic Style" lighting in Gateway and Tremont areas
ONLINE VOTING Polling Results	25%	46% ✓	29%	
PUBLIC MEETING Polling Results	20%	47% ✓	33%	<ul style="list-style-type: none">Downtown/Flats Design review Committee and Plan Commission concurred with desire to duplicate "Historic Style" lighting in Gateway and Tremont - This is not one of ODOT specified lighting options

Local Street and Pedestrian Lighting: Originally Presented to the Public

OPTION **B**

MCGRAW-EDISON - TALON LIGHTING

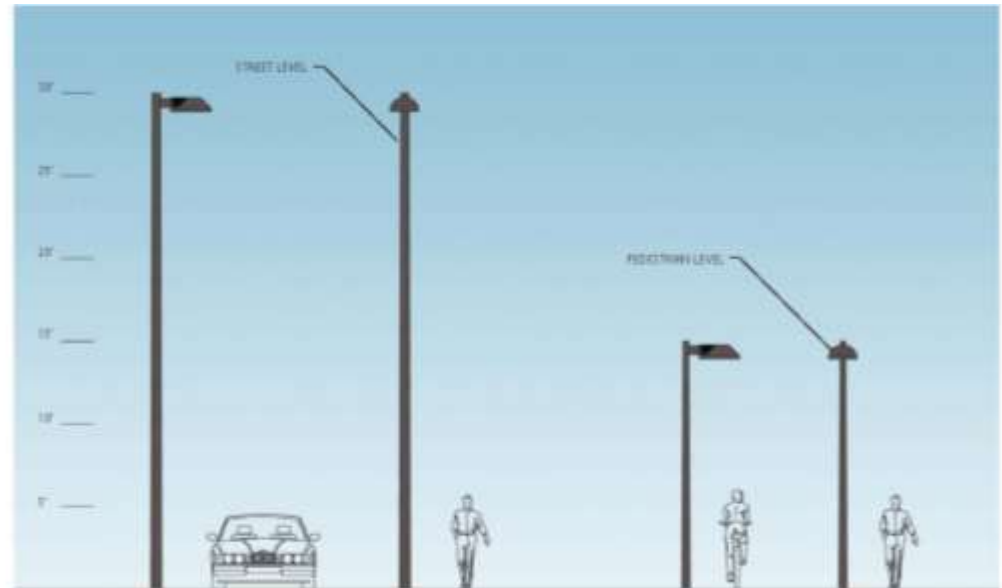
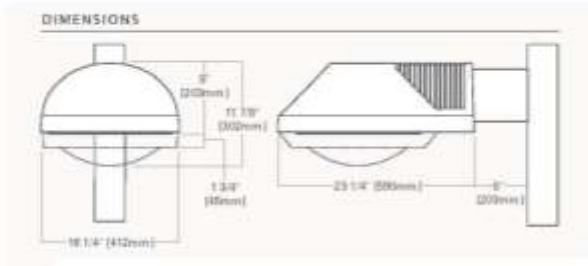

Pedestrian Lighting: To be used as Budget Allows



Gateway Lantern



Tremont Acorn Fixture