

DETOUR TO OTHER SIDE OF STREET

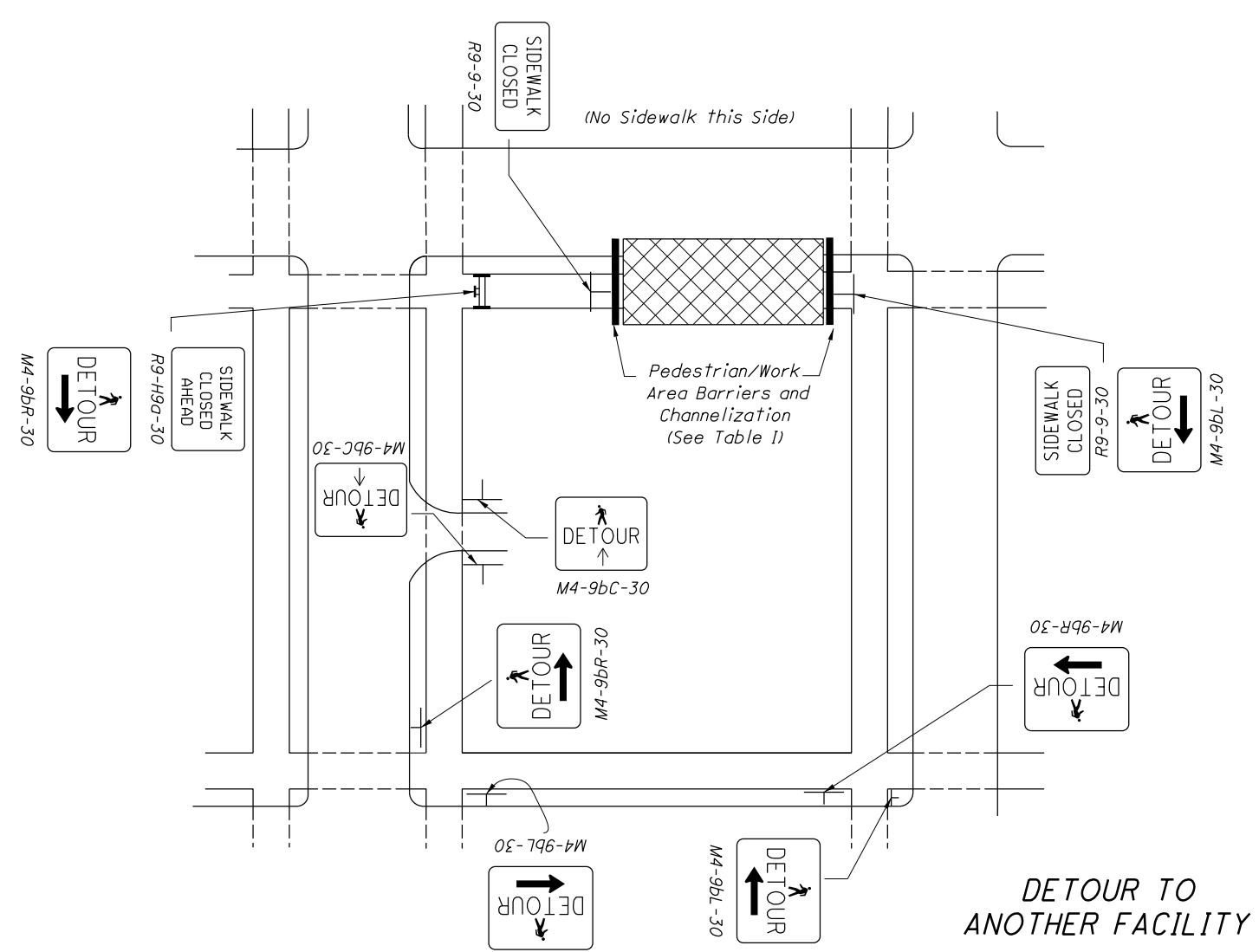

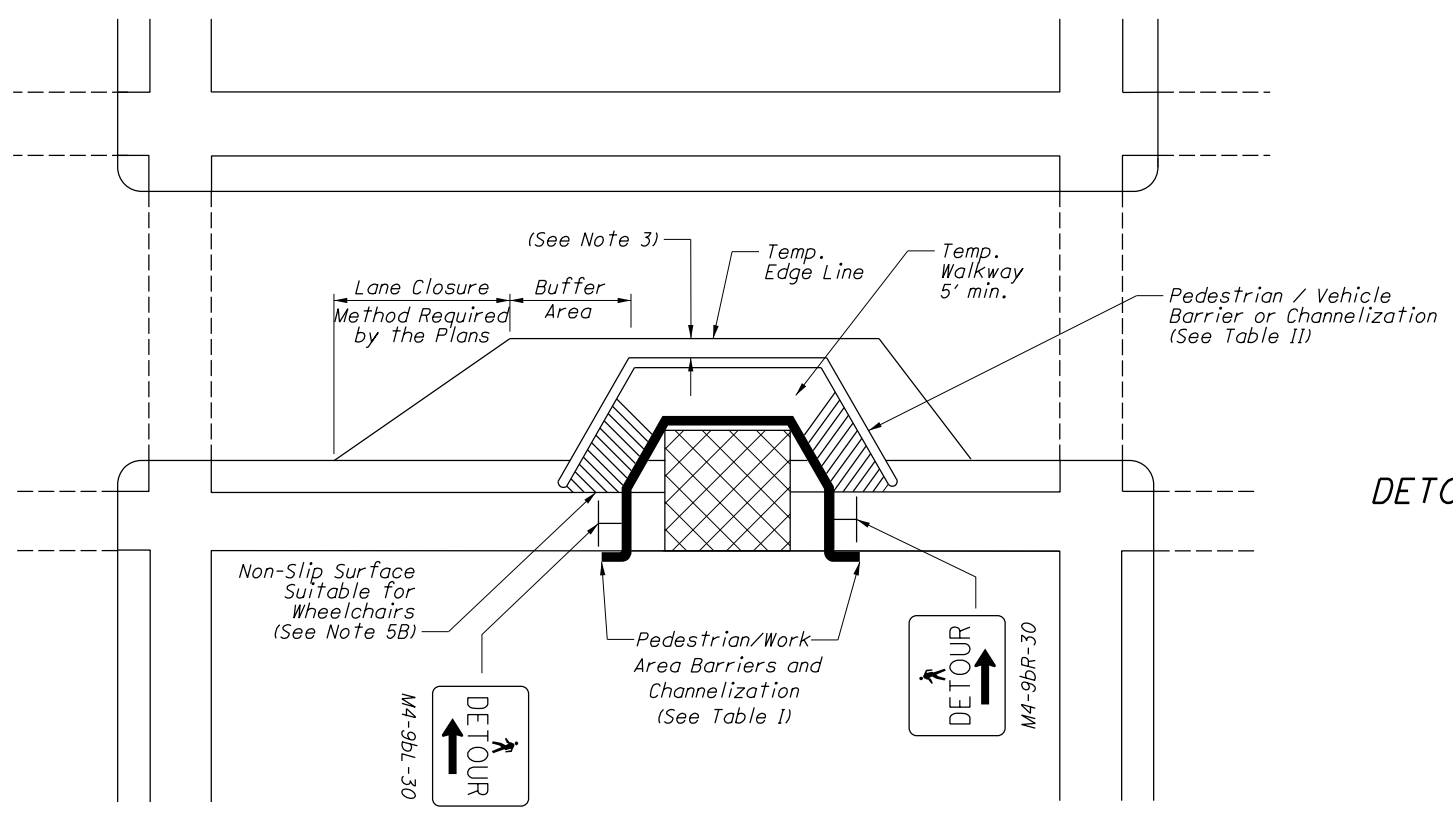

DETOUR TO ANOTHER FACILITY



DETOUR TO TEMPORARY WALKWAY ("RUNAROUND") ON ROADWAY

**LEGEND**

WORK AREA 

TYPE I BARRICADE WITH SIGN 

THIS DRAWING REPLACES MT-110.10 DATED 07-20-2012.

STANDARD ROADWAY CONSTRUCTION DRAWING

SCD NUMBER  
**MT-110.10**

**PEDESTRIAN DETOUR METHODS**

**OFFICE OF ROADWAY ENGINEERING**

STDS. ENGINEER  
Stargell

Michael Blaine

REVISION DATE  
07-19-2013

**NOTES:**

GENERAL

- 1A. This drawing presents traffic controls only for pedestrian traffic. Vehicular traffic control shall be provided as required.
- 1B. The purpose of the traffic control devices provided herein is to divert and guide pedestrians whose path would otherwise enter the work area. The Contractor must take additional precautions as appropriate to protect other pedestrians or residents (including children) from exposure to hazards resulting from construction operations.

SIGNS AND BARRICADES

- 2A. All signs and barricades shall be placed so that they do not cause a hazard for pedestrians. All signs, not on barricades or channelizing devices, near or over active sidewalks shall have a minimum 7' vertical clearance. Signs mounted on barricades or channelizing devices shall have a minimum 1' clearance above the sidewalk.
- 2B. Advance signing for sidewalk closure shall be mounted on Type I Barricade, placed such that they will not block more than one-half the sidewalk.

PAVEMENT MARKING

- 3. Maintain 2' minimum when possible, between the work zone edge line and the barrier or channelizing device separating the pedestrian path from the vehicle path.

STAGED WORK

- 4. For repair or reconstruction work involving sidewalks on both sides of the street, the work shall be staged so that one side is rebuilt before the other is disrupted.

TEMPORARY WALKWAYS

- 5A. Pedestrian walkways constructed by the Contractor shall be kept free of any obstructions or hazards including holes, debris and mud. Other walkways damaged or dirtied by the Contractor shall be immediately repaired or cleaned.
- 5B. For construction of temporary walkway the maximum grade shall be 5 percent unless specified otherwise in the plans. The maximum cross slope shall be 2 percent.

LIGHTING AND DELINEATION

- 6A. At night, in otherwise unlighted areas, pedestrian-channelizing devices and barricades and pedestrian detour signs shall be provided with lighting as follows:
  - a) Illumination shall provide a minimum of 1.2 foot-candles on temporary walkways.
  - b) Illumination shall be controlled by photocells.
  - c) Illumination fixtures may consist of floodlights or other protected fixtures mounted at least 10' above ground.
  - d) Illumination supports may be standard highway lighting poles, 4" x 4" wood posts or other supports approved by the Engineer.
- 6B. For barricades and channelizing devices located between the pedestrian way and the vehicle travel lane in unlighted areas, the devices shall be delineated or lighted at night as follows:
  - a) Delineation of the portable barrier (PB) located between the vehicle lane and the pedestrian path shall be by barrier reflectors on the vehicle side of the PB and by object markers as per Standard Construction Drawing (SCD) MT-101.70.

b) Channelizing devices other than PB shall be provided with Type C steady burning lights on the vehicle side of the channelizer.

CHANNELIZATION REQUIREMENTS

- 7A. All channelization devices used to separate pedestrians from the work area or from the vehicular lane shall be as determined from the adjacent tables.
- 7B. Wood railing shall be a min. of a 2" x 4" rail at 32" above ground. It shall be secured to 2" x 4" posts at not more than 6' spacing with secure attachment hardware. It shall be installed and braced to be essentially rigid and able to support the following loads:
  - a) A horizontal transverse load of 100 pounds at each post top.
  - b) A vertical load of 250 pounds at midpoint between each post.
- 7C. Wood snow fence shall be nominally 42" high, securely supported by wood or steel posts at 6' maximum spacing. Plastic/nylon construction fence shall be bright orange. It shall be securely fastened to wood or metal posts at not more than 6' spacing. It shall be nominally 42" high and the top edge shall not sag below 30" (12" max. sag). Either of the fence sections with extensive broken slots or holes greater than 12" x 12" shall be repaired or replaced.
- 7D. Chain link fence, Type CLT shall conform to CMS 607 and appropriate details on Roadway Standard Construction Drawings F-1.1, F-3.1 and F-3.2, except that materials need not be new nor shall certification and tests be required.
- 7E. Plywood walls shall be a minimum of 5/8" exterior plywood, supported by a 2" x 4" or heavier framing securely anchored and buttressed to resist wind load and/or persons. They shall be designed for a minimum wind loading of 30 pounds per square foot (or larger if local codes require). Height of the wall shall be not less than 7' above the walkway and if within range of thrown objects, shall be of sufficient height to screen pedestrians and passing cars.
- 7F. When PB is provided, it shall be 32" PB as per CMS 622. Delineation of PB shall be as per SCD MT-101.70.
- 7G. Barrier located along a "runaround" within the roadway pavement shall meet the following requirements:
  - a) Be a minimum of 36" in height and continuous with the ground surface.
  - b) Extend along the entire length of the runaround.
  - c) Have no breaks or gaps along the full length of the barrier.
  - d) Have a solid, continuous bottom rail between 4" and 12" in height.
  - e) Be of high contrast color and material.
  - f) Provide temporary ramps and boardwalks as required to ensure a smooth and continuous surface that complies with Americans with Disabilities Act Accessibility Guidelines.

**BARRIER AND CHANNELIZING DEVICE SELECTION TABLES**

**TABLE I - CHANNELIZATION TYPE WHEN USED BETWEEN THE PEDESTRIAN WALKWAY AND THE WORK AREA**

DISTANCE FROM WORK ACTIVITY TO CHANNELIZATION	WORK CHARACTERISTICS *					
	< 2 FT DROPOFF	2 - 5 FT DROPOFF	> 5 FT DROPOFF	DIRT/MUD SPLASHED	EQUIPMENT WHICH MOVES OR HAS EXPOSED MOVING PARTS	OPERATION WHICH THROWS STONE/ETC.
< 5 ft.	A-E	B-E	C-D	D	D-E	D
5 - 10 ft.	A-E	B-E	B-E	D	B-E	D
> 10 - 30 ft.	A-E	A-E	B-E	N/A	A-E	D
> 30 ft.	N/A	A-E	B-E	N/A	A-E	D

\* These requirements shall not apply to paving, grinding or other similar operations.

**TABLE II - CHANNELIZATION TYPE WHEN USED BETWEEN THE PEDESTRIAN WALKWAY AND THE VEHICULAR LANE**

DISTANCE FROM EDGE OF TRAFFIC LANE TO FACE OF CHANNELIZATION	SPEED LIMIT (MPH)		
	25	30 - 40	> 40
0 - 2 ft.	E	E	E
> 2-6 ft.	B-E	E	E
> 6 ft.	B-E	B-E	E

SELECTION LIST

- A. Wood Railing
- B. Snow Fence, Wood or Orange Plastic Construction Fence.
- C. Chain Link Fence, Type CLT
- D. Plywood Wall
- E. Portable Barrier