

ELEVATION VIEW

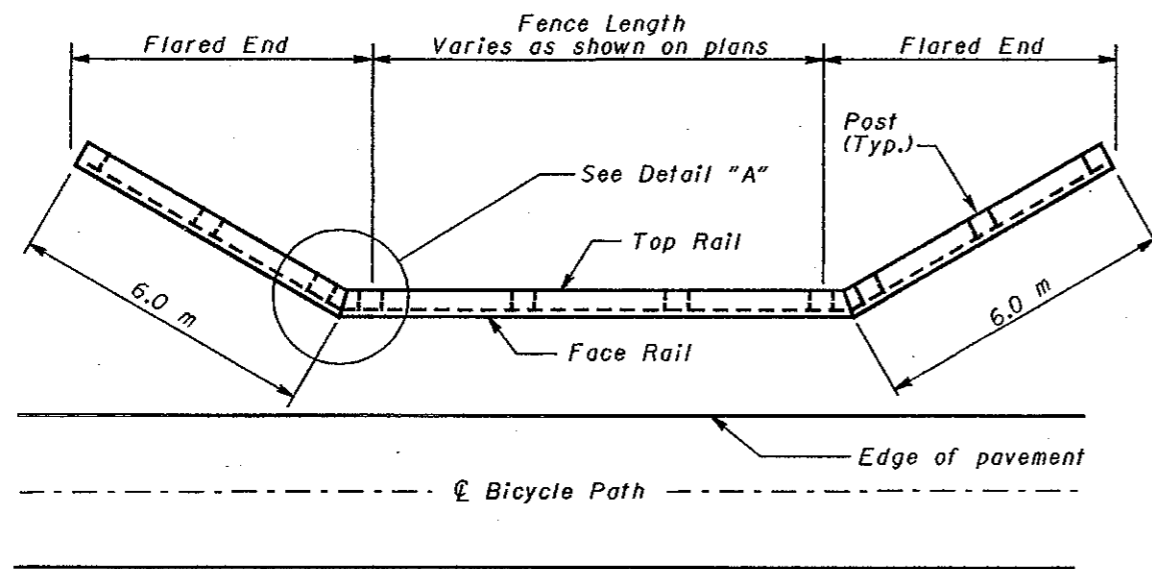

PLAN VIEW

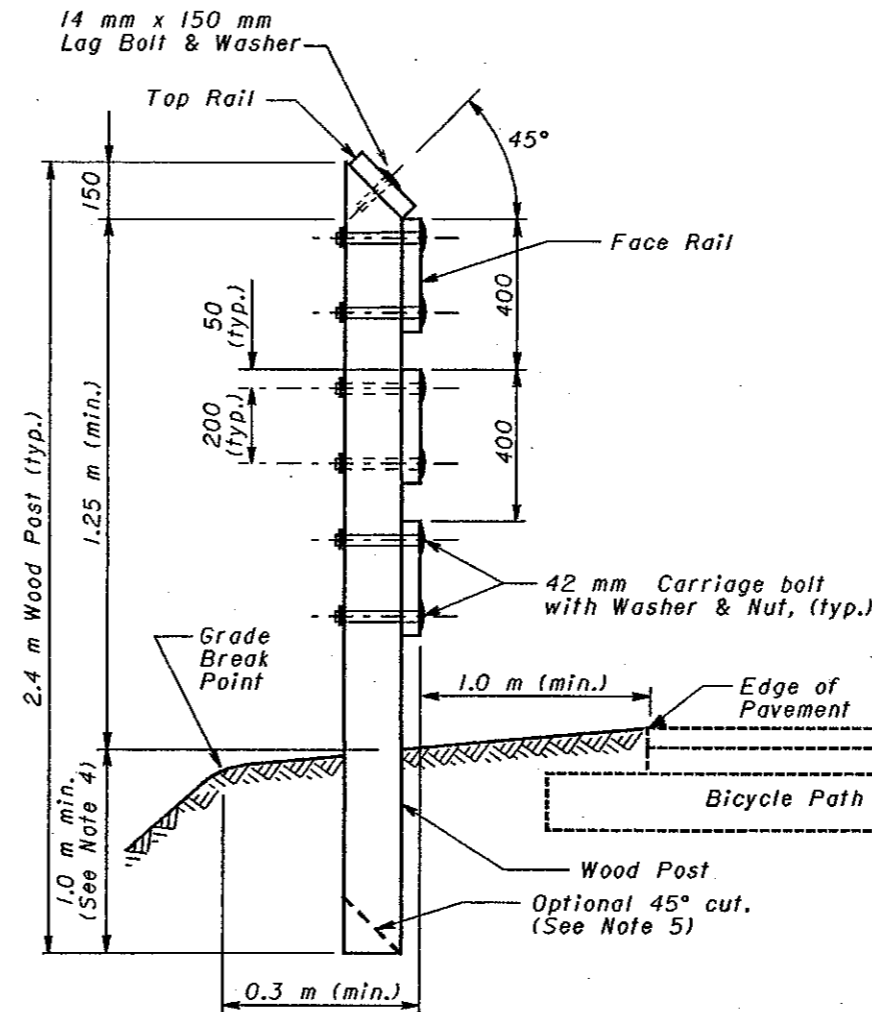

SECTION A-A

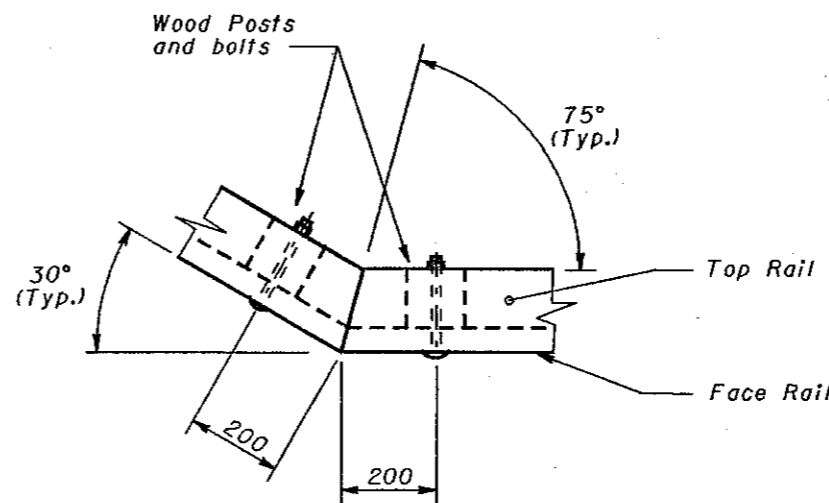

Lag Bolts in Top Rail are not shown for clarity.

DETAIL "A"

NOTES

- 1) All wood members shall be CCA treated as per CMS 712.06.
- 2) All bolts, washers, and nuts shall be galvanized as per CMS 711.02 and 711.10. Counterbore face of rails to provide flush bolt heads.
- 3) Railing shall be of a wood that is smooth and splinter free.
- 4) Where less than 0.3 m of graded shoulder width (10:1 or flatter) extends beyond the edge of the face rail, longer posts shall be used so that a minimum 1.5 m embedment depth is provided.
- 5) The bottom end of the 150 mm x 150 mm posts may be cut to a 45° point.
- 6) Butting of the ends of the top rail and the middle face rail shall be staggered (on alternate posts) with butting ends of the upper and lower face rails. All butt end joints shall be centered on the posts.
- 7) The cost of furnishing and placing all posts, rails, and hardware shall be included in the unit price bid for Item 607, Fence, Misc.; Wood Fence

All dimensions are in millimeters unless otherwise noted.



OFFICE OF ROADWAY ENGINEERING
OHIO DEPARTMENT OF TRANSPORTATION

BIKEWAY RAILING

DATE
4-1-96

STANDARD CONSTRUCTION DRAWING
RM-5.2M

APPROVED *R.K. Hulman, P.E.*
ADMINISTRATOR

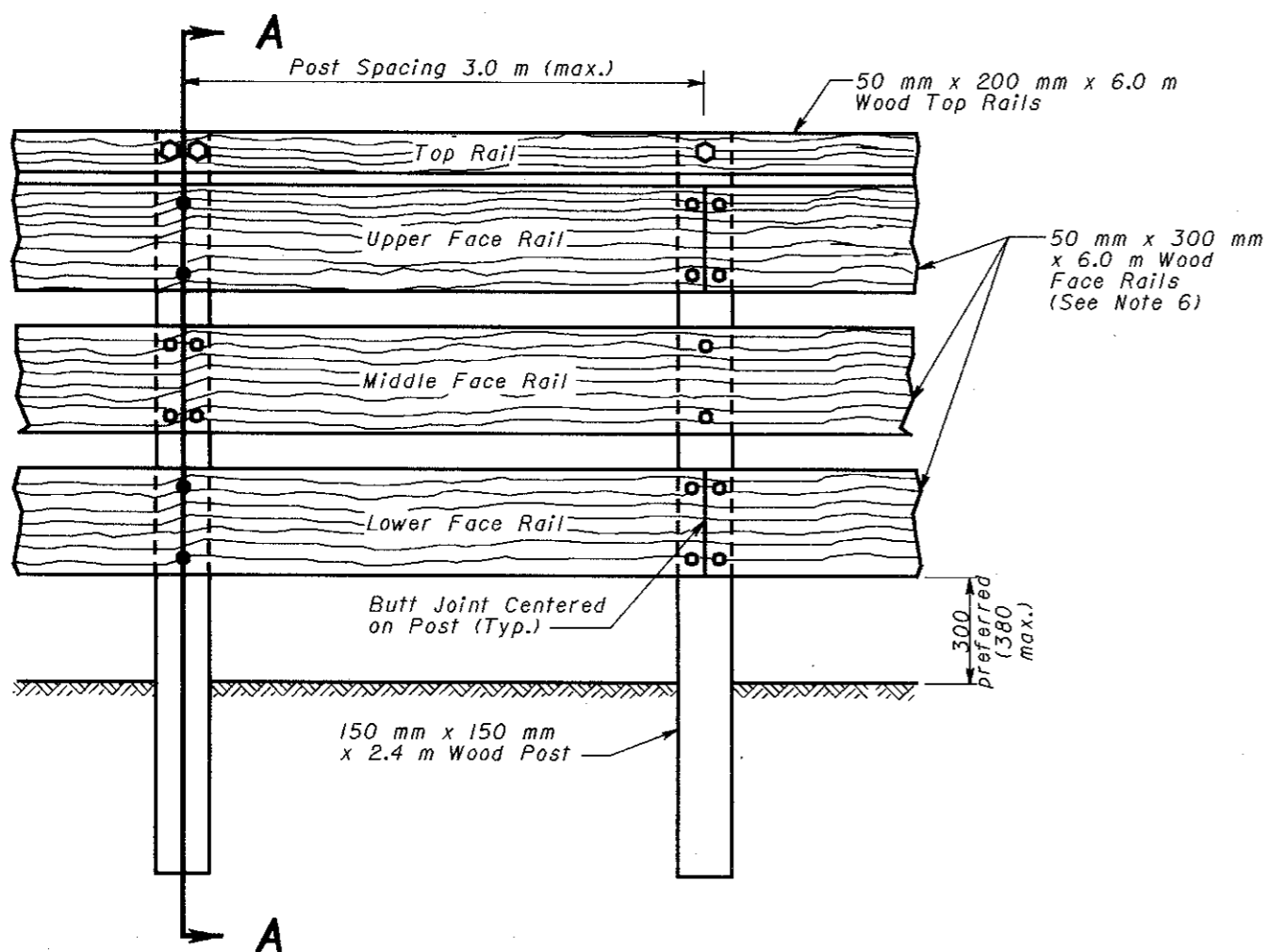

ELEVATION VIEW

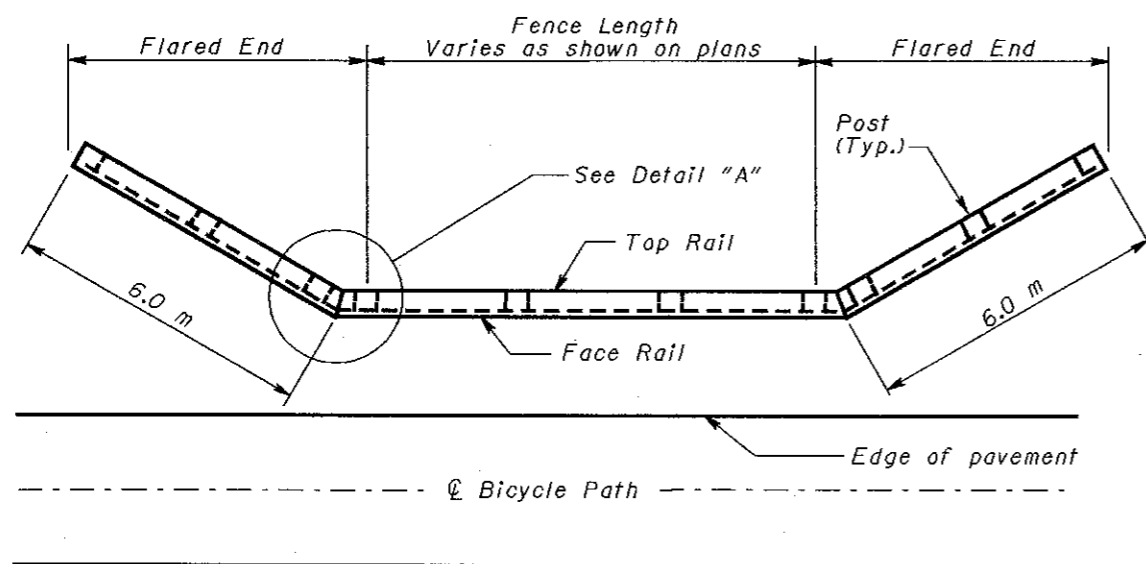

PLAN VIEW

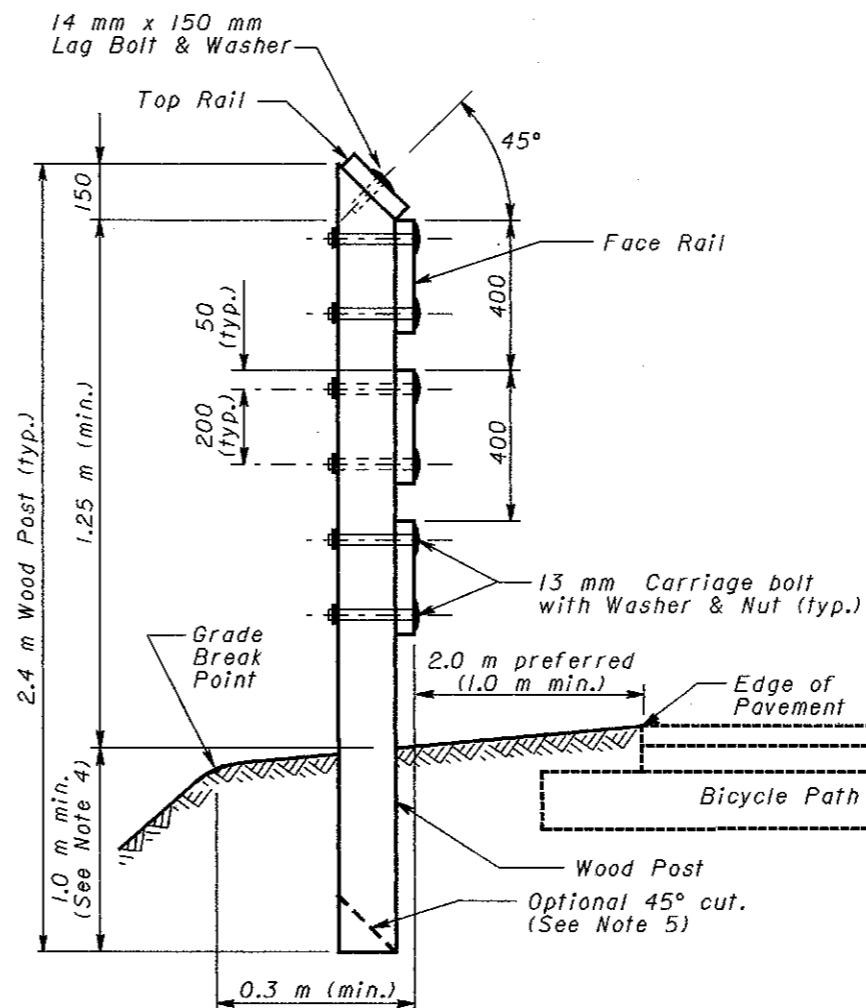

SECTION A-A

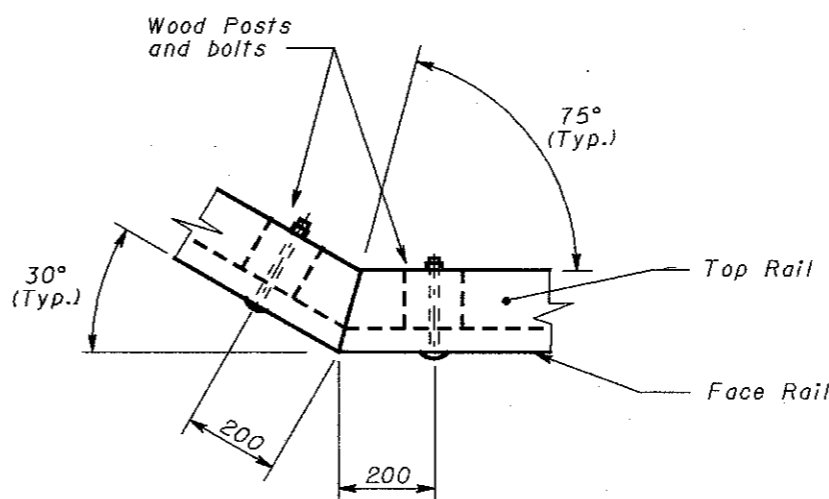

Lag Bolts in Top Rail are not shown for clarity.

DETAIL "A"

NOTES

- 1) All wood members shall be CCA treated as per CMS 712.06.
- 2) All bolts, washers, and nuts shall be galvanized as per CMS 711.02 and 711.10. Counterbore face of rails to provide flush bolt heads.
- 3) Railing shall be of a wood that is smooth and splinter free.
- 4) Where less than 0.3 m of graded shoulder width (10:1 or flatter) extends beyond the edge of the face rail, longer posts shall be used so that a minimum 1.5 m embedment depth is provided.
- 5) The bottom end of the 150 mm x 150 mm posts may be cut to a 45° point.
- 6) Butting of the ends of the top rail and the middle face rail shall be staggered (on alternate posts) with butting ends of the upper and lower face rails. All butt end joints shall be centered on the posts.
- 7) The cost of furnishing and placing all posts, rails, and hardware shall be included in the unit price bid for Item 607, Fence, Misc.; Wood Fence

All dimensions are in millimeters unless otherwise noted.



OFFICE OF ROADWAY ENGINEERING
OHIO DEPARTMENT OF TRANSPORTATION

BIKEWAY RAILING

DATE
4-1-96
4-14-98

STANDARD CONSTRUCTION DRAWING **RM-5.2M**

APPROVED *Ralph F. Sutherland*
ADMINISTRATOR

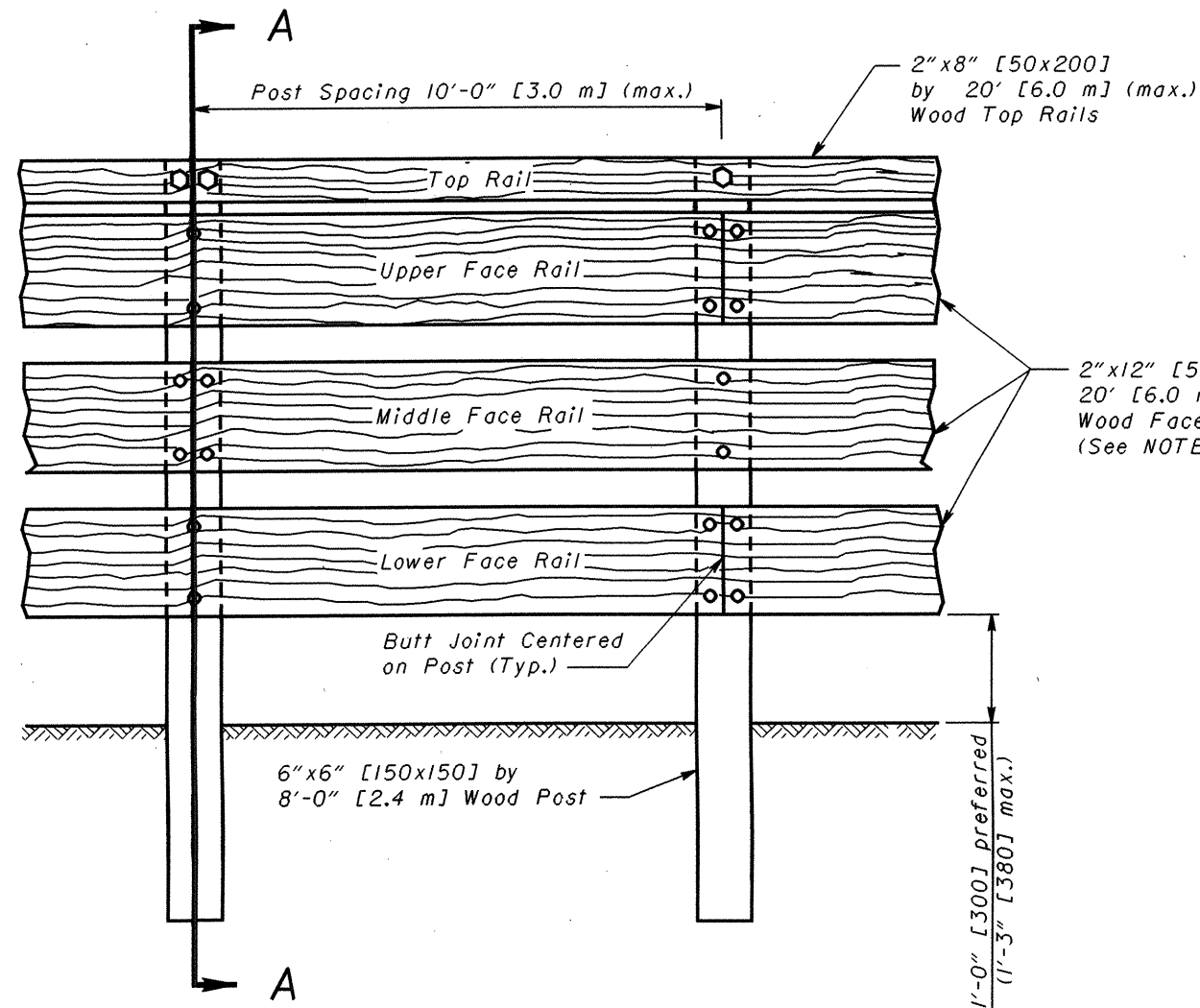

ELEVATION VIEW

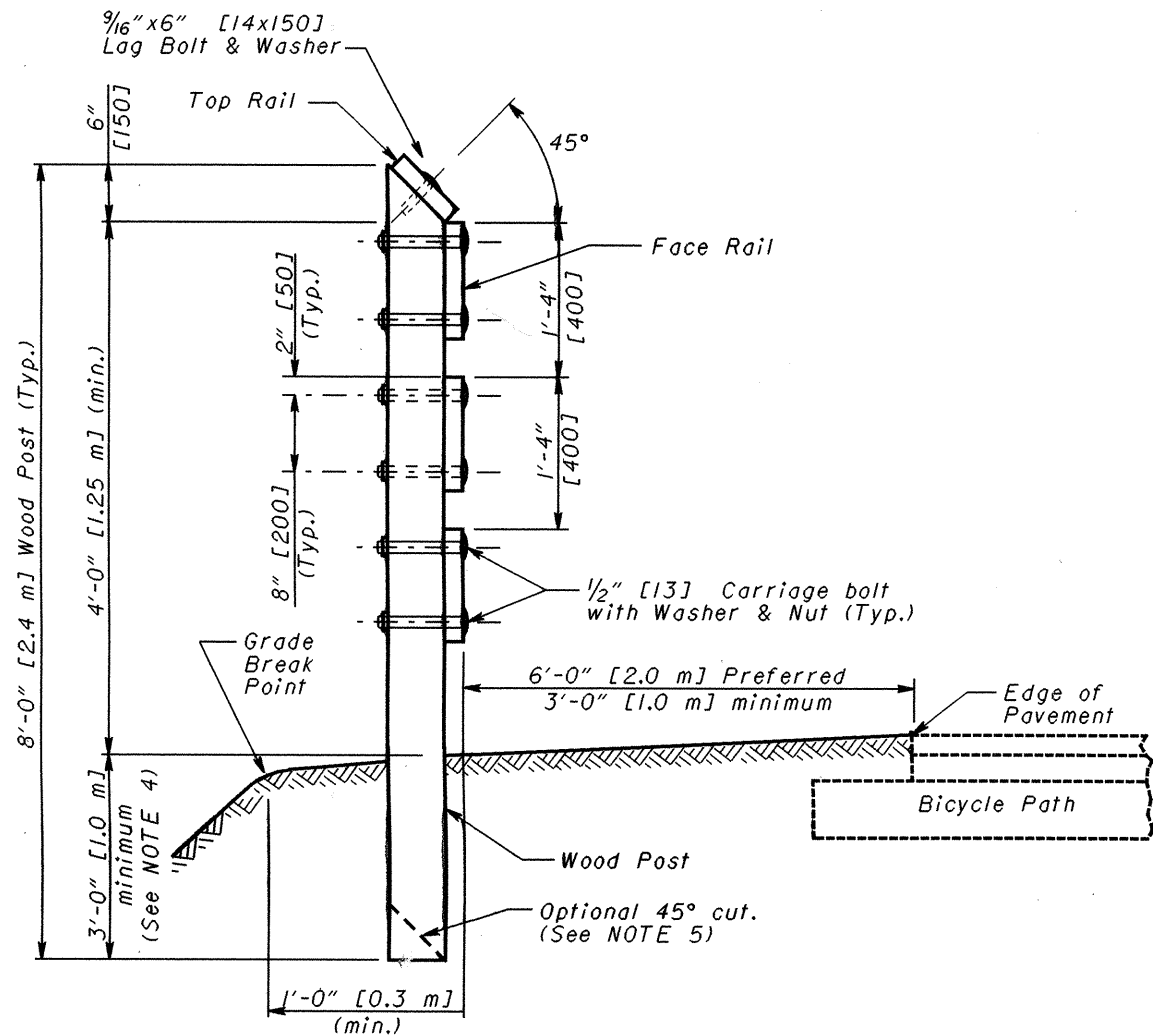

SECTION A-A

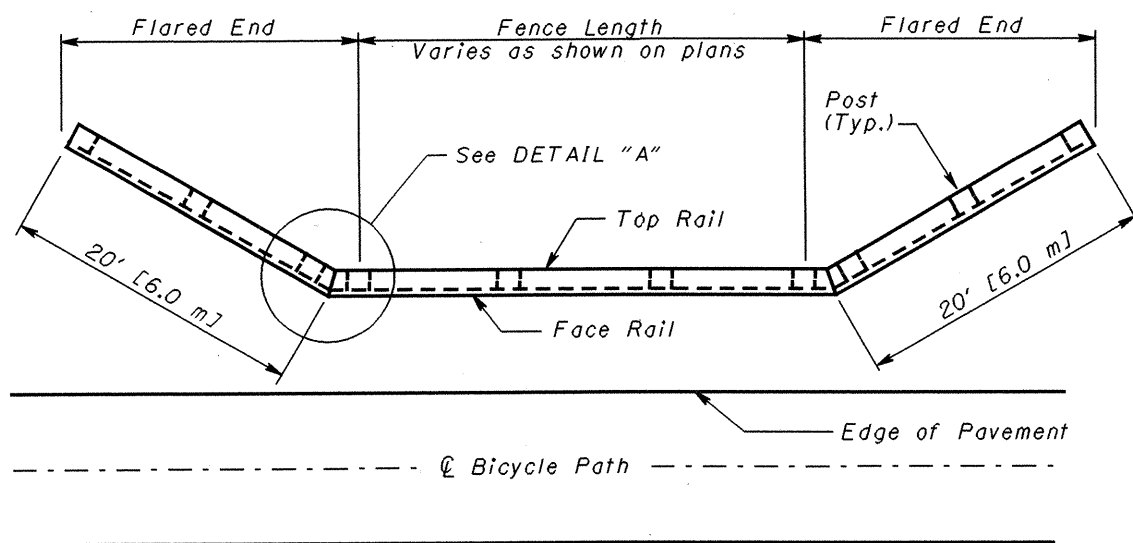

PLAN VIEW

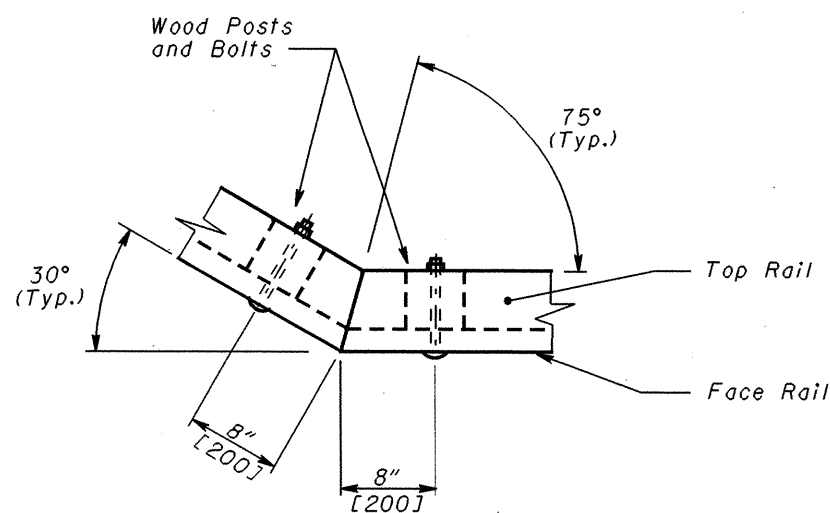

Lag Bolts in Top Rail are not shown for clarity.

DETAIL "A"

NOTES

- 1) CCA treat all wood members as specified in CMS 712.06.
- 2) Galvanize all bolts, washers, and nuts as specified in CMS 711.02 and 711.10. Counterbore face of rails to provide flush bolt heads.
- 3) Provide a wood railing that is smooth and splinter free.
- 4) Where less than 1'-0" [0.3 m] of graded shoulder width (10:1 or flatter) extends beyond the edge of the face rail, use longer posts so that a minimum 5'-0" [1.5 m] embedment depth is provided.
- 5) The bottom end of the 6"x6" [150x150] posts may be cut to a 45° point.
- 6) Stagger butt ends of the top rail and the middle face rail (on alternate posts) with butting ends of the upper and lower face rails. Center all butt end joints on the posts.
- 7) Include the cost of furnishing and placing all posts, rails, and hardware in the unit price bid for **Item 607 - Fence, Misc. + Wood Fence.**

THIS DRAWING REPLACES RM-5.2M DATED 4-14-98.

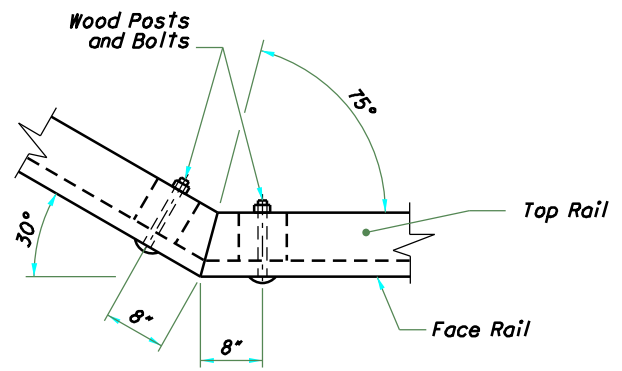
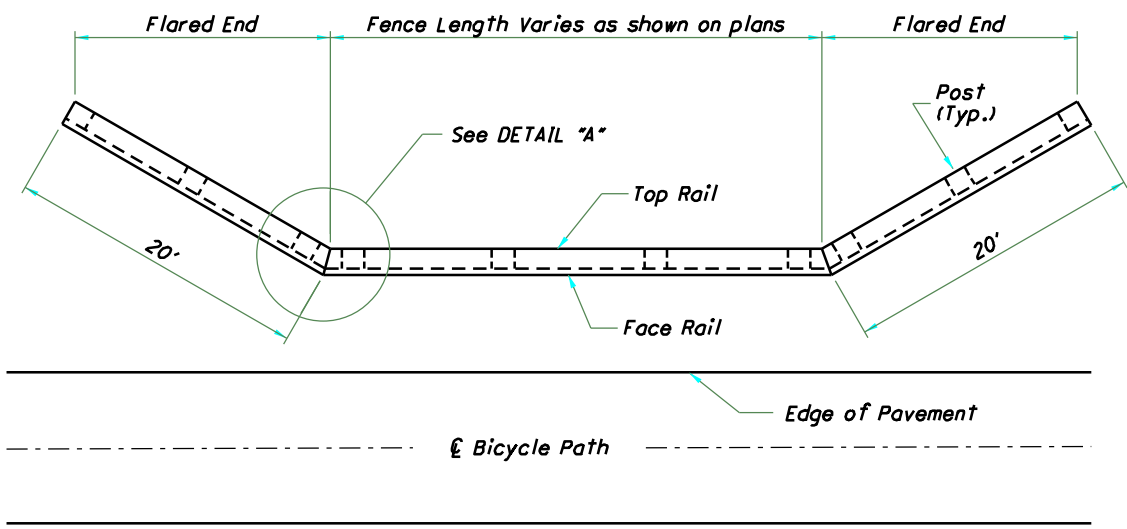
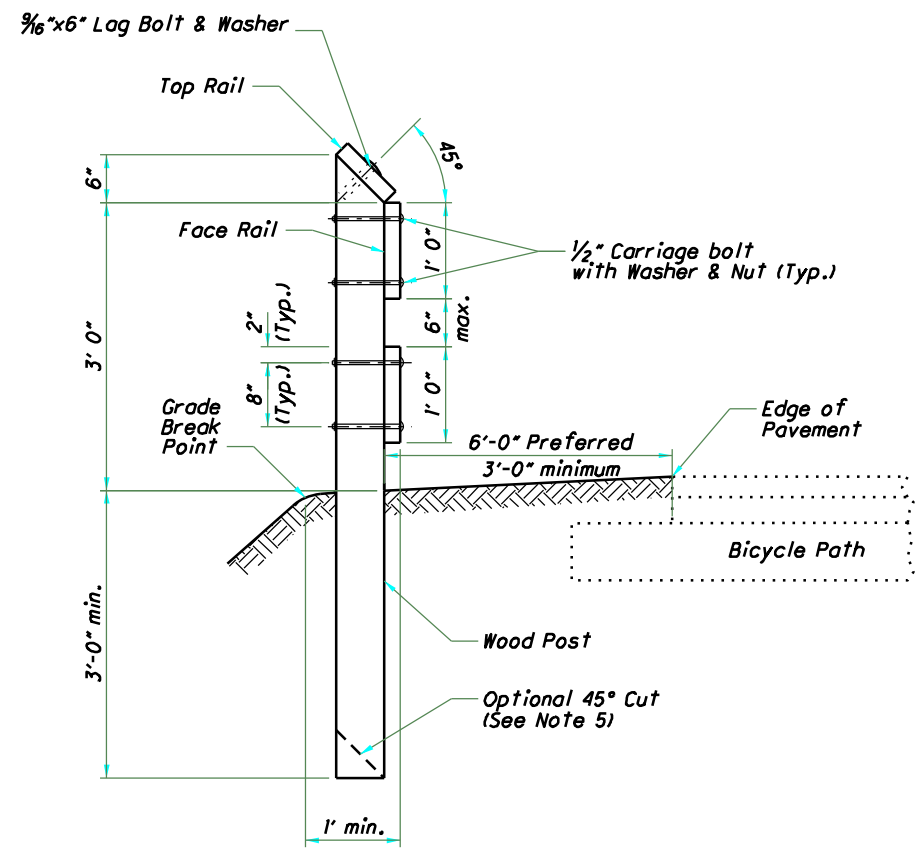
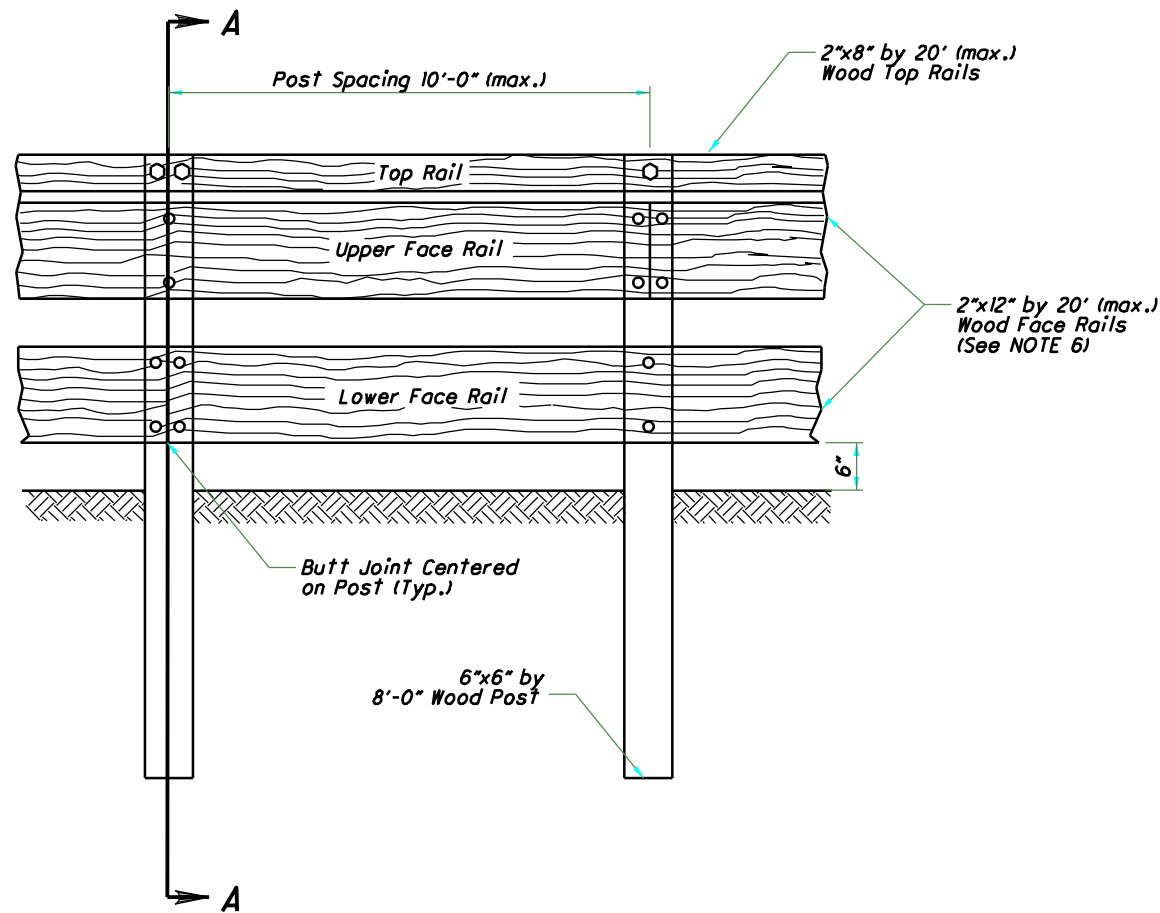

PLAN VIEW

DETAIL "A"

Lag Bolts in Top Rail are not shown for clarity.

NOTES

- 1) CCA treat all wood members as specified in CMS 712.06.
- 2) Galvanize all bolts, washers, and nuts as specified in CMS 711.02 and 711.10. Counterbore face of rails to provide flush bolt heads.
- 3) Provide a wood railing that is smooth and splinter free.
- 4) Where less than 1'-0" of graded shoulder width (10:1 or flatter) extends beyond the edge of the face rail, use longer posts so that a minimum 5'-0" embedment depth is provided.
- 5) The bottom end of the 6"x6" posts may be cut to a 45° point.
- 6) Stagger butt ends of the top rail and the lower face rail (on alternate posts). Center all butt end joints on the posts.
- 7) Include the cost of furnishing and placing all posts, rails, and hardware in the unit price bid for Item 607 - Fence, Misc.: Wood Fence.

THIS DRAWING REPLACES RM-5.2M DATED 4-18-03.

STANDARD ROADWAY CONSTRUCTION DRAWING

BIKEWAY RAILING

RM-5.2

1/1

OFFICE OF ROADWAY ENGINEERING

ALL METRIC DIMENSIONS () ARE IN MILLIMETERS UNLESS OTHERWISE NOTED.

STATE ENGINEER

M. Blime

STATE OF OHIO DEPARTMENT OF TRANSPORTATION

David B. Swan

ADMINISTRATOR

1-21-11

DATE

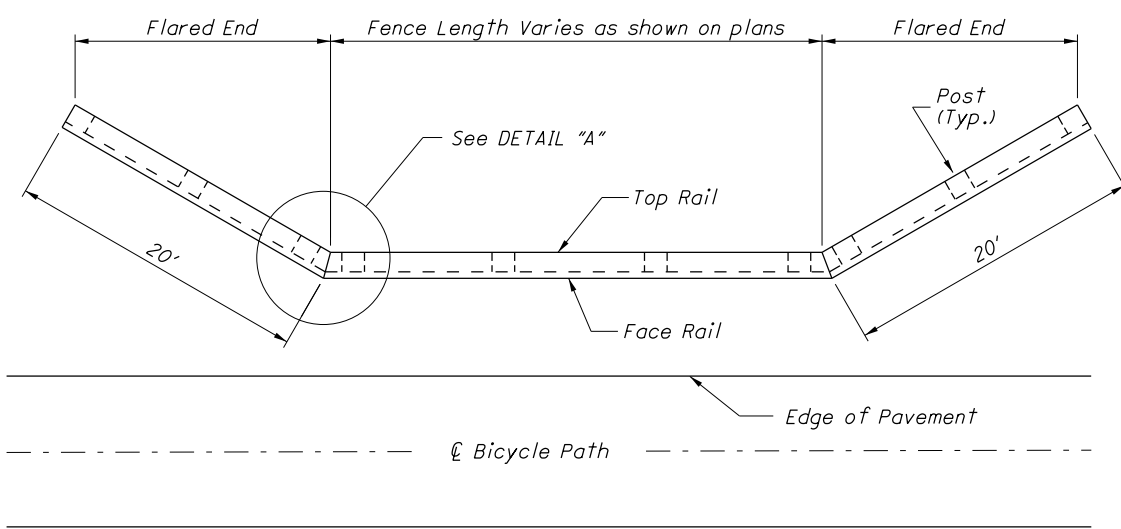
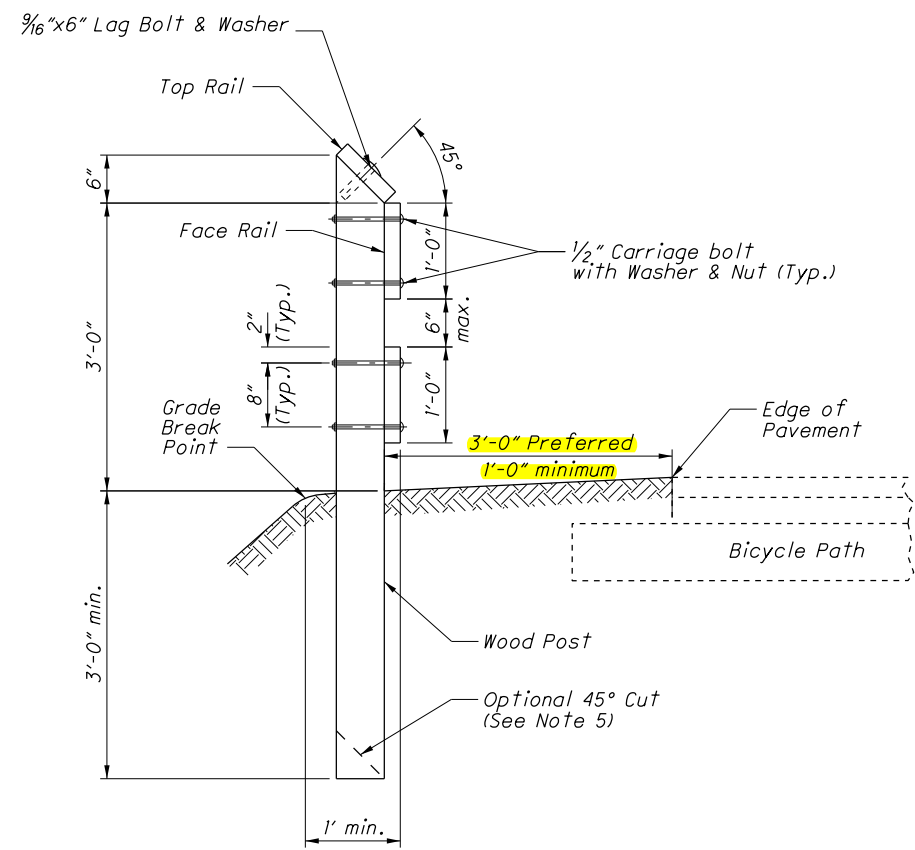
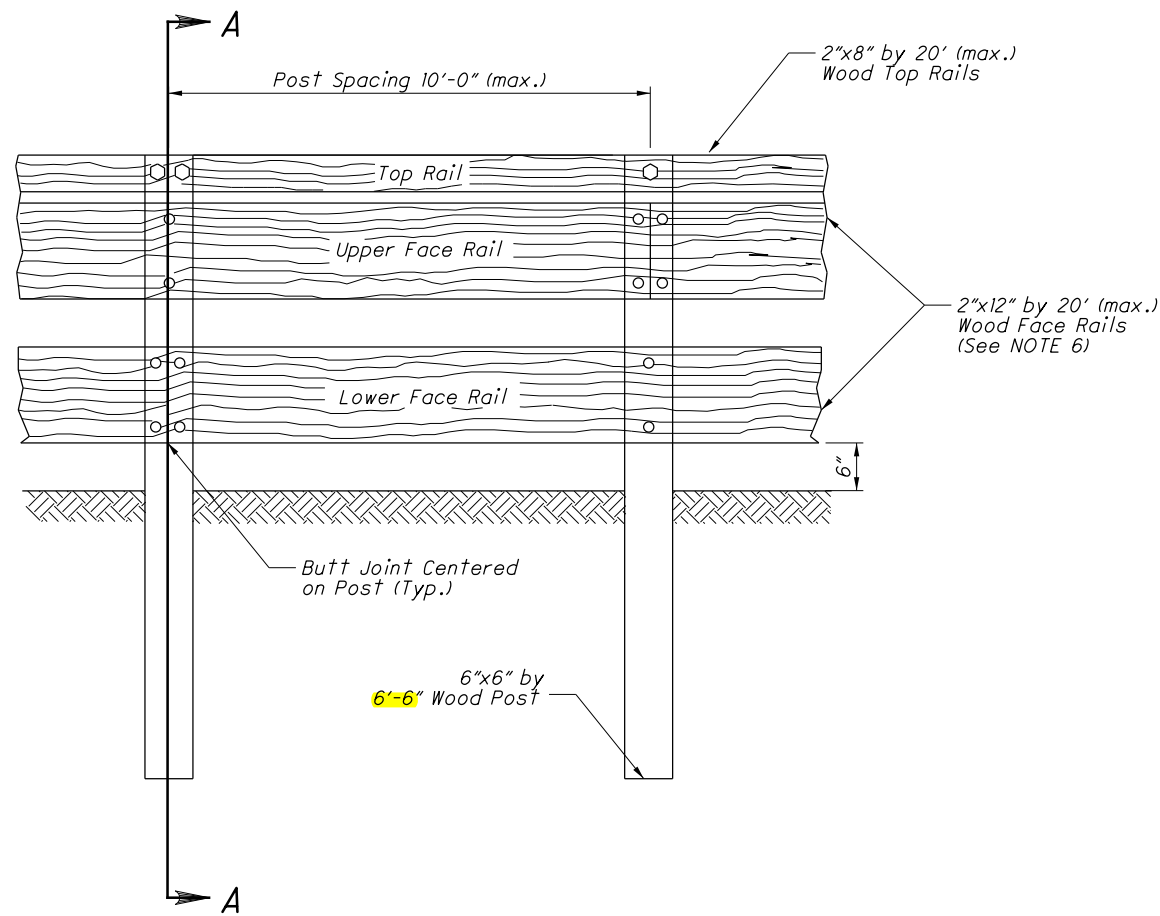

PLAN VIEW

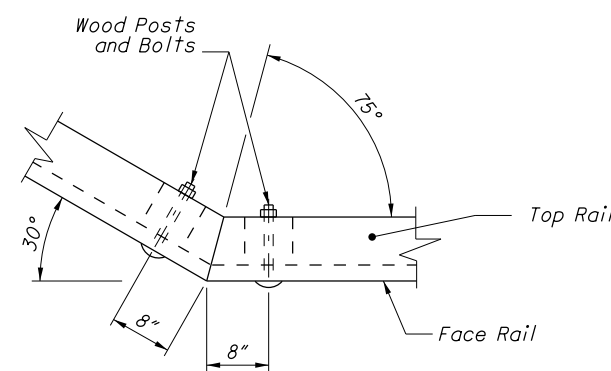

Lag Bolts in Top Rail are not shown for clarity.

DETAIL "A"

NOTES

- 1) CCA treat all wood members as specified in CMS 712.06.
- 2) Galvanize all bolts, washers, and nuts as specified in CMS 711.02 and 711.10. Counterbore face of rails to provide flush bolt heads.
- 3) Provide a wood railing that is smooth and splinter free.
- 4) Where less than 1'-0" of graded shoulder width (10:1 or flatter) extends beyond the edge of the face rail, use longer posts so that a minimum 5'-0" embedment depth is provided.
- 5) The bottom end of the 6"x6" posts may be cut to a 45° point.
- 6) Stagger butt ends of the top rail and the lower face rail (on alternate posts). Center all butt end joints on the posts.
- 7) Include the cost of furnishing and placing all posts, rails, and hardware in the unit price bid for Item 607 - Fence, Misc.: Wood Fence.

THIS DRAWING REPLACES RM-5.2 DATED 1-21-11

STANDARD ROADWAY CONSTRUCTION DRAWING

SD NUMBER
RM-5.2

BIKEWAY RAILING

OFFICE OF ROADWAY ENGINEERING

STATUS
ENGINEER
M. Ruppe

STATE OF OHIO DEPARTMENT OF TRANSPORTATION
Ryanaldo Stangell
 ADMINISTRATOR
 1-17-2014
 DATE